

Show how you will handle storm water.
No encroaching on the railroad right-of-way or any easements

PL201700081 PL2017-81

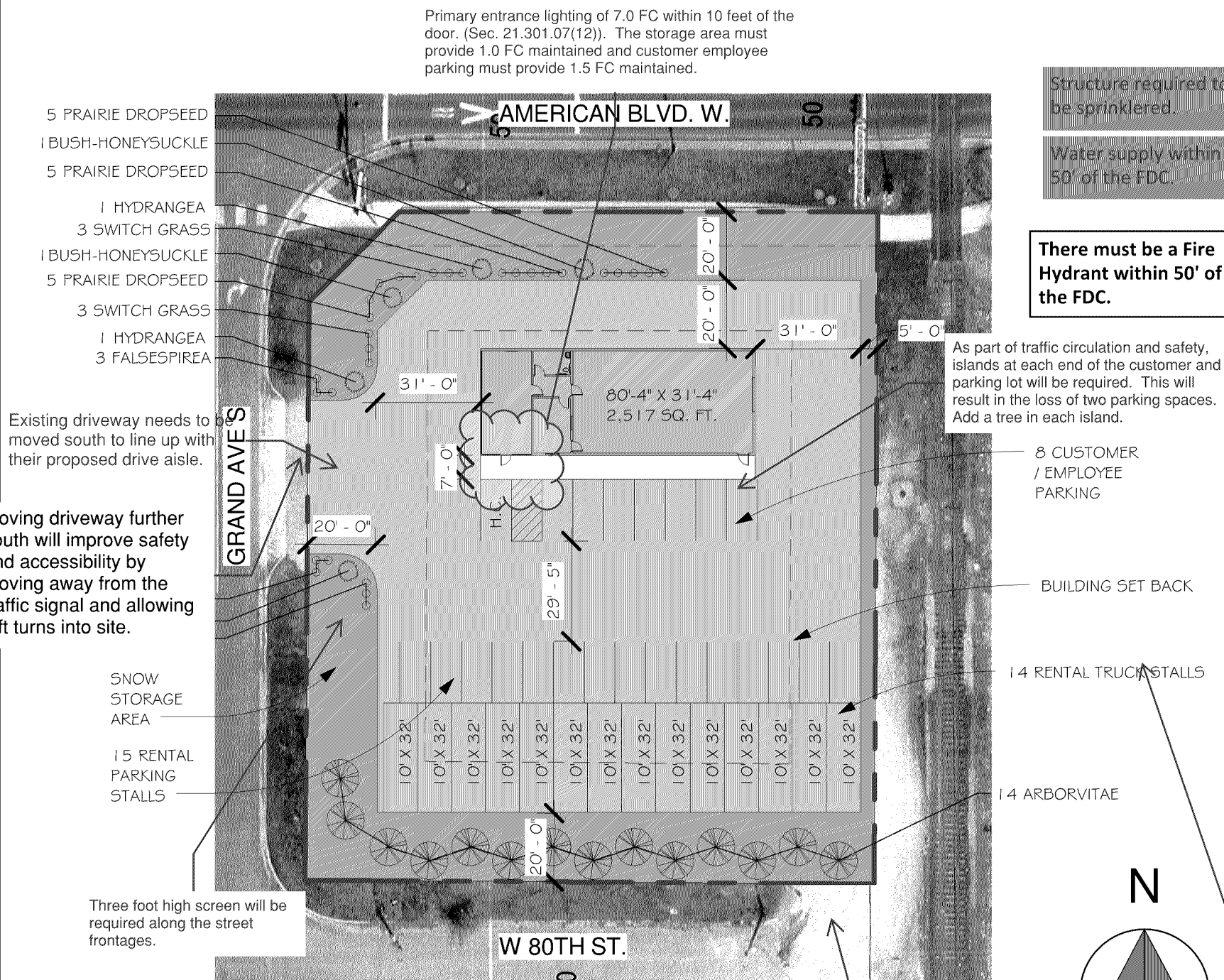

Structure required to be sprinklered.

Water supply within 50' of the FDC.

All underground tanks and contaminated soil to be removed.

There must be a Fire Hydrant within 50' of the FDC.

PROPOSED LANDSCAPING:

DEVELOPMENT SITE AREA = 32,360 SQ. FT.
PER ORDINANCE: 1 TREE / 2,500 SQ. FT. = 13 TREES
1 SHRUB / 1,000 SQ. FT. = 33 SHRUB

Required landscaping must be dispersed throughout the site. Ornamental or evergreen trees used to meet the City Code requirement are limited to 25 percent each.

PLANT SCHEDULE

OVERSTORY TREES

QTY.	COMMON NAME	BOTANIC NAME	SIZE
14	ARBORVITAE	Arborvitae is a shrub and must not be used as a tree. thuja occidentalis	B#B
14	TOTAL TREES		

PLANT SCHEDULE

SHRUBS / PERENNIALS

QTY.	COMMON NAME	BOTANIC NAME	SIZE
9	SWITCH GRASS, <i>ROTSTRAHLBUSCH</i>	P. virgatum 'northwinds'	#1 Cont.
15	PRAIRIE DROPSEED	Sporobolus heterolepis 'Tara'	#1 Cont.
2	BUSH-HONEYSUCKLE, <i>DWARF</i>	Diervilla lonicera	#5 Cont.
6	FALSESPIREA	Sorbaria sorbifolia 'Sem'	#5 Cont.
3	HYDRANGEA, <i>ANNABELLE</i>	Hydrangea arborescens 'Annabelle'	#3 Cont.
35	TOTAL SHRUBS		