

CITY OF BLOOMINGTON
1800 W OLD SHAKOPEE RD
BLOOMINGTON, MN 55431

ROSSON RICHARD J
8206 OLD CEDAR AVE S
BLOOMINGTON, MN 55425

CEDAR GATE LLC
901 N 3RD ST #150
MPLS, MN 55401

SOUTH LOOP INVESTMENTS LLC
PO BOX 3208
PARK CITY, UT 84060

NORTH PAD DEVELOPMENT LLC
2131 LINDAU LN #500
BLOOMINGTON, MN 55425

O'NEILL JAMES W ET AL
425 HAMM BLDG
408 ST PETER ST
ST PAUL, MN 55102

HALVERSON NANNETTE K
8256 OLD CEDAR AVE S
BLOOMINGTON, MN 55425

COLUMBIA PROP MPLS LTC
740 CENTRE VIEW BLVD
CRETVIEW HILLS, KY 41017

SOUTH PAD HOTEL LLC
2131 LINDAU LN #500
BLOOMINGTON, MN 55425

CCF2 LLC
7801 E BUSH LAKE RD #120
BLOOMINGTON, MN 55438

CHRISTIAN MARY C
8220 OLD CEDAR AVE S
BLOOMINGTON, MN 55425

SOUTH LOOP HOSP EAT 38362
C/O MERCURY INVESTMENTS
P O BOX 3208
PARK CITY, UT 84060

BLN OFFICE PARK ASSOC II
C/O BLN OFFICE PARK ASSOC
2001 KILLEBREW DR
BLOOMINGTON, MN 55425

METROPOLITAN AIRPORTS COM
6040 28TH AVE S
MPLS, MN 55450

WR KILLEBREW LLC
4350 BAKER RD
MINNETONKA, MN 55343

MSP BLOOMINGTON LLC
7300 BLANCO RD #701
SAN ANTONIO, TX 78216

MOAC MALL HOLDINGS LLC
C/O NORDSTROMS - TAX DEPT
P O BOX 2229
SEATTLE, WA 98111

NORTH PAD DEVELOPMENT LLC
C/O MOAC MALL HOLDINGS
60 E BROADWAY
BLOOMINGTON, MN 55425

SOUTH PAD HOTEL LLC
2100 KILLEBREW DR
BLOOMINGTON, MN 55425

MATTHEWS MORRIS L
8234 OLD CEDAR AVE S
BLOOMINGTON, MN 55425

SOUTH LOOP INVESTMENTS 2 LLC
340 MAIN ST #200
PARK CITY, UT 84060

DELTA METRO LANDS LLC
2131 LINDAU LN #500
BLOOMINGTON, MN 55425

METROPOLITAN COUNCIL
ATTN: TAX DEPARTMENT
390 ROBERT ST N
ST PAUL, MN 55101

O'NEILL JAMES C ESTATE
425 HAMM BLDG
408 ST PETER ST
ST PAUL, MN 55102

BLN OFFICE PARK ASSOC
2001 KILLEBREW DR
BLOOMINGTON, MN 55425

MOAC MALL HOLDINGS LLC
2131 LINDAU LN #500
BLOOMINGTON, MN 55425

NORTHERN LIGHTS IND GRP
C/O SENTINEL R E GROUP
1251 AVE OF AMERICAS-35TH
NEW YORK, NY 10020

MOAC MALL HOLDINGS LLC
ATTN: PROP REAL ESTATE TX
7 W 7TH ST
CINCINNATI, OH 45202

HENDRICKSON JAMES K
8214 OLD CEDAR AVE S
BLOOMINGTON, MN 55425

CONCORDE ATRUIM CTR LLC
310 E SUPERIOR ST
DULUTH, MN 55802

MOAC MALL HOLDINGS LLC
C/O SEARS MERCHANDISE GRP
3333 BEVERLY RD
HOFFMAN ESTATES, IL 60179

COUNTRY/CARLSON
MAIL STOP 8254
701 CARLSON PKY
MINNETONKA, MN 55305

NSHE BIG SPRINGS LLC
C/O IKEA PROPERTY INC
420 ALAN WOOD RD
CONSHOHOCKEN, PA 19428

POLAR SEMICONDUCTOR INC
2800 E OLD SHAKOPEE RD
BLOOMINGTON, MN 55425

MOAC LAND HOLDINGS LLC
BOB LARSON MOA MGMT OFFICES
2131 LINDAU LN #500
BLOOMINGTON, MN 55425

APPELBAUM SALLY FAMILY LP
C/O D H GUSTAFSON COMPANY
1500 MC ANDREWS RD W# 100
BURNSVILLE, MN 55337

TMI HOSPITALITY
P O BOX 9118
FARGO, ND 58106

IHOP REALTY CORP
ATTN: TAX DEPT
450 N BRAND BLVD 7TH FLR
GLENDALE, CA 91203

MFS KILLEBREW LLC
D/B/A CHEVY'S CINCO LLC
9 103RD AVE NE # 202
BELLEVUE, WA 98004

BLOOMINGTON CIS LP
MAIL STOP 8254
701 CARLSON PKY
MINNETONKA, MN 55305

CHATHAM BLMGTN HS LLC
C/O JEFFREY H FISHER
222 LAKEVIEW AVE #200
PALM BEACH, FL 33401

2276 HOMECREST REALTY LLC
3711 SHORE PKY
BROOKLYN, NY 11235

US FEDERAL CREDIT UNION
1400 RIVERWOOD DR
BURNSVILLE, MN 55337

MOAC LAND HOLDINGS LLC
2131 LINDAU LN #500
BLOOMINGTON, MN 55425

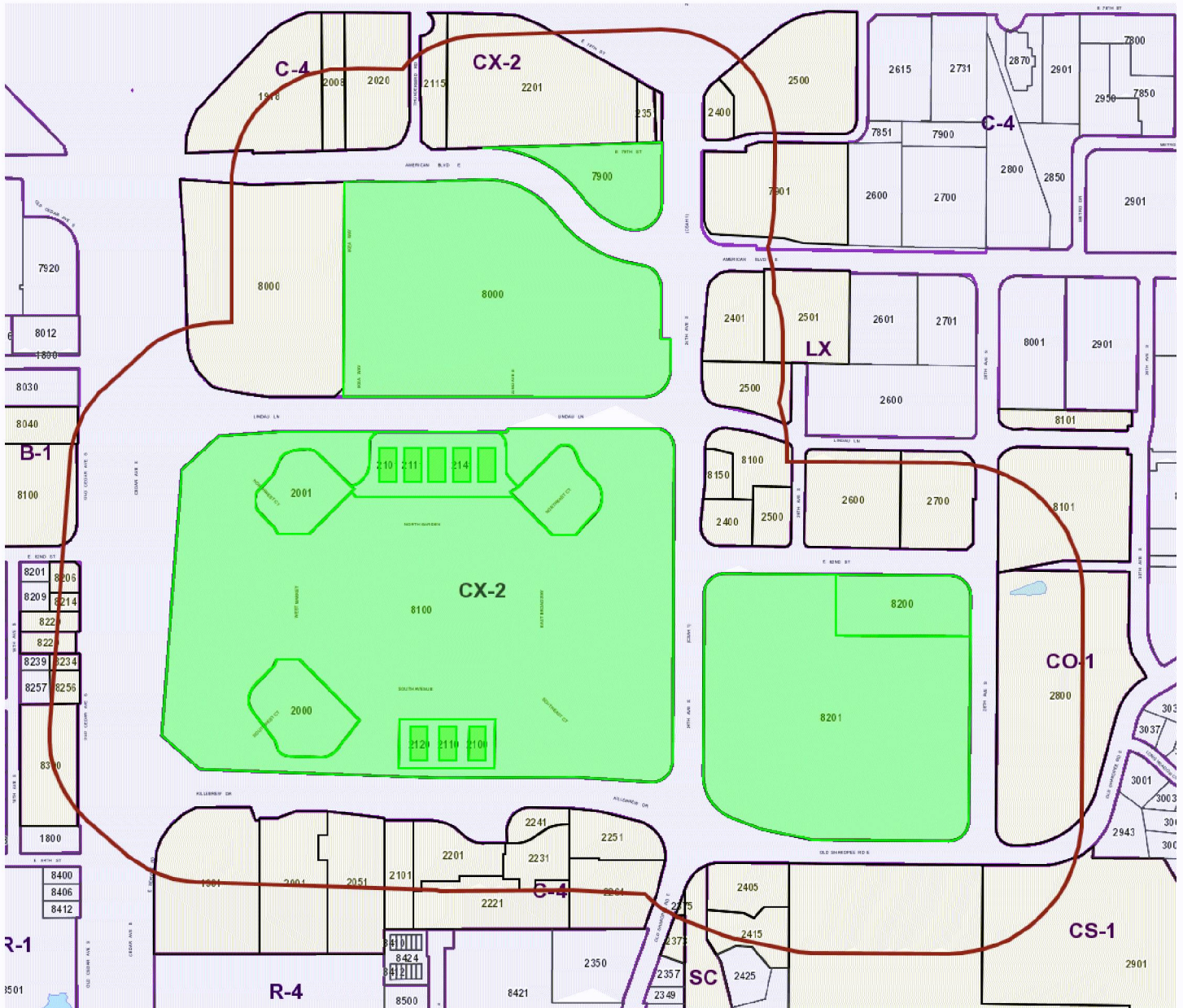

PL2017-288

City of Bloomington Notification Map



Case: PL2017-288

Subject Properties: 7900, 8000, 8100 and 8201 24th Avenue; 2101, 2111 and 2121 Lindau Lane; and 8200 28th Avenue

-  Notification Boundary (500 feet)
-  Subject Property/Properties
-  Notified Properties

