

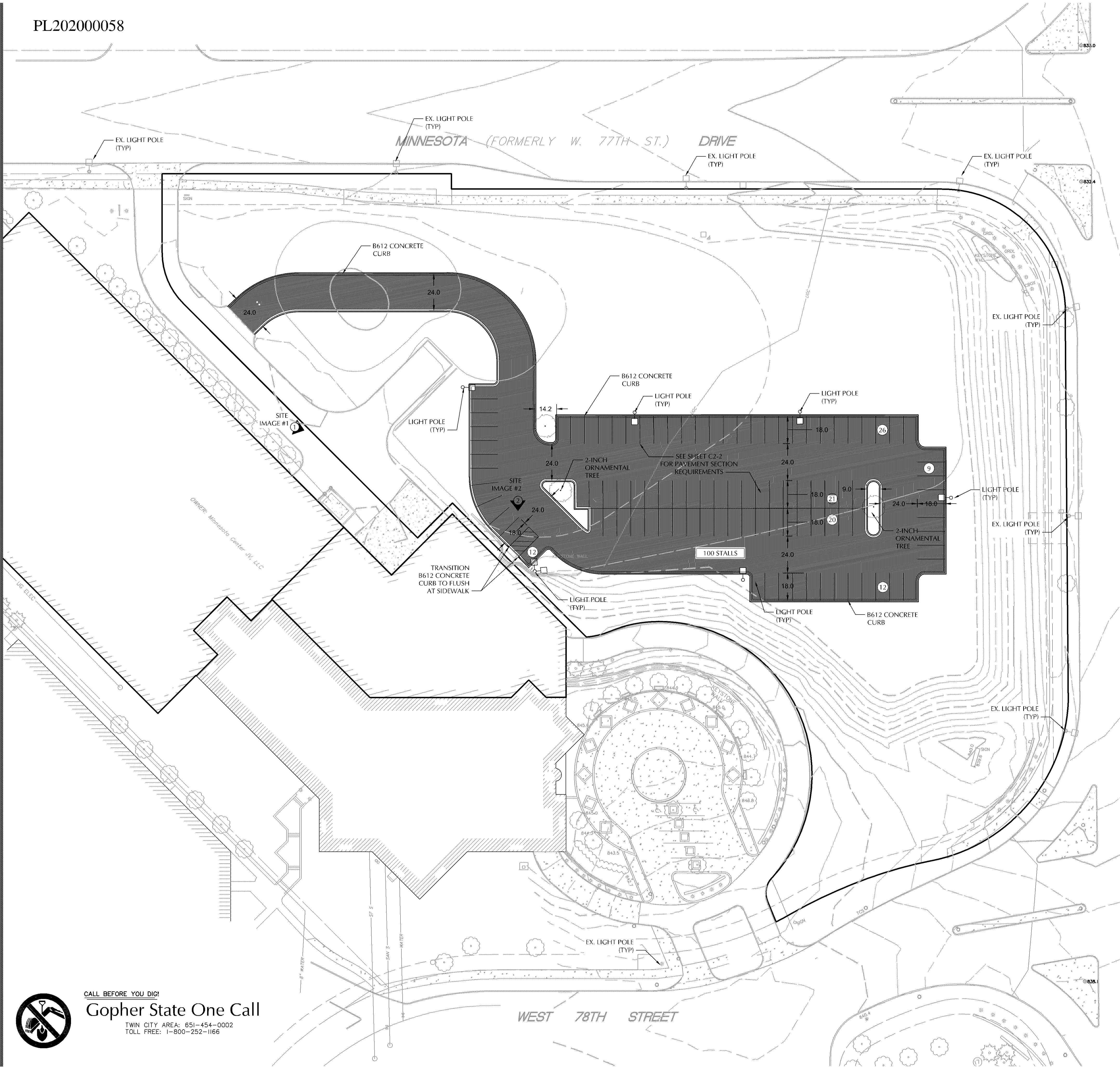

CALL BEFORE YOU DIG!

Gopher State One Call

TWIN CITY AREA: 651-454-0002
TOLL FREE: 1-800-252-1166



SITE NOTES

1. TYPICAL FULL SIZED PARKING SPACE IS 9' X 18' UNLESS OTHERWISE NOTED.
2. CONTRACTOR SHALL BE RESPONSIBLE FOR ALL STRIPING AS SHOWN ON THIS PLAN.

EXISTING CONDITIONS NOTES

1. EXISTING SITE IMPROVEMENTS, UTILITIES, AND TOPOGRAPHY PROVIDED BY SUNDE LAND SURVEYING, DATED JULY 24, 2017. LOUCKS DOES NOT GUARANTEE THE ACCURACY, OR COMPLETENESS OF WORK PERFORMED BY OTHERS. CONTRACTOR SHALL FIELD VERIFY SITE CONDITIONS AND NOTIFY THE PROJECT ENGINEER AND PROJECT MANAGER IMMEDIATELY WITH ANY DISCREPANCIES.

PROJECT BENCHMARK

PER SUNDE LAND SURVEY DATED JULY 24, 2017

1. TOP OF TOP NUT OF FIRE HYDRANT ON THE SOUTH SIDE OF MINNESOTA DRIVE NEAR MOST NORTHERLY CORNER OF PARKING RAMP. ELEVATION = 829.05 FEET
2. TOP OF TOP NUT OF FIRE HYDRANT ON THE SOUTH SIDE OF MINNESOTA DRIVE 300 FEET +/- WEST OF FRANCE AVENUE. ELEVATION = 831.12 FEET
3. TOP OF TOP NUT OF FIRE HYDRANT AT NORTHWEST QUADRANT OF FRANCE AVENUE AND WEST 78TH STREET. ELEVATION = 837.06 FEET

WARNING:

THE CONTRACTOR SHALL BE RESPONSIBLE FOR CALLING FOR LOCATIONS OF ALL EXISTING UTILITIES. THEY SHALL COOPERATE WITH ALL UTILITY COMPANIES IN MAINTAINING THEIR SERVICE AND / OR RELOCATION OF LINES.

THE CONTRACTOR SHALL CONTACT GOPHER STATE ONE CALL AT 651-454-0002 AT LEAST 48 HOURS IN ADVANCE FOR THE LOCATIONS OF ALL UNDERGROUND WIRES, CABLES, CONDUITS, PIPES, MANHOLES, VALVES OR OTHER BURIED STRUCTURES BEFORE DIGGING. THE CONTRACTOR SHALL REPAIR OR REPLACE THE ABOVE WHEN DAMAGED DURING CONSTRUCTION AT NO COST TO THE OWNER.

SITE IMAGES

#1) EXISTING LOADING DOCK - MINNESOTA CENTER

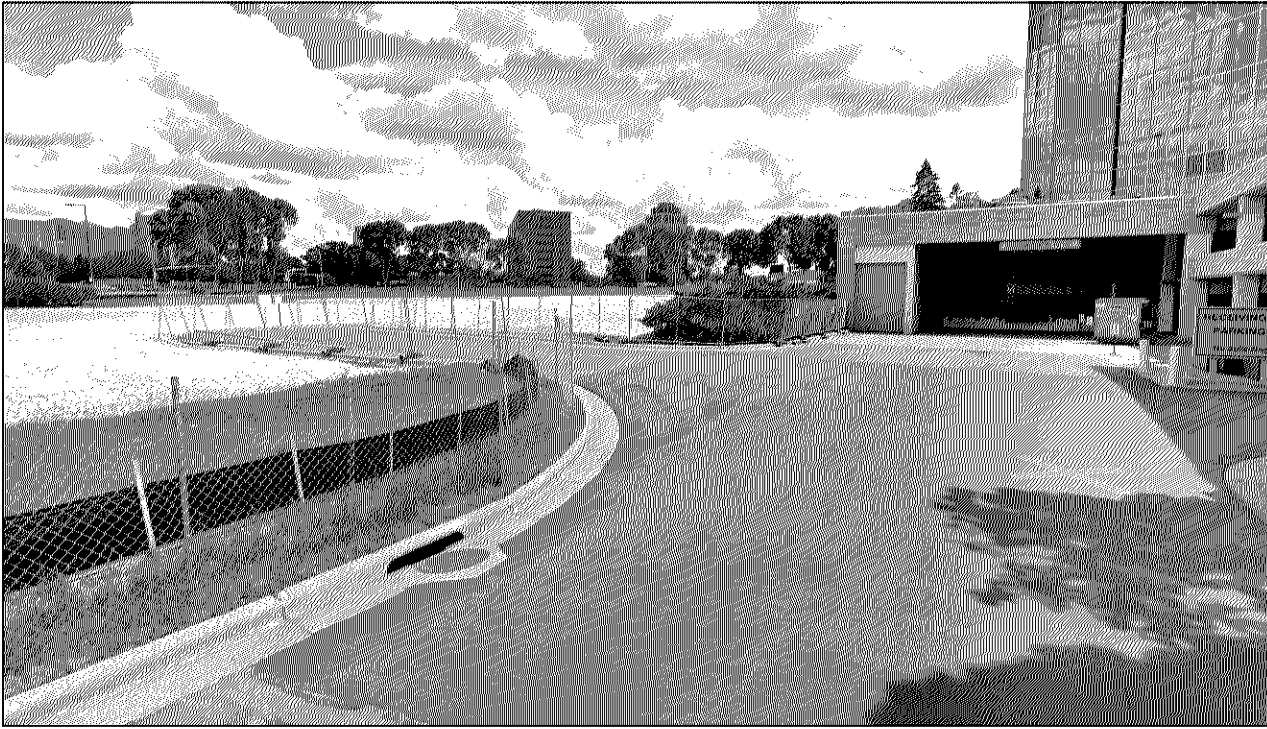

#2) EXISTING RETAINING WALL / PEDESTRIAN ENTRANCE - MINNESOTA CENTER



DRURY PLAZA
HOTEL
INTERIM
PARKING LOT
EXHIBIT

3901 MINNESOTA DRIVE
BLOOMINGTON, MINNESOTA

Drury Southwest, Inc.

101 S. Farrar Drive
Cape Girardeau, Missouri, 63701

LOUCKS

PLANNING
CIVIL ENGINEERING
LAND SURVEYING
LANDSCAPE ARCHITECTURE
ENVIRONMENTAL

7200 Hemlock Lane, Suite 300
Maple Grove, MN 55369
763.424.5505
www.loucksinc.com

CADD QUALIFICATION

CADD files prepared by the Consultant for this project are instruments of the Consultant's professional services for use solely with respect to this project. These CADD files shall not be used on other projects, for additions to this project, or for completion of this project by others without written approval by the Consultant. With the Consultant's approval, others may be permitted to obtain copies of the CADD drawing files for information and reference only. All intentional or unintentional revisions, additions, or deletions to these CADD files shall be made at the full risk of that party making such revisions, additions or deletions and that party shall hold harmless and indemnify the Consultant from any & all responsibilities, claims, and liabilities.

SUBMITTAL/REVISIONS

04/21/20 CITY SUBMITTAL

PROFESSIONAL SIGNATURE

I hereby certify that this plan, specification or report was prepared by me or under my direct supervision and that I am a duly Licensed Professional Engineer under the laws of the State of Minnesota.

License No. Vicki J. Van Dell - PE 41352
Date -

QUALITY CONTROL

Loecks Project No. 17457.00
Project Lead JLV
Drawn By JLV
Checked By NMM
Reviewed By JLV
NOT FOR CONSTRUCTION

SHEET INDEX

C0-1	COVER SHEET
C1-1	EXISTING CONDITIONS PLAN
C2-1	SITE PLAN
C2-2	SITE PLAN OVERLAY
C3-1	GRADING PLAN
C3-2	GRADING PLAN OVERLAY
C8-1	CIVIL DETAILS
SL-1	SITE LIGHTING PLAN

INTERIM LOT
CODE
COMPLIANCE
EXHIBIT

EX-1

