

HOFFMANN GERALD E
6816 W 82ND ST
BLOOMINGTON, MN 55438

HITCHCOCK INDUSTRIES INC
8701 HARRIET AVE S
BLOOMINGTON, MN 55420

LAM THUY PHUOC
8645 BRYANT AVE S
BLOOMINGTON, MN 55420

MAMULA MARY E
8635 BRYANT AVE S
BLOOMINGTON, MN 55420

ADELMANN PROPERTIES 1 LLC
8640 HARRIET AVE S # 100
BLOOMINGTON, MN 55420

ADELMANN PROPERTIES 1 LLC
C/O ROBERT F ADELMANN
8640 HARRIET AVE S # 100
BLOOMINGTON, MN 55420

R&K II LLC
700 N BERKSHIRE LN
PLYMOUTH, MN 55441

NGUYEN HAM C
8404 VIRGINIA CIR
BLOOMINGTON, MN 55438

ASHLAND INC
P O BOX 14000
LEXINGTON, KY 40512

COOK PROPS BLMGTN/BC LLC
C/O BRIAN D COOK
9841 LEE DR
EDEN PRAIRIE, MN 55347

COOK DANIEL D
8796 COTTONWOOD LN
EDEN PRAIRIE, MN 55347

JEC MILLER HOLDINGS LLC
2202 11TH ST E
GLENCOE, MN 55336

RUD DELAINE C
8615 BRYANT AVE S
BLOOMINGTON, MN 55420

WIZARD CREEK INC
510 VALLEYWOOD CIR
GOLDEN VALLEY, MN 55422

T AND T OF MN INC
8610 HARRIET AVE S
BLOOMINGTON, MN 55420

S & S MANAGEMENT
C/O GENUINE PARTS CO,AUDT
2999 CIRCLE 75 PKY
ATLANTA, GA 30339

ALJOE DAVID A
8655 BRYANT AVE S
BLOOMINGTON, MN 55420

REALTY INCOME PROP 3 LLC
11995 EL CAMINO REAL# 101
SAN DIEGO, CA 92130

KASSA DONALD
8533 BRYANT AVE S
BLOOMINGTON, MN 55420

AGGREGATE IND MWR INC
C/O PATTY CHRISTENSEN
2815 DODD RD # 101
EAGAN, MN 55121

STROMMEN CAMPBELL, SIRIANNA
8540 ALDRICH AVE S
BLOOMINGTON, MN 55420

OLSON AMY
8649 BRYANT AVE S
BLOOMINGTON, MN 55420

HENRY COURTS INC
3710 CHICAGO AVE S
MPLS, MN 55407

BLMGTN SHOPPES DEVELOPERS
7100 WAYZATA BLVD # 200
MPLS, MN 55426

DAVANNI'S INC
1100 XENIUM LN N
PLYMOUTH, MN 55441

GAUDERMAN JASON J
181 BOYNTON RD
KAYSVILLE, UT 84037

SCHILLING HEIDI
5156 W 95TH ST
BLOOMINGTON, MN 55437

BERDAN JESSICA
8549 BRYANT AVE S
BLOOMINGTON, MN 55420

ESBER ANDREW JR
8555 ALDRICH AVE S
BLOOMINGTON, MN 55420

WU RUOQING
8521 ALDRICH AVE S
BLOOMINGTON, MN 55420

8609 PROFESSIONAL BUILDING L
900 AMERICAN BLVD E
BLOOMINGTON, MN 55420

RUD DELAINE
8615 BRYANT AVE S
BLOOMINGTON, MN 55420

SCHOENBORN ROBERT J
26370 TAME FISH LAKE RD
DEERWOOD, MN 56444

PETERSON TROY D
1642 CHEROKEE MTN CIR
CASTLE ROCK, CO 80109

BERGLUND ROBERT L
8614 BRYANT AVE S
BLOOMINGTON, MN 55420

HORVAT JOE G ESTATE
8636 BRYANT AVE S
BLOOMINGTON, MN 55420

LUO HUI MEI
8509 ALDRICH AVE S
BLOOMINGTON, MN 55420

WENDEL RANDY G
8539 BRYANT AVE S
BLOOMINGTON, MN 55420

SENSKE ADOLPH JR
8541 ALDRICH AVE S
BLOOMINGTON, MN 55420

WANGERIN ERVIN
8544 ALDRICH AVE S
BLOOMINGTON, MN 55420

LYNDALE AVENUE TOWNHOMES
C/O SAND COMPANIES
P O BOX 727
WAITE PARK, MN 56387

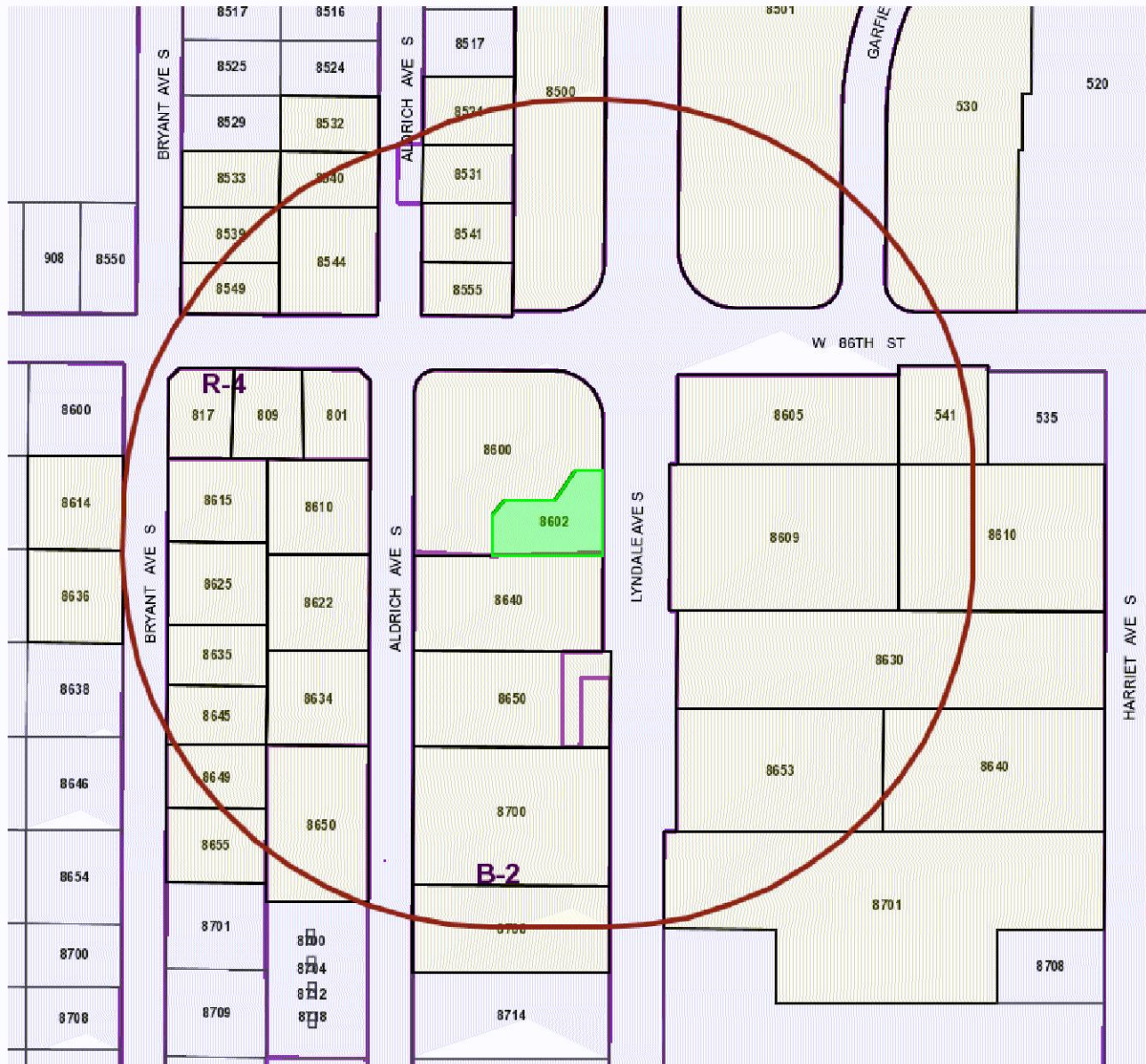

RFP LLC
181 RIVER RIDGE CIR S
BURNSVILLE, MN 55337

City of Bloomington Notification Map



Case PL2017-83

Subject Property: 8602 Lyndale Avenue

-  Notification Boundary (500 feet)
-  Subject Property/Properties
-  Notified Properties

