

Revised: File: N:\Projects\K-1 Client\Koma\2021\2864 Koma Thermo King Civil Engineering Services Bloomington, MN\Koma\0101 - Existing Conditions.dwg
Plotted Date: Oct 22, 2021

PL202100221

PL2021-221

TEMPORARY EROSION CONTROL NOTES:

1. INSTALL PERIMETER AND SEDIMENT CONTROL ITEMS PRIOR TO CONSTRUCTION.
2. THE SURFACE OF ALL SLOPES MORE THAN THREE (3) FEET IN VERTICAL HEIGHT AND STEEPER THAN 5:1 SHALL BE COVERED WITH CITY OF BLOOMINGTON APPROVED EROSION CONTROL BLANKETS. INSTALLATION SHALL CONFORM TO MANUFACTURER'S SPECIFICATIONS. DEVIATIONS FROM THIS REQUIREMENT SHALL BE SUBMITTED IN WRITING WITH AN ALTERNATIVE PLAN FOR TEMPORARY EROSION CONTROL. THIS PLAN SHALL BE APPROVED BY THE CITY ENGINEER.
3. INSTALLATION OF THE EROSION BLANKETS SHALL BE INSTALLED TO THE SATISFACTION OF THE CITY'S PUBLIC WORKS INSPECTOR PRIOR TO ACCEPTANCE OF ROUGH GRADING AND SHALL BE PER THE MANUFACTURER'S SPECIFICATIONS.
4. RESTORATION REQUIREMENTS ARE SHOWN AT A MINIMUM. ADDITIONAL RESTORATION MAY BE REQUIRED IF THERE IS ADDITIONAL SOIL DISTURBANCE.

0 15 30.0001 Feet

LEGEND:

- BITUMINOUS PAVEMENT
- CONCRETE
- FACILITY
- BRICK WALKWAY
- GRASS
- MULCHED LANDSCAPING
- EXISTING CONTOUR
- STORM SEWER INLET
- SIGN
- TREE
- LIGHT POLE

PROJECT BENCHMARK:

HORIZONTAL - MINNESOTA STATE PLANE
SOUTH (NAD83)
VERTICAL - NAVD 88

CONTROL POINT - TOP NUT OF FIRE HYDRANT
NORTHING: 1030132.34'
EASTING: 2810207.47'
ELEV: 836.40'

PARKING SUMMARY:

112 REGULAR
2 HANDICAP
2 HANDICAP WHEEL CHAIR ACCESS

NO.	DATE	ISSUE/REVISION	DRAWN	CHKD

ISSUED FOR REVIEW
NOT FOR CONSTRUCTION

Pinnacle Engineering

11541 96th Ave N
Minneapolis, MN 55369
(763) 315-4501
www.pine.ng.com

DATE:	10/15/2021
DRAWN:	ASM
DESIGNED:	ASM
CHECKED:	BAK
APPROVED:	BAK

PROJECT
SITE PLAN
THERMO KING
BLOOMINGTON, MN

CLIENT

KOMA

DRAWING TITLE
EXISTING CONDITIONS
SOUTH FACILITY ENTRANCE

PROJECT NO.: M20212864

DRAWING NO.: C101

SCALE: AS NOTED

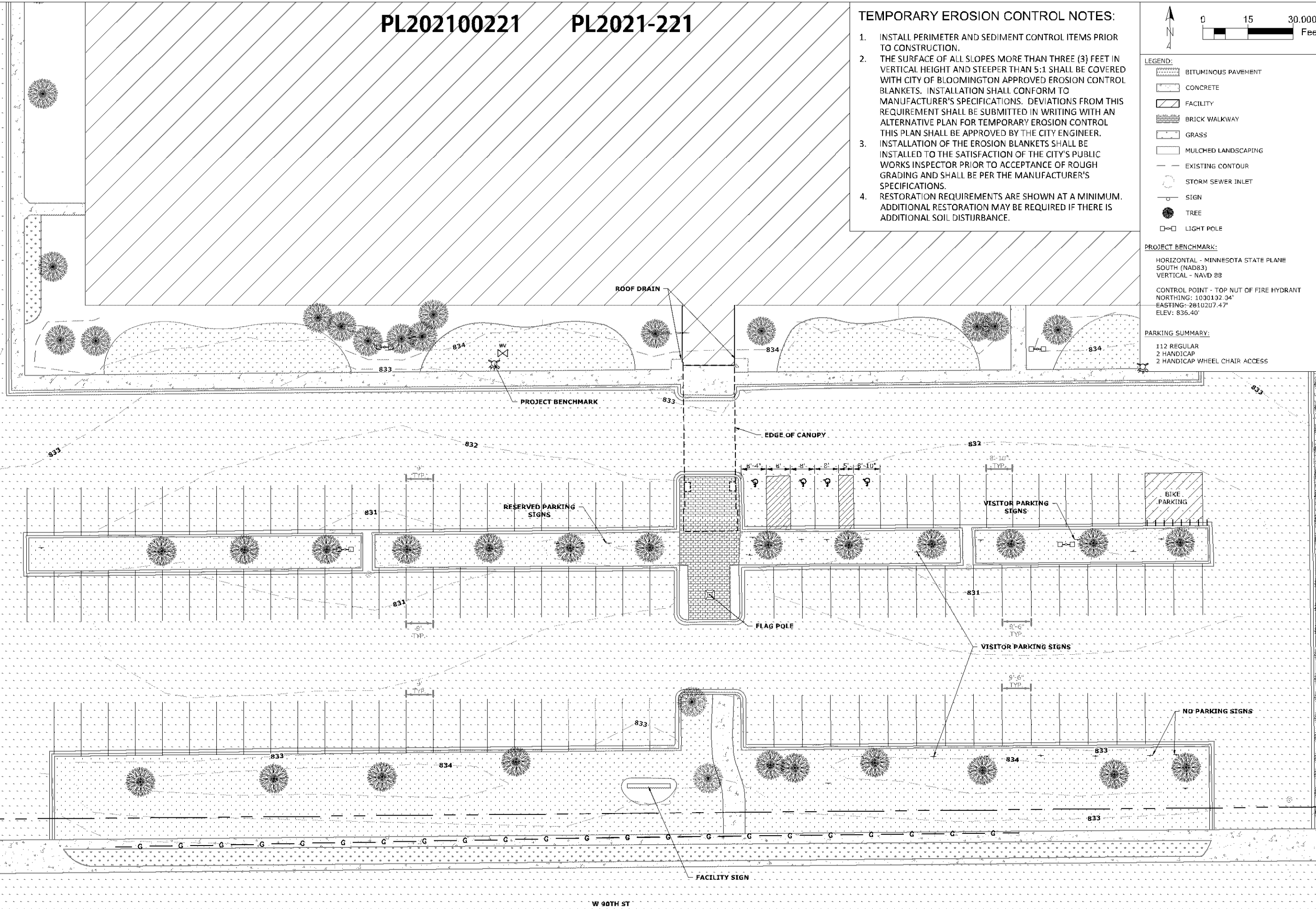

W 90TH ST

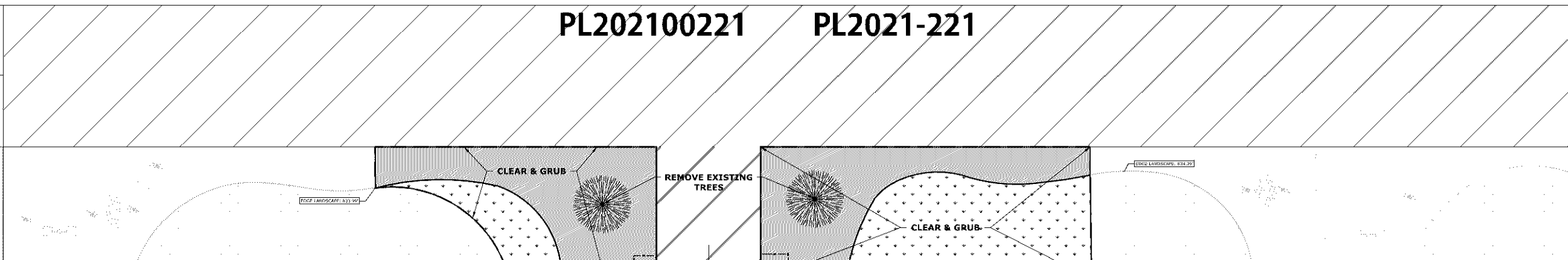



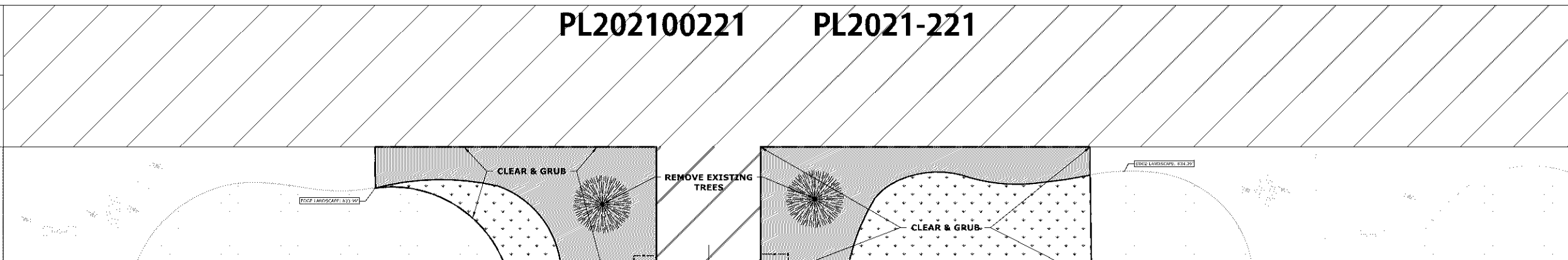



1. REMOVALS TO INCLUDE STOCKPILING, REMOVING AND PROPERLY DISPOSING OF MATERIALS AND WASTE IN ACCORDANCE WITH THE APPLICABLE RULES AND STATUTES OF THE STATE OF MINNESOTA AND ORDINANCES OF THE CITY OF BLOOMINGTON.
2. REMOVE EXISTING PAVEMENT SECTION, INCLUDING BASE. REMOVE SOFT OR UNSUITABLE MATERIALS BENEATH PAVEMENT, UP TO THREE FEET BELOW EXISTING GRADE. AREAS REQUIRING DEEPER EXCAVATION WILL BE DETERMINED AT TIME OF CONSTRUCTION.
3. AFTER CANOPY AND COLUMNS ARE REMOVED, REMOVE AND STOCKPILE BRICK PAVERS SURROUNDING COLUMNS IN ISLAND TO THE EXTENT REQUIRED TO BE ABLE TO REPLACE WITH LIKE MATERIAL AND UNBROKEN REPLACEMENT PAVING STONES.
4. CONTRACTOR TO REMOVE LARGE LIMESTONE ROCKS AT ENTRANCE AND TEMPORARILY STORE THEM IN THE FRONT PARKING AREA AS DESIGNATED BY OWNER. REPLACE AFTER ENTRY WAY CONSTRUCTION AND REPAIR OF IRRIGATION SYSTEM IS COMPLETED, AS DIRECTED BY THE OWNER OR THE OWNER'S LANDSCAPING CONTRACTOR.
5. REPLACE TREES AS NOTED ON SHEET C401.

[illegible]



LEGEND:

-  PROPOSED CONTOUR
-  EXISTING CONTOUR
-  BITUMINOUS PAVEMENT
-  CONCRETE
-  GRASS
-  MULCHED LANDSCAPING

- ## GRADING NOTES:
1. PLACE CLASS 5 BASE PER MNDOT STANDARD SPECIFICATION SECTION 3138 AS THE BASE COURSE.
 2. PLACE ENGINEERED FILL, INCLUDING THE BASE COURSE, AT +3/-1 PERCENTAGE POINTS OF OPTIMUM MOISTURE AND COMPACT TO 95% OF ITS STANDARD PROCTOR DENSITY (ASTM D 698).
 3. SUITABLE BACKFILL MATERIAL TO MEET PROPOSED SUBGRADE ELEVATION INCLUDES MINERAL SOILS FREE OF ORGANIC MATERIAL OR OTHER DELETERIOUS MATERIALS.
 4. SITE SOILS TO BE USED OR REUSED AS BACKFILL MUST BE WITHIN SPECIFIED MOISTURE CONTENTS AND COMPACTED TO 95% OF STANDARD PROCTOR DENSITY.
 5. PROOFROLL OR OTHERWISE VERIFY SUBGRADE FOR ACCEPTANCE PRIOR TO PLACING CLASS 5 BASE.
 6. DEWATERING MAY BE REQUIRED TO MAINTAIN A DRY EXCAVATION, ACCEPTABLE FOR PLACEMENT OF FILL MATERIAL. DO NOT PLACE FILL MATERIAL INTO STANDING WATER OR ONTO SOFT SUBGRADE SOILS.
 7. REFER TO SHEET C000 FOR GENERAL NOTES.

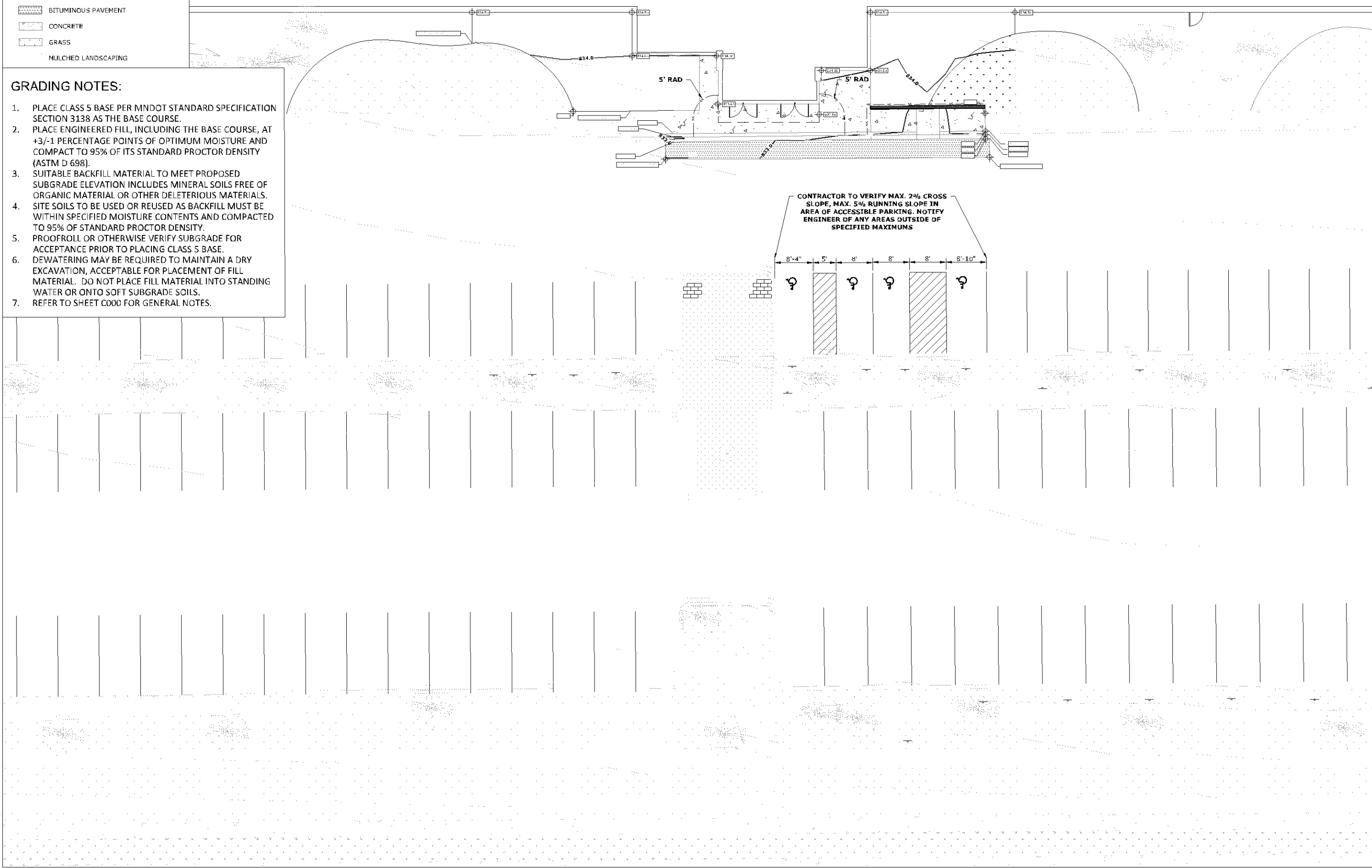

PL202100221 PL2021-221

[illegible]

ISSUED FOR REVIEW
NOT FOR CONSTRUCTION

**Pinnacle
Engineering**

11541 95th Ave N
Minneapolis, MN 55548
(763) 315-4501
www.pinnacle.com

DATE:	10/15/2021
DRAWN:	ASM
DESIGNED:	ASM
CHECKED:	BAK
APPROVED:	BAK

<p>PROJECT SITE PLAN THERMO KING BLOOMINGTON, MN</p>	<p>CLIENT </p>
--	--

DRAWING TITLE		DRAWING NO.
SITE GRADING PLAN SOUTH FACILITY ENTRANCE		
PROJECT NO.	IM20212664	C301
SCALE:	AS NOTED	

01020Feet

LEGEND:

BITUMINOUS PAVEMENT

CONCRETE

BRICK WALKWAY

GRASS

MULCHED LANDSCAPING

PROPOSED DRAINTILE

SIGN

TREE

PL202100221

PL2021-221

PAVING NOTES:

1.

CONCRETE WILL BE A STANDARD PORTLAND CEMENT MIX OF 4,000 PSI COMPRESSIVE STRENGTH AT 28 DAYS, SLUMP OF 4 INCHES +/- 1 INCH, AND AIR ENTRAINMENT OF 5 TO 8 PERCENT AT POINT OF DELIVERY FOR NOMINAL ¾-INCH MAXIMUM AGGREGATE SIZE. MIXES INCLUDING REPLACEMENT OF UP TO 25% OF THE PORTLAND CEMENT WITH FLYASH MAY BE USED. ONLY ONE MIX WILL BE USED FOR THE PROJECT. FURNISH BATCH TICKET INFORMATION.

2.

JOINTING: SIDEWALK JOINTS EVERY 5 FEET.

3.

FINISHING: BROOM FINISH AND ALLOW THE SURFACE WATER TO DISSIPATE COMPLETELY. PROTECT THE AREA FROM BLOWING DUST AND DEBRIS. APPLY TK-ONE STEP (TK PRODUCTS), ACRYLIC COPOLYMER/SILOXANE BLEND SEALANT, OR EQUAL, TO CURE AND SEAL CONCRETE AND PROTECT AGAINST SALT INTRUSION AND FREEZE/ THAW CYCLES.

SURFACE TREATMENT NOTES:

1.

REPLACE STOCKPILED LANDSCAPING ROCKS AS DIRECTED BY THE OWNER OR THE OWNER'S LANDSCAPING CONTRACTOR.

2.

MAINTAIN 9 FEET OF CLEAR SPACE FOR REPLACING TREES NEXT TO THE ENTRY. TREES WILL BE PLANTED DURING SPRING FOR BEST SURVIVAL RATES. SUPPLY AND PLANT B&B AMERICAN SENTRY LINDEN (TILIA AMERICANA 'MCKSENTRY') OR QUAKING ASPEN (POPULUS TREMULOIDES).

The diagram is a detailed site plan for a surface treatment project. It features a central paved area with various materials and dimensions. Key elements include:

- PAVING LAYOUT:** A central paved area with dimensions of 22'-8" and 48". It includes a "PROPOSED ROOF DRAIN CONNECTION" and "ASPHALT PAVING. SEE DETAIL 4 ON SHEET C501".
- RETAINING WALL:** A wall section with a "MAINTAIN MIN. 9' CLEARANCE (TYP)" and a note to "SEE DETAIL 1 & DETAIL 3 ON SHEET C501".
- BRICK PAVING:** A section labeled "INSTALL BRICK PAVERS THAT MATCH EXISTING IN LOCATION OF REMOVED CANOPY PILLARS" with dimensions of 8'-4", 5', 8', 8', 8', and 8'-10".
- LANDSCAPING:** Areas of "MULCHED LANDSCAPING" and "GRASS" are shown, along with "TREE" symbols and "PROPOSED DRAINTILE" lines.
- Handicap Stall:** A note to "REVISE HANDICAP STALL STRIPING AS SHOWN" points to a specific area.

1.

PLACE CLASS 5 BASE PER MNDOT STANDARD SPECIFICATION SECTION 3138 AS THE BASE COURSE.

2.

PLACE ENGINEERED FILL, INCLUDING THE BASE COURSE, AT +3/-1 PERCENTAGE POINTS OF OPTIMUM MOISTURE AND COMPACT TO 95% OF ITS STANDARD PROCTOR DENSITY (ASTM D 698).

3.

SUITABLE BACKFILL MATERIAL TO MEET PROPOSED SUBGRADE ELEVATION INCLUDES MINERAL SOILS FREE OF ORGANIC MATERIAL OR OTHER DELETERIOUS MATERIALS.

4.

SITE SOILS TO BE USED OR REUSED AS BACKFILL MUST BE WITHIN SPECIFIED MOISTURE CONTENTS AND COMPACTED TO 95% OF STANDARD PROCTOR DENSITY.

5.

PROOFROLL OR OTHERWISE VERIFY SUBGRADE FOR ACCEPTANCE PRIOR TO PLACING CLASS 5 BASE.

6.

DEWATERING MAY BE REQUIRED TO MAINTAIN A DRY EXCAVATION; ACCEPTABLE FOR PLACEMENT OF FILL MATERIAL. DO NOT PLACE FILL MATERIAL INTO STANDING WATER OR ONTO SOFT SUBGRADE SOILS.

7.

REFER TO SHEET C000 FOR GENERAL NOTES.

DATE: 10/15/2021

DRAWN: ASM

DESIGNED: ASM

CHECKED: BAK

APPROVED: BAK

PROJECT: SITE PLAN

CLIENT: THERMO KING BLOOMINGTON, MN

PROJECT NO.: IN20212854

DRAWING NO.: C401

SCALE: AS NOTED

ISSUED FOR REVIEW

NOT FOR CONSTRUCTION

Pinnacle Engineering

11541 95th Ave N

Minneapolis, MN 55569

(763) 315-4501

www.pine.ng.com

PL202100221

PL2021-221

DRAWING TITLE: SURFACE TREATMENT PLAN

DRAWING NO.: C401

PROJECT NO.: IN20212854

SCALE: AS NOTED

PROJECT: SITE PLAN

CLIENT: THERMO KING BLOOMINGTON, MN

PROJECT NO.: IN20212854

DRAWING NO.: C401

SCALE: AS NOTED

ISSUED FOR REVIEW

NOT FOR CONSTRUCTION

Pinnacle Engineering

11541 95th Ave N

Minneapolis, MN 55569

(763) 315-4501

www.pine.ng.com

PL202100221

PL2021-221

DRAWING TITLE: SURFACE TREATMENT PLAN

DRAWING NO.: C401

PROJECT NO.: IN20212854

SCALE: AS NOTED

PROJECT: SITE PLAN

CLIENT: THERMO KING BLOOMINGTON, MN

PROJECT NO.: IN20212854

DRAWING NO.: C401

SCALE: AS NOTED

ISSUED FOR REVIEW

NOT FOR CONSTRUCTION

Pinnacle Engineering

11541 95th Ave N

Minneapolis, MN 55569

(763) 315-4501

www.pine.ng.com

PL202100221

PL2021-221

DRAWING TITLE: SURFACE TREATMENT PLAN

DRAWING NO.: C401

PROJECT NO.: IN20212854

SCALE: AS NOTED

PROJECT: SITE PLAN

CLIENT: THERMO KING BLOOMINGTON, MN

PROJECT NO.: IN20212854

DRAWING NO.: C401

SCALE: AS NOTED

ISSUED FOR REVIEW

NOT FOR CONSTRUCTION

Pinnacle Engineering

11541 95th Ave N

Minneapolis, MN 55569

(763) 315-4501

www.pine.ng.com

PL202100221

PL2021-221

DRAWING TITLE: SURFACE TREATMENT PLAN

DRAWING NO.: C401

PROJECT NO.: IN20212854

SCALE: AS NOTED

PROJECT: SITE PLAN

CLIENT: THERMO KING BLOOMINGTON, MN

PROJECT NO.: IN20212854

DRAWING NO.: C401

SCALE: AS NOTED

ISSUED FOR REVIEW

NOT FOR CONSTRUCTION

Pinnacle Engineering

11541 95th Ave N

Minneapolis, MN 55569

(763) 315-4501

www.pine.ng.com

PL202100221

PL2021-221

DRAWING TITLE: SURFACE TREATMENT PLAN

DRAWING NO.: C401

PROJECT NO.: IN20212854

SCALE: AS NOTED

PROJECT: SITE PLAN

CLIENT: THERMO KING BLOOMINGTON, MN

PROJECT NO.: IN20212854

DRAWING NO.: C401

SCALE: AS NOTED

ISSUED FOR REVIEW

NOT FOR CONSTRUCTION

Pinnacle Engineering

11541 95th Ave N

Minneapolis, MN 55569

(763) 315-4501

www.pine.ng.com

PL202100221

PL2021-221

DRAWING TITLE: SURFACE TREATMENT PLAN

DRAWING NO.: C401

PROJECT NO.: IN20212854

SCALE: AS NOTED

PROJECT: SITE PLAN

CLIENT: THERMO KING BLOOMINGTON, MN

PROJECT NO.: IN20212854

DRAWING NO.: C401

SCALE: AS NOTED

ISSUED FOR REVIEW

NOT FOR CONSTRUCTION

Pinnacle Engineering

11541 95th Ave N

Minneapolis, MN 55569

(763) 315-4501

www.pine.ng.com

PL202100221

PL2021-221

DRAWING TITLE: SURFACE TREATMENT PLAN

DRAWING NO.: C401

PROJECT NO.: IN20212854

SCALE: AS NOTED

PROJECT: SITE PLAN

CLIENT: THERMO KING BLOOMINGTON, MN

PROJECT NO.: IN20212854

DRAWING NO.: C401

SCALE: AS NOTED

ISSUED FOR REVIEW

NOT FOR CONSTRUCTION

Pinnacle Engineering

11541 95th Ave N

Minneapolis, MN 55569

(763) 315-4501

www.pine.ng.com

PL202100221

PL2021-221

DRAWING TITLE: SURFACE TREATMENT PLAN

DRAWING NO.: C401

PROJECT NO.: IN20212854

SCALE: AS NOTED

PROJECT: SITE PLAN

CLIENT: THERMO KING BLOOMINGTON, MN

PROJECT NO.: IN20212854

DRAWING NO.: C401

SCALE: AS NOTED

ISSUED FOR REVIEW

NOT FOR CONSTRUCTION

Pinnacle Engineering

11541 95th Ave N

Minneapolis, MN 55569

(763) 315-4501

www.pine.ng.com

PL202100221

PL2021-221

DRAWING TITLE: SURFACE TREATMENT PLAN

DRAWING NO.: C401

PROJECT NO.: IN20212854

SCALE: AS NOTED

PROJECT: SITE PLAN

CLIENT: THERMO KING BLOOMINGTON, MN

PROJECT NO.: IN20212854

DRAWING NO.: C401

SCALE: AS NOTED

ISSUED FOR REVIEW

NOT FOR CONSTRUCTION

Pinnacle Engineering

11541 95th Ave N

Minneapolis, MN 55569

(763) 315-4501

www.pine.ng.com

PL202100221

PL2021-221

DRAWING TITLE: SURFACE TREATMENT PLAN

DRAWING NO.: C401

PROJECT NO.: IN20212854

SCALE: AS NOTED

PROJECT: SITE PLAN

CLIENT: THERMO KING BLOOMINGTON, MN

PROJECT NO.: IN20212854

DRAWING NO.: C401

SCALE: AS NOTED

ISSUED FOR REVIEW

NOT FOR CONSTRUCTION

Pinnacle Engineering

11541 95th Ave N

Minneapolis, MN 55569

(763) 315-4501

www.pine.ng.com

PL202100221

PL2021-221

DRAWING TITLE: SURFACE TREATMENT PLAN

DRAWING NO.: C401

PROJECT NO.: IN20212854

SCALE: AS NOTED

PROJECT: SITE PLAN

CLIENT: THERMO KING BLOOMINGTON, MN

PROJECT NO.: IN20212854

DRAWING NO.: C401

SCALE: AS NOTED

ISSUED FOR REVIEW

NOT FOR CONSTRUCTION

Pinnacle Engineering

11541 95th Ave N

Minneapolis, MN 55569

(763) 315-4501

www.pine.ng.com

PL202100221

PL2021-221

DRAWING TITLE: SURFACE TREATMENT PLAN

DRAWING NO.: C401

PROJECT NO.: IN20212854

SCALE: AS NOTED

PROJECT: SITE PLAN

CLIENT: THERMO KING BLOOMINGTON, MN

PROJECT NO.: IN20212854

DRAWING NO.: C401

SCALE: AS NOTED

ISSUED FOR REVIEW

NOT FOR CONSTRUCTION

Pinnacle Engineering

11541 95th Ave N

Minneapolis, MN 55569

(763) 315-4501

www.pine.ng.com

PL202100221

PL2021-221

DRAWING TITLE: SURFACE TREATMENT PLAN

DRAWING NO.: C401

PROJECT NO.: IN20212854

SCALE: AS NOTED

PROJECT: SITE PLAN

CLIENT: THERMO KING BLOOMINGTON, MN

PROJECT NO.: IN20212854

DRAWING NO.: C401

SCALE: AS NOTED

ISSUED FOR REVIEW

NOT FOR CONSTRUCTION

Pinnacle Engineering

11541 95th Ave N

Minneapolis, MN 55569

(763) 315-4501

www.pine.ng.com

PL202100221

PL2021-221

DRAWING TITLE: SURFACE TREATMENT PLAN

DRAWING NO.: C401

PROJECT NO.: IN20212854

SCALE: AS NOTED

PROJECT: SITE PLAN

CLIENT: THERMO KING BLOOMINGTON, MN

PROJECT NO.: IN20212854

DRAWING NO.: C401

SCALE: AS NOTED

ISSUED FOR REVIEW

NOT FOR CONSTRUCTION

Pinnacle Engineering

11541 95th Ave N

Minneapolis, MN 55569

(763) 315-4501

www.pine.ng.com

PL202100221

PL2021-221

DRAWING TITLE: SURFACE TREATMENT PLAN

DRAWING NO.: C401

PROJECT NO.: IN20212854

SCALE: AS NOTED

PROJECT: SITE PLAN

CLIENT: THERMO KING BLOOMINGTON, MN

PROJECT NO.: IN20212854

DRAWING NO.: C401

SCALE: AS NOTED

ISSUED FOR REVIEW

NOT FOR CONSTRUCTION

Pinnacle Engineering

11541 95th Ave N

Minneapolis, MN 55569

(763) 315-4501

www.pine.ng.com

PL202100221

PL2021-221

DRAWING TITLE: SURFACE TREATMENT PLAN

DRAWING NO.: C401

PROJECT NO.: IN20212854

SCALE: AS NOTED

PROJECT: SITE PLAN

CLIENT: THERMO KING BLOOMINGTON, MN

PROJECT NO.: IN20212854

DRAWING NO.: C401

SCALE: AS NOTED

ISSUED FOR REVIEW

NOT FOR CONSTRUCTION

Pinnacle Engineering

11541 95th Ave N

Minneapolis, MN 55569

(763) 315-4501

www.pine.ng.com

PL202100221

PL2021-221

DRAWING TITLE: SURFACE TREATMENT PLAN

DRAWING NO.: C401

PROJECT NO.: IN20212854

SCALE: AS NOTED

PROJECT: SITE PLAN

CLIENT: THERMO KING BLOOMINGTON, MN

PROJECT NO.: IN20212854

DRAWING NO.: C401

SCALE: AS NOTED

ISSUED FOR REVIEW

NOT FOR CONSTRUCTION

Pinnacle Engineering

11541 95th Ave N

Minneapolis, MN 55569

(763) 315-4501

www.pine.ng.com

PL202100221

PL2021-221

DRAWING TITLE: SURFACE TREATMENT PLAN

DRAWING NO.: C401

PROJECT NO.: IN20212854

SCALE: AS NOTED

PROJECT: SITE PLAN

CLIENT: THERMO KING BLOOMINGTON, MN

PROJECT NO.: IN20212854

DRAWING NO.: C401

SCALE: AS NOTED

ISSUED FOR REVIEW

NOT FOR CONSTRUCTION

Pinnacle Engineering

11541 95th Ave N

Minneapolis, MN 55569

(763) 315-4501

www.pine.ng.com

PL202100221

PL2021-221

DRAWING TITLE: SURFACE TREATMENT PLAN

DRAWING NO.: C401

PROJECT NO.: IN20212854

SCALE: AS NOTED

PROJECT: SITE PLAN

CLIENT: THERMO KING BLOOMINGTON, MN

PROJECT NO.: IN20212854

DRAWING NO.: C401

SCALE: AS NOTED

ISSUED FOR REVIEW

NOT FOR CONSTRUCTION

Pinnacle Engineering

11541 95th Ave N

Minneapolis, MN 55569

(763) 315-4501

www.pine.ng.com

PL202100221

PL2021-221

DRAWING TITLE: SURFACE TREATMENT PLAN

DRAWING NO.: C401

PROJECT NO.: IN20212854

SCALE: AS NOTED

PROJECT: SITE PLAN

CLIENT: THERMO KING BLOOMINGTON, MN

PROJECT NO.: IN20212854

DRAWING NO.: C401

SCALE: AS NOTED

ISSUED FOR REVIEW

NOT FOR CONSTRUCTION

Pinnacle Engineering

11541 95th Ave N

Minneapolis, MN 55569

(763) 315-4501

www.pine.ng.com

PL202100221

PL2021-221

DRAWING TITLE: SURFACE TREATMENT PLAN

DRAWING NO.: C401

PROJECT NO.: IN20212854

SCALE: AS NOTED

PROJECT: SITE PLAN

CLIENT: THERMO KING BLOOMINGTON, MN

PROJECT NO.: IN20212854

DRAWING NO.: C401

SCALE: AS NOTED

ISSUED FOR REVIEW

NOT FOR CONSTRUCTION

Pinnacle Engineering

11541 95th Ave N

Minneapolis, MN 55569

(763) 315-4501

www.pine.ng.com

PL202100221

PL2021-221

DRAWING TITLE: SURFACE TREATMENT PLAN

DRAWING NO.: C401

PROJECT NO.: IN20212854

SCALE: AS NOTED

PROJECT: SITE PLAN

CLIENT: THERMO KING BLOOMINGTON, MN

PROJECT NO.: IN20212854

DRAWING NO.: C401

SCALE: AS NOTED

ISSUED FOR REVIEW

NOT FOR CONSTRUCTION

Pinnacle Engineering

11541 95th Ave N

Minneapolis, MN 55569

(763) 315-4501

www.pine.ng.com

PL202100221

PL2021-221

DRAWING TITLE: SURFACE TREATMENT PLAN

DRAWING NO.: C401

PROJECT NO.: IN20212854

SCALE: AS NOTED

PROJECT: SITE PLAN

CLIENT: THERMO KING BLOOMINGTON, MN

PROJECT NO.: IN20212854

DRAWING NO.: C401

SCALE: AS NOTED

ISSUED FOR REVIEW

NOT FOR CONSTRUCTION

Pinnacle Engineering

11541 95th Ave N

Minneapolis, MN 55569

(763) 315-4501

www.pine.ng.com

PL202100221

PL2021-221

DRAWING TITLE: SURFACE TREATMENT PLAN

DRAWING NO.: C401

PROJECT NO.: IN20212854

SCALE: AS NOTED

PROJECT: SITE PLAN

CLIENT: THERMO KING BLOOMINGTON, MN

PROJECT NO.: IN20212854

DRAWING NO.: C401

SCALE: AS NOTED

ISSUED FOR REVIEW

NOT FOR CONSTRUCTION

Pinnacle Engineering

11541 95th Ave N

Minneapolis, MN 55569

(763) 315-4501

www.pine.ng.com

PL202100221

PL2021-221

DRAWING TITLE: SURFACE TREATMENT PLAN

DRAWING NO.: C401

PROJECT NO.: IN20212854

SCALE: AS NOTED

PROJECT: SITE PLAN

CLIENT: THERMO KING BLOOMINGTON, MN

PROJECT NO.: IN20212854

DRAWING NO.: C401

SCALE: AS NOTED

ISSUED FOR REVIEW

NOT FOR CONSTRUCTION

Pinnacle Engineering

11541 95th Ave N

Minneapolis, MN 55569

(763) 315-4501

www.pine.ng.com

PL202100221

PL2021-221

DRAWING TITLE: SURFACE TREATMENT PLAN

DRAWING NO.: C401

PROJECT NO.: IN20212854

SCALE: AS NOTED

PROJECT: SITE PLAN

CLIENT: THERMO KING BLOOMINGTON, MN

PROJECT NO.: IN20212854

DRAWING NO.: C401

SCALE: AS NOTED

ISSUED FOR REVIEW

NOT FOR CONSTRUCTION

Pinnacle Engineering

11541 95th Ave N

Minneapolis, MN 55569

(763) 315-4501

www.pine.ng.com

PL202100221

PL2021-221

DRAWING TITLE: SURFACE TREATMENT PLAN

DRAWING NO.: C401

PROJECT NO.: IN20212854

SCALE: AS NOTED

PROJECT: SITE PLAN

CLIENT: THERMO KING BLOOMINGTON, MN

PROJECT NO.: IN20212854

DRAWING NO.: C401

SCALE: AS NOTED

ISSUED FOR REVIEW

NOT FOR CONSTRUCTION

Pinnacle Engineering

11541 95th Ave N

Minneapolis, MN 55569

(763) 315-4501

www.pine.ng.com

PL202100221

PL2021-221

DRAWING TITLE: SURFACE TREATMENT PLAN

DRAWING NO.: C401

PROJECT NO.: IN20212854

SCALE: AS NOTED

PROJECT: SITE PLAN

CLIENT: THERMO KING BLOOMINGTON, MN

PROJECT NO.: IN20212854

DRAWING NO.: C401

SCALE: AS NOTED

ISSUED FOR REVIEW

NOT FOR CONSTRUCTION

Pinnacle Engineering

11541 95th Ave N

Minneapolis, MN 55569

(763) 315-4501

www.pine.ng.com

PL202100221

PL2021-221

DRAWING TITLE: SURFACE TREATMENT PLAN

DRAWING NO.: C401

PROJECT NO.: IN20212854

SCALE: AS NOTED

PROJECT: SITE PLAN

CLIENT: THERMO KING BLOOMINGTON, MN

PROJECT NO.: IN20212854

DRAWING NO.: C401

SCALE: AS NOTED

ISSUED FOR REVIEW

NOT FOR CONSTRUCTION

Pinnacle Engineering

11541 95th Ave N

Minneapolis, MN 55569

(763) 315-4501

www.pine.ng.com

PL202100221

PL2021-221

DRAWING TITLE: SURFACE TREATMENT PLAN

DRAWING NO.: C401

PROJECT NO.: IN20212854

SCALE: AS NOTED

PROJECT: SITE PLAN

CLIENT: THERMO KING BLOOMINGTON, MN

PROJECT NO.: IN20212854

DRAWING NO.: C401

SCALE: AS NOTED

ISSUED FOR REVIEW

NOT FOR CONSTRUCTION

Pinnacle Engineering

11541 95th Ave N

Minneapolis, MN 55569

(763) 315-4501

www.pine.ng.com

PL202100221

PL2021-221

DRAWING TITLE: SURFACE TREATMENT PLAN

DRAWING NO.: C401

PROJECT NO.: IN20212854

SCALE: AS NOTED

PROJECT: SITE PLAN

CLIENT: THERMO KING BLOOMINGTON, MN

PROJECT NO.: IN20212854

DRAWING NO.: C401

SCALE: AS NOTED

ISSUED FOR REVIEW

NOT FOR CONSTRUCTION

Pinnacle Engineering

11541 95th Ave N

Minneapolis, MN 55569

(763) 315-4501

www.pine.ng.com

PL202100221

PL2021-221

DRAWING TITLE: SURFACE TREATMENT PLAN

DRAWING NO.: C401

PROJECT NO.: IN20212854

SCALE: AS NOTED

PROJECT: SITE PLAN

CLIENT: THERMO KING BLOOMINGTON, MN

PROJECT NO.: IN20212854

DRAWING NO.: C401

SCALE: AS NOTED

ISSUED FOR REVIEW

NOT FOR CONSTRUCTION

Pinnacle Engineering

11541 95th Ave N

Minneapolis, MN 55569

(763) 315-4501

www.pine.ng.com

PL202100221

PL2021-221

DRAWING TITLE: SURFACE TREATMENT PLAN

DRAWING NO.: C401

PROJECT NO.: IN20212854

SCALE: AS NOTED

PROJECT: SITE PLAN

CLIENT: THERMO KING BLOOMINGTON, MN

PROJECT NO.: IN20212854

DRAWING NO.: C401

SCALE: AS NOTED

ISSUED FOR REVIEW

NOT FOR CONSTRUCTION

Pinnacle Engineering

11541 95th Ave N

Minneapolis, MN 55569

(763) 315-4501

www.pine.ng.com

PL202100221

PL2021-221

DRAWING TITLE: SURFACE TREATMENT PLAN

DRAWING NO.: C401

PROJECT NO.: IN20212854

SCALE: AS NOTED

PROJECT: SITE PLAN

CLIENT: THERMO KING BLOOMINGTON, MN

PROJECT NO.: IN20212854

DRAWING NO.: C401

SCALE: AS NOTED

ISSUED FOR REVIEW

NOT FOR CONSTRUCTION

Pinnacle Engineering

11541 95th Ave N

Minneapolis, MN 55569

(763) 315-4501

www.pine.ng.com

PL202100221

PL2021-221

DRAWING TITLE: SURFACE TREATMENT PLAN

DRAWING NO.: C401

PROJECT NO.: IN20212854

SCALE: AS NOTED

PROJECT: SITE PLAN

CLIENT: THERMO KING BLOOMINGTON, MN

PROJECT NO.: IN20212854

DRAWING NO.: C401

SCALE: AS NOTED

ISSUED FOR REVIEW

NOT FOR CONSTRUCTION

Pinnacle Engineering

11541 95th Ave N

Minneapolis, MN 55569

(763) 315-4501

www.pine.ng.com

PL202100221

PL2021-221

DRAWING TITLE: SURFACE TREATMENT PLAN

DRAWING NO.: C401

PROJECT NO.: IN20212854

SCALE: AS NOTED

PROJECT: SITE PLAN

CLIENT: THERMO KING BLOOMINGTON, MN

PROJECT NO.: IN20212854

DRAWING NO.: C401

SCALE: AS NOTED

ISSUED FOR REVIEW

NOT FOR CONSTRUCTION

Pinnacle Engineering

11541 95th Ave N

Minneapolis, MN 55569

(763) 315-4501

www.pine.ng.com

PL202100221

PL2021-221

DRAWING TITLE: SURFACE TREATMENT PLAN

DRAWING NO.: C401

PROJECT NO.: IN20212854

SCALE: AS NOTED

PROJECT: SITE PLAN

CLIENT: THERMO KING BLOOMINGTON, MN

PROJECT NO.: IN20212854

DRAWING NO.: C401

SCALE: AS NOTED

ISSUED FOR REVIEW

NOT FOR CONSTRUCTION

Pinnacle Engineering

11541 95th Ave N

Minneapolis, MN 55569

(763) 315-4501

www.pine.ng.com

PL202100221

PL2021-221

DRAWING TITLE: SURFACE TREATMENT PLAN

DRAWING NO.: C401

PROJECT NO.: IN20212854

SCALE: AS NOTED

PROJECT: SITE PLAN

CLIENT: THERMO KING BLOOMINGTON, MN

PROJECT NO.: IN20212854

DRAWING NO.: C401

SCALE: AS NOTED

ISSUED FOR REVIEW

NOT FOR CONSTRUCTION

Pinnacle Engineering

11541 95th Ave N

Minneapolis, MN 55569

(763) 315-4501

www.pine.ng.com

PL202100221

PL2021-221

DRAWING TITLE: SURFACE TREATMENT PLAN

DRAWING NO.: C401

PROJECT NO.: IN20212854

SCALE: AS NOTED

PROJECT: SITE PLAN

CLIENT: THERMO KING BLOOMINGTON, MN

PROJECT NO.: IN20212854

DRAWING NO.: C401

SCALE: AS NOTED

ISSUED FOR REVIEW

NOT FOR CONSTRUCTION

Pinnacle Engineering

11541 95th Ave N

Minneapolis, MN 55569

(763) 315-4501

www.pine.ng.com

PL202100221

PL2021-221

DRAWING TITLE: SURFACE TREATMENT PLAN

DRAWING NO.: C401

PROJECT NO.: IN20212854

SCALE: AS NOTED

PROJECT: SITE PLAN

CLIENT: THERMO KING BLOOMINGTON, MN

PROJECT NO.: IN20212854

DRAWING NO.: C401

SCALE: AS NOTED

ISSUED FOR REVIEW

NOT FOR CONSTRUCTION

Pinnacle Engineering

11541 95th Ave N

Minneapolis, MN 55569

(763) 315-4501

www.pine.ng.com

PL202100221

PL2021-221

DRAWING TITLE: SURFACE TREATMENT PLAN

DRAWING NO.: C401

PROJECT NO.: IN20212854

SCALE: AS NOTED

PROJECT: SITE PLAN

CLIENT: THERMO KING BLOOMINGTON, MN

PROJECT NO.: IN20212854

DRAWING NO.: C401

SCALE: AS NOTED

ISSUED FOR REVIEW

NOT FOR CONSTRUCTION

Pinnacle Engineering

11541 95th Ave N

Minneapolis, MN 55569

(763) 315-4501

www.pine.ng.com

PL202100221

PL2021-221

DRAWING TITLE: SURFACE TREATMENT PLAN

DRAWING NO.: C401

PROJECT NO.: IN20212854

SCALE: AS NOTED

PROJECT: SITE PLAN

CLIENT: THERMO KING BLOOMINGTON, MN

PROJECT NO.: IN20212854

DRAWING NO.: C401

SCALE: AS NOTED

ISSUED FOR REVIEW

NOT FOR CONSTRUCTION

Pinnacle Engineering

11541 95th Ave N

Minneapolis, MN 55569

(763) 315-4501

www.pine.ng.com

PL202100221

PL2021-221

DRAWING TITLE: SURFACE TREATMENT PLAN

DRAWING NO.: C401

PROJECT NO.: IN20212854

SCALE: AS NOTED

PROJECT: SITE PLAN

CLIENT: THERMO KING BLOOMINGTON, MN