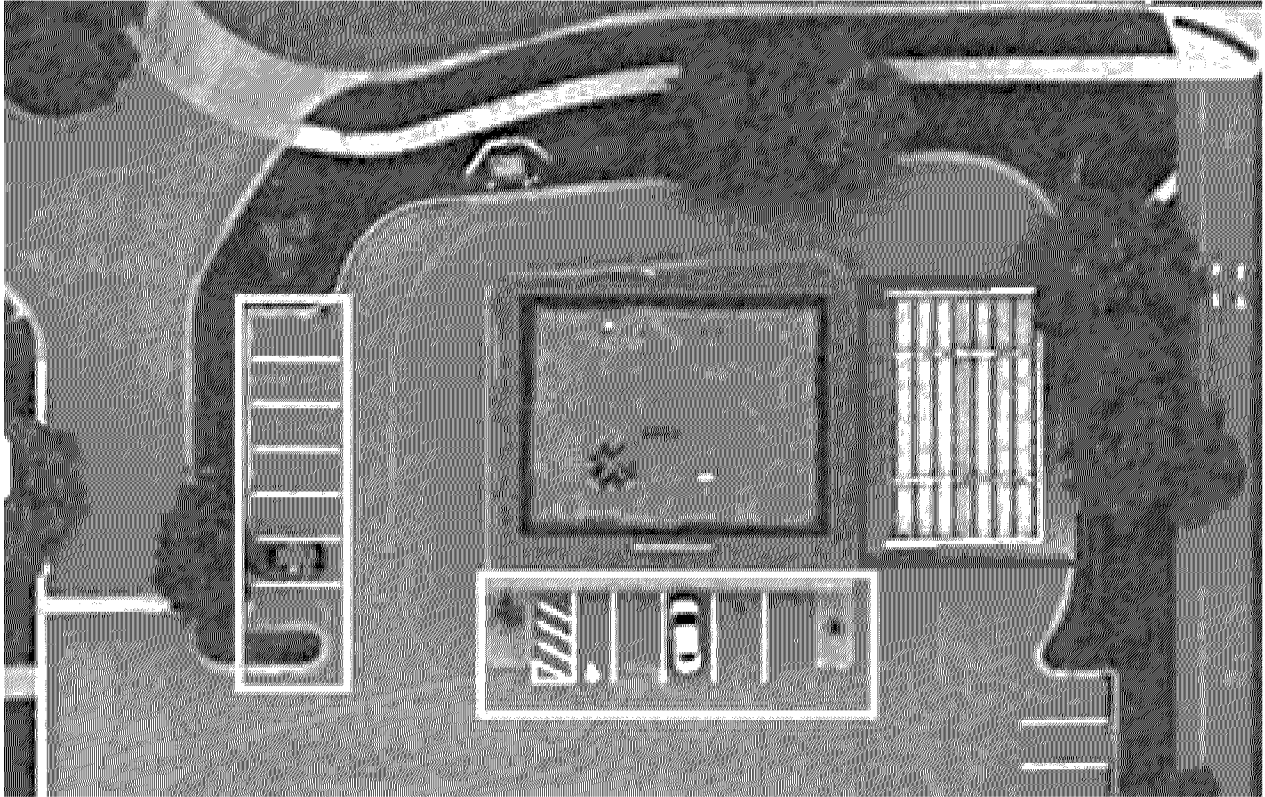

**EXHIBIT B
TENANT PARKING AREA**



The parking spaces outlined in yellow shall be designated solely for Tenant's use.

Tenant, at its discretion, may have the ability to add additional designated parking spaces and/or drop-off/pick-up lanes in the area outlined in red.

- The fuel tanks and canopy will be removed.
- A floorplan would be completed by the Vet user later.
- The primary and secondary entrances will just be the existing entrances.

Name

Date
EXHIBIT A
PREMISES

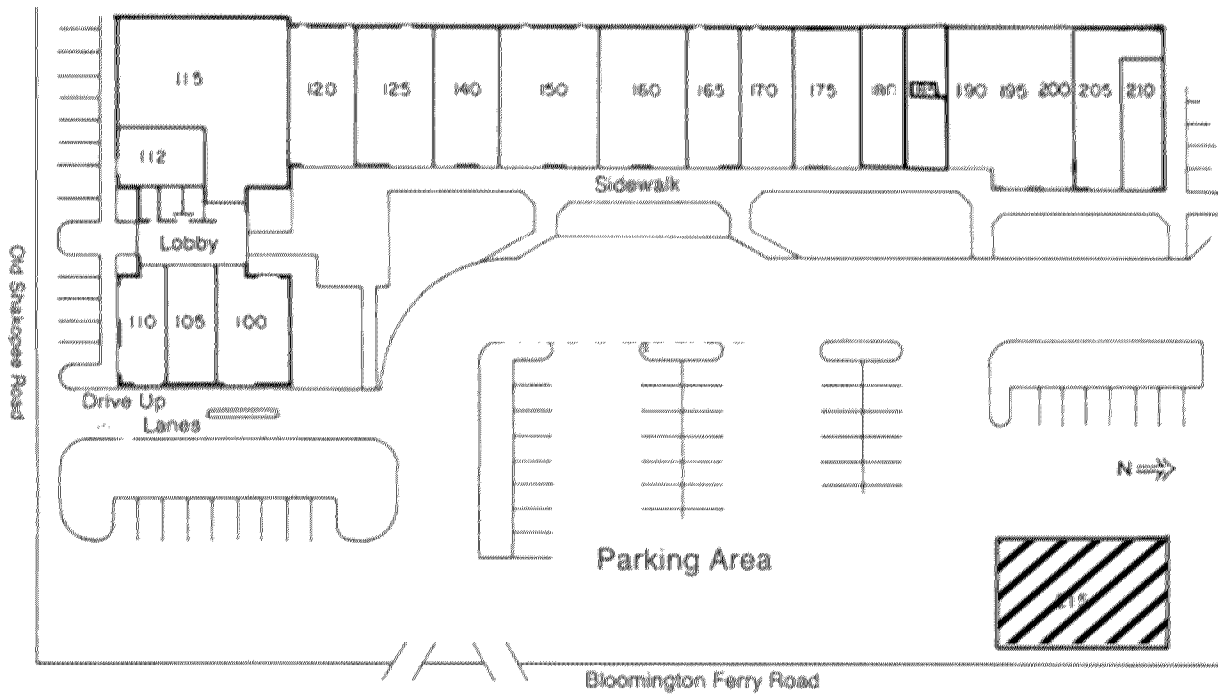

Hashmarked area represents the Premises.