

Emergency responder radio coverage meeting the requirements of appendix P in the 2020 MSFC shall be provided throughout the property and within the structures.

All exterior doors that allow access to the interior of the building(s) shall be numbered in a sequential order starting with the main entrance (public entrance) as number 1 and continue in a clockwise manner.

Provide updated inventory of hazardous materials, locations and protection engineer analysis of remodeling areas for code compliance.

PL2023-76
PL202300076

| | | | |
|--|-----------|--|---------|
| | PHASE 1.1 | | PHASE 2 |
| | PHASE 1.2 | | PHASE 3 |
| | PHASE 1.3 | | PHASE 4 |

This document may be an electronic file or may be printed from an electronic file. It is not to be used for construction. The user of this document is responsible for its use. The user of this document is responsible for its use. The user of this document is responsible for its use.

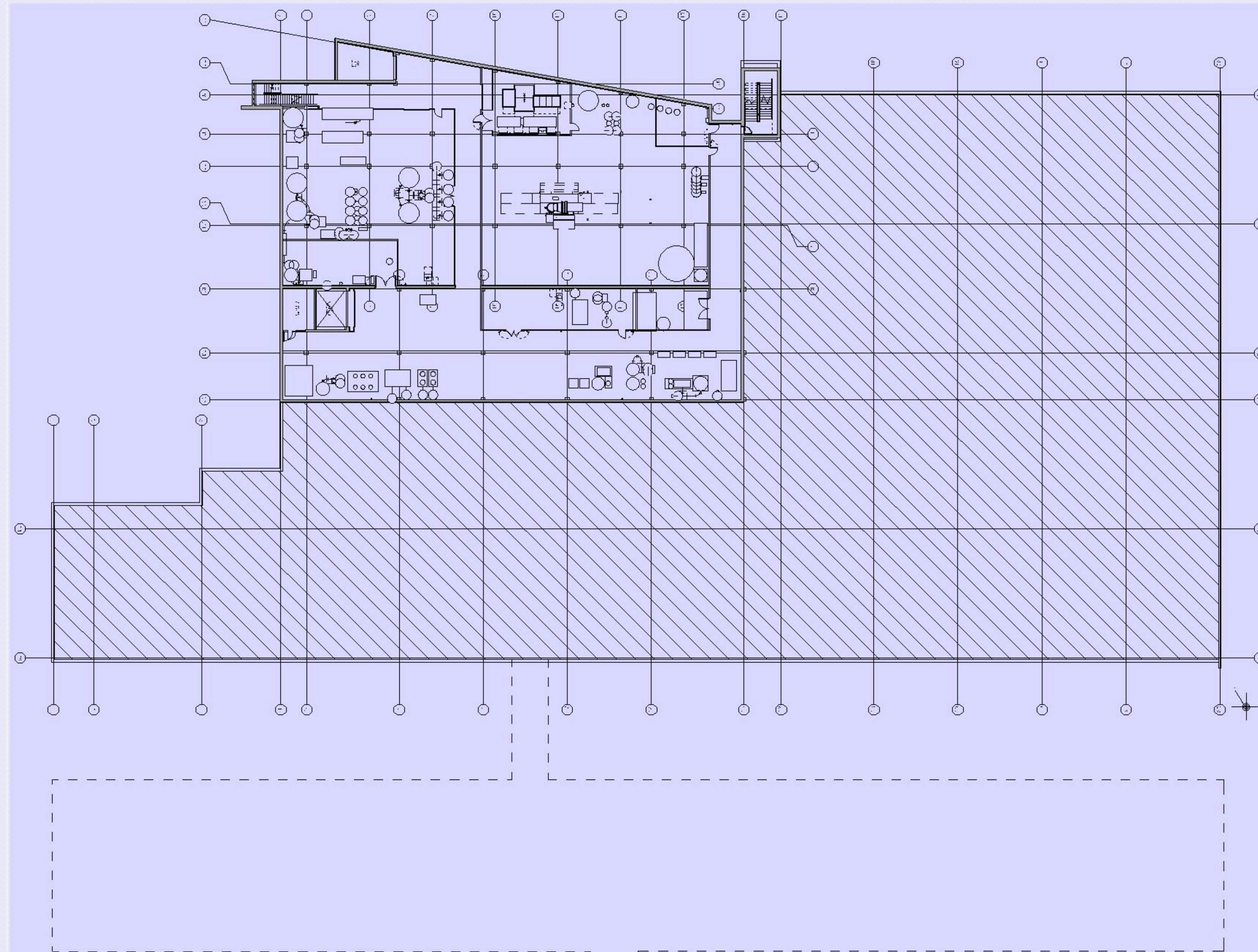

PHASE 2 P1-N-
LOWER LEVEL

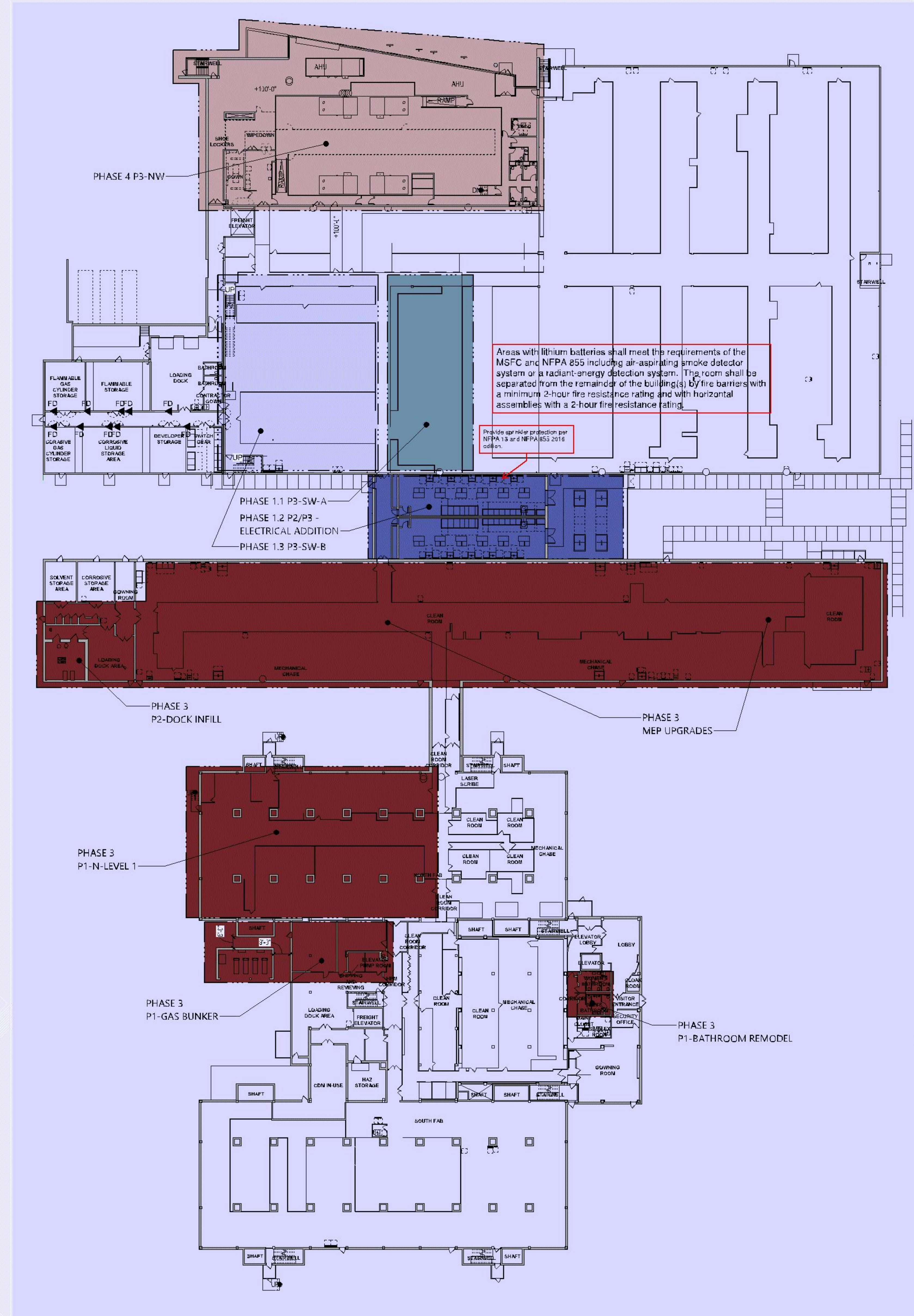
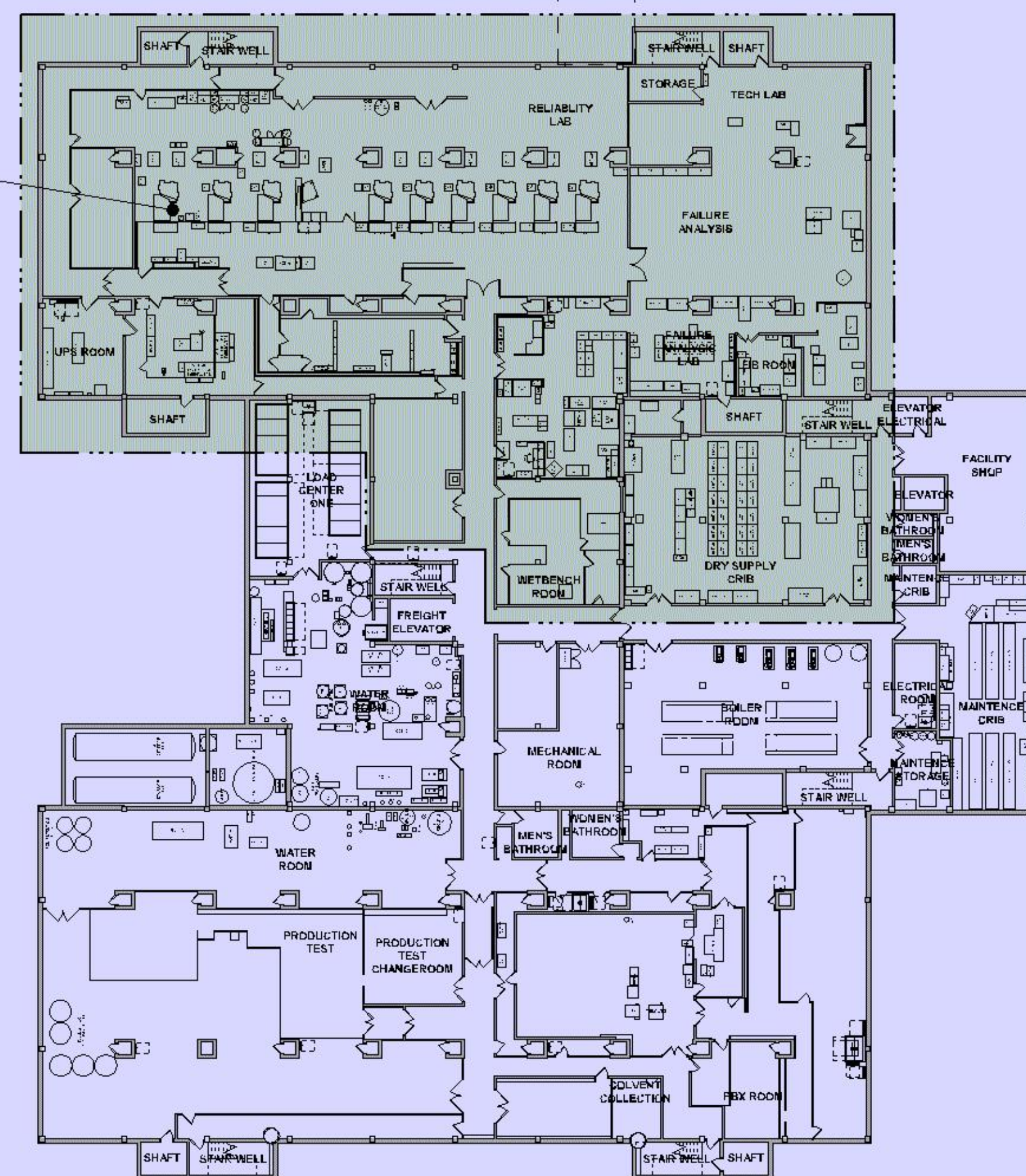

Areas with lithium batteries shall meet the requirements of the MSFC and NFPA 655 including air-pressurized smoke detector system or a radiant-energy detection system. The room shall be separated from the remainder of the building(s) by fire barriers with a minimum 2-hour fire resistance rating and with horizontal assemblies with a 2-hour fire resistance rating.

Provides per NFPA 655 production per NFPA 13 and NFPA 653 2016

Issued For: _____
Date: _____
SD ISSUE: 04/24/2023

**NOT FOR
CONSTRUCTION
FOR REFERENCE ONLY**

This is not to be a Record Copy. The user of this document is responsible for its use. The user of this document is responsible for its use.

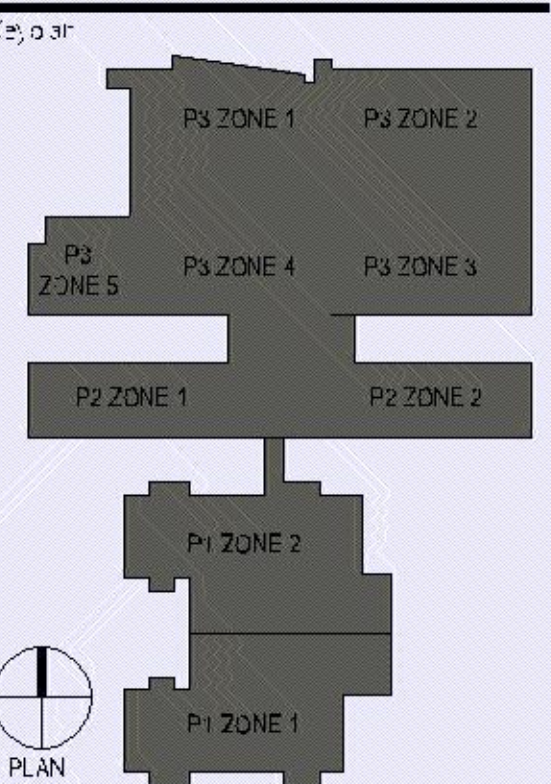

PLAN NORTH
DWG: P.2300079.00
Date: _____
Author: _____

SCOPE PLANS

PL2023-76
PL202300076



CLEANROOM
REMODEL

B | W | B | R

380 St. Peter Street, Ste. 600
Saint Paul, MN 55102
651.222.3761
bwbr.com

Consultants:

This document may be an electronic file or may be printed from an electronic file provided to the user. It is the sole responsibility of the user to ensure that the content and quality of the original documents on file at BWBR.

Issued For:

Item: _____ Date: _____

**NOT FOR
CONSTRUCTION**

This Sheet may be a Reduced Copy. The bar above is 1" long on a Full Size Sheet. Drawing Scales apply to Full Size Sheets.

Keyplan:

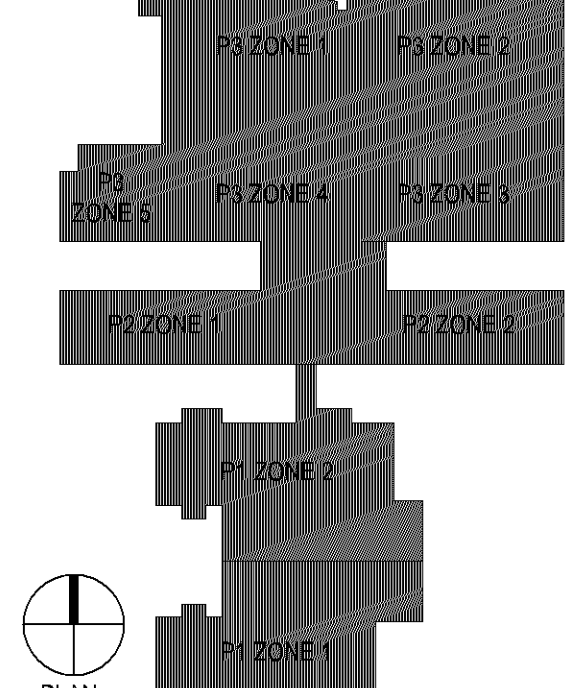

PLAN NORTH

BWBR Comm. No. _____ Drawn _____

P.2300079.00

Sheet Title:

ARCHITECTURAL SITE PLAN

Sheet No. _____

Sheet No. _____

3.200.AS

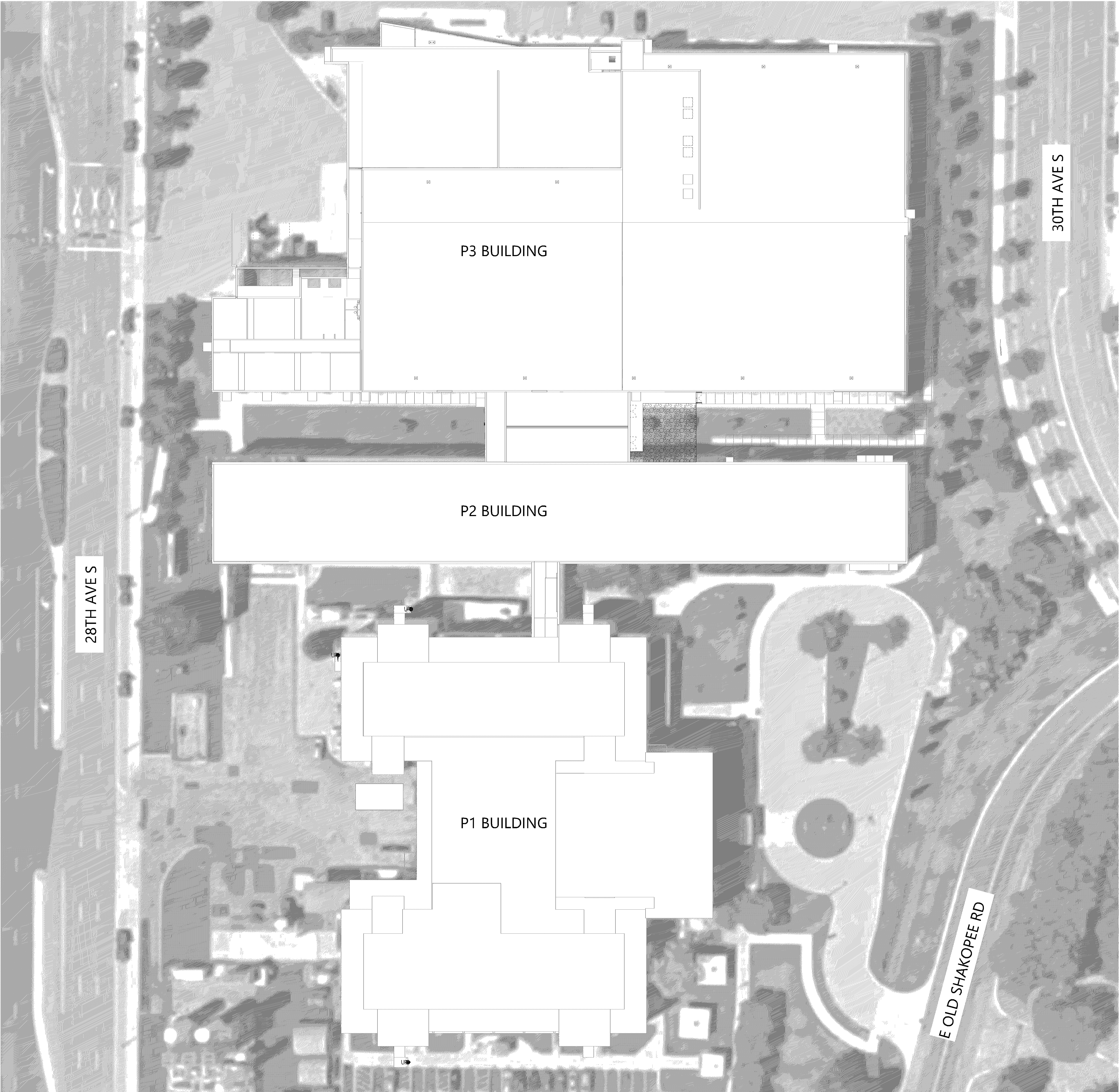

1 SITE PLAN
1/20/23 1" = 30'-0"