

SURVEY FOR: DAVID CARLSON CO. INC.

PL202300071
PL2023-71

60589.060 518L. 57

Prepared By:

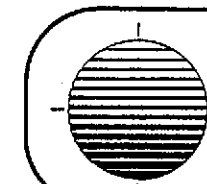

SCHOELL & MADSON, INC.
ENGINEERS • SURVEYORS • PLANNERS
SOIL TESTING • ENVIRONMENTAL SERVICES
10580 WAYZATA BLVD.
MINNETONKA, MN. 55343
(612) 548-7801 FAX: 548-9085

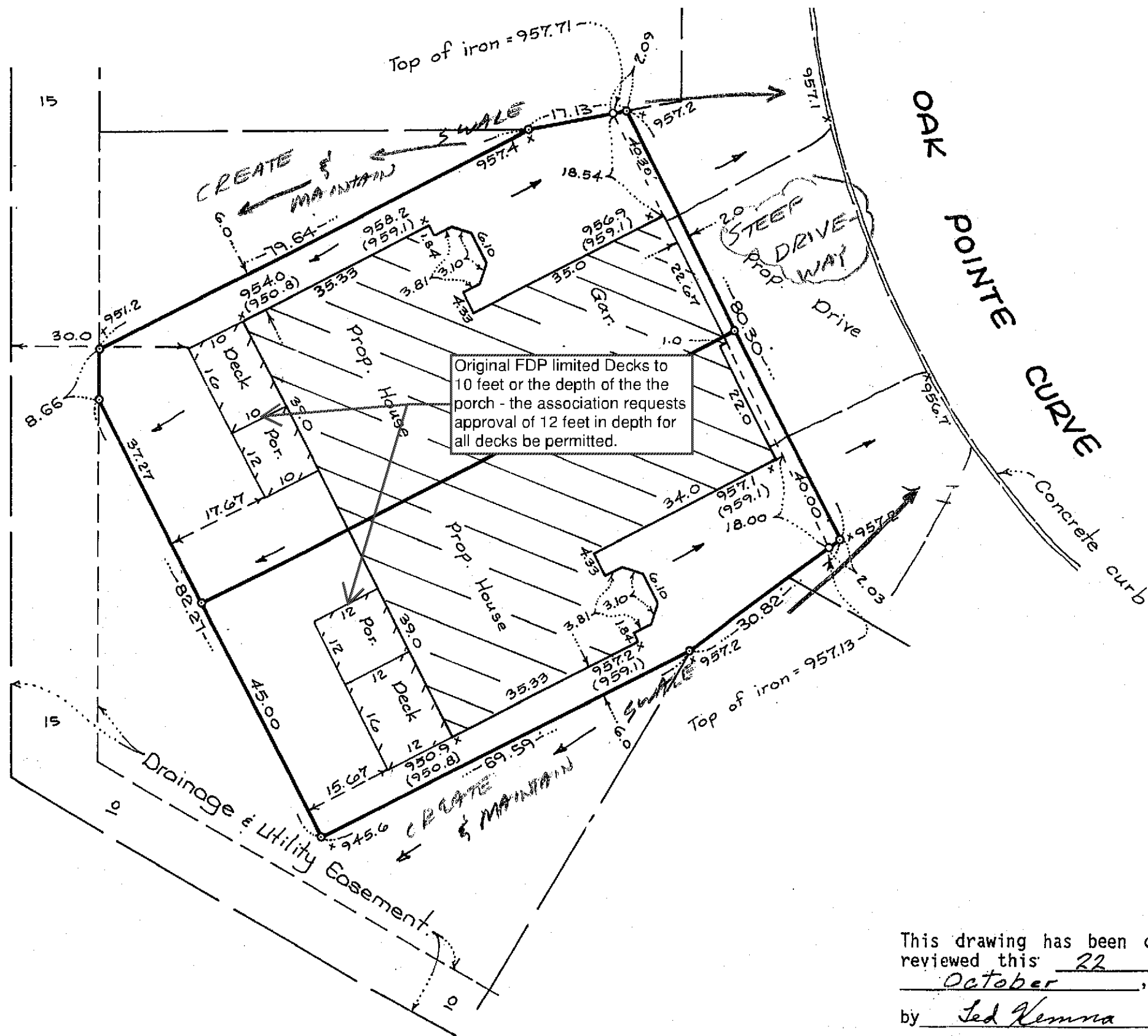

DESCRIPTION: 7201 + 7203 OAK POINTE CRV.

Lots 32 and 33, Block 1, OAK POINTE 2ND ADDITION.

BENCHMARK:

Top of iron monument as shown. Elevation = 957.71
(NGVD-1929).

GENERAL NOTES:

1. o - Denotes iron monument.
2. □ - Denotes wood stake.
3. x950.1 - Denotes existing spot elevation.
4. x(951.3) - Denotes proposed spot elevation.
5. ↗ - Denotes direction of surface drainage.
6. Proposed garage floor elevation = 959.1
7. Proposed top of foundation elevation = 959.4
8. Proposed lowest floor elevation = 950.8
9. Type of home is a walkout

This drawing has been checked and
reviewed this 22 day of
October, 19 92,
by Led Kemna

I hereby certify that this survey was
prepared under my supervision and that
I am a Licensed Land Surveyor under the
laws of the State of Minnesota.

Theodore D. Kemna
Theodore D. Kemna

Date: Oct. 20, 1992 License No. 17006

SURVEY FOR: DAVID CARLSON CO. INC.

PL202300071
PL2023-71

60589.060 518L.75

Prepared By:

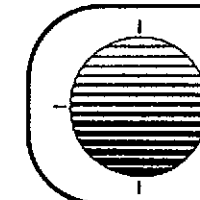

SCHOELL & MADSON, INC.
ENGINEERS • SURVEYORS • PLANNERS
SOIL TESTING • ENVIRONMENTAL SERVICES
10580 WAYZATA BLVD.
MINNETONKA, MN. 55343
(612) 546-7601 FAX: 546-9065

Original FDP limited Decks to 10 feet or the depth of the porch - the association requests approval of 12 feet in depth for all decks be permitted.

DESCRIPTION:

Lots 3 and 4, Block 1, OAK POINTE 2ND ADDITION.

BENCHMARK:

Top of iron monument as shown. Elevation = 952.33 (NGVD-1929).

GENERAL NOTES:

1. o - Denotes iron monument.
2. □ - Denotes wood stake.
3. x951.3 - Denotes existing spot elevation.
4. x(952.1) - Denotes proposed spot elevation.
5. ↗ - Denotes direction of surface drainage.
6. Proposed garage floor elevation = 953.3
7. Proposed top of foundation elevation = 953.6
8. Proposed lowest floor elevation = 945.0
9. Type of home is a walkout
10. Rev. 3-10-93 Swale & Top of foundation

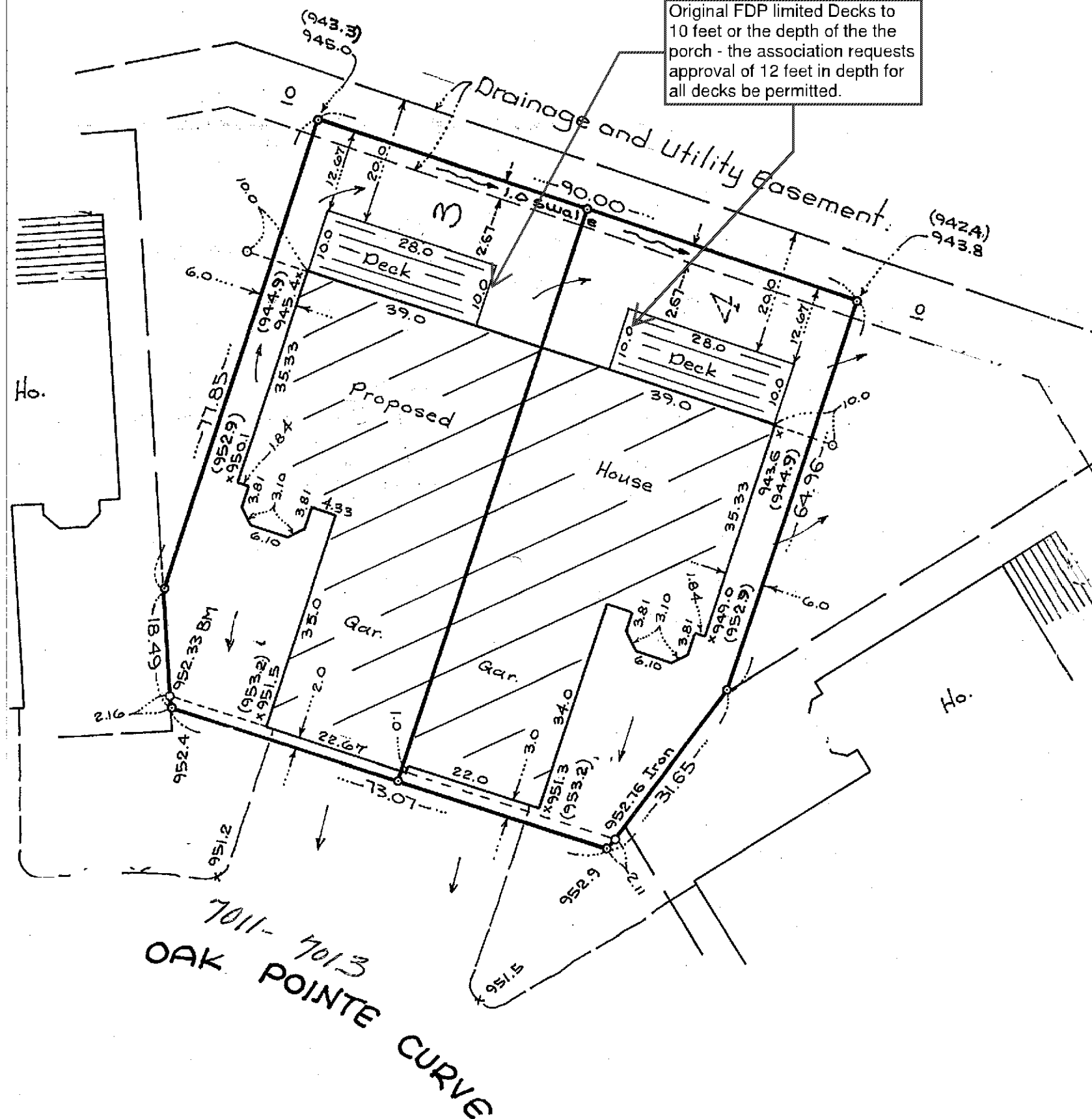

This drawing has been checked and reviewed this 9th day of March, 1993,

by Ed Kemna

I hereby certify that this survey was prepared under my supervision and that I am a Licensed Land Surveyor under the laws of the State of Minnesota.

Theodore D. Kemna
Theodore D. Kemna

Date: Mar. 8, 1993 License No. 17006

1.011

CREATE & MAINTAIN EMERGENCY OVERFLOW SURVE
(WITH MAX $\frac{30.5}{\text{GROUNDING PLAN}}$ ELEV. 950.5 PER APPROVED)

(951)
ELEV. 950

SCHOELL & MADSON, INC.
ENGINEERS • SURVEYORS • PLANNERS
SOIL TESTING • ENVIRONMENTAL SERVICES
10580 WAYZATA BLVD.
MINNETONKA, MN. 55343
(812) 548-7801 FAX: 548-9085



OAK POINTE CURVE

Lots 48 and 49, Block 1, OAK POINTE 2ND ADDITION.

Top of iron monument as shown. Elevation = 951.66
(NGVD-1929).

1. o - Denotes iron monument.
2. □ - Denotes wood stake.
3. x 951.3 - Denotes existing spot elevation.
4. x(949.9) - Denotes proposed spot elevation.
5. ← - Denotes direction of surface drainage.
- 6 Proposed garage floor elevation = 953.3
7. Proposed top of foundation elevation = 953.6
8. Proposed lowest floor elevation = 945.6
9. Type of home is a flat lot.

I hereby certify that this survey was prepared under my supervision and that I am a Licensed Land Surveyor under the laws of the State of Minnesota.

Theodore D. Kemna
Theodore D. Kemna

Date: Jan. 25, 93 License No. 17006