

CASE FILE #PL201900056

CDM# NO. 19077
 DATE 06-MAY-19
 REVISIONS

I HEREBY CERTIFY THAT THIS PLAN, SPECIFICATION OR REPORT WAS PREPARED BY ME OR UNDER MY DIRECT SUPERVISION AND THAT I AM A DULY REGISTERED ENGINEER UNDER THE LAWS OF THE STATE OF MINNESOTA.
Richard A. Sandberg, P.E.
 TYPE AND CLASSIFICATION: LICENSED P.E.
 REG. NO.: 12021

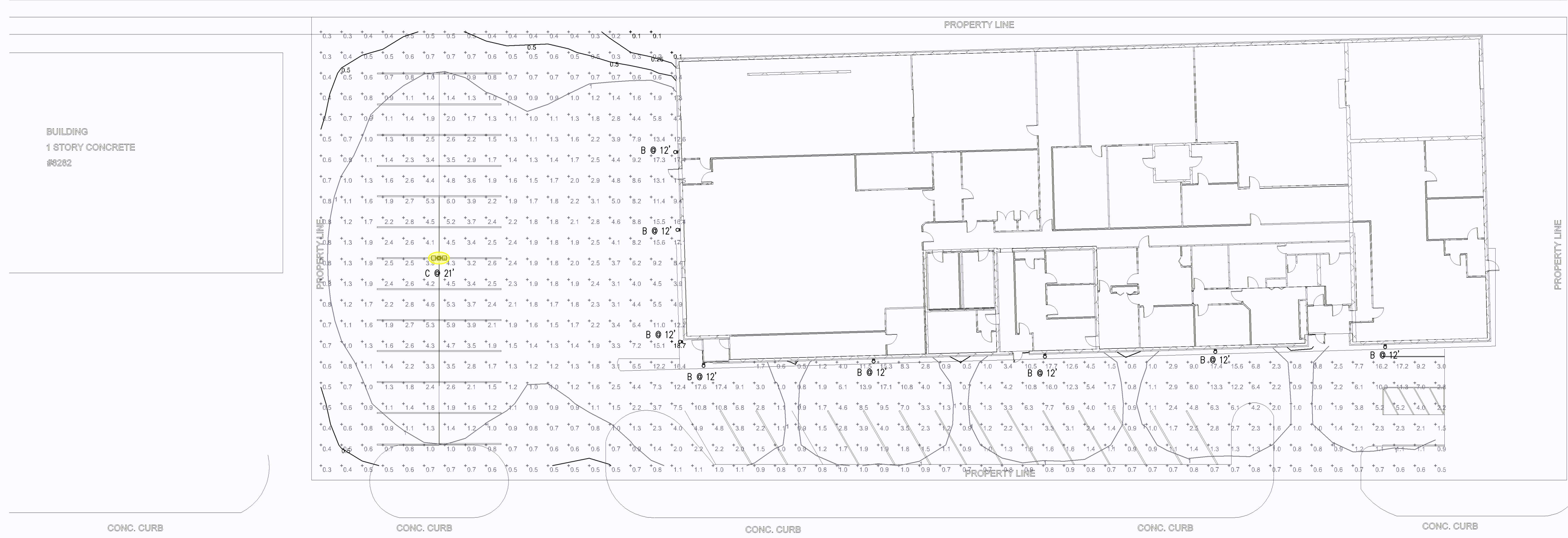

1 PH1 SITE PHOTOMETRICS PLAN - INITIAL FC WITH .99 LLF
 0 20'
 NORTH

LIGHTING PLAN APPROVED



[Signature]

NMJ
05/23/2019

LIGHT FIXTURE SCHEDULE

TYPE	DESCRIPTION	FINISH	DIMMING	VOLTAGE	LAMP	CRI	INPUT	MANUFACTURER	NOTES
B	LED WALL PACK, ALUMINUM HOUSING, FINISH TO BE SELECTED BY ARCH, INTEGRAL PHOTOCELL, TYPE IV LIGHT DISTRIBUTION, DLC RATED	VERIFY	-	120/277	LED 5000K 7000 LUMENS	65	79W	LUMARK #XTOR88-PC1	
C	CUTOFF AREA LIGHTING, DOUBLE HEAD, ALUMINUM HOUSING, 18" SQUARE STRAIGHT STEEL POLE, TYPE III DISTRIBUTION, HAND HOLE, BACKLIGHT CONTROL, DLC RATED	BRONZE	-	120/277	LED 5000K 10,200 LUMENS	70	87W	LUMARK #PRV-A25-UNV-T3-SA-BZ-OA/RA1014	

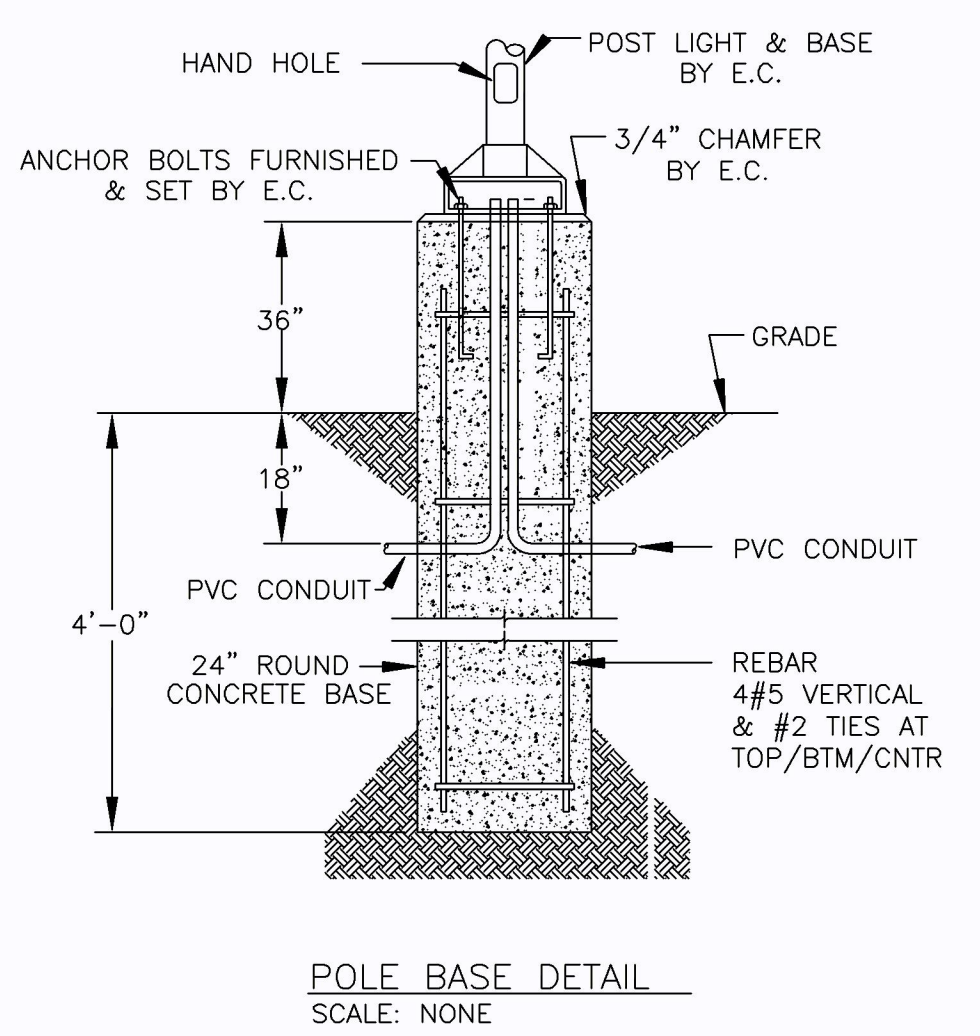

INSPIRE ARCHITECTS
 620 CIVIC HEIGHTS DRIVE, SUITE 109
 CIRCLE PINES, MINNESOTA 55014

8200 GRAND AVENUE S
BLOOMINGTON, MINNESOTA

SHEET NO.
PH1
 1 OF 2

