

Rooms/areas classified as an I-4 occupancy (more than 5 children <= to 2.5 years of age) with an occupant load of 10 or more shall have 2 exits.

PL2016-229
PL201600229

Meet all fire alarm requirements for assigned occupancy (A, E and/or I).

Each room must be designated as to age of children to be cared for. See MN statute 245A.02 subd.19

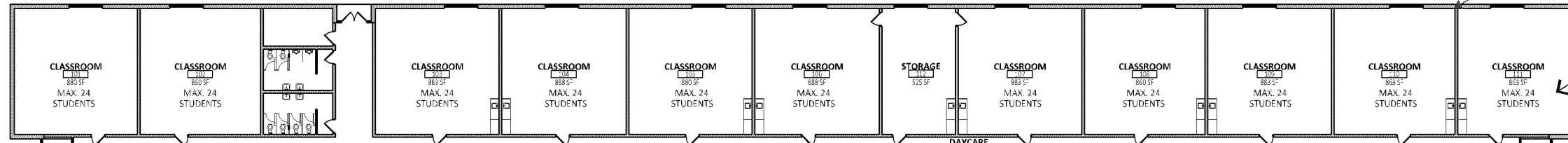

DAYCARE AREA: 15,170 SF

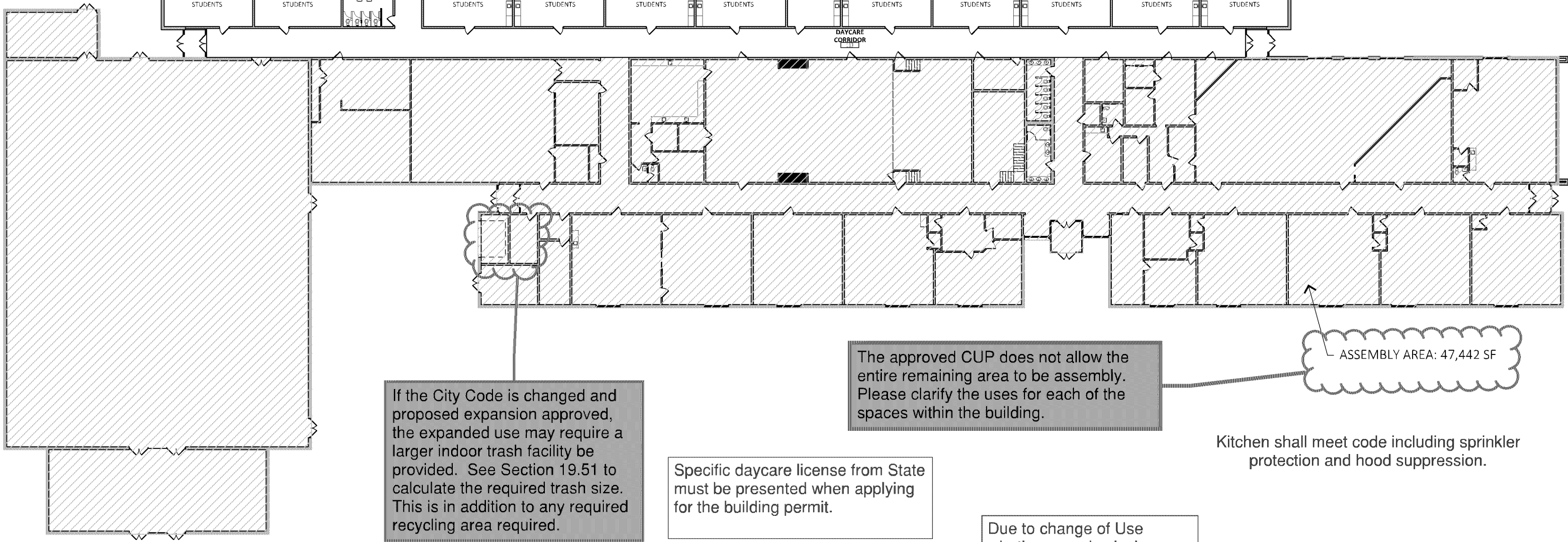

If the City Code is changed and proposed expansion approved, the expanded use may require a larger indoor trash facility be provided. See Section 19.51 to calculate the required trash size. This is in addition to any required recycling area required.

The approved CUP does not allow the entire remaining area to be assembly. Please clarify the uses for each of the spaces within the building.

ASSEMBLY AREA: 47,442 SF

Kitchen shall meet code including sprinkler protection and hood suppression.

Specific daycare license from State must be presented when applying for the building permit.

Due to change of Use whether any physical building work is done it will require a building permit for code review purposes and Certificate of Occupancy for Change of Use.

Provide two sets of plans to scale with specific room dimensions given.

Suppression and alarm systems shall be serviced annually. Systems shall be monitored.

If the City Code is changed and proposed expansion approved, day care activities must not be conducted before 5:00 a.m. or after 9:00 p.m. in residential zoning districts.

If the City Code is changed and proposed expansion approved, please provide a site plan to identify any drop-off and pick-up Plans. Assume the drop-off and pick-up will only use parking spaces as the only other option would be fire lanes or required access aisles?

Would the food service be in the rooms or separate room? Please identify any food service location and details.



CONDITIONAL USE PERMIT: FLOOR PLAN

8201 PARK AVE. S., BLOOMINGTON, MN
December 20, 2016

DAR AL-FAROOQ DAYCARE

