

PL201900150
PL2019-150

INTERSTATE HIGHWAY NO. 494
(STATE HIGHWAY NO. 5)

LYNDALE AVE. S.
TO LYNN EAST
BOULEVARD

SUBARU
FFE=851.00
36,786 GFA

ACURA
PO: 03-057-04-22-0011
7801 LYNDALE AVE. SOUTH
BLOOMINGTON, MN 55420
OWNER: THE LUTHER COMPANY, LLP
EXISTING BUILDING
FFE = 851.9

EXISTING BUILDING
FFE = 853.2
PO: 03-057-04-22-0019
7845 LYNDALE AVENUE SOUTH
BLOOMINGTON, MN 55420
OWNER: KEATS BLOOMINGTON, LLC

AMERICAN BOULEVARD WEST

Luminaire Schedule

Symbol	Qty	Label	Arrangement	LMF	Lum. Lumens	Lum. Watts	Part Number
⊙	2	OSQ-HO-3ME-1 S/L	SINGLE	1.000	41454	420	OSQ-HO-A-MM-3ME-50K-S/L-XX W/ OSQ-HO-DAXX
⊙	2	OSQ-HO-3ME-BLSF 6SL	SINGLE	1.000	44155	550	OSQ-HO-A-MM-3ME-6SL-50K-S/L W/ OSQ-HO-BLSF & OSQ-HO-DAXX
⊙	4	OSQ-HO-4MB-4SL	SINGLE	1.000	26797	341	OSQ-HO-A-MM-4ME-4SL-50K-S/L W/ OSQ-HO-BLSF & OSQ-HO-DAXX
⊙	4	OSQ-HO-4MB-6SL	SINGLE	1.000	42540	550	OSQ-HO-A-MM-4ME-4SL-50K-S/L W/ OSQ-HO-BLSF & OSQ-HO-DAXX
⊙	1	OSQ-HO-4ME2 S/L	BACK-BACK	1.000	41454	420	OSQ-HO-A-MM-4ME-50K-S/L-XX W/ OSQ-HO-DAXX
⊙	3	OSQ-HO-4SH-2 S/L	BACK-BACK	1.000	41055	420	OSQ-HO-A-MM-4SH-50K-S/L-XX W/ OSQ-HO-DAXX
⊙	12	OSQ-HO-4SH-2 4SL	BACK-BACK	1.000	52766	550	OSQ-HO-A-MM-4SH-4SL-50K-S/L-XX W/ OSQ-HO-DAXX
⊙	1	OSQ-HO-AF-50L	SINGLE	1.000	41454	420	OSQ-HO-A-MM-AF-50L-S/L-XX W/ OSQ-HO-DAXX
⊙	12	OSQ-HO-AF-6SL	SINGLE	1.000	53848	550	OSQ-HO-A-MM-AF-6SL-S/L-XX W/ OSQ-HO-DAXX

Calculation Summary (Footcandles calculated using predicted lumen values @ 50K hrs of operation)

Label	Units	Avg	Max	Min	Aug/Min	Max/Min
PAVED PARKING	Fc	11.82	66.2	0.9	13.3	73.56
PROPERTY LINE	Fc	1.51	8.6	0.0	N.A.	N.A.
FRONTLINE	Fc	41.21	66.2	25.5	1.62	2.60
FRONTLINE 2	Fc	36.38	46.6	23.5	1.57	1.98
GENERAL SALES 1	Fc	18.26	28.1	9.6	1.90	2.93

Photometrics Plan provided by Cree Lighting. Contact Darren Johnson, 507.456.9722, djohnson@winsupplyinc.com.

NOTE: EXISTING AND NEW POLES
 (6) PS452C1XX (20' X 4" STEEL SQUARE POLE)
 (9) PS452C2XX (20' X 4" STEEL SQUARE POLE 28180)
 Proposed poles meet 130 MPH sustained winds.
 Additional Equipment:
 (57) OSQ-HO-DAXX (DIRECT ARM MOUNT)
 (10) OSQ-HO-BLSF (BACK LIGHT SHIELD)
 *** CUSTOMER TO VERIFY ORDERING INFORMATION AND CATALOGUE NUMBER PRIOR TO PLACING ORDER ***

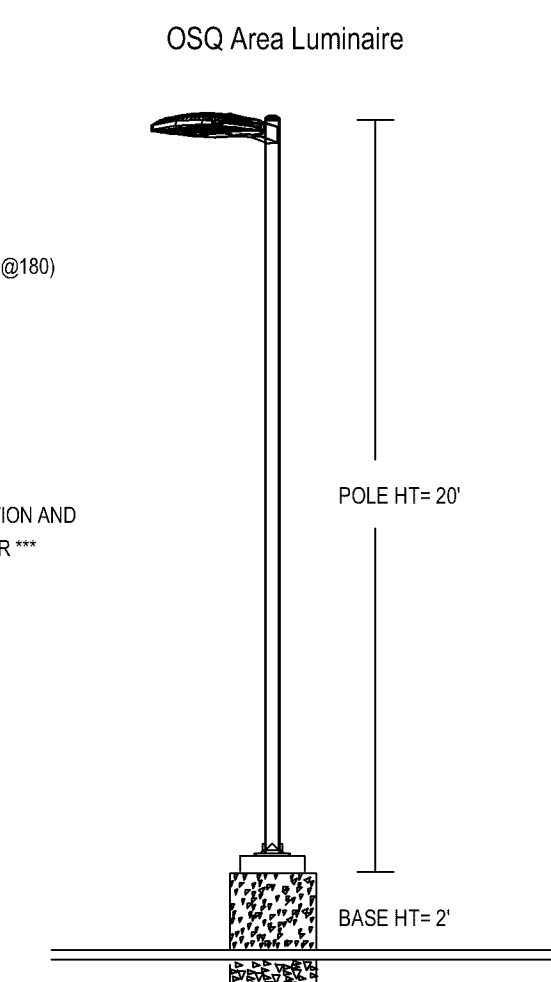

DEVELOPER
MOTORS MANAGEMENT CORPORATION
3701 ALABAMA AVENUE SOUTH
ST. LOUIS PARK, MN 55416
TEL: (612)28-8800 FAX: (612)28-8800

MUNICIPALITY
BLOOMINGTON

PROJECT
LUTHER BLOOMINGTON
ACURA SUBARU
BLOOMINGTON, MN

SHEET INDEX

ISSUE / REVISION HISTORY

DATE	ISSUE / REVISION	REVIEW
08/28/2019	ISSUE SUBMITTAL	DES
09/02/2019	SITE PLAN SUBMITTAL	DES
09/09/2019	PHOTOMETRICS SUBMITTAL	DES
10/02/2019	PERMIT SUBMITTAL	DES

PROJECT MANAGER REVIEW
DATE: 10/15/2019

CERTIFICATION

PERMIT SUBMITTAL
OCTOBER 15, 2019

LANDFORM
From Site to Finish

105 South Fifth Avenue Tel: 612-252-9070
Suite 513 Fax: 612-252-9077
Minneapolis, MN 55401 Web: landform.net

FILE NAME: C202BA041.DWG
PROJECT NO: BAA14041

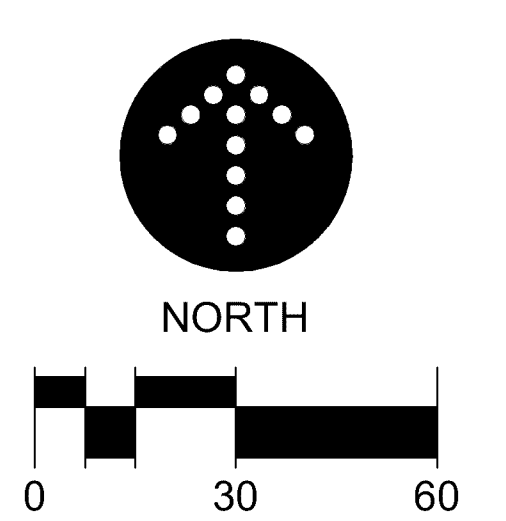

PHOTOMETRICS PLAN
INITIAL VALUES
C2.2

Sheet	Title
C01	DATE TIME SHEET
C02	EXISTING CONDITIONS
C03	DEVELOPMENT
C04	PROPOSED DRIVEWAY, METAL WALLS
C05	PHOTOMETRIC PLAN - MAINTAINED VALUES
C06	PHOTOMETRIC PLAN - UNMAINTAINED VALUES
C07	PHOTOMETRIC PLAN - UNMAINTAINED VALUES
C08	PHOTOMETRIC PLAN - UNMAINTAINED VALUES
C09	PHOTOMETRIC PLAN - UNMAINTAINED VALUES
C10	PHOTOMETRIC PLAN - UNMAINTAINED VALUES
C11	PHOTOMETRIC PLAN - UNMAINTAINED VALUES
C12	PHOTOMETRIC PLAN - UNMAINTAINED VALUES
C13	PHOTOMETRIC PLAN - UNMAINTAINED VALUES
C14	PHOTOMETRIC PLAN - UNMAINTAINED VALUES
C15	PHOTOMETRIC PLAN - UNMAINTAINED VALUES
C16	PHOTOMETRIC PLAN - UNMAINTAINED VALUES
C17	PHOTOMETRIC PLAN - UNMAINTAINED VALUES
C18	PHOTOMETRIC PLAN - UNMAINTAINED VALUES
C19	PHOTOMETRIC PLAN - UNMAINTAINED VALUES
C20	PHOTOMETRIC PLAN - UNMAINTAINED VALUES
C21	PHOTOMETRIC PLAN - UNMAINTAINED VALUES
C22	PHOTOMETRIC PLAN - UNMAINTAINED VALUES
C23	PHOTOMETRIC PLAN - UNMAINTAINED VALUES
C24	PHOTOMETRIC PLAN - UNMAINTAINED VALUES
C25	PHOTOMETRIC PLAN - UNMAINTAINED VALUES
C26	PHOTOMETRIC PLAN - UNMAINTAINED VALUES
C27	PHOTOMETRIC PLAN - UNMAINTAINED VALUES
C28	PHOTOMETRIC PLAN - UNMAINTAINED VALUES
C29	PHOTOMETRIC PLAN - UNMAINTAINED VALUES
C30	PHOTOMETRIC PLAN - UNMAINTAINED VALUES
C31	PHOTOMETRIC PLAN - UNMAINTAINED VALUES
C32	PHOTOMETRIC PLAN - UNMAINTAINED VALUES
C33	PHOTOMETRIC PLAN - UNMAINTAINED VALUES
C34	PHOTOMETRIC PLAN - UNMAINTAINED VALUES
C35	PHOTOMETRIC PLAN - UNMAINTAINED VALUES
C36	PHOTOMETRIC PLAN - UNMAINTAINED VALUES
C37	PHOTOMETRIC PLAN - UNMAINTAINED VALUES
C38	PHOTOMETRIC PLAN - UNMAINTAINED VALUES
C39	PHOTOMETRIC PLAN - UNMAINTAINED VALUES
C40	PHOTOMETRIC PLAN - UNMAINTAINED VALUES
C41	PHOTOMETRIC PLAN - UNMAINTAINED VALUES
C42	PHOTOMETRIC PLAN - UNMAINTAINED VALUES
C43	PHOTOMETRIC PLAN - UNMAINTAINED VALUES
C44	PHOTOMETRIC PLAN - UNMAINTAINED VALUES
C45	PHOTOMETRIC PLAN - UNMAINTAINED VALUES
C46	PHOTOMETRIC PLAN - UNMAINTAINED VALUES
C47	PHOTOMETRIC PLAN - UNMAINTAINED VALUES
C48	PHOTOMETRIC PLAN - UNMAINTAINED VALUES
C49	PHOTOMETRIC PLAN - UNMAINTAINED VALUES
C50	PHOTOMETRIC PLAN - UNMAINTAINED VALUES
C51	PHOTOMETRIC PLAN - UNMAINTAINED VALUES
C52	PHOTOMETRIC PLAN - UNMAINTAINED VALUES
C53	PHOTOMETRIC PLAN - UNMAINTAINED VALUES
C54	PHOTOMETRIC PLAN - UNMAINTAINED VALUES
C55	PHOTOMETRIC PLAN - UNMAINTAINED VALUES
C56	PHOTOMETRIC PLAN - UNMAINTAINED VALUES
C57	PHOTOMETRIC PLAN - UNMAINTAINED VALUES
C58	PHOTOMETRIC PLAN - UNMAINTAINED VALUES
C59	PHOTOMETRIC PLAN - UNMAINTAINED VALUES
C60	PHOTOMETRIC PLAN - UNMAINTAINED VALUES
C61	PHOTOMETRIC PLAN - UNMAINTAINED VALUES
C62	PHOTOMETRIC PLAN - UNMAINTAINED VALUES
C63	PHOTOMETRIC PLAN - UNMAINTAINED VALUES
C64	PHOTOMETRIC PLAN - UNMAINTAINED VALUES
C65	PHOTOMETRIC PLAN - UNMAINTAINED VALUES
C66	PHOTOMETRIC PLAN - UNMAINTAINED VALUES
C67	PHOTOMETRIC PLAN - UNMAINTAINED VALUES
C68	PHOTOMETRIC PLAN - UNMAINTAINED VALUES
C69	PHOTOMETRIC PLAN - UNMAINTAINED VALUES
C70	PHOTOMETRIC PLAN - UNMAINTAINED VALUES
C71	PHOTOMETRIC PLAN - UNMAINTAINED VALUES
C72	PHOTOMETRIC PLAN - UNMAINTAINED VALUES
C73	PHOTOMETRIC PLAN - UNMAINTAINED VALUES
C74	PHOTOMETRIC PLAN - UNMAINTAINED VALUES
C75	PHOTOMETRIC PLAN - UNMAINTAINED VALUES
C76	PHOTOMETRIC PLAN - UNMAINTAINED VALUES
C77	PHOTOMETRIC PLAN - UNMAINTAINED VALUES
C78	PHOTOMETRIC PLAN - UNMAINTAINED VALUES
C79	PHOTOMETRIC PLAN - UNMAINTAINED VALUES
C80	PHOTOMETRIC PLAN - UNMAINTAINED VALUES
C81	PHOTOMETRIC PLAN - UNMAINTAINED VALUES
C82	PHOTOMETRIC PLAN - UNMAINTAINED VALUES
C83	PHOTOMETRIC PLAN - UNMAINTAINED VALUES
C84	PHOTOMETRIC PLAN - UNMAINTAINED VALUES
C85	PHOTOMETRIC PLAN - UNMAINTAINED VALUES
C86	PHOTOMETRIC PLAN - UNMAINTAINED VALUES
C87	PHOTOMETRIC PLAN - UNMAINTAINED VALUES
C88	PHOTOMETRIC PLAN - UNMAINTAINED VALUES
C89	PHOTOMETRIC PLAN - UNMAINTAINED VALUES
C90	PHOTOMETRIC PLAN - UNMAINTAINED VALUES
C91	PHOTOMETRIC PLAN - UNMAINTAINED VALUES
C92	PHOTOMETRIC PLAN - UNMAINTAINED VALUES
C93	PHOTOMETRIC PLAN - UNMAINTAINED VALUES
C94	PHOTOMETRIC PLAN - UNMAINTAINED VALUES
C95	PHOTOMETRIC PLAN - UNMAINTAINED VALUES
C96	PHOTOMETRIC PLAN - UNMAINTAINED VALUES
C97	PHOTOMETRIC PLAN - UNMAINTAINED VALUES
C98	PHOTOMETRIC PLAN - UNMAINTAINED VALUES
C99	PHOTOMETRIC PLAN - UNMAINTAINED VALUES
C100	PHOTOMETRIC PLAN - UNMAINTAINED VALUES

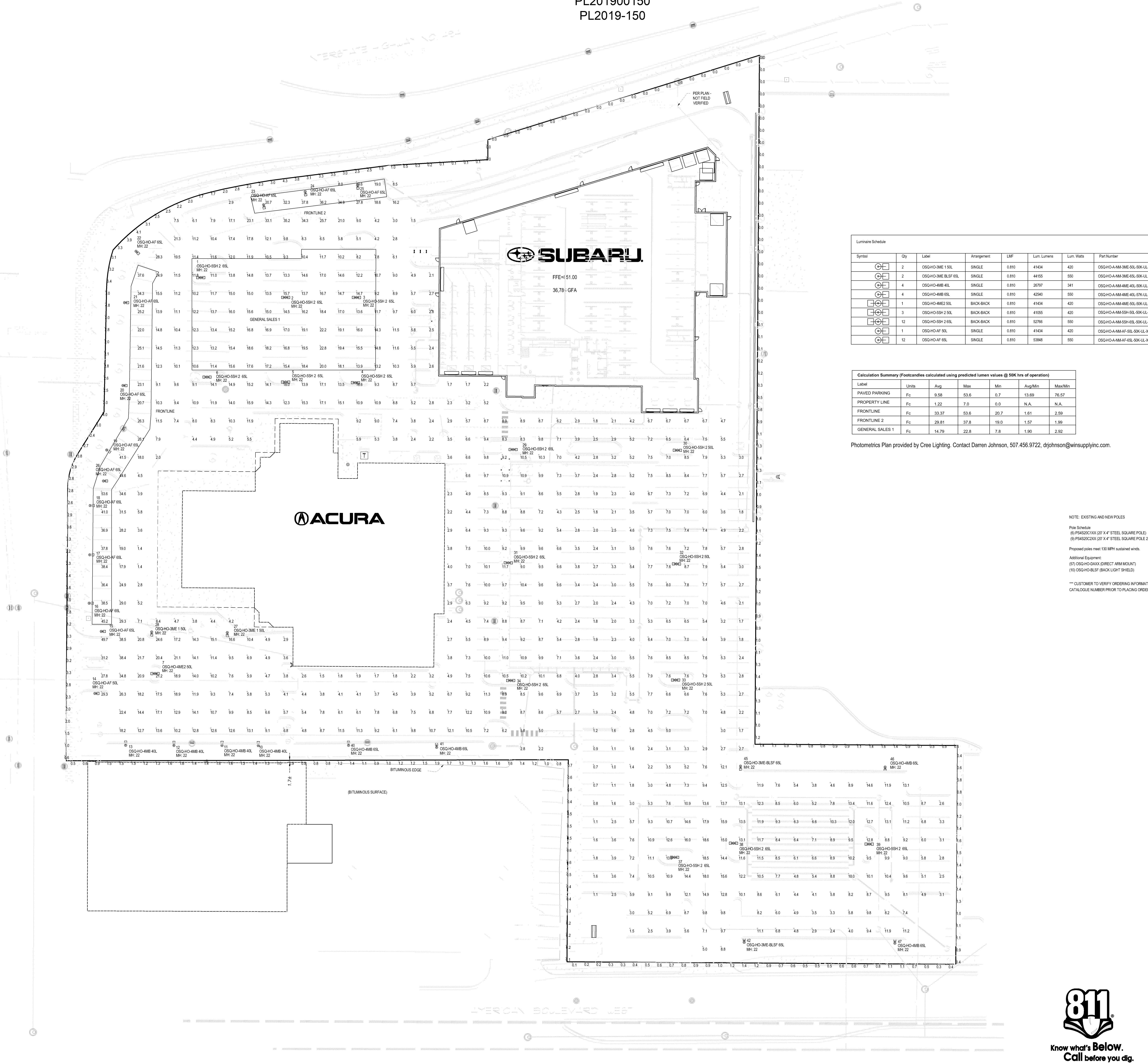

Luminaire Schedule

Symbol	Qty	Label	Arrangement	LMF	Lum. Lumens	Lum. Watts	Part Number
⊙	2	OSQ-HO-3ME-1-SOL	SINGLE	0.810	41454	420	OSQ-HO-A-MME-50L-50K-LX-XX W/ OSQ-HO-DAXX
⊙	2	OSQ-HO-3ME-BLSF-6SL	SINGLE	0.810	44155	550	OSQ-HO-A-MME-45L-50K-LX-XX W/ OSQ-HO-BLSF & OSQ-HO-DAXX
⊙	4	OSQ-HO-4MB-4XL	SINGLE	0.810	26797	341	OSQ-HO-A-MME-40L-50K-LX-XX W/ OSQ-HO-BLSF & OSQ-HO-DAXX
⊙	4	OSQ-HO-4MB-6SL	SINGLE	0.810	42540	550	OSQ-HO-A-MME-40L-50K-LX-XX W/ OSQ-HO-BLSF & OSQ-HO-DAXX
⊙	1	OSQ-HO-4ME2-SOL	BACK-BACK	0.810	41454	420	OSQ-HO-A-MME-50L-50K-LX-XX W/ OSQ-HO-DAXX
⊙	3	OSQ-HO-4ME2-SOL	BACK-BACK	0.810	41055	420	OSQ-HO-A-MME-50L-50K-LX-XX W/ OSQ-HO-DAXX
⊙	12	OSQ-HO-4ME2-SOL	BACK-BACK	0.810	52766	550	OSQ-HO-A-MME-50L-50K-LX-XX W/ OSQ-HO-DAXX
⊙	1	OSQ-HO-4AF-SOL	SINGLE	0.810	41454	420	OSQ-HO-A-MME-45L-50K-LX-XX W/ OSQ-HO-DAXX
⊙	12	OSQ-HO-4AF-6SL	SINGLE	0.810	53848	550	OSQ-HO-A-MME-45L-50K-LX-XX W/ OSQ-HO-DAXX

Calculation Summary (Footcandles calculated using predicted lumen values @ 50K hrs of operation)

Label	Units	Avg	Max	Min	Aug/Min	Max/Min
PAVED PARKING	Fc	9.58	53.6	0.7	13.69	76.57
PROPERTY LINE	Fc	1.22	7.0	0.0	N.A.	N.A.
FRONTLINE	Fc	33.37	53.6	20.7	1.61	2.59
FRONTLINE 2	Fc	29.81	37.8	19.0	1.57	1.99
GENERAL SALES 1	Fc	14.79	22.8	7.8	1.90	2.92

Photometrics Plan provided by Cree Lighting. Contact Darren Johnson, 507.456.9722, djohnson@winsupplyinc.com.

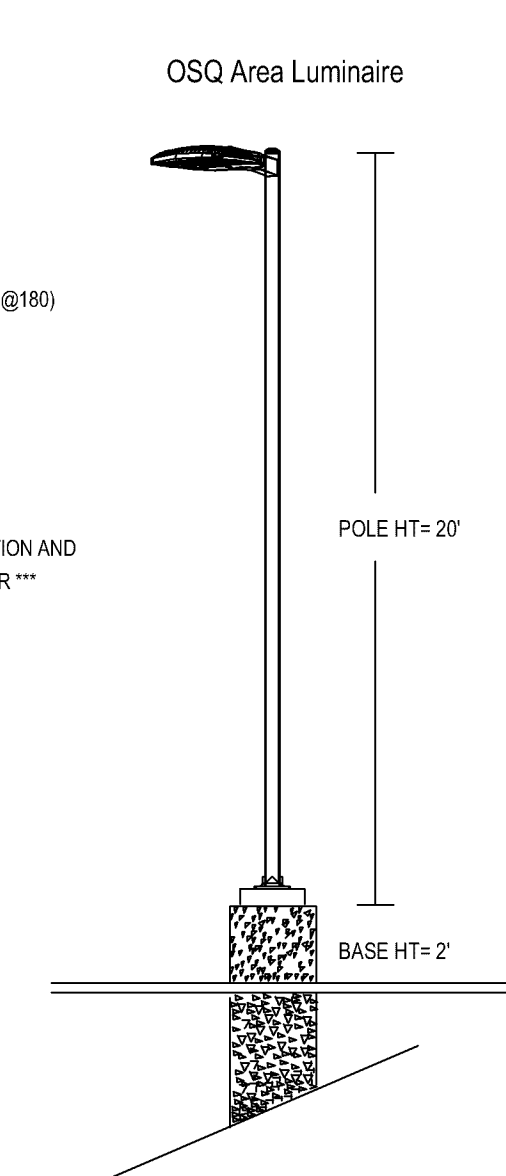

NOTE: EXISTING AND NEW POLES
 Pole Schedule
 (8) PS452C1XX (20' X 4" STEEL SQUARE POLE)
 (9) PS452C2XX (20' X 4" STEEL SQUARE POLE 28184)
 Proposed poles meet 130 MPH sustained winds.
 Additional Equipment:
 (57) OSQ-HO-DAXX (DIRECT ARM MOUNT)
 (10) OSQ-HO-BLSF (BACK LIGHT SHIELD)
 *** CUSTOMER TO VERIFY ORDERING INFORMATION AND CATALOGUE NUMBER PRIOR TO PLACING ORDER ***

ISSUE / REVISION HISTORY

DATE	ISSUE / REVISION	REVISION
08/28/2019	ISSUE / REVISION	ISS
09/10/2019	ISSUE / REVISION	ISS
09/10/2019	ISSUE / REVISION	ISS
09/10/2019	ISSUE / REVISION	ISS
09/10/2019	ISSUE / REVISION	ISS

PROJECT MANAGER REVIEW

BY	DATE
01/05/2019	01/15/2019

CERTIFICATION

PERMIT SUBMITTAL
OCTOBER 15, 2019

LANDFORM
From Site to Finish
105 South Fifth Avenue Suite 513
Minneapolis, MN 55401
Tel: 612-252-9070
Fax: 612-252-9077
Web: landform.net

PHOTOMETRIC PLAN
MAINTAINED VALUES
C2.3

