

REVISION SCHEDULE

NO.	DESCRIPTION	DATE
1	CONSTRUCTION	3/4/2019
2	ADDENDUM 01	3/27/2019
3	ASI #1	5/28/2019

I hereby certify that this survey, plan or report was prepared by me or under my direct supervision and that I am a duly Licensed Professional Engineer, Registered Professional Architect or Registered Professional Surveyor in the State of Minnesota.
 Date: 3/4/2019
 Registration No. 55234
 This certification is void unless signed in blank. If it is available, upon request at: www.jlgarchitects.com

J. Ash McKinney
 J. Ash McKinney
 Professional Engineer
 Registration No. 55234

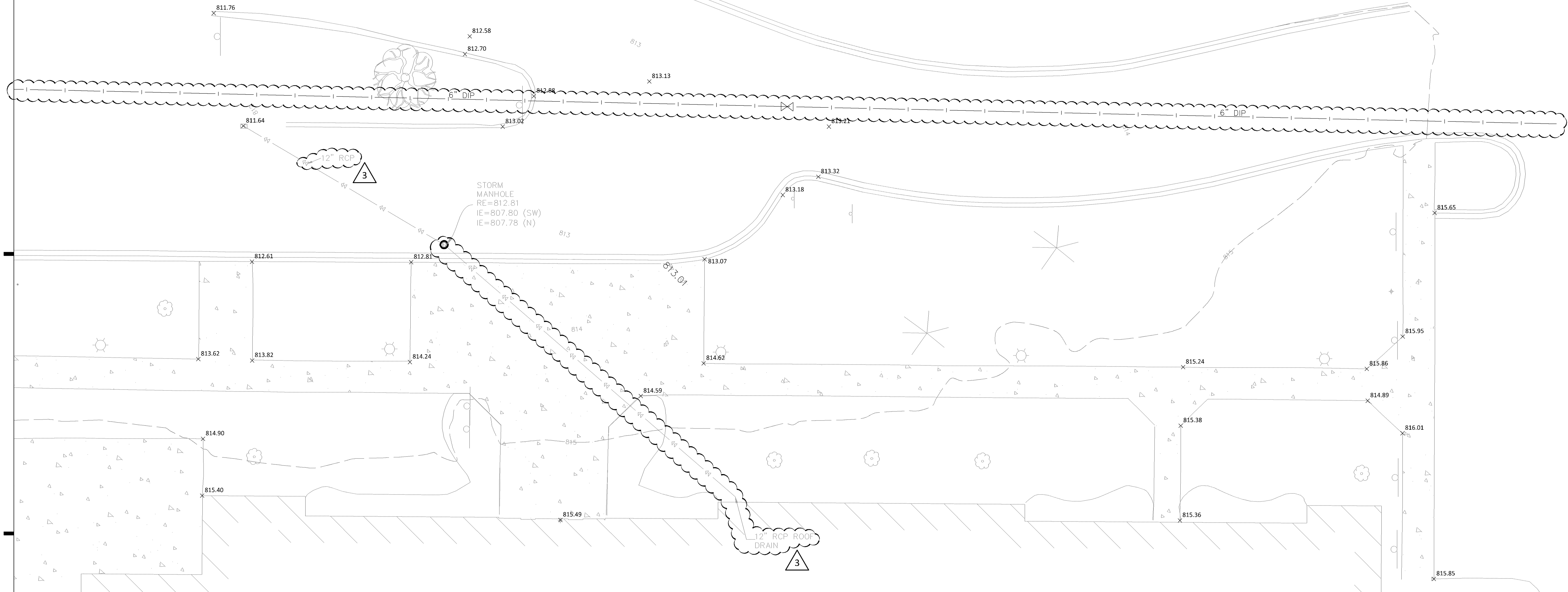

SURVEY COMPLETED BY OTHERS

PL201900066
PL2019-66

LEGEND

● FOUND MONUMENT	— BOUNDARY LINE	- - - EASEMENT LINE
○ FOUND CAST IRON MONUMENT	— RIGHT-OF-WAY LINE	- - - SETBACK LINE
⊙ FOUND RIGHT-OF-WAY MONUMENT	- - - UNDERLYING / ADJACENT LOT	- - - RESTRICTED ACCESS
○ SET MONUMENT MARKED LS 21729	- - - TIE LINE	- - - TREE LINE
⊗ GATE VALVE / HYDRANT	- - - SECTION LINE	- - - CONCRETE CURB
○ SANITARY MANHOLE	- - - DEED DISTANCE (100.00)	- - - BUILDING LINE
○ CLEAN OUT	- - - WATERMAIN	- - - BUILDING CANOPY
○ STORM MANHOLE	- - - SANITARY SEWER	- - - BITUMINOUS SURFACE
○ STORM CATCH BASIN	- - - STORM SEWER	- - - CONCRETE SURFACE
△ FLARED END SECTION	- - - UNDERGROUND ELECTRIC	○ DECIDUOUS TREE
△ TRANSFORMER	- - - UNDERGROUND TELEPHONE	✱ CONIFEROUS TREE
★ LIGHT	- - - UNDERGROUND GAS	○ SPOT ELEVATION
⊗ GUY ANCHOR	- - - OVERHEAD ELECTRICAL WIRE	- - - CONTOUR
○ UTILITY POLE	- - - CHAIN LINK FENCE	ST # 999.9 SOIL BORING
■ GUARD POST	- - - WOOD FENCE	## REGULAR PARKING STALL COUNT
□ SIGN	- - - WIRE FENCE	⊕ TRAFFIC MARKERS
⊗ GAS METER	- - - WET LAND	
⊗ GAS MANHOLE	- - - RETAINING WALL	
⊗ ELECTRIC MANHOLE	- - - BLOCK RETAINING WALL	
⊗ ELECTRIC METER	- - - STONE RETAINING WALL	
□ TELEPHONE PEDESTAL	- - - POND / WATER LINE	
□ CABLE TV BOX	- - - FEMA FLOOD ZONE LINE	
⊗ COMMUNICATIONS MANHOLE		

2019 BLOOMINGTON ICE GARDEN REMODEL
 3600 W 98TH ST MINNEAPOLIS, MN 55431

7 MARCH, 2019

EXISTING CONDITIONS

C2.01

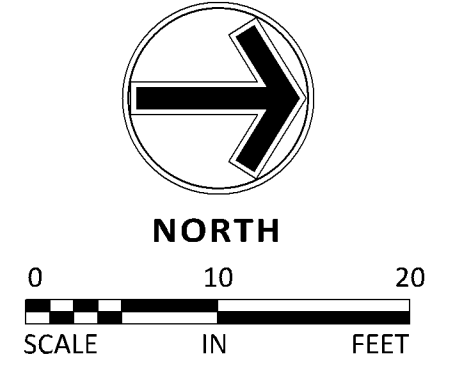

REVISION SCHEDULE

NO.	DESCRIPTION	DATE
1	CONSTRUCTION	3/4/2019
2	ADDENDUM 01	3/27/2019
3	ASI #1	5/28/2019

I hereby certify that this survey, plan or report was prepared by me or under my direct supervision and that I am a duly licensed professional ARCHITECT under the laws of the State of Minnesota.
Joseph J. McKinney
Date: 3/4/2019
Registration No. 55234
This certification is not valid unless signed in black ink. If a signature is not in black ink, it is invalid, even if signed in blue ink. Minnesota, MN only.

2019 BLOOMINGTON ICE GARDEN REMODEL
3600 W 98TH ST MINNEAPOLIS, MN 55431

7 MARCH, 2019
DEMOLITION PLANS

C2.02

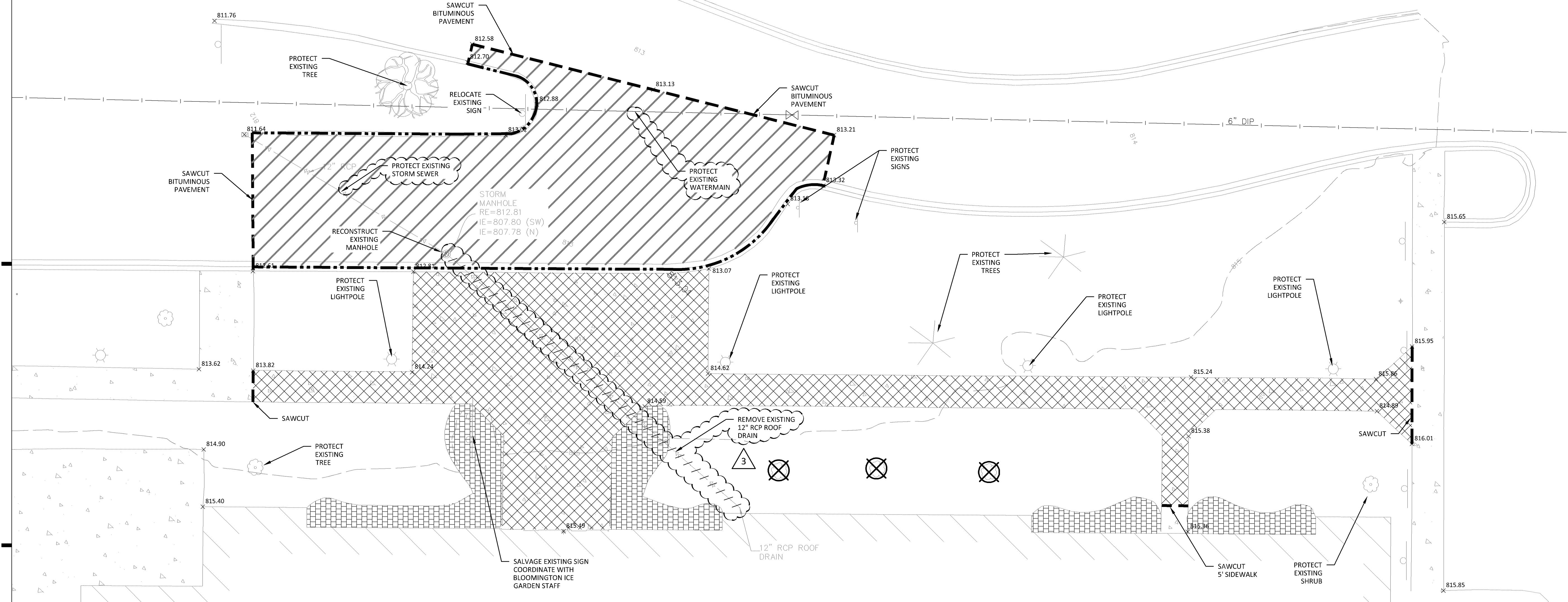

DEMOLITION NOTES

- DEMOLITION NOTES ARE NOT COMPREHENSIVE. CONTRACTOR SHALL VISIT THE SITE PRIOR TO CONSTRUCTION TO OBTAIN A CLEAR UNDERSTANDING OF THE INTENDED SCOPE OF WORK.
- THE CONTRACTOR IS RESPONSIBLE FOR DEMOLITION, REMOVAL, AND DISPOSING IN A LOCATION APPROVED BY ALL GOVERNING AUTHORITIES AND IN ACCORDANCE WITH APPLICABLE CODES, OF ALL STRUCTURES, PADS, WALLS, FLUMES, FOUNDATIONS, PARKING, DRIVES, DRAINAGE STRUCTURES, UTILITIES, ETC., SUCH THAT THE IMPROVEMENTS SHOWN ON THE PLANS CAN BE CONSTRUCTED. ALL FACILITIES TO BE REMOVED SHALL BE UNDERCUT TO SUITABLE MATERIAL AND BROUGHT TO GRADE WITH SUITABLE COMPACTED FILL MATERIAL PER THE GEOTECHNICAL REPORT AND/OR GEOTECHNICAL ENGINEER.
- CLEARING AND GRUBBING: CONTRACTOR IS RESPONSIBLE FOR REMOVING ALL DEBRIS FROM THE SITE AND DISPOSING THE DEBRIS IN A LAWFUL MANNER. CONTRACTOR IS RESPONSIBLE FOR OBTAINING ALL PERMITS REQUIRED FOR DEMOLITION AND DISPOSAL.
- CONTRACTOR SHALL COORDINATE WITH RESPECTIVE UTILITY COMPANIES PRIOR TO REMOVAL AND/OR RELOCATION OF UTILITIES. CONTRACTOR SHALL COORDINATE WITH UTILITY COMPANIES CONCERNING PORTIONS OF WORK WHICH MAY BE PERFORMED BY THE UTILITY COMPANIES' FORCES AND ANY FEES WHICH ARE TO BE PAID TO UTILITY COMPANIES FOR SERVICES. CONTRACTOR IS RESPONSIBLE FOR PAYING ALL FEES AND CHARGES.
- CONTRACTOR IS SPECIFICALLY CAUTIONED THAT LOCATIONS OF EXISTING UTILITIES SHOWN ON THIS PLAN HAVE BEEN DETERMINED FROM INFORMATION AVAILABLE. ENGINEER ASSUMES NO RESPONSIBILITY FOR THE UTILITY MAPPING ACCURACY. PRIOR TO START OF ANY DEMOLITION ACTIVITY, THE CONTRACTOR SHALL NOTIFY UTILITY COMPANIES 48 HOURS PRIOR TO ANY EXCAVATION FOR ON-SITE LOCATIONS OF EXISTING UTILITIES. THE LOCATIONS OF UTILITIES SHALL BE OBTAINED BY THE CONTRACTOR BY CALLING MINNESOTA GOPHER STATE ONE CALL AT 800-252-1166 OR 651-454-0002.
- THE MAPPING LOCATION OF ALL EXISTING SEWERS, PIPING, AND UTILITIES SHOWN ARE NOT TO BE INTERPRETED AS THE EXACT LOCATION, OR AS THE ONLY OBSTACLES THAT MAY OCCUR ON THE SITE. VERIFY EXISTING CONDITIONS AND PROCEED WITH CAUTION AROUND ANY ANTICIPATED FEATURES. GIVE NOTICE TO ALL UTILITY COMPANIES REGARDING DESTRUCTION AND REMOVAL OF ALL SERVICE LINES AND CAP ALL LINES BEFORE PROCEEDING WITH WORK. UTILITIES DETERMINED TO BE ABANDONED SHALL BE REMOVED IF UNDER THE BUILDING INCLUDING 10' BEYOND FOUNDATIONS.
- ELECTRICAL, TELEPHONE, CABLE, WATER, FIBER OPTIC CABLE AND/OR GAS LINES NEEDING TO BE REMOVED OR RELOCATED SHALL BE COORDINATED WITH THE AFFECTED UTILITY COMPANY. ADEQUATE TIME SHALL BE PROVIDED FOR RELOCATION AND CLOSE COORDINATION WITH THE UTILITY COMPANY IS NECESSARY TO PROVIDE A SMOOTH TRANSITION IN UTILITY SERVICE. CONTRACTOR SHALL PAY CLOSE ATTENTION TO EXISTING UTILITIES WITHIN THE ROAD RIGHT OF WAY DURING CONSTRUCTION.
- CONTRACTOR MUST PROTECT THE PUBLIC AT ALL TIMES WITH FENCING, BARRICADES, ENCLOSURES, ETC., TO THE BEST PRACTICES.
- PRIOR TO DEMOLITION OCCURRING, ALL EROSION CONTROL DEVICES ARE TO BE INSTALLED AND APPROVED BY THE LOCAL AUTHORITY.
- CONTRACTOR SHALL LIMIT SAW-CUT & PAVEMENT REMOVAL TO ONLY THOSE AREAS WHERE IT IS REQUIRED AS SHOWN ON THESE CONSTRUCTION PLANS BUT IF ANY DAMAGE IS INCURRED ON ANY OF THE SURROUNDING PAVEMENT, ETC. THE CONTRACTOR SHALL BE RESPONSIBLE FOR ITS REMOVAL AND REPAIR.
- CONTRACTOR TO PROTECT EXISTING FEATURES WHICH ARE TO REMAIN. DAMAGE TO ANY EXISTING CONDITIONS TO REMAIN WILL BE REPLACED AT CONTRACTOR'S EXPENSE.

LEGEND

	EXISTING
LIGHT	
STORM SEWER	
TREES / SHRUBS	
CONCRETE	
SIGNS	
CONCRETE CURB	
BITUMINOUS CURB	
BUILDING	
REMOVE EXIST CONCRETE CURB	
SAW CUT EXIST BITUMINOUS PAVEMENT	
REMOVE EXISTING BITUMINOUS PAVEMENT	
REMOVE EXISTING CONCRETE PAVEMENT	
REMOVE EXISTING LANDSCAPING	
REMOVE EXISTING SHRUB	
REMOVE EXISTING	
REMOVE EXISTING UTILITY LINE	

**PL201900066
PL2019-66**

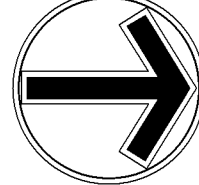

NORTH
0 10 20
SCALE IN FEET

REVISION SCHEDULE

NO.	DESCRIPTION	DATE
1	CONSTRUCTION	3/4/2019
2	ADDENDUM 01	3/27/2019
3	ASI #1	5/28/2019

I hereby certify that this survey, plan or report was prepared by me or under my direct supervision and I am a duly Licensed Professional Engineer or Architect under the laws of the State of Minnesota.
 Date: 3/4/2019
 Registration No. 55234
 This certification is not valid unless signed in blank. If it is available upon request at Cambridge, Minnesota, MN office.

Julie Long
 Julie Long, PE
 Registration No. 55234

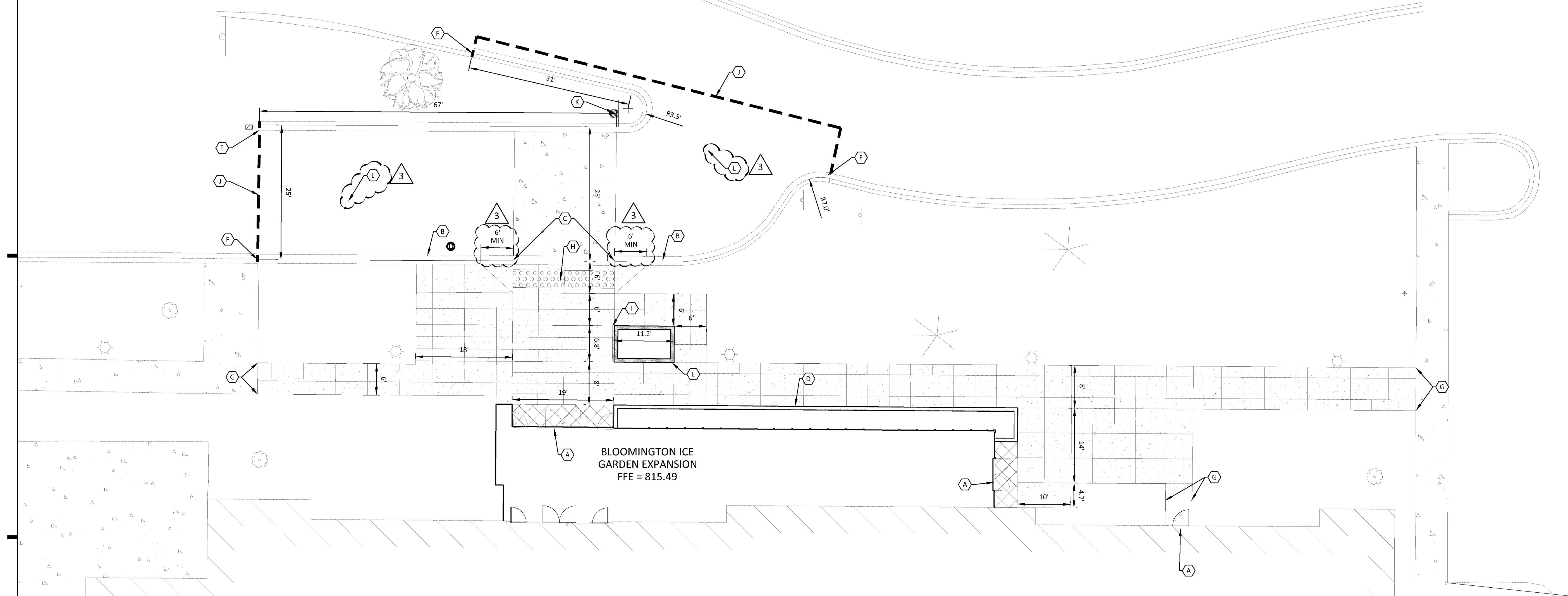

LEGEND

	PROPOSED	EXISTING	
PROPERTY LIMIT	---	---	STANDARD DUTY ASPHALT PAVING
CURB & GUTTER	---	---	CONCRETE PAVING
BUILDING	---	---	CONCRETE SIDEWALK
SAWCUT LINE	---	---	ARCHITECTURAL CONCRETE
SIGN	●	●	
KEY NOTE	ⓧ		
EXISTING LIGHT FIXTURE TO REMAIN	☀		

DEVELOPMENT NOTES

1. ALL DIMENSIONS ARE ROUNDED TO THE NEAREST TENTH FOOT.
2. ALL DIMENSIONS SHOWN ARE TO THE FACE OF CURB TO FACE OF CURB UNLESS OTHERWISE NOTED.
3. CONTRACTOR SHALL REVIEW PAVEMENT GRADIENT AND CONSTRUCT "GUTTER OUT" WHERE WATER DRAINS AWAY FROM CURB. ALL OTHER AREAS SHALL BE CONSTRUCTED AS "GUTTER IN" CURB. COORDINATE WITH GRADING CONTRACTOR.
4. ALL AREAS ARE ROUNDED TO THE NEAREST SQUARE FOOT.
5. ALL GRADIENTS ON SIDEWALKS ALONG THE ADA ROUTE SHALL HAVE A MAXIMUM LONGITUDINAL SLOPE OF 5% (1:20), EXCEPT AT CURB RAMPS (1:12), AND A MAXIMUM CROSS SLOPE OF 2.00% (1:50). THE MAXIMUM SLOPE IN ANY DIRECTION ON AN ADA PARKING STALL OR ACCESS AISLE SHALL BE 2.00% (1:50). THE CONTRACTOR SHALL REVIEW AND VERIFY THE GRADIENT IN THE FIELD ALONG THE ADA ROUTES PRIOR TO PLACING CONCRETE OR BITUMINOUS PAVEMENT. THE CONTRACTOR SHALL NOTIFY THE ENGINEER IMMEDIATELY IF THERE IS A DISCREPANCY BETWEEN THE GRADIENT IN THE FIELD VERSUS THE DESIGN GRADIENT AND COORDINATE WITH GRADING CONTRACTOR.
6. "NO PARKING" SIGNS SHALL BE PLACED ALONG ALL DRIVEWAYS AS REQUIRED BY CITY.

KEY NOTES

- A. BUILDING, STOOPS SEE ARCHITECTURAL PLANS
- B. 6-612 CONCRETE CURB AND GUTTER (SEE DETAIL 01 ON SHEET C9.01)
- C. FLAT CURB SECTION (SEE DETAIL 03 ON SHEET C9.01)
- D. ARCHITECTURAL PLANTER CURB (SEE DETAIL 6 ON SHEET L1.02)
- E. RAISED CONCRETE PLANTER (SEE STRUCTURAL PLANS)
- F. MEET AND MATCH EXISTING CURB
- G. MEET AND MATCH EXISTING CONCRETE
- H. TACTILE WARNING STRIP (SEE DETAIL 09 ON SHEET C9.02)
- I. HANDRAIL (SEE ARCHITECTURAL PLANS)
- J. MEET AND MATCH EXISTING PAVEMENT
- K. RELOCATED SIGN
- L. REPLACE/RESTORE BITUMINOUS PAVEMENT SECTION TO MATCH EXISTING SECTION AT A MINIMUM OR PER DETAIL 10 ON SHEET C9.02.

PL201900066
PL2019-66

ENGINEERING DIVISION
 Approved By: Julie Long, PE
 06/04/2019 3:39:57 PM

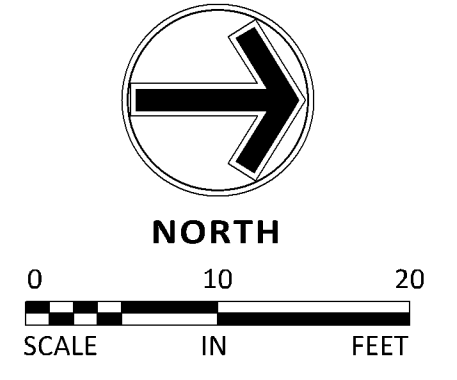

2019 BLOOMINGTON ICE GARDEN REMODEL
 3600 W 98TH ST MINNEAPOLIS, MN 55431

7 MARCH, 2019

SITE PLAN

C3.01

REVISION SCHEDULE

NO.	DESCRIPTION	DATE
1	CONSTRUCTION	3/4/2019
2	ADDENDUM 01	3/27/2019
3	ASI #1	5/28/2019

I hereby certify that this survey, plan or report was prepared by me or under my direct supervision and that I am a duly Licensed Professional ARCHITECT under the laws of the State of Minnesota.
 Date: 3/4/2019
 Registration No. 53234
 J. Ash McKinney

2019 BLOOMINGTON ICE GARDEN REMODEL
3600 W 98TH ST MINNEAPOLIS, MN 55431

7 MARCH, 2019
ADA ROUTE PLAN

C3.02

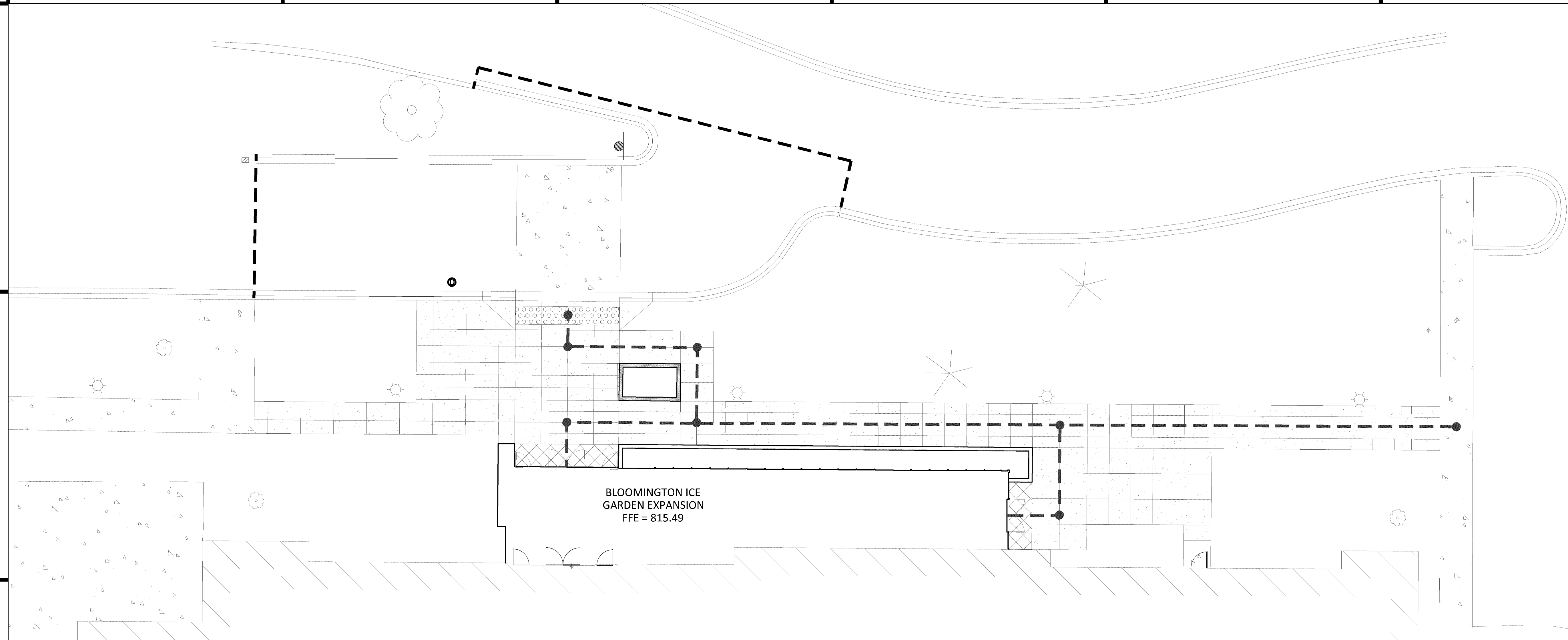

PL201900066
PL2019-66

LEGEND

- PROPOSED ACCESSIBLE ROUTE
- TURNING MOVEMENT LOCATION

ACCESSIBILITY NOTES

1. CONTRACTOR IS TO ENSURE ADA ROUTE IS COMPLIANT WITH ADA AND MINNESOTA STATE ACCESSIBILITY CODE REGULATIONS AND IS TO NOTIFY ENGINEER IF FIELD CONDITIONS PROHIBIT COMPLIANCE.
2. ALL GRADIENT ON SIDEWALKS ALONG THE ADA ROUTE SHALL HAVE A MAXIMUM LONGITUDINAL SLOPE OF 5% (1:20), EXCEPT AT CURB RAMPS (1:12), AND A MAXIMUM CROSS SLOPE OF 2.08% (1:48). MAXIMUM SLOPE IN ANY DIRECTION ON AN ADA PARKING STALL OR ACCESS AISLE SHALL BE IN 2.08% (1:48). CONTRACTOR SHALL REVIEW AND VERIFY THE GRADIENT IN THE FIELD ALONG THE ADA ROUTES PRIOR TO PLACING CONCRETE OR BITUMINOUS. CONTRACTOR SHALL NOTIFY THE ENGINEER IMMEDIATELY IF THERE IS A DISCREPANCY BETWEEN THE GRADIENT IN THE FIELD VERSUS THE DESIGN GRADIENT. COORDINATE ALL WORK WITH PAVING CONTRACTOR.
3. ALL TURNING LOCATIONS SHOWN SHOULD PROVIDE A MAXIMUM SLOPE OF 2% IN ALL DIRECTIONS IN A 4'x4' AREA.

ENGINEERING DIVISION
Approved By: Julie Long, PE
06/04/2019 3:40:08 PM

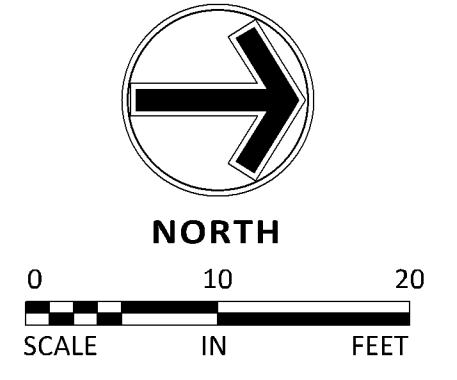

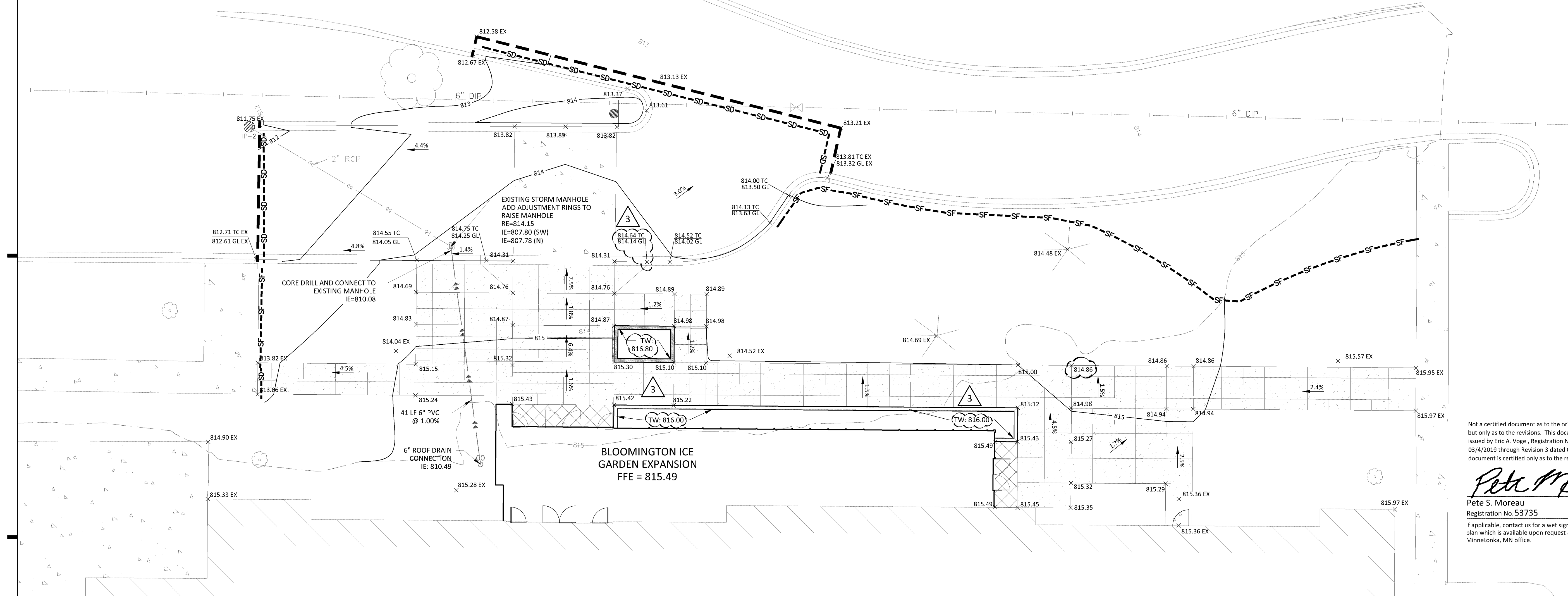

NO.	DESCRIPTION	DATE
1	CONSTRUCTION	3/4/2019
2	ADDENDUM 01	3/27/2019
3	ASI #1	5/28/2019

Not a certified document as to the original document but only as to the revisions. This document originally issued by Eric A. Vogel, Registration No. 54914 on 03/4/2019 through Revision 3 dated 05/28/2019. This document is certified only as to the revisions.

Pete S. Moreau
Pete S. Moreau
Registration No. 53735

If applicable, contact us for a wet signed copy of this plan which is available upon request at Sambatek's, Minnetonka, MN office.

I hereby certify that this plan, specification or report was prepared by me or under my direct supervision and that I am a duly licensed professional engineer under the laws of the state of Minnesota.
Eric A. Vogel
Registration No. 54914
Date: 3/4/2019
If applicable, contact us for a wet signed copy of this plan which is available upon request at Sambatek's, Minnetonka, MN office.

GRADING NOTES

- PROPOSED CONTOURS ARE TO FINISHED SURFACE ELEVATION. SPOT ELEVATIONS ALONG PROPOSED CURB DENOTE GUTTER GRADE.
- CONTRACTOR SHALL REVIEW PAVEMENT GRADIENT AND CONSTRUCT "GUTTER OUT" WHERE WATER DRAINS AWAY FROM CURB. ALL OTHER AREAS SHALL BE CONSTRUCTED AS "GUTTER IN" CURB.
- ALL GRADIENT ON SIDEWALKS ALONG THE ADA ROUTE SHALL HAVE A MAXIMUM LONGITUDINAL SLOPE OF 5% (1:20), EXCEPT AT CURB RAMPS (1:12), AND A MAXIMUM CROSS SLOPE OF 2.00% (1:50). MAXIMUM SLOPE IN ANY DIRECTION ON AN ADA PARKING STALL OR ACCESS AISLE SHALL BE IN 2.00% (1:50). CONTRACTOR SHALL REVIEW AND VERIFY THE GRADIENT IN THE FIELD ALONG THE ADA ROUTES PRIOR TO PLACING CONCRETE OR BITUMINOUS. CONTRACTOR SHALL NOTIFY THE ENGINEER IMMEDIATELY IF THERE IS A DISCREPANCY BETWEEN THE GRADIENT IN THE FIELD VERSUS THE DESIGN GRADIENT. COORDINATE ALL WORK WITH PAVING CONTRACTOR.
- CONTRACTOR SHALL TAKE ALL PRECAUTIONS NECESSARY TO AVOID PROPERTY DAMAGE TO ADJACENT PROPERTIES DURING THE CONSTRUCTION PHASES OF THIS PROJECT. CONTRACTOR WILL BE HELD SOLELY RESPONSIBLE FOR ANY DAMAGES TO THE ADJACENT PROPERTIES OCCURRING DURING THE CONSTRUCTION PHASES OF THIS PROJECT.
- SAFETY NOTICE TO CONTRACTORS: IN ACCORDANCE WITH GENERALLY ACCEPTED CONSTRUCTION PRACTICES, CONTRACTOR WILL BE SOLELY AND COMPLETELY RESPONSIBLE FOR CONDITIONS ON THE JOB SITE, INCLUDING SAFETY OF ALL PERSONS AND PROPERTY DURING PERFORMANCE OF THE WORK. THIS REQUIREMENT WILL APPLY CONTINUOUSLY AND NOT BE LIMITED TO NORMAL WORKING HOURS. THE DUTY OF THE ENGINEER OR THE DEVELOPER TO CONDUCT CONSTRUCTION REVIEW OF THE CONTRACTOR'S PERFORMANCE IS NOT INTENDED TO INCLUDE REVIEW OF THE ADEQUACY OF THE CONTRACTOR'S SAFETY MEASURES IN, ON OR NEAR THE CONSTRUCTION SITE.
- CONTRACTOR SHALL COMPLETE THE SITE GRADING CONSTRUCTION IN ACCORDANCE WITH THE REQUIREMENTS OF THE OWNER'S SOILS ENGINEER. ALL SOIL TESTING SHALL BE COMPLETED BY THE OWNER'S SOILS ENGINEER. CONTRACTOR SHALL BE RESPONSIBLE FOR COORDINATING ALL REQUIRED SOIL TESTS AND INSPECTIONS WITH THE SOILS ENGINEER.
A GEOTECHNICAL ENGINEERING SOILS REPORT HAS BEEN COMPLETED BY:
COMPANY: BRAUN INTERTEC
ADDRESS: 11001 HAMPSHIRE AVE S, MINNEAPOLIS, MN 55438
PHONE: 952-995-2000
DATED: 11-30-2018
CONTRACTOR SHALL OBTAIN A COPY OF THE SOILS REPORT.
- CONTRACTOR SHALL COMPLETE DEWATERING AS REQUIRED TO COMPLETE THE SITE GRADING CONSTRUCTION.
- PRIOR TO PLACEMENT OF THE AGGREGATE BASE, A TEST ROLL SHALL BE PERFORMED ON THE STREET AND PARKING AREA SUBGRADE. CONTRACTOR SHALL PROVIDE A LOADED TANDM AXLE TRUCK WITH A GROSS WEIGHT OF 25 TONS. THE TEST ROLLING SHALL BE AT THE DIRECTION OF THE SOILS ENGINEER AND SHALL BE COMPLETED IN AREAS AS DIRECTED BY THE SOILS ENGINEER. CORRECTION OF THE SUBGRADE SOILS SHALL BE COMPLETED IN ACCORDANCE WITH THE REQUIREMENTS OF THE SOILS ENGINEER.
- REPLACE ALL SUBGRADE SOIL DISTURBED DURING THE CONSTRUCTION THAT HAVE BECOME UNSUITABLE AND WILL NOT PASS A TEST ROLL. REMOVE UNSUITABLE SOIL FROM THE SITE AND IMPORT SUITABLE SOIL AT NO ADDITIONAL COST TO THE OWNER.
- CONTRACTOR SHALL BE RESPONSIBLE FOR PROVIDING AND MAINTAINING VEHICULAR AND PEDESTRIAN TRAFFIC CONTROL DEVICES SUCH AS BARRICADES, WARNING SIGNS, DIRECTIONAL SIGNS, FLAGMEN AND LIGHTS TO CONTROL THE MOVEMENT OF TRAFFIC WHERE NECESSARY. TRAFFIC CONTROL DEVICES SHALL CONFORM TO APPROPRIATE MINNESOTA DEPARTMENT OF TRANSPORTATION STANDARDS.
- EXISTING TREES AND OTHER NATURAL VEGETATION WITHIN THE PROJECT AND/OR ADJACENT TO THE PROJECT ARE OF PRIME CONCERN TO THE CONTRACTOR'S OPERATIONS AND SHALL BE A RESTRICTED AREA. CONTRACTOR SHALL PROTECT TREES TO REMAIN AT ALL TIMES. EQUIPMENT SHALL NOT NEEDLESSLY BE OPERATED UNDER NEARBY TREES AND EXTREME CAUTION SHALL BE EXERCISED WHEN WORKING ADJACENT TO TREES. SHOULD ANY PORTION OF THE TREE BRANCHES REQUIRE REMOVAL TO PERMIT OPERATION OF THE CONTRACTOR'S EQUIPMENT, CONTRACTOR SHALL OBTAIN THE SERVICES OF A PROFESSIONAL TREE TRIMMING SERVICE TO TRIM THE TREES PRIOR TO THE BEGINNING OF OPERATION. SHOULD CONTRACTOR'S OPERATIONS RESULT IN THE BREAKING OF ANY LIMBS, THE BROKEN LIMBS SHOULD BE REMOVED IMMEDIATELY AND CUTS SHALL BE PROPERLY PROTECTED TO MINIMIZE ANY LASTING DAMAGE TO THE TREE. NO TREES SHALL BE REMOVED WITHOUT AUTHORIZATION BY THE ENGINEER. COSTS FOR TRIMMING SERVICES SHALL BE CONSIDERED INCIDENTAL TO THE GRADING CONSTRUCTION AND NO SPECIAL PAYMENT WILL BE MADE.

- 11.a. RESTRICTED AREAS SHALL INCLUDE ALL DESIGNATED TREE AREAS OUTSIDE OF THE DESIGNATED CONSTRUCTION ZONE. ALL VEGETATION WITHIN THE RESTRICTED AREAS SHALL REMAIN.
- 11.b. CONTRACTOR SHALL RESTRICT ALL GRADING AND CONSTRUCTION ACTIVITIES TO AREAS DESIGNATED ON THE PLANS. ACTIVITIES WITHIN THE RESTRICTED AREAS MAY BE RESTRICTED TO A NARROWER WIDTH IN THE FIELD TO SAVE ADDITIONAL TREES AS DIRECTED BY THE OWNER.
- 11.c. ACTIVITIES PROHIBITED OUTSIDE OF THE CONSTRUCTION BOUNDARIES WOULD INCLUDE, BUT NOT BE LIMITED TO: SOIL AND OTHER MATERIAL STOCKPILING, EQUIPMENT OR MACHINERY STORAGE, DRIVING OF ANY VEHICLE, LEAKAGE OR SPILLAGE OF ANY "WASHOUT" OR OTHER TOXIC MATERIAL. THE COLLECTION OF OTHER DEBRIS AND SOIL STOCKPILING WILL BE IN AN AREA DETERMINED ON-SITE BY THE ENGINEER.
- 11.d. ALL RESTRICTED AREAS SHALL BE FENCED OFF WITH BRIGHT ORANGE POLYETHYLENE SAFETY NETTING AND STEEL STAKES AS SHOWN ON THE TREE PROTECTION DETAIL. AT NO TIME SHALL THIS FENCING BE REMOVED OR ACTIVITY OF ANY KIND TAKE PLACE WITHIN IT. FINAL PLACEMENT OF ALL PROTECTIVE FENCING SHALL BE COMPLETE BEFORE ANY WORK COMMENCES ON-SITE.
- 11.e. BEFORE COMMENCING WITH ANY EXCAVATION CONTRACTOR SHALL COMPLETE ALL PREPARATORY WORK REGARDING TREE REMOVAL, ROOT PRUNING, TREE PRUNING AND STUMP REMOVAL TO THE SATISFACTION OF THE OWNER.
- EXCAVATE TOPSOIL FROM AREAS TO BE FURTHER EXCAVATED OR REGRADED AND STOCKPILE IN AREAS DESIGNATED ON THE SITE. CONTRACTOR SHALL SALVAGE ENOUGH TOPSOIL FOR RESPREADING ON THE SITE AS SPECIFIED. EXCESS TOPSOIL SHALL BE PLACED IN EMBANKMENT AREAS, OUTSIDE OF BUILDING PADS, ROADWAYS AND PARKING AREAS. CONTRACTOR SHALL SUBCUT CUT AREAS, WHERE TURF IS TO BE ESTABLISHED, TO A DEPTH OF 6 INCHES. RESPREAD TOPSOIL IN AREAS WHERE TURF IS TO BE ESTABLISHED TO A MINIMUM DEPTH OF 6 INCHES.
- FINISHED GRADING SHALL BE COMPLETED, CONTRACTOR SHALL UNIFORMLY GRADE AREAS WITHIN LIMITS OF GRADING, INCLUDING ADJACENT TRANSITION AREAS. PROVIDE A SMOOTH FINISHED SURFACE WITHIN SPECIFIED TOLERANCES, WITH UNIFORM LEVELS OR SLOPES BETWEEN POINTS WHERE ELEVATIONS ARE SHOWN, OR BETWEEN SUCH POINTS AND EXISTING GRADES. AREAS THAT HAVE BEEN FINISHED GRADED SHALL BE PROTECTED FROM SUBSEQUENT CONSTRUCTION OPERATIONS, TRAFFIC AND EROSION. REPAIR ALL AREAS THAT HAVE BECOME RUTTED, ERODED OR HAS SETTLED BELOW THE CORRECT GRADE. ALL AREAS DISTURBED BY THE CONTRACTOR'S OPERATIONS SHALL BE RESTORED TO EQUAL OR BETTER THAN ORIGINAL CONDITION OR TO THE REQUIREMENTS OF THE NEW WORK.
- TOLERANCES
 - THE COMMERCIAL BUILDING SUBGRADE FINISHED SURFACE ELEVATION SHALL NOT VARY BY MORE THAN 0.10 FOOT ABOVE, OR 0.10 FOOT BELOW, THE PRESCRIBED ELEVATION AT ANY POINT WHERE MEASUREMENT IS MADE.
 - THE STREET OR PARKING AREA SUBGRADE FINISHED SURFACE ELEVATION SHALL NOT VARY BY MORE THAN 0.05 FOOT ABOVE, OR 0.10 FOOT BELOW, THE PRESCRIBED ELEVATION OF ANY POINT WHERE MEASUREMENT IS MADE.
 - AREAS WHICH ARE TO RECEIVE TOPSOIL SHALL BE GRADED TO WITHIN 0.30 FOOT ABOVE OR BELOW THE REQUIRED ELEVATION, UNLESS DIRECTED OTHERWISE BY THE ENGINEER.
 - TOPSOIL SHALL BE GRADED TO PLUS OR MINUS 1/2 INCH OF THE SPECIFIED THICKNESS.
- AFTER THE SITE GRADING IS COMPLETED, IF EXCESS OR SHORTAGE OF SOIL MATERIAL EXISTS, CONTRACTOR SHALL TRANSPORT ALL EXCESS SOIL MATERIAL OFF THE SITE TO AN AREA SELECTED BY THE CONTRACTOR, OR IMPORT SUITABLE MATERIAL TO THE SITE.
- CONTRACTOR SHALL DETERMINE THE LOCATION OF ANY HAUL ROADS THAT MAY BE REQUIRED TO COMPLETE THE SITE GRADING CONSTRUCTION AND SHALL INDICATE HAUL ROADS ON EROSION AND SEDIMENT CONTROL "SITE MAP". CONTRACTOR SHALL COMPLY WITH THE REQUIREMENTS OF THE GOVERNING AUTHORITY OF EACH ROADWAY. CONTRACTOR SHALL POST WHATEVER SECURITY, AND COMPLY WITH ALL CONDITIONS WHICH ARE REQUIRED BY EACH GOVERNING AUTHORITY OF EACH ROADWAY.
- FILL PLACED WITHIN THE BUILDING PAD AREAS SHALL BE IN CONFORMANCE WITH HUD/FHA PROCEDURES AND DATA SHEET 796.

LEGEND

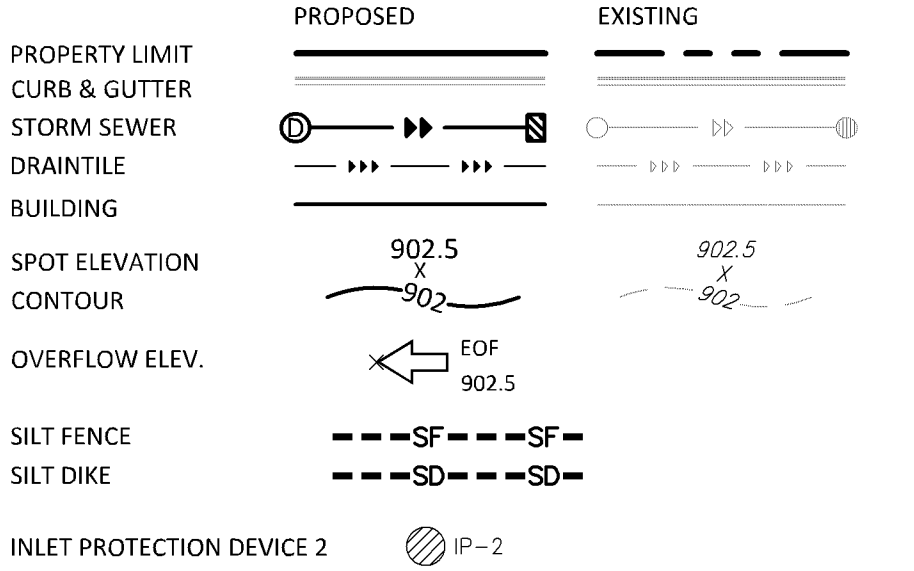

PL201900066
PL2019-66

ENGINEERING DIVISION
Approved By: Julie Long, PE
06/04/2019 3:40:08 PM

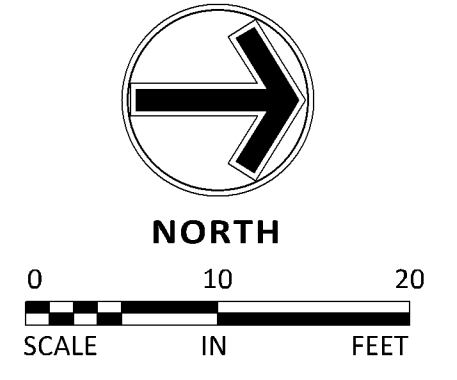

2019 BLOOMINGTON ICE GARDEN REMODEL
3600 W 98TH ST MINNEAPOLIS, MN 55431

7 MARCH, 2019
GRADING PLAN

C4.01

REVISION SCHEDULE

NO.	DESCRIPTION	DATE
1	CONSTRUCTION	3/4/2019
2	ADDENDUM 01	3/27/2019
3	ASI #1	5/28/2019

I hereby certify that this plan, specification or report was prepared by me or under my direct supervision and that I am a duly licensed professional ENGINEER under the laws of the state of Minnesota.
Eric A. Vogel
Registration No. 54914
Date: 3/4/2019
If applicable, contact us for a wet signed copy of this plan which is available upon request at Sambatek's, Minnetonka, MN office.

2019 BLOOMINGTON ICE GARDEN REMODEL
3600 W 98TH ST MINNEAPOLIS, MN 55431

7 MARCH, 2019

DETAILS

C9.01

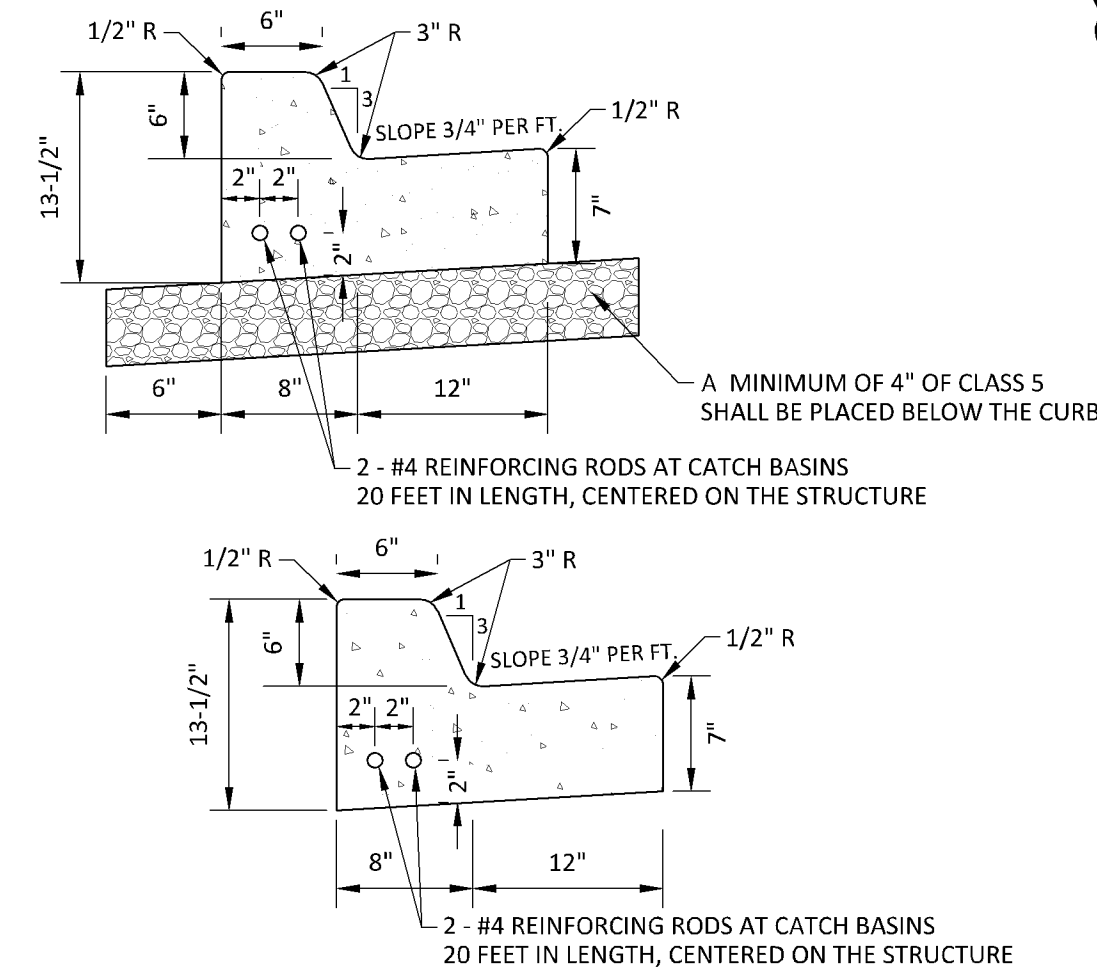

01 B612 CONCRETE CURB & GUTTER
N.T.S.

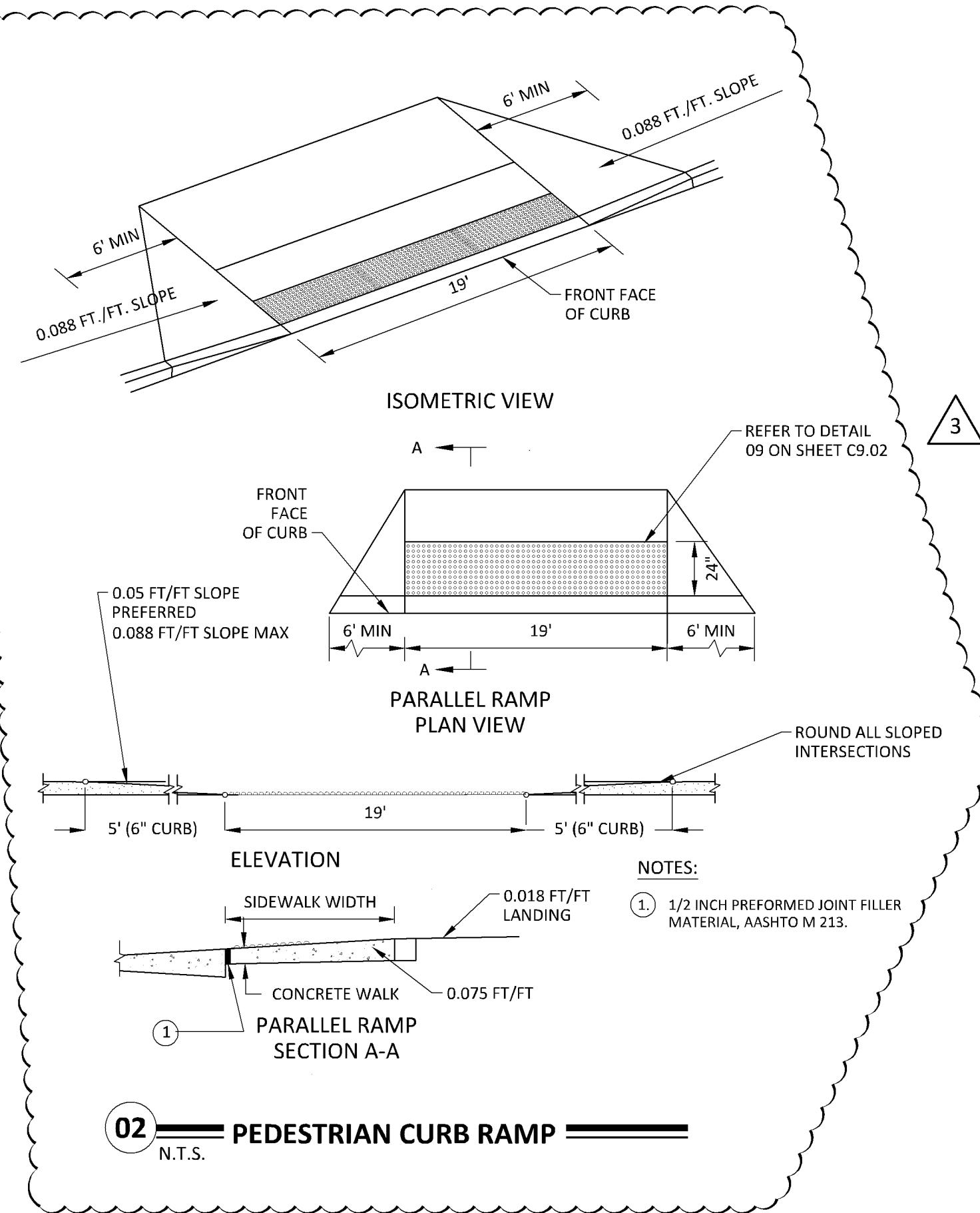

02 PEDESTRIAN CURB RAMP
N.T.S.

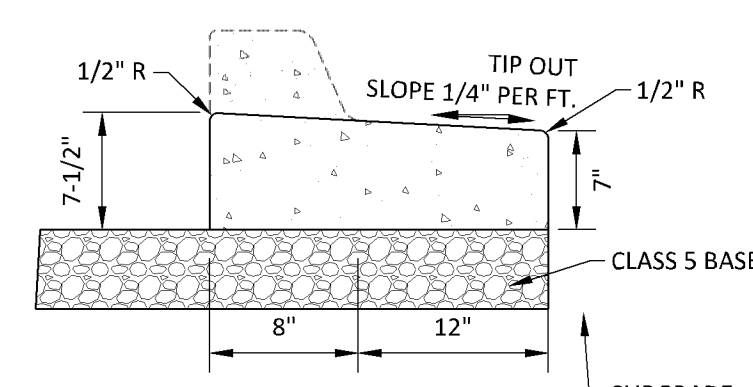

03 FLAT CURB SECTION
N.T.S.

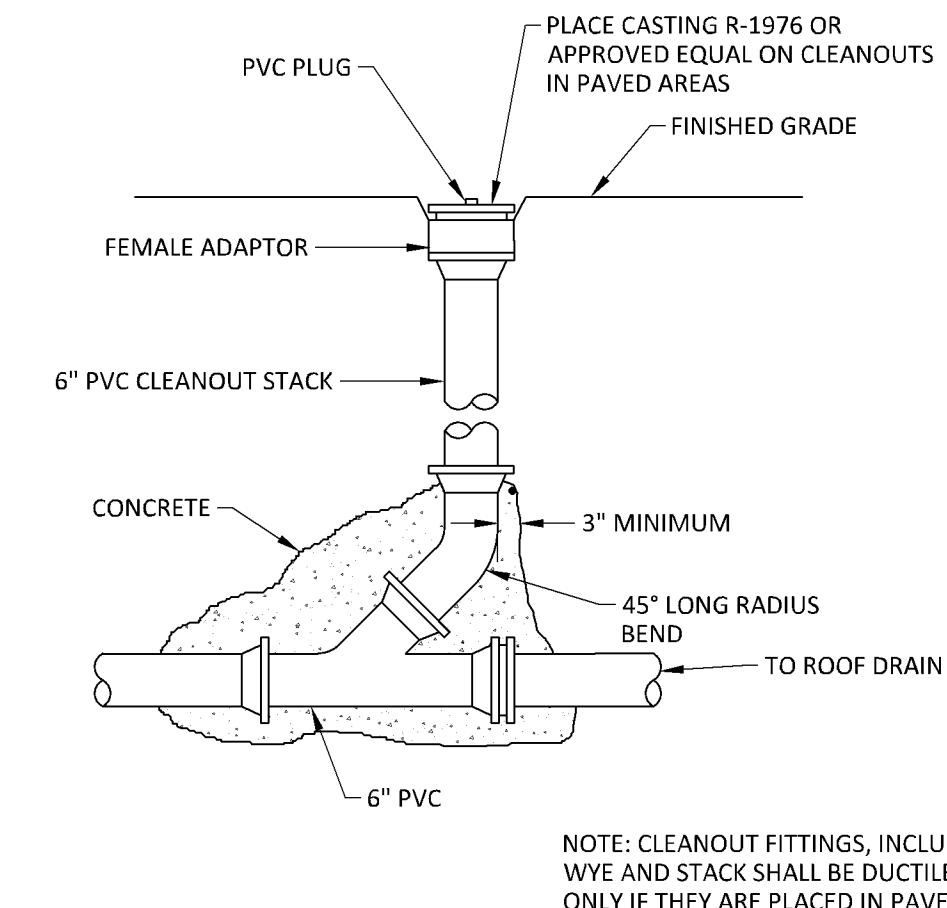

04 TYPICAL CLEANOUT
N.T.S.

Not a certified document as to the original document but only as to the revisions. This document originally issued by Eric A. Vogel, Registration No. 54914 on 03/4/2019 through Revision 3 dated 05/28/2019. This document is certified only as to the revisions.
Pete S. Moreau
Pete S. Moreau
Registration No. 53735
If applicable, contact us for a wet signed copy of this plan which is available upon request at Sambatek's, Minnetonka, MN office.

PL201900066
PL2019-66

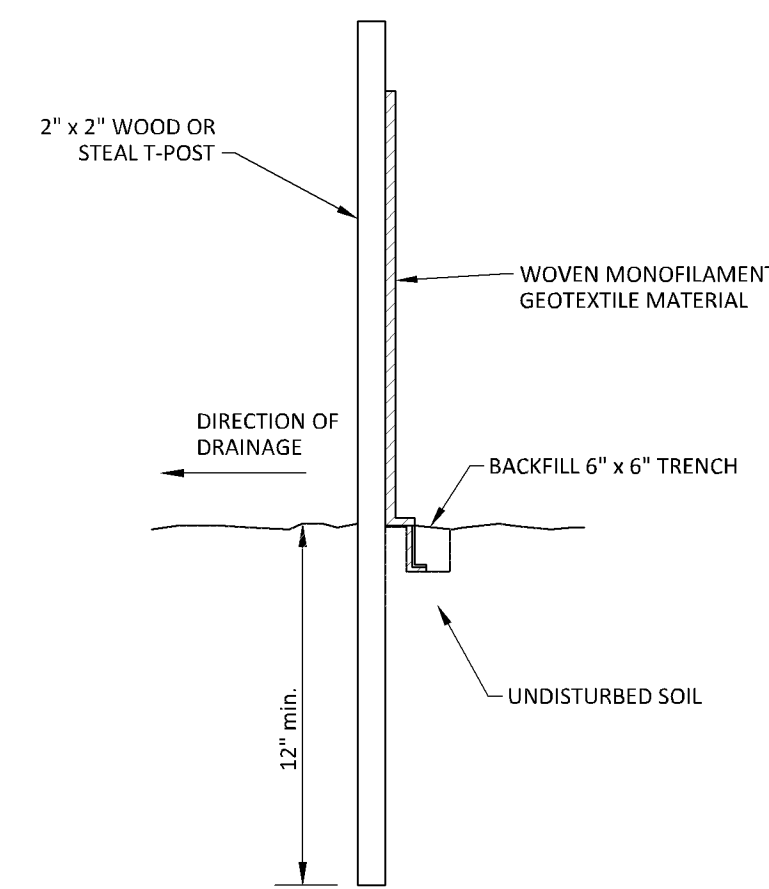

05 SILT FENCE
N.T.S.

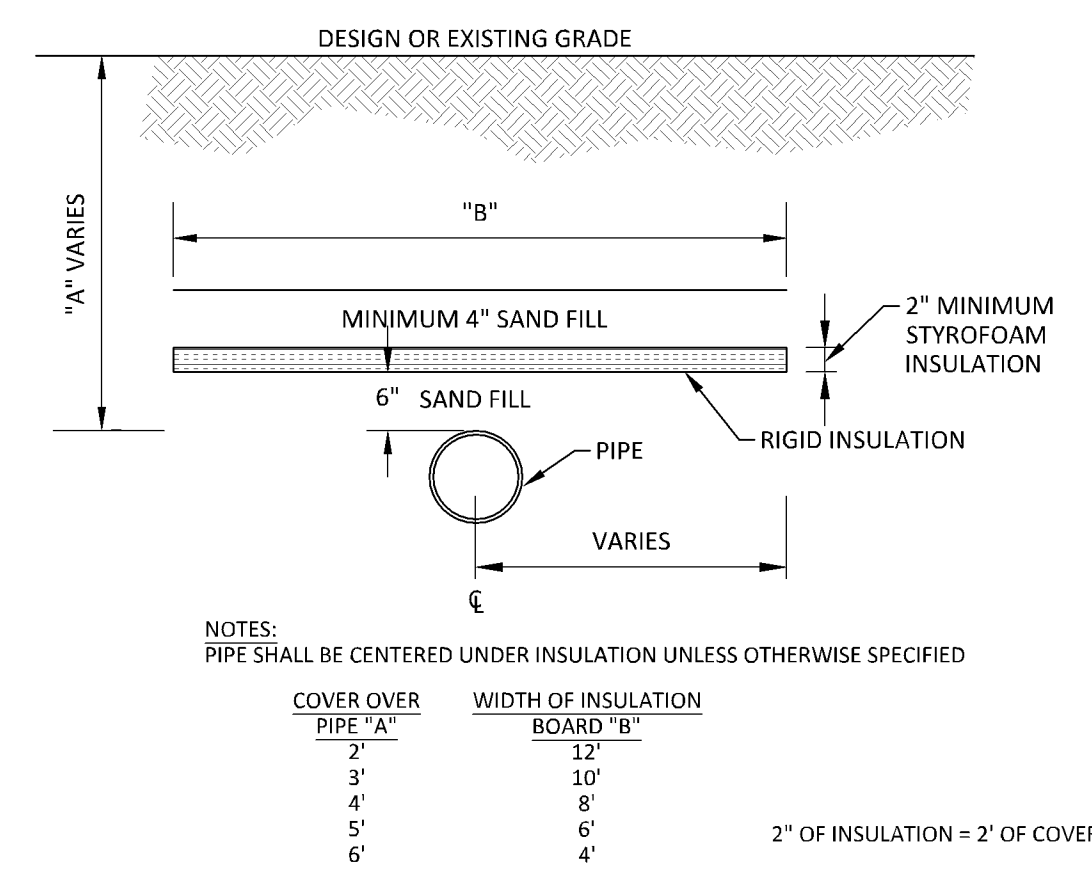

06 INSULATION DETAIL FOR SHALLOW PIPE
N.T.S.

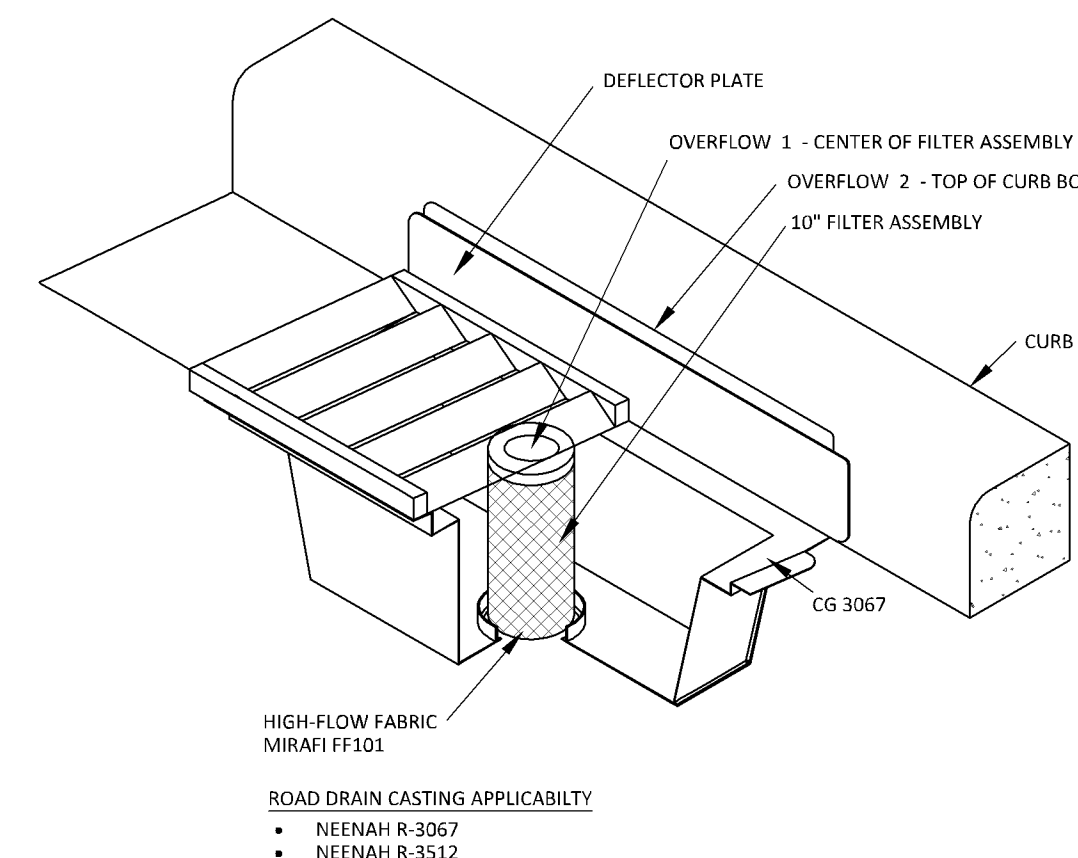

07 ROAD DRAIN INLET PROTECTION (IP-2)
NOT TO SCALE

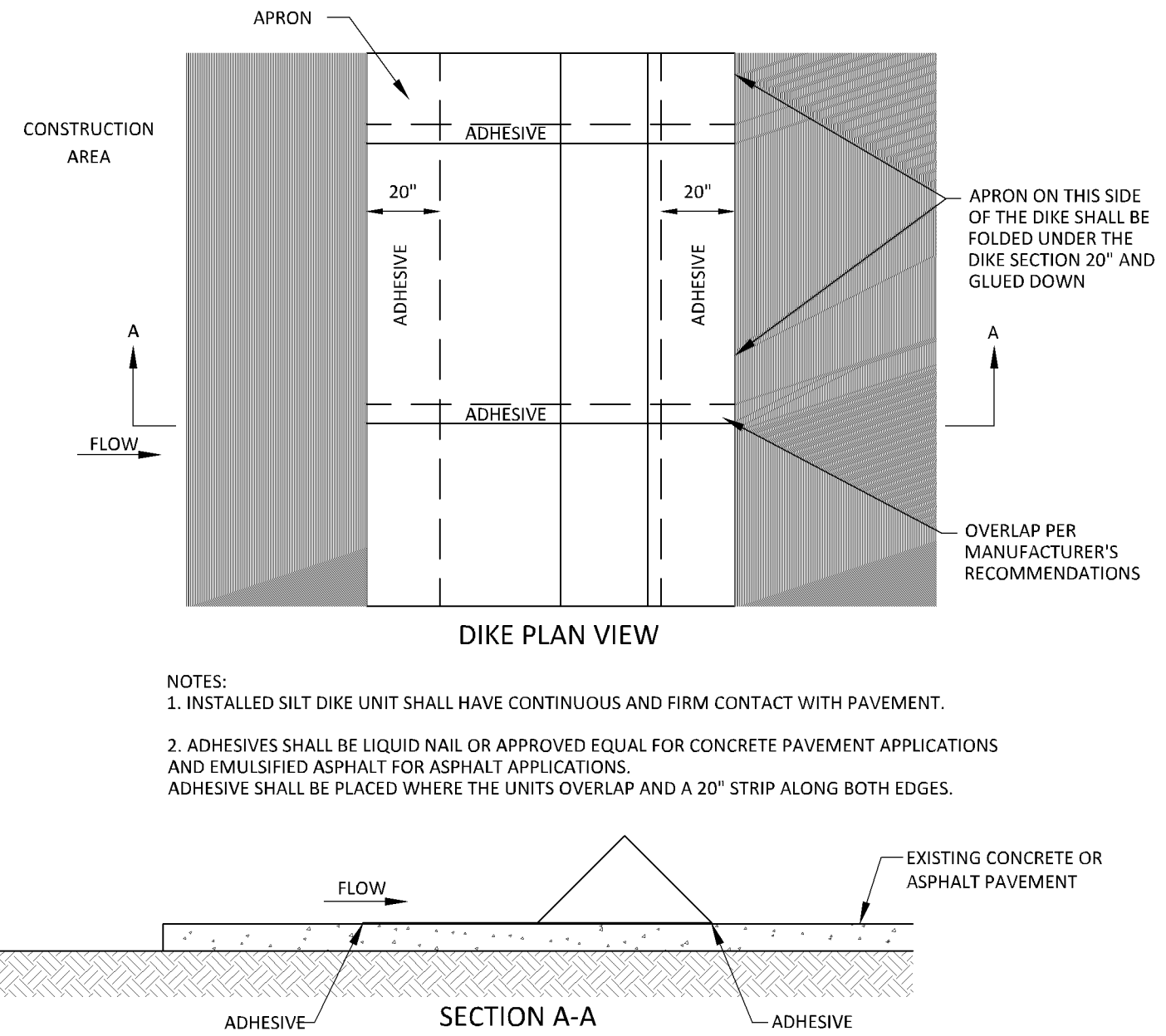

08 SILT DIKE ON PAVEMENT
N.T.S.

ENGINEERING DIVISION
Approved By: Julie Long, PE
06/04/2019 3:40:08 PM

REVISION SCHEDULE

NO.	DESCRIPTION	DATE
1	CONSTRUCTION	3/4/2019
2	ADDENDUM 01	3/27/2019
3	ASI #1	5/28/2019

I hereby certify that this plan, specification or report was prepared by me or under my direct supervision and that I am a duly licensed professional ENGINEER under the laws of the state of Minnesota.
Eric A. Vogel
Registration No. 54914
Date: 3/4/2019
If applicable, contact us for a wet signed copy of this plan which is available upon request at Sambatek's, Minnetonka, MN office.

Not a certified document as to the original document but only as to the revisions. This document originally issued by Eric A. Vogel, Registration No. 54914 on 03/4/2019 through Revision 3 dated 05/28/2019. This document is certified only as to the revisions.

Pete S. Moreau
Pete S. Moreau
Registration No. 53735

If applicable, contact us for a wet signed copy of this plan which is available upon request at Sambatek's, Minnetonka, MN office.

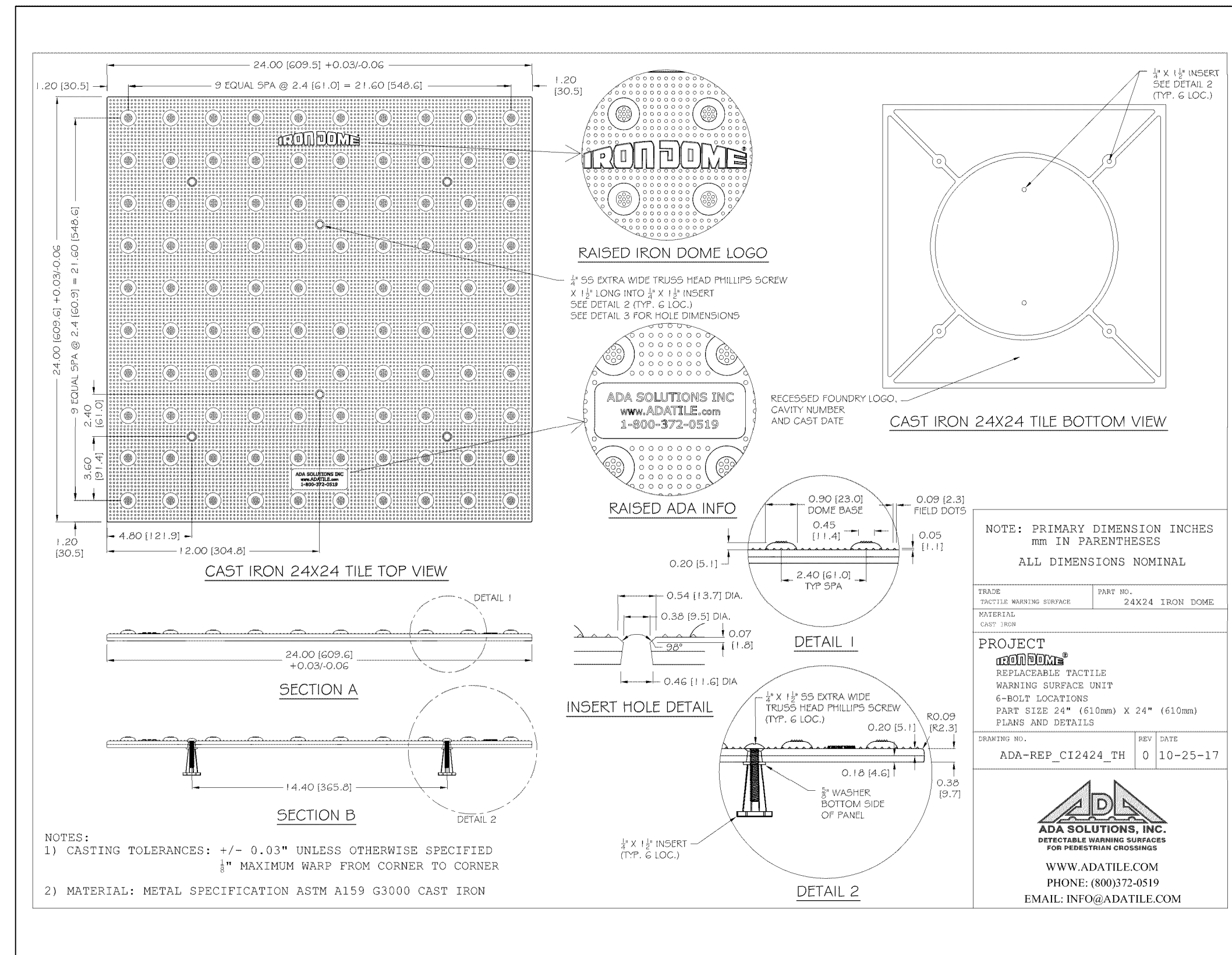

09 TRUNCATED DOME WARNING SURFACE

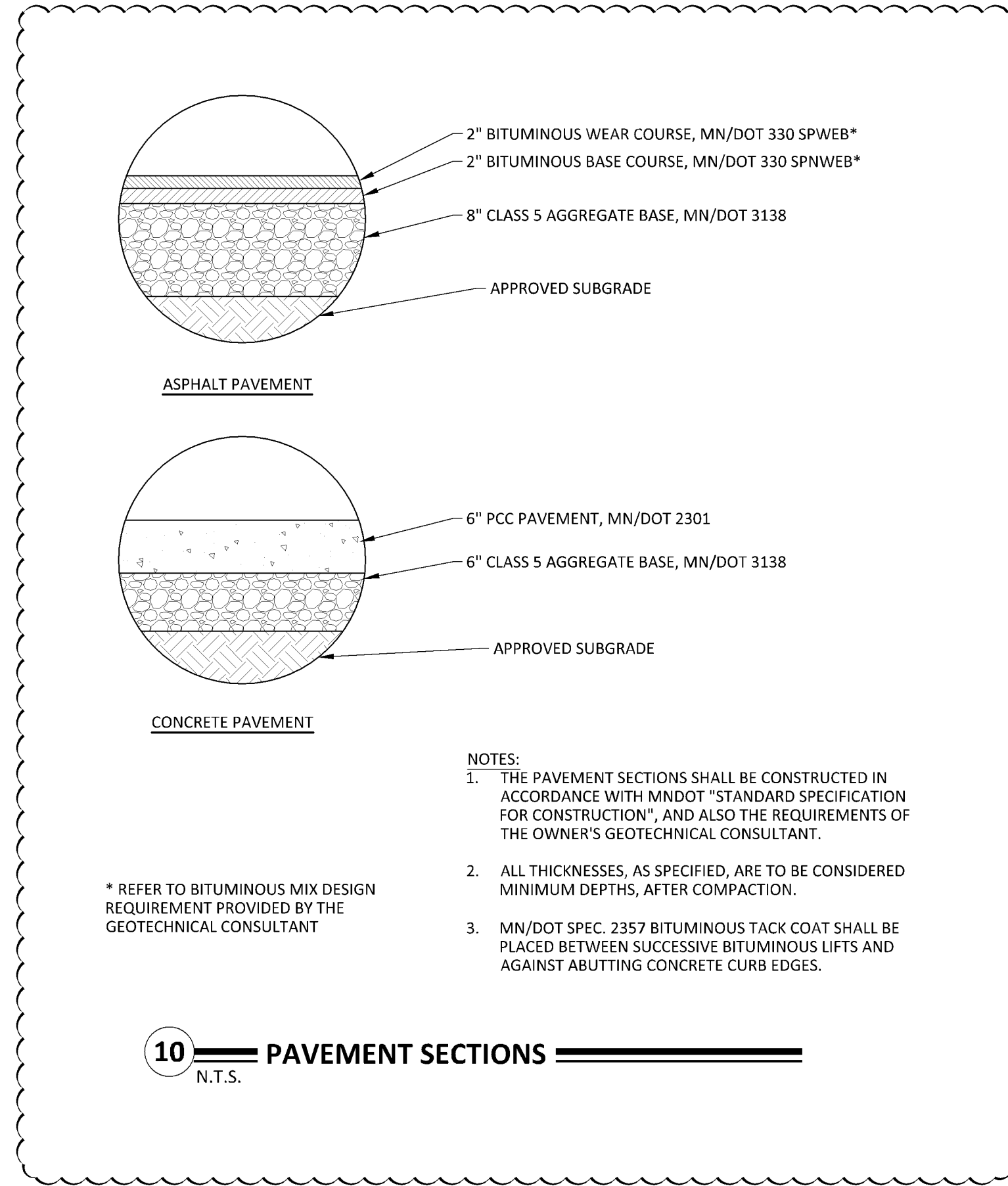

10 PAVEMENT SECTIONS
N.T.S.

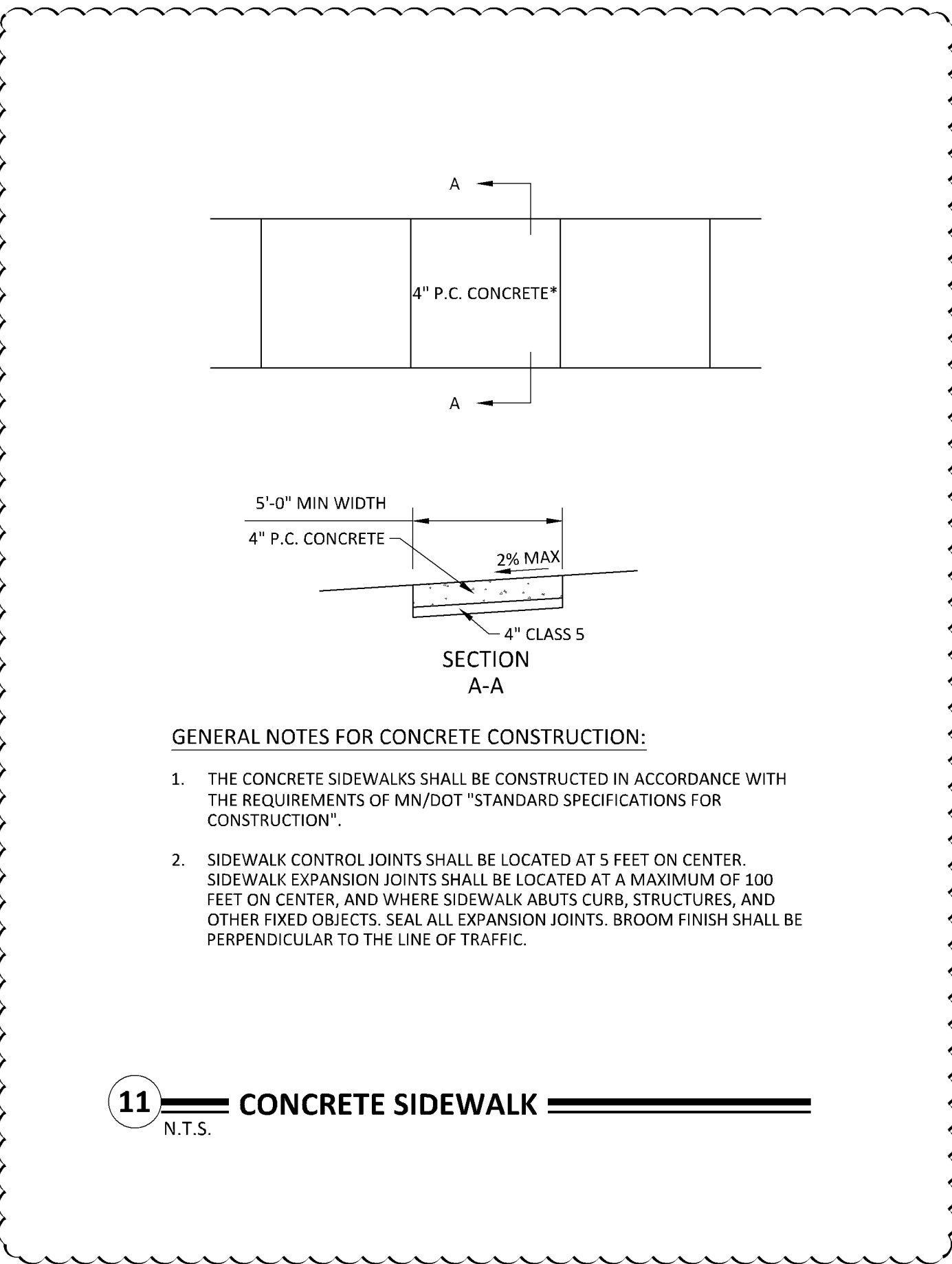

11 CONCRETE SIDEWALK
N.T.S.

ENGINEERING DIVISION
Approved By: Julie Long, PE
06/04/2019 3:40:08 PM

PL201900066
PL2019-66

2019 BLOOMINGTON ICE GARDEN REMODEL
3600 W 98TH ST MINNEAPOLIS, MN 55431

7 MARCH, 2019

DETAILS

C9.02

REVISION SCHEDULE

NO.	DESCRIPTION	DATE
1	CONSTRUCTION	3/4/2019
2	ADDENDUM 01	3/27/2019
3	ASI #1	5/28/2019

I hereby certify that this survey, plan or report was prepared by me or under my supervision and I am a duly Licensed Professional Landscape Architect under the laws of the State of Minnesota.
 J. Ash McKinney
 Registration No. 55234
 Date: 3/4/2019
 This certification is void unless signed in blank. If it is available upon request at Cambridge, Minnesota, MN office.

2019 BLOOMINGTON ICE GARDEN REMODEL
3600 W 98TH ST MINNEAPOLIS, MN 55431

7 MARCH, 2019
LANDSCAPE PLAN

L1.01

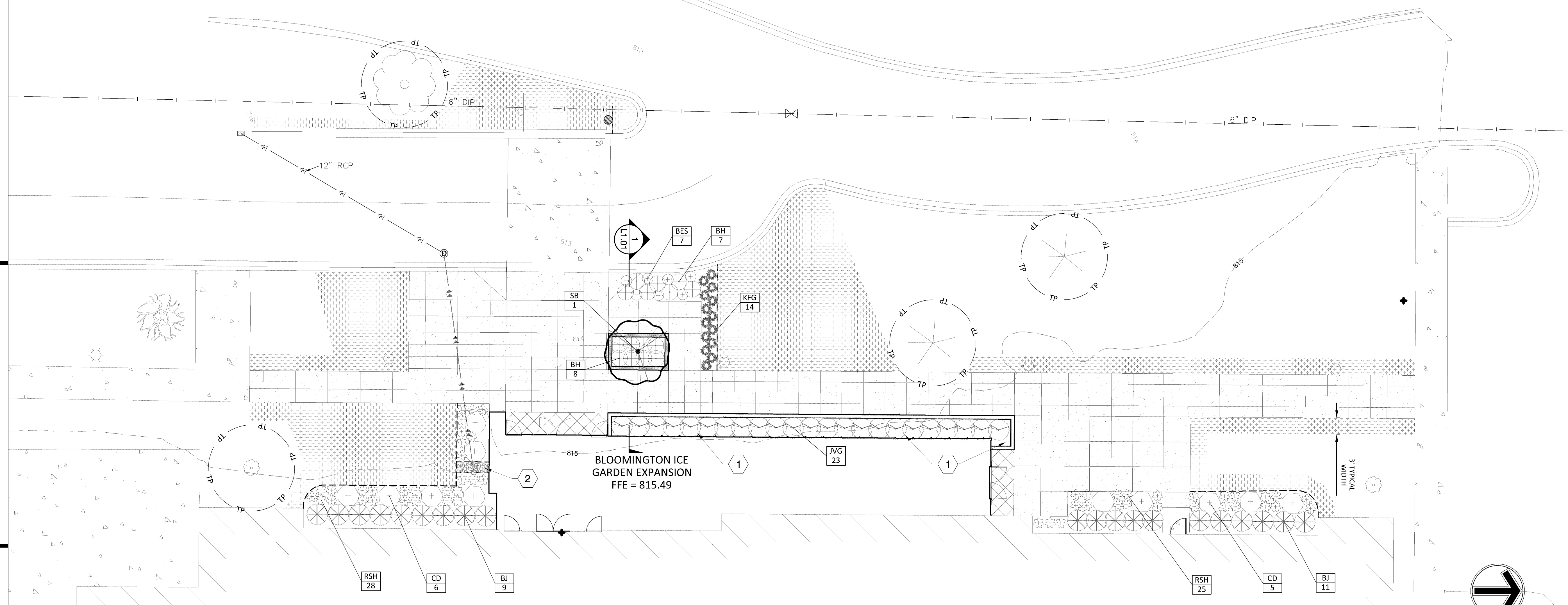

PLANT SCHEDULE					
ORN. TREES	CODE	BOTANICAL NAME / COMMON NAME	CONT	CAL	QTY
	SB	Amelanchier canadensis 'Autumn Brilliance' / Autumn Brilliance Serviceberry	B & B	2" Cal	1
SHRUBS	CODE	BOTANICAL NAME / COMMON NAME	CONT		QTY
	CD	Cornus sericea 'Alleman's Compact' / Dwarf Red Twig Dogwood	5 gal		11
	BH	Diervilla lonicera / Dwarf Bush Honeysuckle	5 gal		15
	BJ	Juniperus sabina 'Broadmoor' / Broadmoor Juniper	5 gal		20
	JVG	Juniperus virginiana 'Grey Owl' / Grey Owl Juniper	5 gal.		23
GRASSES	CODE	BOTANICAL NAME / COMMON NAME	CONT		QTY
	KFG	Calamagrostis x acutiflora 'Karl Foerster' / Feather Reed Grass	1 gal		14
PERENNIALS	CODE	BOTANICAL NAME / COMMON NAME	CONT		QTY
	RSH	Hosta x 'Regal Splendor' / Plantain Lily	1 gal		53
	BES	Rudbeckia fulgida 'Goldstrum' / Black Eyed Susan	1 gal		7
GROUND COVERS	CODE	BOTANICAL NAME / COMMON NAME	CONT		QTY
	TUR HIG	Turf Sod Highland Sod / Sod	Sod		2,463 sf

REFERENCE NOTES SCHEDULE	
SYMBOL	DESCRIPTION
1	ROCK MULCH - 3/4" DRESSER TRAP ROCK W/ FABRIC
2	ROCK MULCH - 4" DRESSER TRAP ROCK W/ FABRIC. LOCATE AT OVERFLOW ROOF DRAIN

ENGINEERING DIVISION
Approved By: Julie Long, PE
06/04/2019 3:40:08 PM

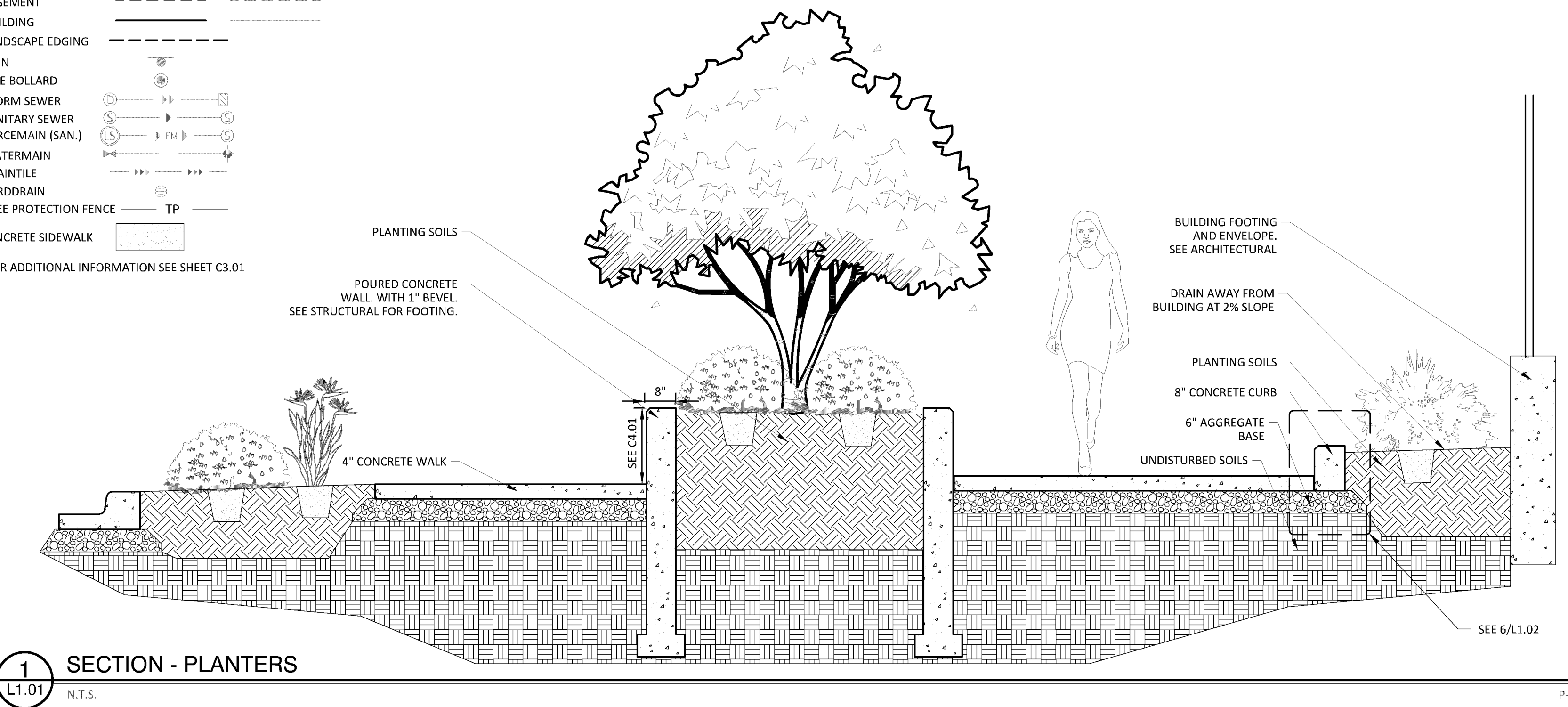
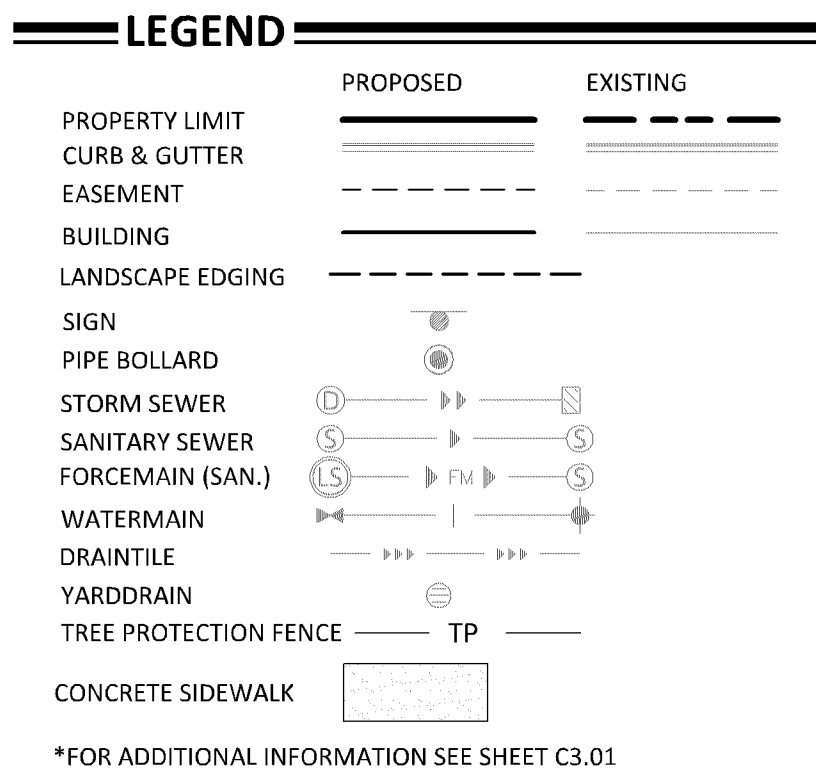

PL201900066
PL2019-66

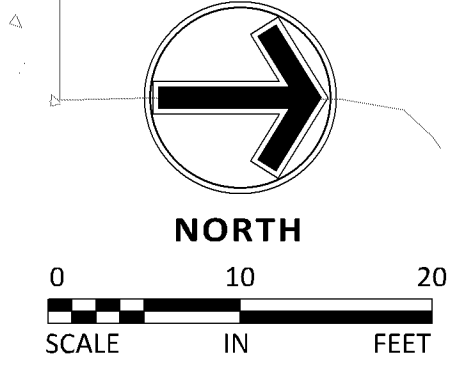

19 December, 2018

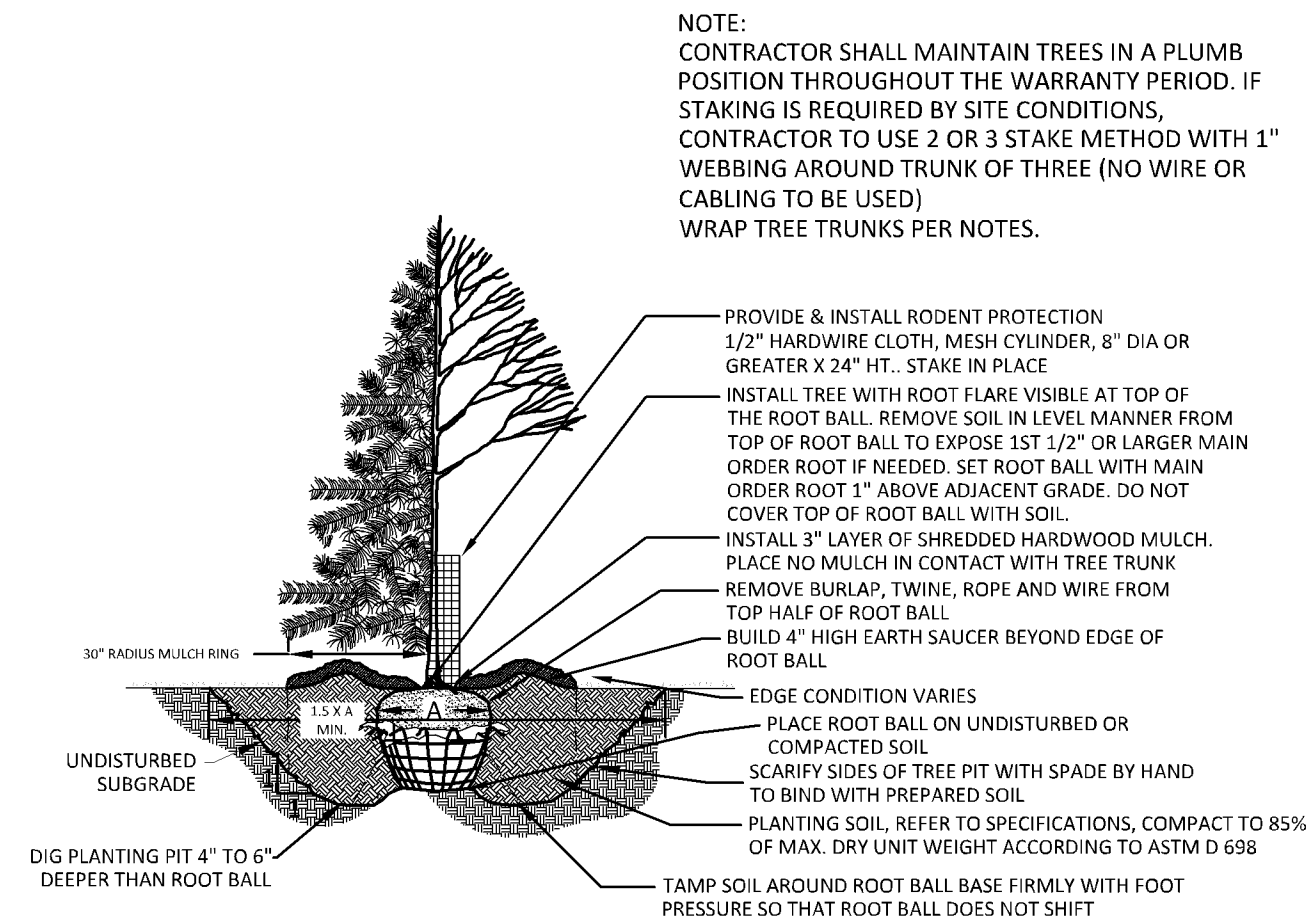

1 TREE PLANTING DETAIL
L1.02 1/4" = 1'-0" P-01

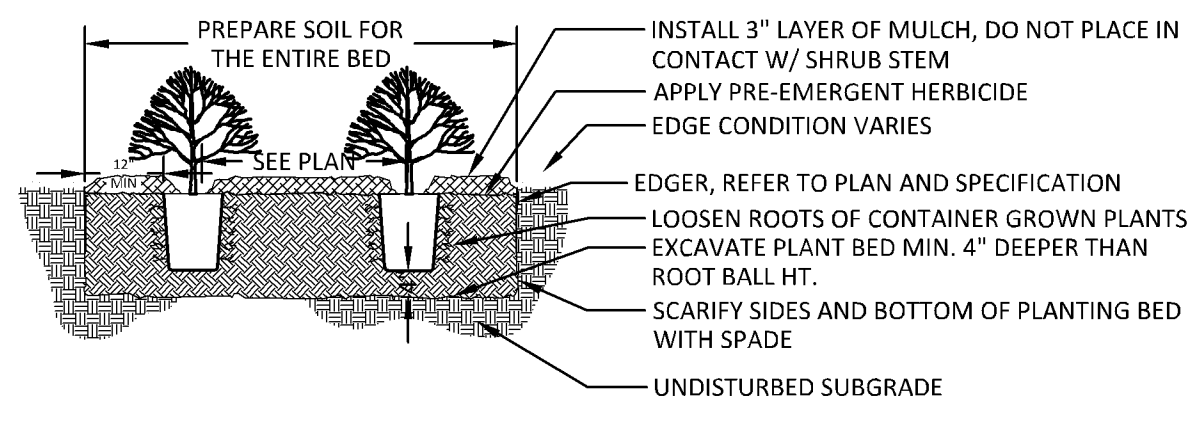

2 SHRUB PLANTING DETAIL
L1.02 3/8" = 1'-0" P-02

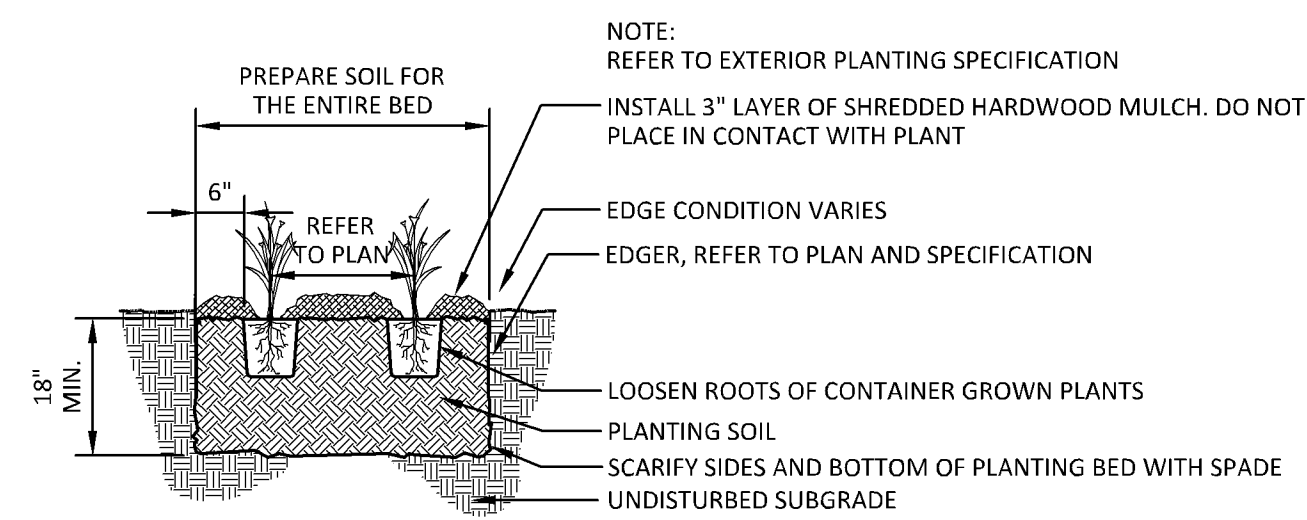

3 PERENNIAL PLANTING DETAIL
L1.02 1/2" = 1'-0" P-03

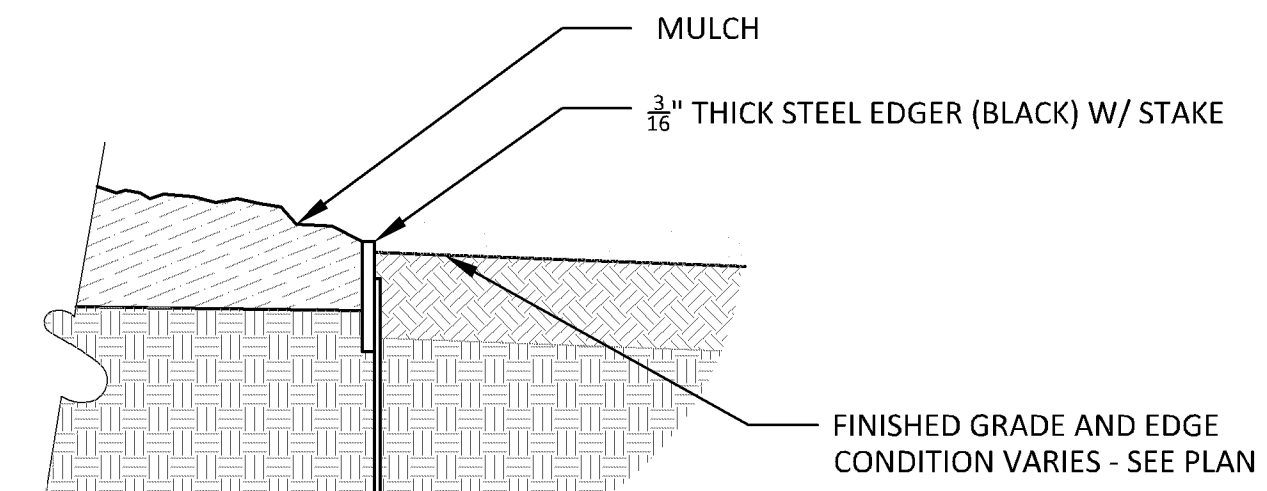

4 STEEL EDGER
L1.02 1 1/2" = 1'-0" P-04

NOTES

GENERAL NOTES:

- THE CONTRACTOR SHALL INSPECT THE SITE AND BECOME FAMILIAR WITH THE EXISTING CONDITIONS RELATING TO THE NATURE AND SCOPE OF THE WORK.
- THE CONTRACTOR SHALL VERIFY PLAN LAYOUT AND BRING TO THE ATTENTION OF THE LANDSCAPE ARCHITECT DISCREPANCIES WHICH MAY COMPROMISE THE DESIGN OR INTENT OF THE LAYOUT.
- THE CONTRACTOR SHALL BE RESPONSIBLE FOR COMPLYING WITH ALL APPLICABLE CODES, REGULATIONS, AND PERMITS GOVERNING THE WORK.
- THE CONTRACTOR SHALL PROTECT EXISTING ROADS, CURBS/GUTTERS, TRAILS, TREES, LAWNS AND SITE ELEMENTS DURING CONSTRUCTION. DAMAGE TO SAME SHALL BE REPAIRED AND/OR REPLACED AT NO ADDITIONAL COST TO THE OWNER.
- LOCATE AND VERIFY ALL UTILITIES, INCLUDING IRRIGATION LINES, WITH THE OWNER FOR PROPRIETARY UTILITIES AND GOPHER STATE ONE CALL 48 HOURS BEFORE DIGGING. CONTRACTOR SHALL BE RESPONSIBLE FOR THE PROTECTION AND REPAIR OF ANY DAMAGES TO SAME. NOTIFY THE LANDSCAPE ARCHITECT OF ANY CONFLICTS TO FACILITATE PLANT RELOCATION.
- THE LANDSCAPE CONTRACTOR SHALL COORDINATE THE PHASES OF CONSTRUCTION AND PLANTING INSTALLATION WITH OTHER CONTRACTORS WORKING ON SITE.
- THE CONTRACTOR SHALL REVIEW THE SITE FOR DEFICIENCIES IN SITE CONDITIONS WHICH MIGHT NEGATIVELY AFFECT PLANT ESTABLISHMENT, SURVIVAL OR WARRANTY. UNDESIRABLE SITE CONDITIONS SHALL BE BROUGHT TO THE ATTENTION OF THE LANDSCAPE ARCHITECT PRIOR TO BEGINNING OF WORK.
- THE PLAN TAKES PRECEDENCE OVER THE LANDSCAPE LEGEND IF DISCREPANCIES EXIST. QUANTITIES SHOWN IN THE PLANTING SCHEDULE ARE FOR THE CONTRACTOR'S CONVENIENCE. CONTRACTOR TO VERIFY QUANTITIES SHOWN ON THE PLAN.
- THE SPECIFICATIONS TAKE PRECEDENCE OVER THE PLANTING NOTES AND GENERAL NOTES.
- EXISTING TREES AND SHRUBS TO REMAIN SHALL BE PROTECTED TO THE DRIP LINE FROM ALL CONSTRUCTION TRAFFIC, STORAGE OF MATERIALS ETC. WITH 4" HT. ORANGE PLASTIC SAFETY FENCING ADEQUATELY SUPPORTED BY STEEL FENCE POSTS 6' O.C. MAXIMUM SPACING.
- LONG-TERM STORAGE OF MATERIALS OR SUPPLIES ON-SITE WILL NOT BE ALLOWED.
- CONTRACTOR SHALL REQUEST IN WRITING, A FINAL ACCEPTANCE INSPECTION.

PLANTING NOTES:

- NO PLANTS SHALL BE INSTALLED UNTIL FINAL GRADING AND CONSTRUCTION HAS BEEN COMPLETED IN THE IMMEDIATE AREA.
- A GRANULAR PRE-EMERGENT HERBICIDE SHALL BE APPLIED TO ALL PLANT BEDS AT THE MANUFACTURER'S RECOMMENDED RATE PRIOR TO PLANT INSTALLATION.
- ALL PLANTING STOCK SHALL CONFORM TO THE "AMERICAN STANDARD FOR NURSERY STOCK," ANSI-Z60, LATEST EDITION, OF THE AMERICAN ASSOCIATION OF NURSERYMEN, INC. AND SHALL CONSTITUTE MINIMUM QUALITY REQUIREMENTS FOR PLANT MATERIALS.
- OVERSTORY TREES SHALL BEGIN BRANCHING NO LOWER THAN 6' ABOVE PAVED SURFACES.
- ALL PLANTS MUST BE HEALTHY, VIGOROUS MATERIAL, FREE OF PESTS AND DISEASE AND BE CONTAINER GROWN OR BALLED AND BURLAPPED AS INDICATED IN THE LANDSCAPE LEGEND.
- PLANT MATERIALS TO BE INSTALLED PER PLANTING DETAILS.
- ALL TREES MUST BE STRAIGHT TRUNKED AND FULL HEADED AND MEET ALL REQUIREMENTS SPECIFIED.
- THE LANDSCAPE ARCHITECT RESERVES THE RIGHT TO REJECT ANY PLANTS WHICH ARE DEEMED UNSATISFACTORY BEFORE, DURING, OR AFTER INSTALLATION.
- NO SUBSTITUTIONS OF PLANT MATERIAL SHALL BE ACCEPTED UNLESS APPROVED IN WRITING BY THE LANDSCAPE ARCHITECT.
- ALL PLANT MATERIAL QUANTITIES, SHAPES OF BEDS AND LOCATIONS SHOWN ARE APPROXIMATE. CONTRACTOR SHALL BE RESPONSIBLE FOR COMPLETE COVERAGE OF ALL PLANTING BEDS AT SPACING SHOWN AND ADJUSTED TO CONFORM TO THE EXACT CONDITIONS OF THE SITE. THE LANDSCAPE ARCHITECT SHALL APPROVE THE STAKING LOCATION OF ALL PLANT MATERIALS PRIOR TO INSTALLATION.
- ALL PLANTING AREAS MUST BE COMPLETELY MULCHED AS SPECIFIED.
- MULCH: SHREDDED HARDWOOD MULCH, CLEAN AND FREE OF NOXIOUS WEEDS OR OTHER DELETERIOUS MATERIAL, IN ALL MASS PLANTING BEDS AND FOR TREES, UNLESS INDICATED AS ROCK MULCH ON DRAWINGS. SUBMIT SAMPLE TO LANDSCAPE ARCHITECT PRIOR TO DELIVERY ON-SITE FOR APPROVAL. DELIVER MULCH ON DAY OF INSTALLATION. USE 4" FOR SHRUB BEDS, AND 3" FOR PERENNIAL/GROUND COVER BEDS, UNLESS OTHERWISE DIRECTED.
- THE CONTRACTOR SHALL BE RESPONSIBLE FOR ALL MULCHES AND PLANTING SOIL QUANTITIES TO COMPLETE THE WORK SHOWN ON THE PLAN.
- USE ANTI-DESICCANT (WILT-PROOF OR APPROVED EQUAL) ON DECIDUOUS PLANTS MOVED IN LEAF AND FOR EVERGREENS MOVED ANYTIME. APPLY AS PER MANUFACTURER'S INSTRUCTION. ALL EVERGREENS SHALL BE SPRAYED IN THE LATE FALL FOR WINTER PROTECTION DURING WARRANTY PERIOD.
- PLANTING SOIL FOR TREES, SHRUBS AND GROUND COVERS: FERTILE FRIABLE LOAM CONTAINING A LIBERAL AMOUNT (4% MIN.) OF HUMUS AND CAPABLE OF SUSTAINING VIGOROUS PLANT GROWTH. IT SHALL COMPLY WITH MNDOT SPECIFICATION 3877 TYPE B SELECT TOPSOIL. MIXTURE SHALL BE FREE FROM HARDPACK SUBSOIL, STONES, CHEMICALS, NOXIOUS WEEDS, ETC. SOIL MIXTURE SHALL HAVE A PH BETWEEN 6.1 AND 7.5 AND 10-0-10 FERTILIZER AT THE RATE OF 3 POUNDS PER CUBIC YARD. IN PLANTING BEDS INCORPORATE THIS MIXTURE THROUGHOUT THE ENTIRE BED IN A 6" LAYER AND ROTOTILLING IT INTO THE TOP 12" OF SOIL AT A 1:1 RATIO. ANY PLANT STOCK NOT PLANTED ON DAY OF DELIVERY SHALL BE HELED IN AND WATERED UNTIL INSTALLATION. PLANTS NOT MAINTAINED IN THIS MANNER WILL BE REJECTED.
- ALL PLANTS SHALL BE GUARANTEED FOR TWO COMPLETE GROWING SEASONS (APRIL 1 - NOVEMBER 1), UNLESS OTHERWISE SPECIFIED. THE GUARANTEE SHALL COVER THE FULL COST OF REPLACEMENT INCLUDING LABOR AND PLANTS.
- CONTRACTOR SHALL NOTIFY THE LANDSCAPE ARCHITECT AT LEAST 3 DAYS PRIOR TO PLANNED DELIVERY. THE CONTRACTOR SHALL NOTIFY THE LANDSCAPE ARCHITECT AT LEAST 24 HOURS IN ADVANCE OF BEGINNING PLANT INSTALLATION.
- SEASONS/TIME OF PLANTING AND SEEDING: NOTE: THE CONTRACTOR MAY ELECT TO PLANT IN OFF-SEASONS ENTIRELY AT HIS/HER RISK. DECIDUOUS
 - POTTED PLANTS: 4/1 - 6/1; 9/21 - 11/1
 - DECIDUOUS B&B: 4/1 - 6/1; 9/21 - 11/1
 - EVERGREEN POTTED PLANTS: 4/1 - 6/1; 9/21-11/1
 - EVERGREEN B&B: 4/1 - 5/1; 9/21 - 11/1
 - TURF/LAWN SEEDING: 4/1 - 6/1; 7/20 - 9/20
 - NATIVE MIX SEEDING: 4/1 - 7/20; 9/20-10/20
- MAINTENANCE SHALL BEGIN IMMEDIATELY AFTER EACH PORTION OF THE WORK IS IN PLACE. PLANT MATERIAL SHALL BE PROTECTED AND MAINTAINED UNTIL THE INSTALLATION OF THE PLANTS IS COMPLETE. INSPECTION HAS BEEN MADE, AND PLANTINGS ARE ACCEPTED EXCLUSIVE OF THE GUARANTEE. MAINTENANCE SHALL INCLUDE WATERING, CULTIVATING, MULCHING,

- REMOVAL OF DEAD MATERIALS, RE-SETTING PLANTS TO PROPER GRADE AND KEEPING PLANTS IN A PLUMB POSITION. AFTER ACCEPTANCE, THE OWNER SHALL ASSUME MAINTENANCE RESPONSIBILITIES. HOWEVER, THE CONTRACTOR SHALL CONTINUE TO BE RESPONSIBLE FOR KEEPING THE TREES PLUMB THROUGHOUT THE GUARANTEE PERIOD.
- ANY PLANT MATERIAL WHICH DIES, TURNS BROWN, OR DEFOOLIATES (PRIOR TO TOTAL ACCEPTANCE OF THE WORK) SHALL BE PROMPTLY REMOVED FROM THE SITE AND REPLACED WITH MATERIAL OF THE SAME SPECIES, QUANTITY, AND SIZE AND MEETING ALL LANDSCAPE LEGEND SPECIFICATIONS.
 - WATERING: MAINTAIN A WATERING SCHEDULE WHICH WILL THOROUGHLY WATER ALL PLANTS ONCE A WEEK. IN EXTREMELY HOT, DRY WEATHER, WATER MORE OFTEN AS REQUIRED BY INDICATIONS OF HEAT STRESS SUCH AS WILTING LEAVES. CHECK MOISTURE UNDER MULCH PRIOR TO WATERING TO DETERMINE NEED. CONTRACTOR SHALL MAKE THE NECESSARY ARRANGEMENTS FOR WATER.

TURF NOTES:

- TURF ESTABLISHMENT SHALL BE ACCOMPLISHED IN ACCORDANCE WITH THE PROVISIONS OF THE MNDOT 2105 AND 2575 EXCEPT AS MODIFIED BELOW:
- ALL AREAS TO RECEIVE SOD SHALL ALSO RECEIVE 6" OF TOPSOIL PRIOR TO INSTALLING SOD. TOPSOIL SHALL BE FREE OF TREE ROOTS, STUMPS, BUILDING MATERIAL, AND TRASH, AND SHALL BE FREE OF STONES LARGER THAN 1 3/4" INCHES IN ANY DIMENSION.
 - WHERE SOD ABUTS PAVED SURFACES, FINISHED GRADE OF SOD/SEED SHALL BE HELD 1" BELOW SURFACE ELEVATION OF TRAIL, SLAB, CURB, ETC.
 - SOD SHALL BE LAID PARALLEL TO THE CONTOURS AND SHALL HAVE STAGGERED JOINTS. ON SLOPES STEEPER THAN 3:1 OR IN DRAINAGE SWALES, SOD SHALL BE STAKED SECURELY.
 - TURF ON ALL OTHER AREAS DISTURBED BY CONSTRUCTION SHALL BE RESTORED BY SEEDING, MULCHING AND FERTILIZING. SEED MIXTURE NO.25-121 WILL BE PLACED AT THE RATE OF 65 POUNDS PER ACRE.
 - ALL DISTURBED AREAS TO BE TURF SEEDING, ARE TO RECEIVE 6" TOP SOIL, SEED, MULCH, AND WATER UNTIL A HEALTHY STAND OF GRASS IS OBTAINED. FOR SLOPES STEEPER THAN 3:1 OR IN DRAINAGE SWALES INSTALL EROSION CONTROL BLANKET.
 - ALL DISTURBED AREAS TO RECEIVE NATIVE SEED, ARE TO RECEIVE PLANTING SOIL, SEED, MULCH, AND WATER UNTIL A HEALTHY STAND OF GRASS IS OBTAINED. FOR SLOPES STEEPER THAN 3:1 OR IN DRAINAGE SWALES INSTALL EROSION CONTROL BLANKET.

IRRIGATION NOTES:

- IRRIGATION SYSTEM TO BE DESIGN/BUILD. CONTRACTOR TO SUBMIT SHOP DRAWINGS FOR APPROVAL OF SYSTEM LAYOUT PRIOR TO INSTALLATION.
- ALL SOD TO RECEIVE SPRAY OR ROTOR IRRIGATION HEADS WITH MINIMUM DESIGN OF 1" IRRIGATION PER WEEK.
- ALL PLANT BEDS TO RECEIVE DRIP LINE IRRIGATION, WITH A MINIMUM DESIGN OF .25" IRRIGATION PER WEEK.
- CONTRACTOR TO INSTALL A TOTAL OF 4 QUICK COUPLERS AT THE CORNERS OF THE PROPERTY. A 2.5" TYPE K SOURCE PIPE IS PROVIDED BY MECHANICAL.

LOW MAINTENANCE FESCUE NOTES:

- DURING GROWING SEASON NEVER MOW SHORTER THAN 3.5 INCHES, PREFERRED MAINTENANCE IS MOW ONCE PER MONTH AT 5" HEIGHT
- DO NOT USE HIGH NITROGEN FERTILIZER ON FESCUE LAWN
- OVERSEED THIN BARE SPOTS IN FALL
- ALWAYS USE SHARP BLADE WHEN MOWING TO AVOID TEARING LEAF BLADE
- SET MOWER TO 3" FOR BAGGING AND MOWING IN LATE FALL AFTER GROWING SEASON

GENERAL TREE SPECIFICATIONS:

- ALL STREET AND PARKING LOT TREES SHALL BE LIMBED UP TO THE FOLLOWING HEIGHTS:
 - 2" CAL. TREES: LOWEST BRANCH 6' HT.
 - 3" CAL.+ TREES: LOWEST BRANCH 7' HT.
- TREE CANOPY WIDTH SHALL BE RELATIVE TO HEIGHT/CALIPER OF TREE AND TYPE OF TREE.
 - 1" CALIPER/6-8' HT: 3-4' WIDTH MIN.
 - 2" CALIPER/12-14' HT: 4-5' WIDTH MIN.
 - 3" CALIPER/14-16' HT: 6-7' WIDTH MIN.
- CANOPY TREES SHALL NOT HAVE CO-DOMINATE LEADERS IN LOWER HALF OF TREE CROWN.
- ALL TREES SHALL HAVE SYMMETRICAL OR BALANCED BRANCHING ON ALL SIDES OF THE TREE.
- TREES SHALL NOT BE TIPPED PRUNED.
- TREES SHALL BE FREE OF PHYSICAL DAMAGE FROM SHIPPING AND HANDLING. DAMAGED TREES SHALL BE REJECTED.
- SUMMER DUG TREES SHALL HAVE ROOTBALL SIZE INCREASED BY 20% TREES WHICH EXCEED RECOMMENDED CALIPER TO HEIGHT RELATIONSHIP SHALL BE REJECTED.

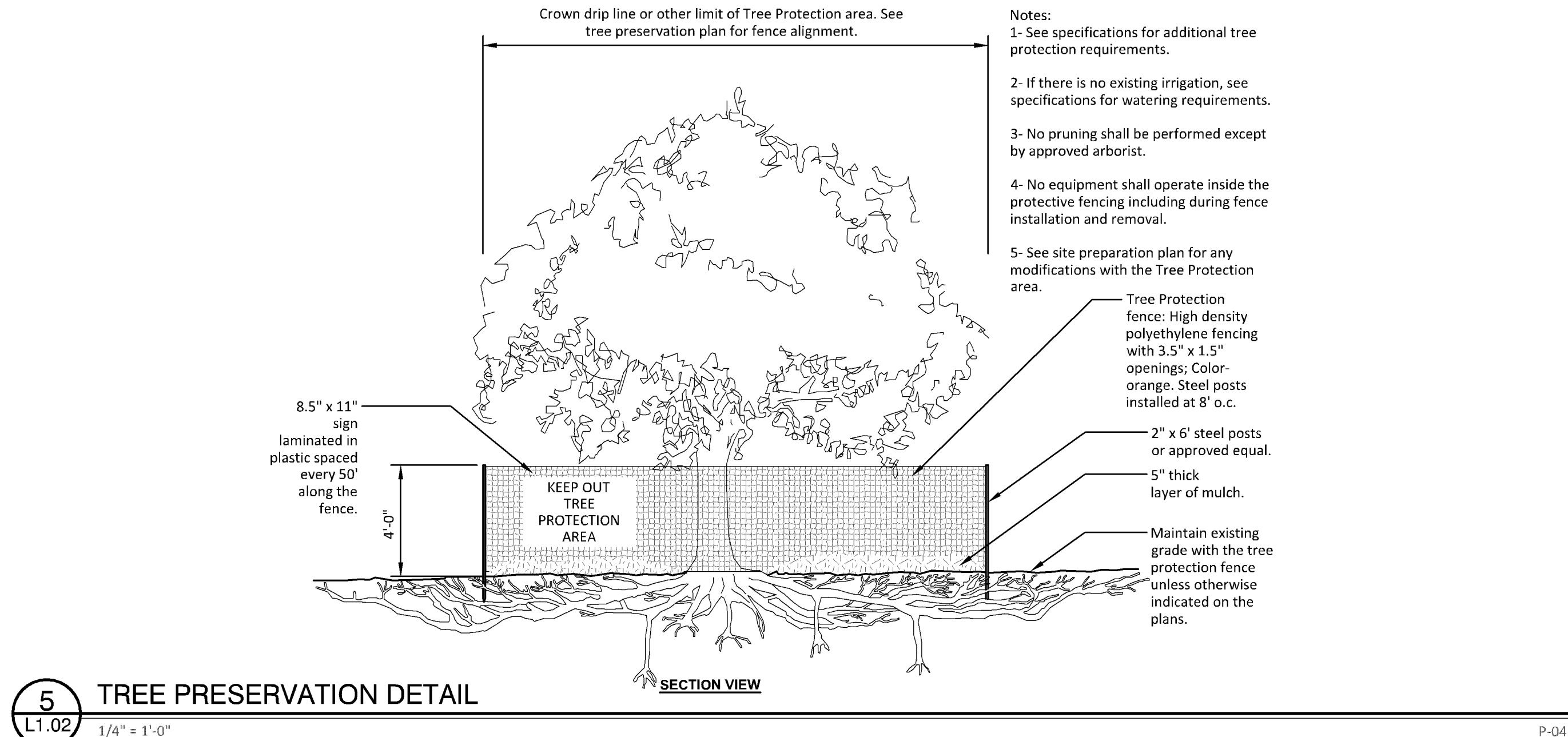

5 TREE PRESERVATION DETAIL
L1.02 1/4" = 1'-0" P-04

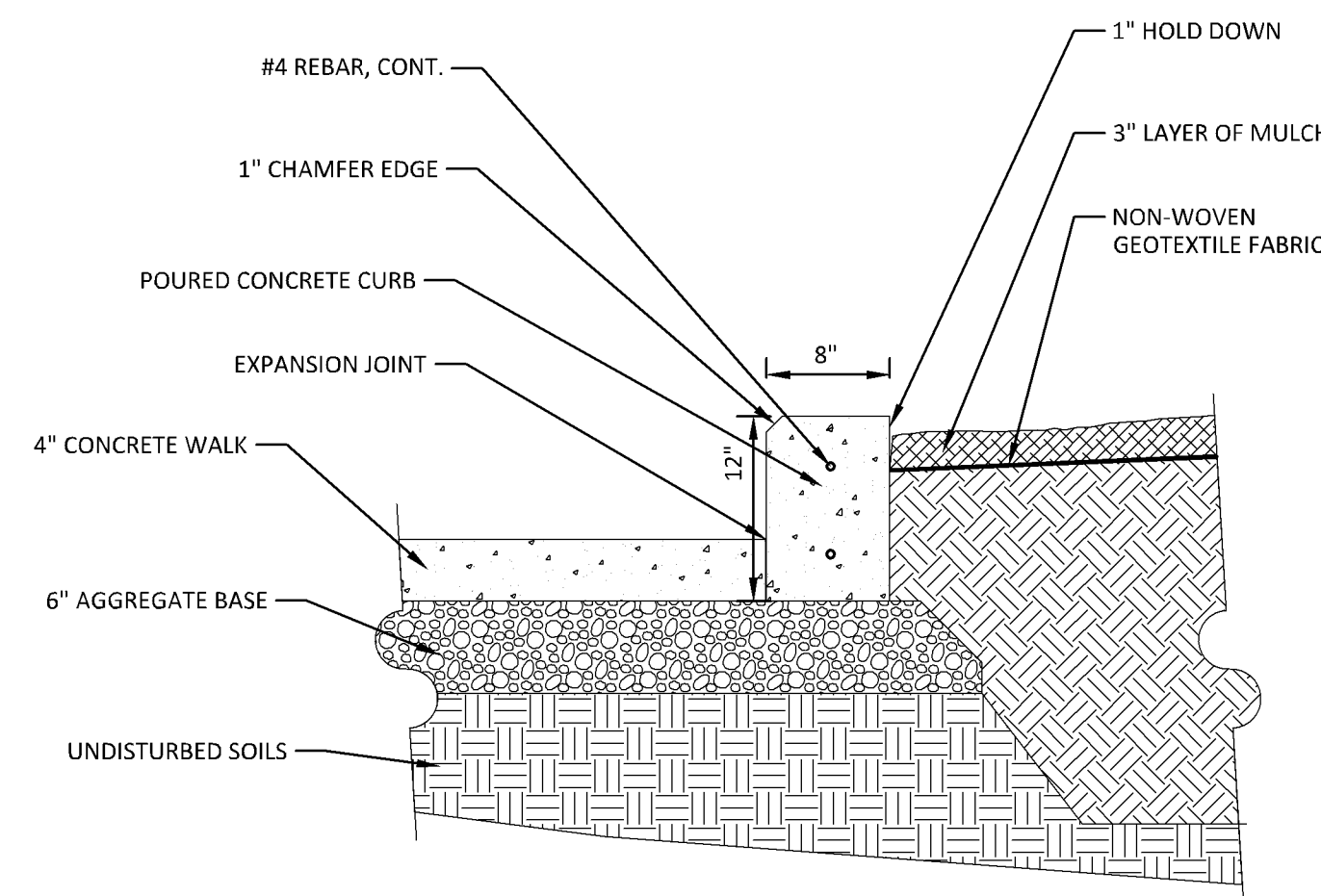

6 8" CONCRETE PLANTER CURB
L1.02 1" = 1'-0" P-24

PL201900066
PL2019-66

ENGINEERING DIVISION
Approved By: Julie Long, PE
06/04/2019 3:40:08 PM

REVISION SCHEDULE

NO.	DESCRIPTION	DATE
1	CONSTRUCTION	3/4/2019
2	ADDENDUM 01	3/27/2019
3	ASI #1	5/28/2019

I hereby certify that this survey, plan or report was prepared by me or under my direct supervision and I am a duly licensed professional LANDSCAPE ARCHITECT under the laws of the State of Minnesota.

Julie J. McKinney
Date: 3/4/2019
Registration No. 53234

This certification is void unless signed in black ink. If a signature appears in red ink, it is invalid and may require a signature, Minnesota, MN 55401.

2019 BLOOMINGTON ICE
GARDEN REMODEL
3600 W 98TH ST MINNEAPOLIS, MN 55431

7 MARCH, 2019
LANDSCAPE
DETAILS &
NOTES

L1.02