

PLANT SCHEDULE

QTY.	COMMON NAME	BOTANICAL NAME	SIZE	ROOT
1	Selection by LA		3"	B&B
3	Sunburst Locust	Gleditsia triacanthos 'Sunburst'	2.5"	B&B
3	Em. Queen Maple	Acer platanoides 'Emerald Queen'	2.5"	B&B
1	River Birch	Betula nigra	2.5"	B&B
4	Japan. Tree Lilac	Syringa reticulata	2"	B&B
1	Amur Maple-Clump	Acer ginnala clump	10'	B&B
2	Amur Maple Tree	Acer ginnala	3"	B&B
7	Techny Arborvitae	Thuja occidentalis 'Techny'	3'	B&B
8	Dwf. Amur Maple	Acer ginnala 'Bailey Compact'	2'	Pot
12	Andorra Juniper	Juniperus horizontalis 'Andorra'	#5	Pot
6	Sea Green Juniper	Juniperus chinensis 'Sea Green'	#5	Pot

- NOTES:**
1. Poly edger between sod and planting beds.
 2. Rock mulch (3" Depth) over Filter blanket in Parking Lot islands and at the stairs on the west side.
 3. Shredded Bark Mulch (4" Depth) over Filter blanket in the Planting beds on the North Entrance Drive.
 4. Clean out existing planting bed on the west side of the lot then add Wood Chip Mulch (4" Depth) with NO filter blanket.

Scale: 1"=20'

North

CITY OF BLOOMINGTON, MN
 LANDSCAPE PLAN APPROVED
 By: *Ray Shuman for LA*
 Director of Planning
 Date: 1-10-94



BOR-SON EAST PARKING LOT ADDITION
 Bloomington, MN

Landscape Plan

date: Nov. 19, 1993
 job no.
 drawn by B. Adams
 revised
 designed by Erv. Mallin
 Reg. Land Architect
 Reg. No. 12929

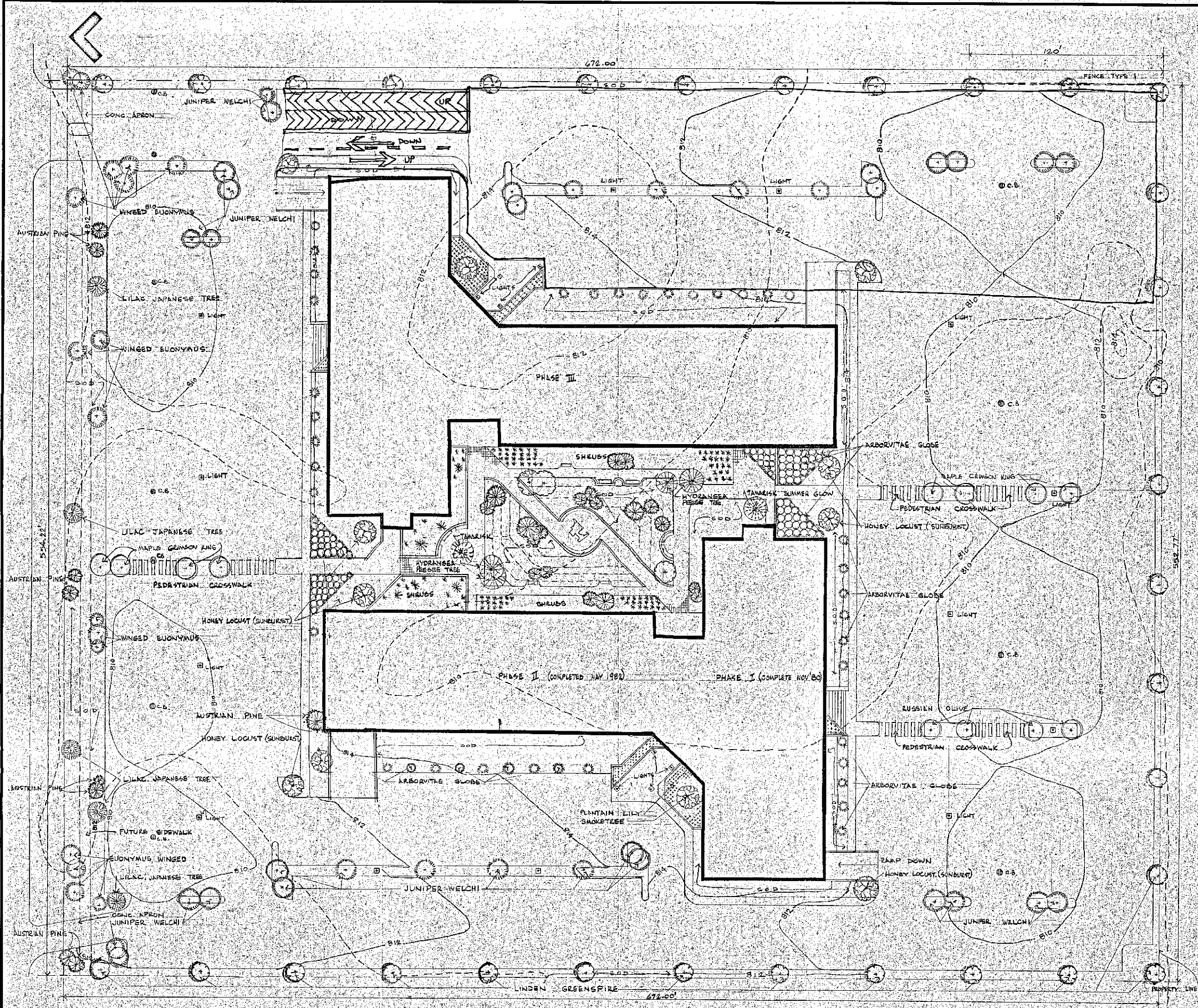

PLANTING SCHEDULE					
SYMBOL	QTY	PLANT TYPE	BOTANICAL NAME	SIZE	REMARKS
(Symbol)		HONEY LOCUST (SUNBURST)	GLADSTONIA TRIACANTHOS		
(Symbol)		MAPLE CRIMSON KING	ACER PLATANOIDES		
(Symbol)		LILAC (JAPANESE)	SYRISSA JAPONICA		
(Symbol)		HYDRANGEA (PEE GEE)	HYDRANGEA PANICULATA		
(Symbol)		AUSTRIAN PINE	PINUS NIGRA		
(Symbol)		LINDEN GREENSPIRE	TILIA GORDONIA GREENSPIRE		
(Symbol)		JUNIPER WELCH	JUNIPERUS WOLCHII		
(Symbol)		ARBORVITAE GLOBE	THUJA OCCIDENTALIS		
(Symbol)		EUONYMUS WINGED	EUONYMUS ALATUS		
(Symbol)		TAMARISK	TAMARIX PENTANDER KUDEN		
(Symbol)		PLANTAIN LILY	HOSTA		
(Symbol)		SHRUB	BERBERIS THUNBERGI		
(Symbol)		SUGAR MAPLE	ACER SACCHARINUM		

GENERAL NOTES

A. THE SITE DEVELOPMENT WILL BE CONSTRUCTED IN PHASES RELATING TO THE CONSTRUCTION OF THE STRUCTURES. FUTURE STAGED DEVELOPMENT MAY NECESSITATE CHANGES WITH THE CURRENT DESIGN. THE OVERALL CONCEPT & DESIGN INTENT HOWEVER IS DESCRIBED BY THIS DRAWING.

B. SIZE OF MATERIAL ILLUSTRATED IS SPECIFIED IN PLANTING SCHEDULE & TO CONFORM WITH CITY OF BLOOMINGTON PROJECT LANDSCAPING REQUIREMENTS.

C. SEE P.U.D. SITE PLAN RE: PADES, GUIDES, PARKING, LOT DRAINAGE, ETC.

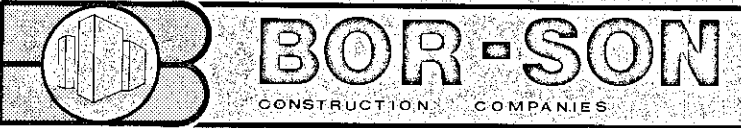

Drawn by: *Donald A. Peterson*
 Date: *10/1/80* Proj. No. *6384*

PROPOSED OFFICE BUILDING
 2001 KILBREW DRIVE BLOOMINGTON MINNESOTA

ADDITIONS
 7-9-80 25 Page I
 3-5-84 Page III

DRAWN: _____
 CHECKED: _____
 DATE: _____
 SCALE: 1" = 30'-0"

TITLE: **LANDSCAPING PLAN (P.U.D.)**

SHEET NO. **L-2**

SUBJECT TO APPROVAL BY DIRECTOR OF PLANNING
 7986-A 84

