

**SURVEY OF:
8201 PARK AVENUE S.
BLOOMINGTON, MN**

- BENCHMARKS**
- 1.) Top of tap nut of fire hydrant at the southwest quadrant of Park Avenue and 83rd Street. Elevation = 821.70 feet
 - 2.) Top of tap nut of fire hydrant on west side of Columbus Ave 74+/- feet north of the north right of way of 83rd Street. Elevation = 819.87 feet
 - 3.) Top of tap nut of fire hydrant west of tennis court and east of northeast building corner. Elevation = 821.12 feet
- NOTE: Elevations shown are based on City of Bloomington benchmarks.

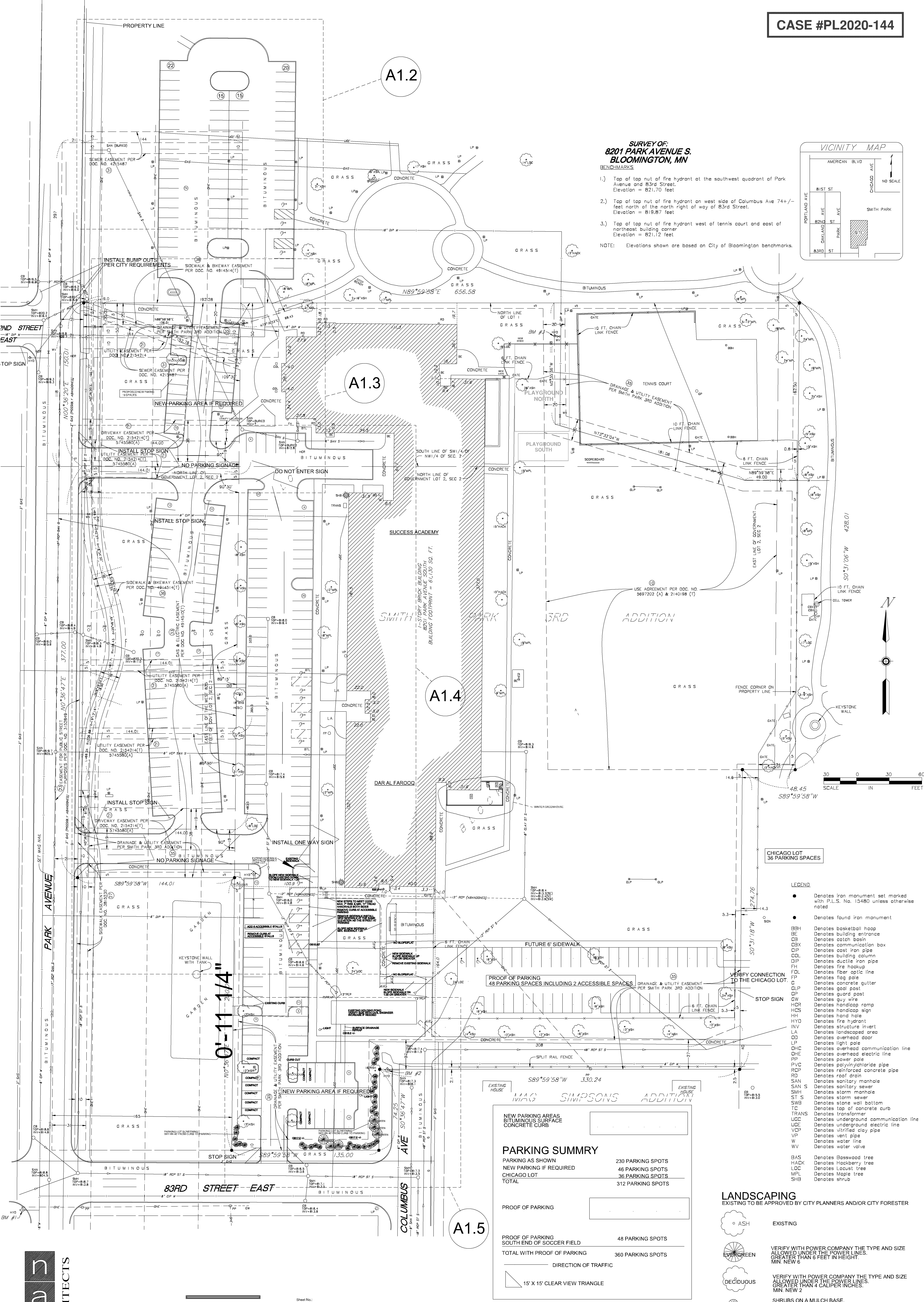
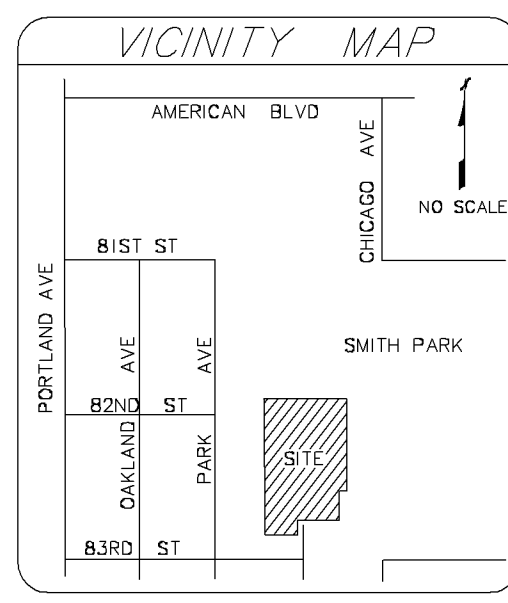

- LEGEND**
- Denotes iron monument set marked with P.L.S. No. 15480 unless otherwise noted
 - Denotes found iron monument
 - BH Denotes basketball hoop
 - BE Denotes building entrance
 - CB Denotes catch basin
 - CBX Denotes communication box
 - CIP Denotes cast iron pipe
 - COL Denotes building column
 - DIP Denotes ductile iron pipe
 - FH Denotes fire hookup
 - FOL Denotes fiber optic line
 - FP Denotes flag pole
 - GC Denotes concrete gutter
 - GLP Denotes goal post
 - GP Denotes guard post
 - GW Denotes guy wire
 - HCR Denotes handicap ramp
 - HCS Denotes handicap sign
 - HH Denotes hand hole
 - HYD Denotes fire hydrant
 - INV Denotes structure invert
 - LA Denotes landscaped area
 - OD Denotes overhead door
 - LP Denotes light pole
 - OHC Denotes overhead communication line
 - OHF Denotes overhead electric line
 - PP Denotes power pole
 - PVC Denotes polyvinyl chloride pipe
 - RCP Denotes reinforced concrete pipe
 - RD Denotes roof drain
 - SAN Denotes sanitary manhole
 - SAN S Denotes sanitary sewer
 - SMH Denotes storm manhole
 - ST S Denotes storm sewer
 - SW Denotes stone wall bottom
 - TC Denotes top of concrete curb
 - TRANS Denotes transformer
 - UGC Denotes underground communication line
 - ULC Denotes underground electric line
 - VCP Denotes vitrified clay pipe
 - VP Denotes vent pipe
 - W Denotes water line
 - WV Denotes water valve
 - BAS Denotes Basewood tree
 - HACK Denotes Hackberry tree
 - LOC Denotes Locust tree
 - MPL Denotes Maple tree
 - SHB Denotes shrub

PARKING SUMMARY

PARKING AS SHOWN	230 PARKING SPOTS
NEW PARKING IF REQUIRED	46 PARKING SPOTS
CHICAGO LOT	36 PARKING SPOTS
TOTAL	312 PARKING SPOTS

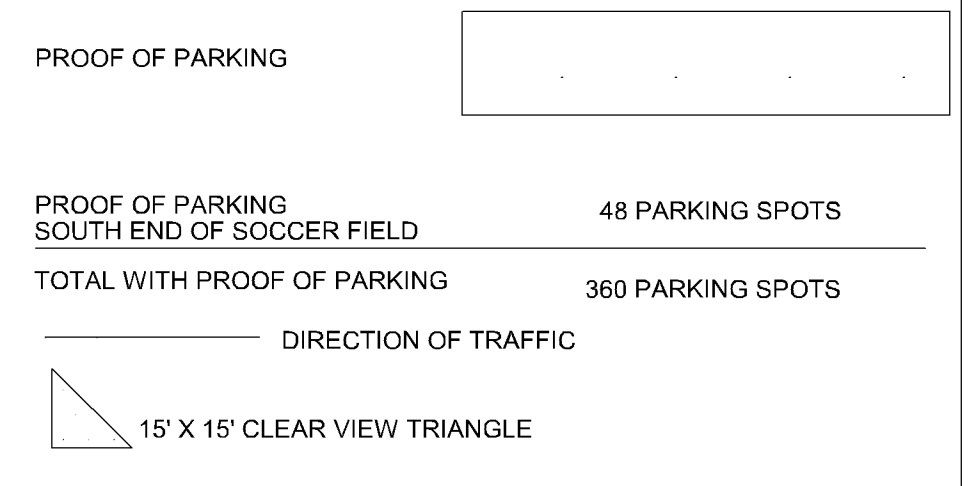

Issues & Revisions:

7-19-18	PARKING AND DRIVES
7-26-18	REMOVE ENTRY @ SMITH PARK
7-27-18	NORTH ENTRY/EXIT TWO WAY
8-10-20	REVISED LANDSCAPING
	ADDED GREENHOUSE

SHEET SCHEDULE

A1.1	SITE PLAN WITH PARKING
A1.2	SMITH PARK PARKING LOT
A1.3	NEW PARKING LOT SOUTH END OF CHS
A1.4	EXISTING WEST PARKING LOT
A1.5	EXISTING WEST PARKING LOT IN BUILDING ENCLOSURE
A1.6	NEW WEST PARKING LOT
A1.7	BUILDING WITH CLASS ROOM REFORMATION FOR SCHOOL YEAR 2021 - 2022
A1.8	BUILDING WITH CLASS ROOM REFORMATION FOR SCHOOL YEAR 2021 - 2022

ARCHITECTS

1559 Sloan Place, Suite 100
Maplewood, MN 55117
Phone: (651) 487-3281
Fax: (651) 487-3283
www.NAI-Architects.com

I hereby certify that this plan, specification, or report was prepared by me or under my direct supervision and that I am a duly Licensed Architect under the laws of the state of Minnesota.

Signature: *John K. Gaspar*
Typed Name: John K. Gaspar
Date: 06-20-2018 Reg. No. 15430

**SUCCESS ACADEMY
Dar Al Farooq Center**

8201 Park Ave South
Bloomington, Mn. 55420

Sheet No: **A1.1**

Comm. No: **2017041**

Drawn By: **J.K.G.**

Date: **06/20/2018**

SURVEY & SITE PLAN

North Arrow

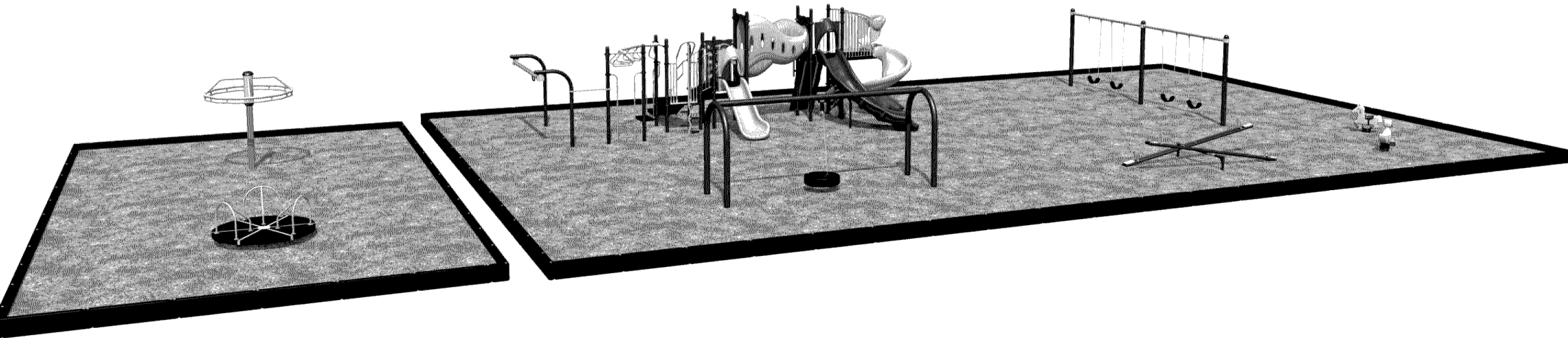

Success Academy

Bloomington, MN

20-3370A.MID

Sales Representative
**MIDWEST
PLAYSCAPES**
8632 EAGLE CREEK CIRCLE
SAVAGE, MN 55378
PHONE: 1.800.747.1452
EMAIL: playscapes@earthlink.net

Equipment Manufacturer
PLAYWORLD
The world needs play.

POST & COMPONENT	ROTOMOLD PLASTIC	2-COLOR PLASTIC	ECO-ARMOR
Brown	Brownstone	Forest Green-Sand	Brown
Beige	Forest Green		

CASE #PL2020-144

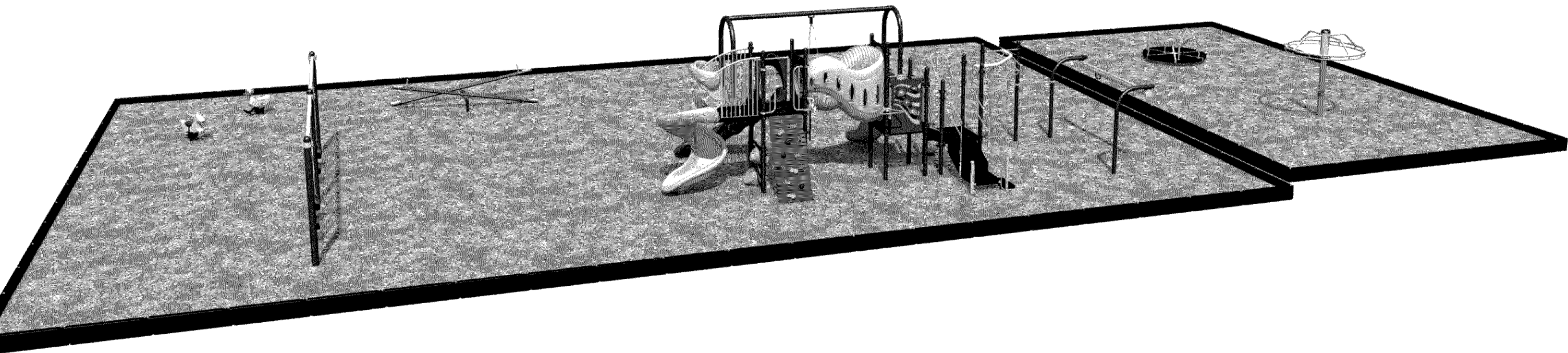

Success Academy
Bloomington, MN

Sales Representative
**MIDWEST
PLAYSCAPES**
8632 EAGLE CREEK CIRCLE
SAVAGE, MN 55378
PHONE: 1.800.747.1452
EMAIL: playscapes@earthlink.net

Equipment Manufacturer
PLAYWORLD
The world needs play.

CASE #PL2020-144



Success Academy

Bloomington, MN

20-3370A.MID

Sales Representative
**MIDWEST
PLAYSCAPES**
8632 EAGLE CREEK CIRCLE
SAVAGE, MN 55378
PHONE: 1.800.747.1452
EMAIL: playscapes@earthlink.net

Equipment Manufacturer
PLAYWORLD
The world needs play.

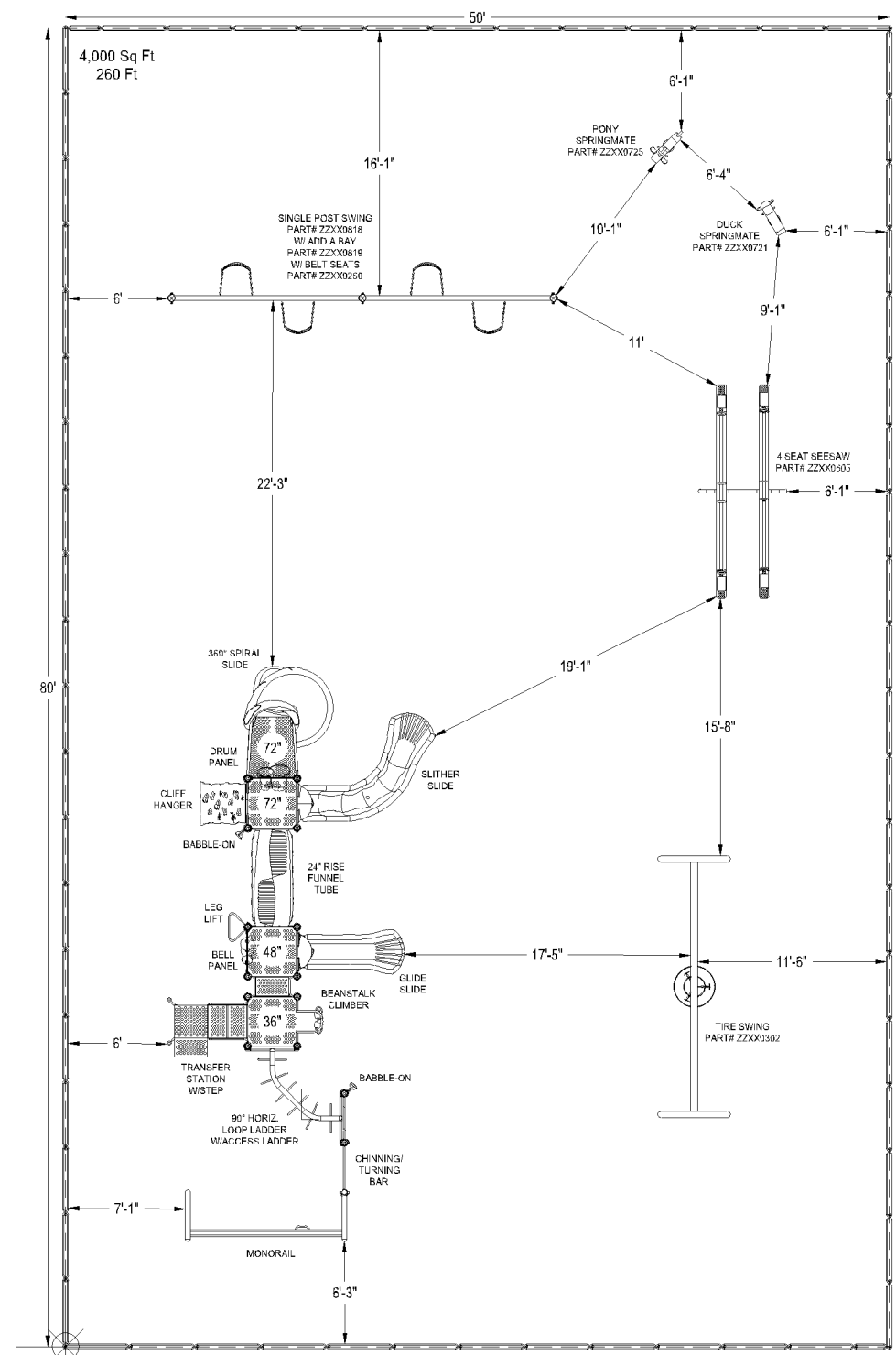

BORDER TIMBERS
 80 - 4" TIMBERS
 4 - 2" TIMBERS
 2 - 1" TIMBERS
 9 - END CAP PKG.

ADA SCHEDULE	Total Elevated Play Activities: 8		
	Total Ground-Level Play Activities: 13		
	Accessible Elevated Activities	Accessible Ground-Level Activities	Accessible Ground-Level Play Types
Required	4	3	3
Provided	8	13	9

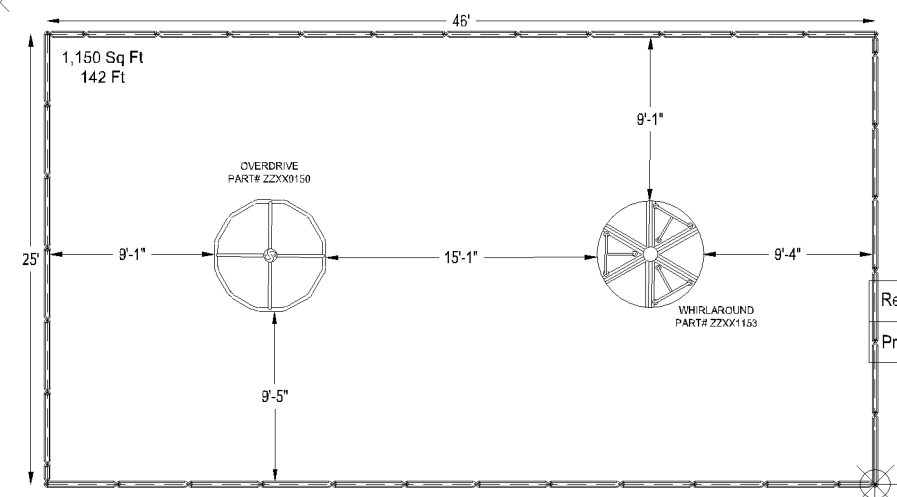

ADA SCHEDULE	Total Elevated Play Activities: 0		
	Total Ground-Level Play Activities: 2		
	Accessible Elevated Activities	Accessible Ground-Level Activities	Accessible Ground-Level Play Types
Required	0	0	0
Provided	0	2	1



MIDWEST PLAYSAPES, INC.
 8632 Eagle Creek Circle
 Savage, MN 55378

EQUIPMENT SIZE:
34'10" x 16'2" x 11'5"

USE ZONE:
See Dwg

AREA: **See Dwg** PERIMETER: **See Dwg**

FALL HEIGHT:
8 Ft.

USER CAPACITY: **69** AGE GROUP: **5-12**

✓ ASTM F1487-17
 ✓ CPSC #325



PROJECT NO:
20-3370A.MID

SCALE:
3/32"=1'-0"

DRAWN BY:
L.RICE

Paper Size
B

DATE:
21-SEP-20

*PLAYGROUND SUPERVISION REQUIRED

SUCCESS ACADEMY
 BLOOMINGTON, MN



Playmore Recreational
 Products & Services
 10271 Deer Run Farms Road
 Suite 1
 Fort Myers, FL 33966

FOOTING LEGEND

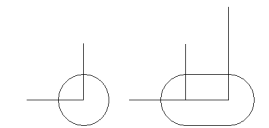

COMPONENT FOOTING (DETAIL 3)

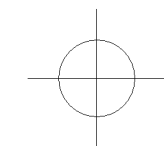

SPIRAL SLIDE CENTER POST FOOTING (DETAIL 1)

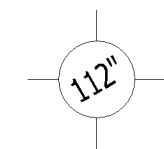

SUPPORT POST FOOTING (DETAIL 1 or 4)
 (112" INDICATES POST LENGTH)

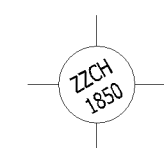

CANTILEVER, "T" POST, AND COMPONENT
 POST FOOTING (DETAIL 2)
 (ZZCH1850 INDICATES PART NUMBER)

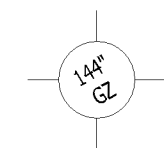

GROUND ZERO POST FOOTING (DETAIL 2)
 (144" INDICATES POST LENGTH)

PROJECT NO:
20-3370A.MID

SCALE:
3/32"=1'0"

DRAWN BY:
L.RICE

Paper Size

DATE:
21-SEP-20

B

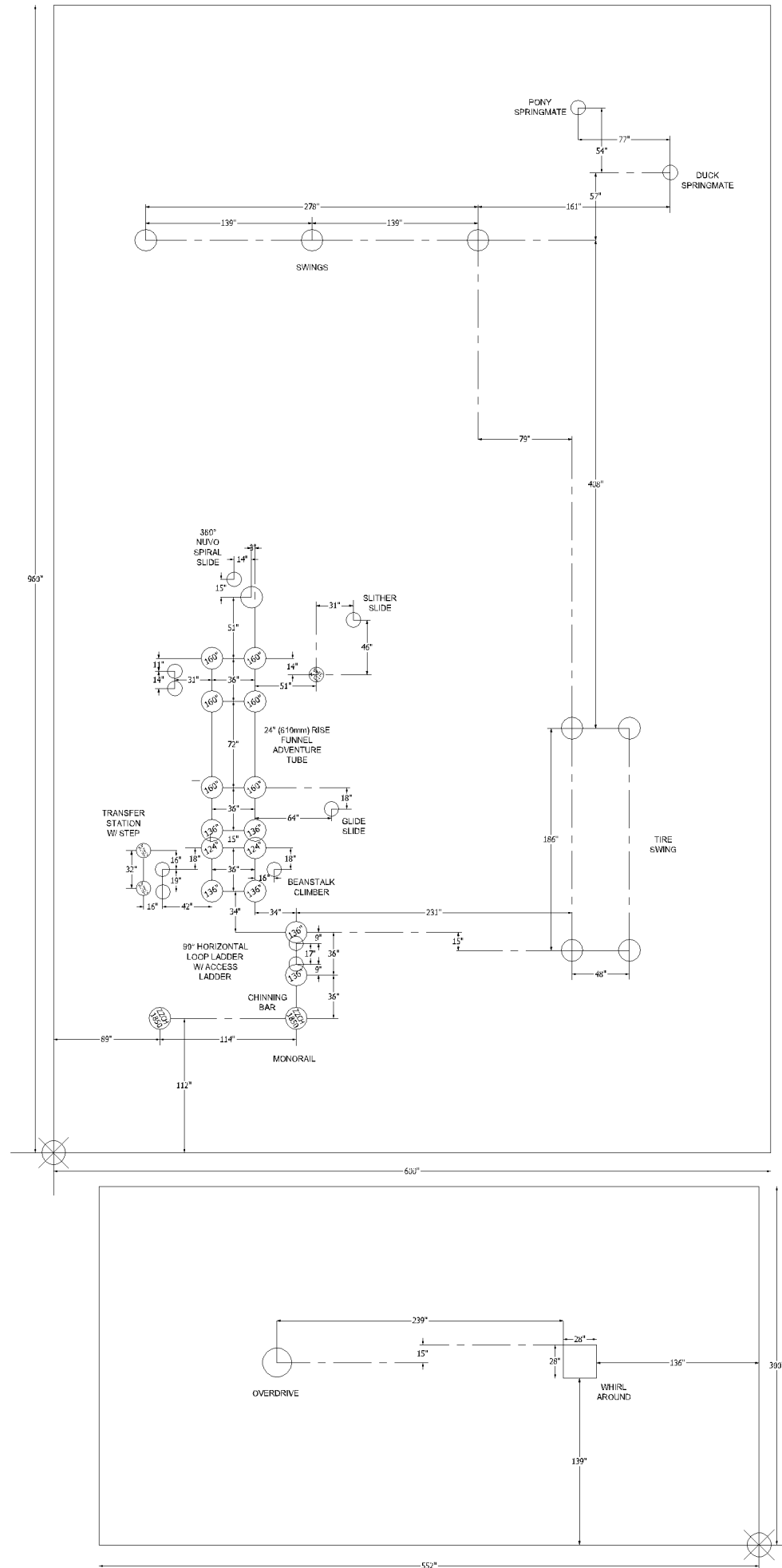

*PLAYGROUND SUPERVISION REQUIRED

SUCCESS ACADEMY
 BLOOMINGTON, MN

Success Academy

CASE #PL2020-144

Design Number: 20-3370A - Bill Of Material

Ref. No.	Part No.	Description	Quantity
Posts			
1	ZZCH0018	3.5in OD x 124in STEEL POST W/RIVETED CAP	2
2	ZZCH0028	3.5in OD x 136in STEEL POST W/ RIVETED CAP	6
3	ZZCH0048	3.5in OD x 160in STEEL POST W/ RIVETED CAP	6
4	ZZCH1850	3.5in OD CANTILEVER POST FOR MONORAILS	2
Decks & Kick Plates			
5	ZZCH0616	SQUARE COATED DECK ASSEMBLY	3
ADA Items			
6	ZZCH2007	TRANSFER STATION w/TALL GUARDRAIL (36in DECK)	1
7	ZZUN2019	APPROACH STEP FOR TRANSFER STATION	1
Slides			
8	ZZCH3126	GLIDE SLIDE (48in DECK)	1
9	ZZCH3206	SLITHER SLIDE 2.0 ENTRANCE & EXIT	1
10	ZZCH3537	SLIDE- NUVO 360 SPIRAL SLIDE	1
11	ZZUN3207	SLITHER SLIDE 2.0 (STRAIGHT SECTION)	1
12	ZZUN3209	SLITHER SLIDE 2.0 (LEFT SECTION)	3
13	ZZUN3249	SLITHER SLIDE 2.0 SUPPORT LEG 3ft-6in	1
Crawl Tubes			
14	ZZCH5628	FUNNEL ADVENTURE TUBE 2ft RISE	1
Climbers			
15	ZZCH6989	INCLINED CLIFF HANGER (72in DECK)	1
16	ZZCH8100	BEANSTALK CLIMBER (36in DECK)	1
Overhead Events			
17	ZZCH5736	CHINNING - TURNING BAR	1
18	ZZCH5770	LEG LIFT	1
19	ZZCH5850	90 DEGREE HORIZONTAL LOOP LADDER	1
20	ZZCH5970	OVERHEAD EVENT ACCESS LADDER (36in DECK)	1
21	ZZUN6990	MONORAIL SECTION FOR CANTILEVER POSTS	1
Audible Activities			
22	ZZCH4467	GROUND TO GROUND BABBLE-ON	1
23	ZZCH4587	DRUM PANEL (GROUND LEVEL)	1
24	ZZCH4588	BELL PANEL	1
Stairs and Ladders			
25	ZZCH9168	12in ACCESS STEPPED PLATFORM (DECK TO DECK)	1
Additional Tool & Maintenance Kits			
26	ZZUN1471	INSTALLER HARDWARE KIT	1
27	ZZUN9910	SURFACING WARNING LABEL KIT	1
28	ZZUN9930	PIPE SYSTEMS MAINTENANCE KIT W/ AEROSOL	1
29	ZZXX0678	LABEL KIT- COMPOSITE STRUCTURE - ASTM	1
30	ZZXXGNGUIC	GENERAL INSTALLERS GUIDE	1



Success Academy

CASE #PL2020-144

Design Number: 20-3370A - Compliance and Technical Data
 Reference Document: ASTM F1487

Ref. No.	Part No.	Qty.	Description	Unit ASTM Status	Total Weight (lbs)	Pre-Consumer Recycled Content (lbs)	Post-Consumer Content (lbs)	CO2e Footprint (kgs)	Users	Install Hours	Concrete (Yds3)	Active Play Events
1	ZZXX0260	4	BELT SEAT W/SILVER SHIELD CHAIN FOR 8ft TOP RAIL	Certified	35.20			216	4	1.00	0.00	4
2	ZZXX0302	1	5in OD ALUMINUM ARCH TIRE SWING W/SILVER SHIELD CHAIN	Certified	253.57			1,173	3	4.00	0.50	1
3	ZZXX0605	1	4 SEAT SEE-SAW W/ FIXED FULCRUM	Certified	323.68			1,068	4	4.00	0.06	1
4	ZZXX0721	1	DUCK WITH COIL SPRING	Certified	63.41			221	1	2.00	0.07	1
5	ZZXX0725	1	PONY WITH COIL SPRING	Certified	70.05			249	1	2.00	0.00	1
6	ZZXX0818	1	8ft SINGLE POST SWING ASSEMBLY	Certified	257.68			159	0	2.00	0.24	0
7	ZZXX0819	1	8ft SINGLE POST SWING ADD-A-BAY	Certified	169.58			109	0	2.00	0.12	0
8	ZZXX1153	1	WHIRL-A-ROUND	N/A	440.36			1,605	12	3.00	0.40	1
9	ZZXX9409	2	1ft BORDER TIMBER w/STAKE	N/A	11.02			26	0	0.50	0.00	0
10	ZZXX9410	4	2ft BORDER TIMBERS w/STAKE	N/A	30.44			64	0	1.00	0.00	0
11	ZZXX9430	98	4ft BORDER TIMBERS w/STAKE	N/A	1,010.38			1,950	0	24.50	0.00	0
12	ZZCH0018	2	3.5in OD x 124in STEEL POST W/RIVETED CAP	Certified	77.82			108	0	2.00	0.25	0
13	ZZCH0028	6	3.5in OD x 136in STEEL POST W/ RIVETED CAP	Certified	261.06			351	0	6.00	0.75	0
14	ZZCH0048	6	3.5in OD x 160in STEEL POST W/ RIVETED CAP	Certified	301.26			408	0	6.00	0.75	0
15	ZZCH1850	2	3.5in OD CANTILEVER POST FOR MONORAILS	Certified	156.42			223	0	1.00	0.36	0
16	ZZCH0616	3	SQUARE COATED DECK ASSEMBLY	Certified	164.58			521	9	3.00	0.00	0
17	ZZCH2007	1	TRANSFER STATION w/TALL GUARDRAIL (36in DECK)	Certified	148.40			310	2	2.00	0.09	0
18	ZZUN2019	1	APPROACH STEP FOR TRANSFER STATION	Certified	35.83			72	1	1.00	0.04	0
19	ZZCH3126	1	GLIDE SLIDE (48in DECK)	Certified	119.73			492	2	1.50	0.03	1
20	ZZCH3206	1	SLITHER SLIDE 2.0 ENTRANCE & EXIT	Certified	85.37			424	2	2.00	0.03	1
21	ZZCH3537	1	SLIDE- NUVO 360 SPIRAL SLIDE	Certified	650.00			1,417	2	6.00	0.15	1
22	ZZUN3207	1	SLITHER SLIDE 2.0 (STRAIGHT SECTION)	Certified	19.59			128	0	0.25	0.00	0
23	ZZUN3209	3	SLITHER SLIDE 2.0 (LEFT SECTION)	Certified	58.77			401	0	0.75	0.00	0



Success Academy

CASE #PL2020-144

Design Number: 20-3370A - Compliance and Technical Data
 Reference Document: ASTM F1487

Ref. No.	Part No.	Qty.	Description	Unit ASTM Status	Total Weight (lbs)	Pre-Consumer Recycled (lbs)	Post-Consumer Content (lbs)	CO2e Footprint (kgs)	Users	Install Hours	Concrete (Yds3)	Active Play Events
24	ZZUN3249	1	SLITHER SLIDE 2.0 SUPPORT LEG 3ft-6in	Certified	15.01			62	0	0.25	0.03	0
25	ZZCH5628	1	FUNNEL ADVENTURE TUBE 2ft RISE	Certified	138.56			992	4	2.00	0.00	1
26	ZZCH6989	1	INCLINED CLIFF HANGER (72in DECK)	Certified	144.40			615	2	2.50	0.06	1
27	ZZCH8100	1	BEANSTALK CLIMBER (36in DECK)	Certified	69.63			273	1	1.00	0.03	1
28	ZZCH5736	1	CHINNING - TURNING BAR	Certified	5.95			41	1	0.50	0.00	1
29	ZZCH5770	1	LEG LIFT	Certified	6.76			30	1	0.50	0.00	1
30	ZZCH5850	1	90 DEGREE HORIZONTAL LOOP LADDER	Certified	67.90			198	2	1.00	0.00	1
31	ZZCH5970	1	OVERHEAD EVENT ACCESS LADDER (36in DECK)	Certified	25.12			71	1	1.50	0.06	0
32	ZZUN6990	1	MONORAIL SECTION FOR CANTILEVER POSTS	Certified	56.38			692	1	2.00	0.00	1
33	ZZXX0150	1	OVERDRIVE	Certified	330.44			1,728	6	3.00	0.21	1
34	ZZCH4467	1	GROUND TO GROUND BABBLE-ON	Certified	43.15			240	2	1.50	0.00	1
35	ZZCH4587	1	DRUM PANEL (GROUND LEVEL)	Certified	44.64			407	2	1.00	0.00	1
36	ZZCH4588	1	BELL PANEL	Certified	46.07			357	2	1.00	0.00	1
37	ZZCH9168	1	12in ACCESS STEPPED PLATFORM (DECK TO DECK)	Certified	70.28			277	1	2.00	0.00	0
38	ZZUN1471	1	INSTALLER HARDWARE KIT	N/A				57				
39	ZZUN9910	1	SURFACING WARNING LABEL KIT	Certified	0.05			1	0	0.25	0.00	0
40	ZZUN9930	1	PIPE SYSTEMS MAINTENANCE KIT W/ AEROSOL	N/A				90				
41	ZZXX0678	1	LABEL KIT- COMPOSITE STRUCTURE - ASTM	N/A	0.04			TBD	0	0.08	0.00	0
42	ZZXXGNGUIC	1	GENERAL INSTALLERS GUIDE	N/A				1				
Totals:					5,808.58	1,450	1,342	17,822	69	97.58	4.23	23
					2,613.86 Kg	653 Kg	604 Kg	18 Metric Tons			3.21 m3	



Success Academy

CASE #PL2020-144

Design Number: 20-3370A - Compliance and Technical Data
 Reference Document: ASTM F1487

Ref. No.	Part No.	Qty.	Description	Unit ASTM Status	Total Weight (lbs)	Pre-Consumer Recycled (lbs)	Post-Consumer Content (lbs)	CO2e Footprint (kgs)	Users	Install Hours	Concrete (Yds3)	Active Play Events
----------	----------	------	-------------	------------------	--------------------	-----------------------------	-----------------------------	----------------------	-------	---------------	-----------------	--------------------

 **ASTM F1487**

The lay-out for this custom playscape, design number 20-3370A, has been configured to meet the requirements of the ASTM F1487 standard. In addition, each of the above components listed as "Certified" have been tested and are IPEMA certified. Components listed as "Not Applicable" do not fall within the scope of the ASTM F1487 standard and have not been tested. IPEMA certification can be verified on the IPEMA website, www.ipema.org. In the interest of playground safety, IPEMA provides a Third Party Certification Service which validates compliance.

 **2010 ADA Standards for Accessible Design**

The lay-out was also designed to meet the 2010 Standards published 15-Sep-2010, by the Department of Justice when installed over a properly maintained surfacing material that is in compliance with ASTM F1951 "Accessibility of Surface Systems Under and Around Playground Equipment" as well as ASTM F1292, "Impact Attenuation of Surfacing Materials Within the Use Zone of Playground Equipment", appropriate for the fall height of the structure.

 **Installation Times**

Installation times are based on one experienced installer. A crew of three experienced individuals can perform the installation within the given time, each member working 1/3 of the given hours. [Eg. Installation Time = 30 hours. For a crew of three, each member will work 10 hours on the installation for a total of 30 hours on the project.]

 **Carbon Footprint**

The CO2e (carbon footprint given in Kilograms and Metric Tons) listed above is a measure of the environmental impact this play structure represents from harvesting raw materials to the time it leaves our shipping dock. Playworld Systems nurtures a total corporate culture that is focused on eliminating carbon producing processes and products, reducing our use of precious raw materials, reusing materials whenever possible and recycling materials at every opportunity. Playworld Systems elected to adopt the Publicly Available Specification; PAS 2050 as published by the British Standards Institute and sponsored by Defra and the Carbon Trust. The PAS 2050 has gained international acceptance as a specification that measures the greenhouse gas emissions in services and goods throughout their entire life cycle.

 **Pre-Consumer Recycle Content**

A measurement, in pounds, that qualifies the amount of material that was captured as waste and diverted from landfill during an initial manufacturing process and is being redirected to a separate manufacturing process to become a different product. E.g. 100% of our Aluminum Tubing is made from captured waste material during the manufacturing process of extruded Aluminum products such as rods, flat bars and H-channels.

 **Post-Consumer Recycle Content**

A measurement, in pounds, that qualifies the amount of material that was once another product that has completed its lifecycle and has been diverted from a landfill as a solid waste through recycling and is now being used in a Playworld Systems' product. E.g. **20% to 40% of the steel in our steel tubing and sheet steel have been diverted from landfills. Automobiles are scrapped and recyclable steel is purchased by the steel mill that produces our raw product.

** The amount of Post-Consumer recycled steel fluctuates daily based on the availability of the recycled steel.

