

PARKING SUMMARY

REQUIRED SUBARU PARKING:

SERVICE AREA	THREE STALLS FOR EACH ENCLOSED "MAJOR SERVICE" BAY	25	75 STALLS
	TWO STALLS FOR EACH ENCLOSED "MINOR SERVICE" BAY	13	26 STALLS
	ONE STALL PER 300 SF OF GFA EXCLUDING SERVICE BAYS	*1,189 SF SERVICE AREA	*4 STALLS
CAR WASH	ONE STALL PER 375 SF OF GFA	*1,003 SF CAR WASH	*3 STALLS
OFFICE	ONE STALL PER 285 SF OF OFFICE GFA	*16,330 SF OFFICE AREA	*57 STALLS
LARGE ITEM RETAIL	ONE STALL PER 220 SF OF RETAIL GFA	*4,048 SF SHOWROOM AREA	*18 STALLS
WAREHOUSE	ONE STALL PER 1,000 SF OF WAREHOUSE GFA	*9,855 SF WAREHOUSE AREA	*12 STALLS
MISCELLANEOUS	ONE STALL PER 360 SF OF GFA	3,292 SF MISCELLANEOUS AREA	9 STALLS
SERVICE	SERVICE DIAGNOSTICS PROVIDE 12 STALLS		-12 STALLS
TOTAL PARKING STALLS REQUIRED			192 STALLS

* DENOTES VALUE USED TO CALCULATE MISCELLANEOUS AREA RATIO.
33,727 SF / 94 STALLS REQUIRED = 1 STALL / 360 SF

REQUIRED ACURA PARKING

SERVICE AREA	THREE STALLS FOR EACH ENCLOSED "MAJOR SERVICE" BAY	10 BAYS	30 STALLS
	TWO STALLS FOR EACH ENCLOSED "MINOR SERVICE" BAY	7 BAYS	14 STALLS
CAR WASH	ONE STALL PER 375 SF OF GFA	*440 SF CAR WASH	*1 STALLS
OFFICE	ONE STALL PER 285 SF/OFFICE	*9,755 SF OFFICE GFA	*34 STALLS
LARGE ITEM RETAIL	ONE STALL PER 220 SF/RETAIL	*6,468 SF SHOWROOM GFA	*29 STALLS
WAREHOUSE	ONE STALL PER 1,000 SF/WAREHOUSE GFA	*9,333 SF WAREHOUSE GFA	*9 STALLS
MISCELLANEOUS	ONE STALL PER 350 SF OF MISCELLANEOUS GFA	1,083 SF MISCELLANEOUS GFA	3 STALLS
SERVICE	SERVICE DIAGNOSTICS PROVIDES 8 STALLS		-8 STALLS
TOTAL PARKING STALLS REQUIRED			112 STALLS

* DENOTES VALUE USED TO CALCULATE MISCELLANEOUS AREA RATIO.
29,893 SF / 73 STALLS REQUIRED = 1 STALL / 350 SF

PROVIDED PARKING:

CUSTOMER/EMPLOYEE STALLS	(9x18)	295 EA.
ACCESSIBLE STALLS (CUSTOMER/EMPLOYEE)	(9x18)	9 EA.
INVENTORY STALLS	(9x18)	182 EA.
TOTAL PARKING STALLS PROVIDED		486 EA.



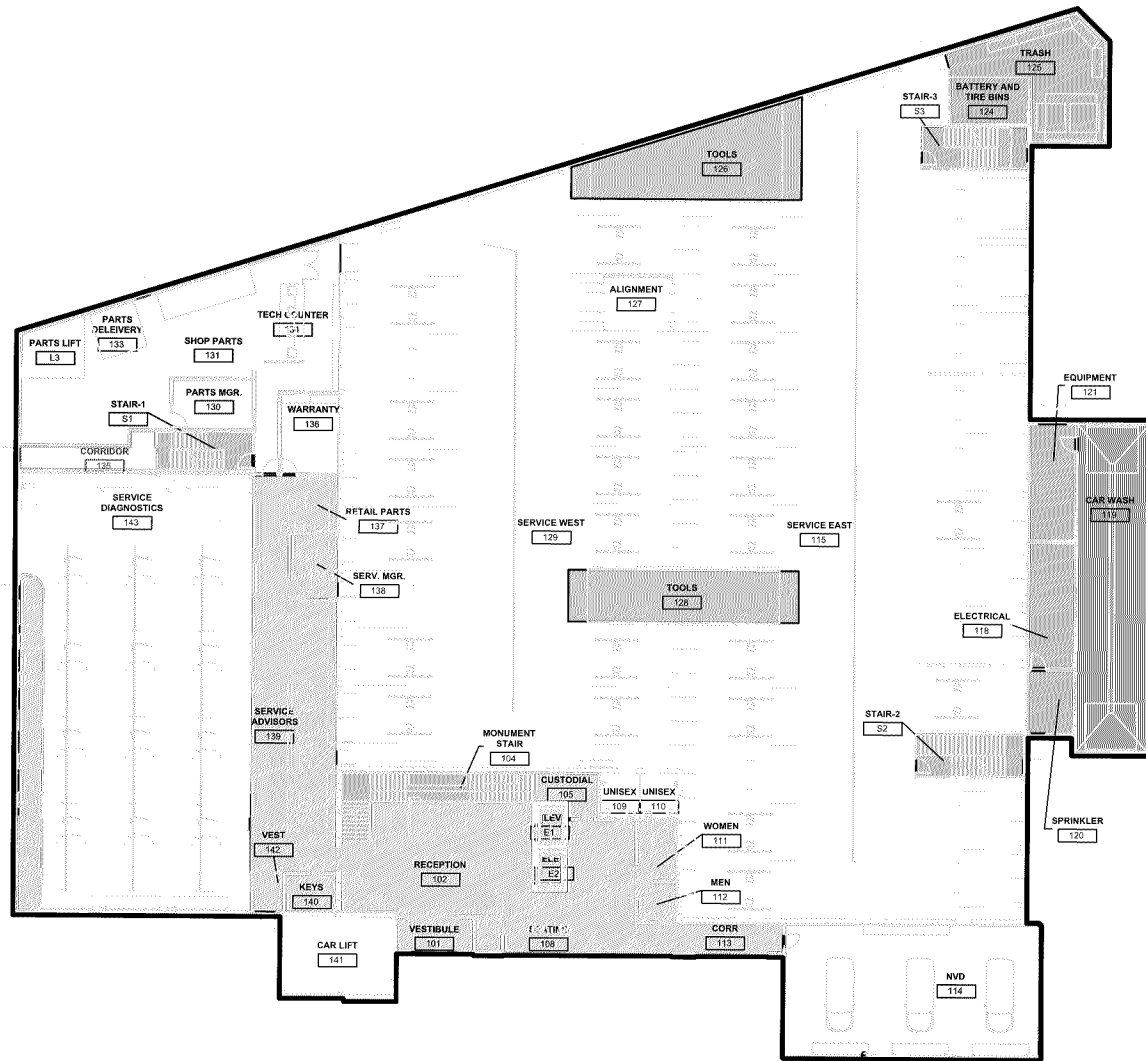

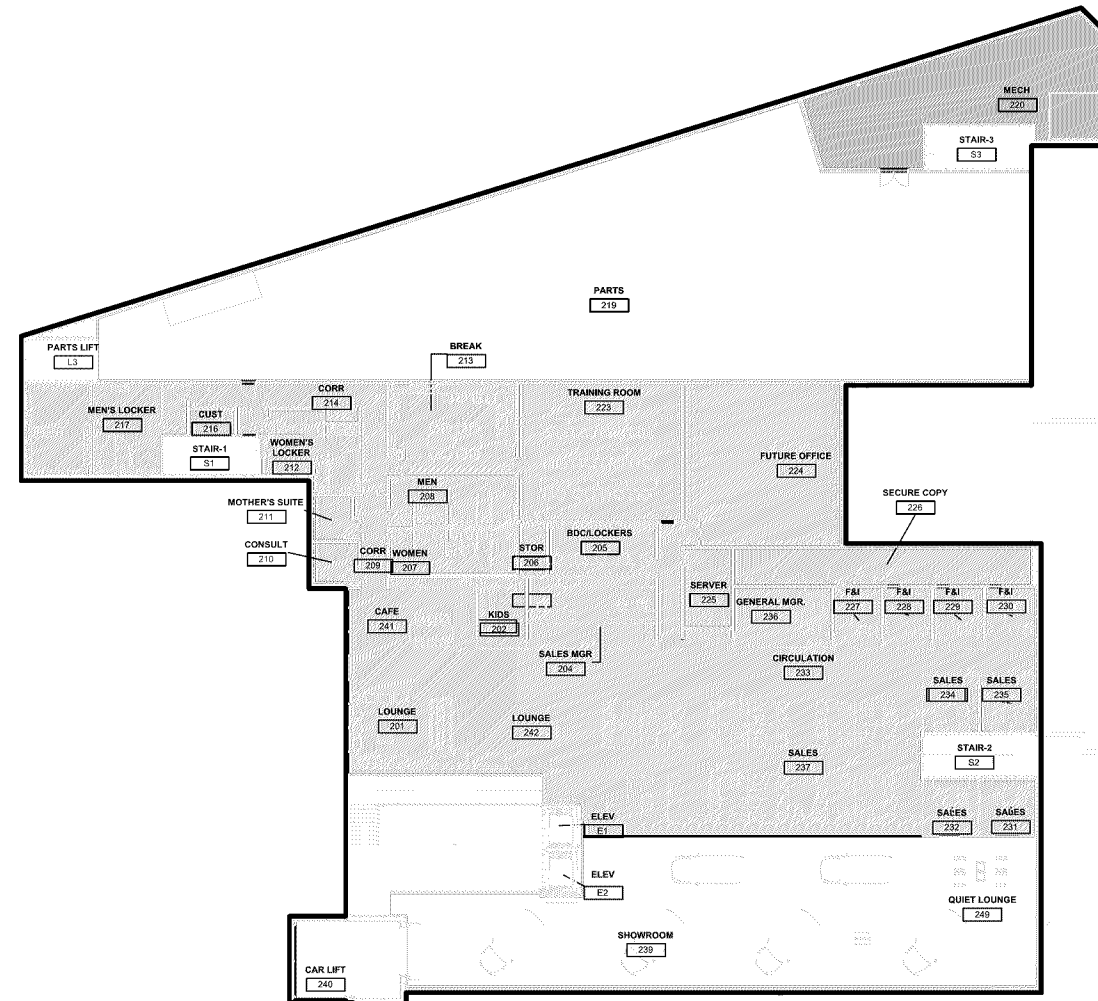

FIRST FLOOR

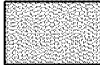

SECOND FLOOR



LEGEND

-  :DENOTES OFFICE AREA
-  :DENOTES WAREHOUSE AREA
-  :DENOTES RETAIL AREA
-  :DENOTES SERVICE AREA
-  :DENOTES CARWASH AREA
-  :DENOTES MISCELLANEOUS AREA

PARKING SUMMARY

REQUIRED SUBARU PARKING:

SERVICE AREA	THREE STALLS FOR EACH ENCLOSED "MAJOR SERVICE" BAY	25	75 STALLS
	TWO STALLS FOR EACH ENCLOSED "MINOR SERVICE" BAY	13	26 STALLS
	ONE STALL PER 300 SF OF GFA EXCLUDING SERVICE BAYS	*1,189 SF SERVICE AREA	*4 STALLS
CAR WASH	ONE STALL PER 375 SF OF GFA	*1,003 SF CAR WASH	*3 STALLS
OFFICE	ONE STALL PER 285 SF OF OFFICE GFA	*16,330 SF OFFICE AREA	*57 STALLS
LARGE ITEM RETAIL	ONE STALL PER 220 SF OF RETAIL GFA	*4,048 SF SHOWROOM AREA	*18 STALLS
WAREHOUSE	ONE STALL PER 1,000 SF OF WAREHOUSE GFA	*11,157 SF WAREHOUSE AREA	*12 STALLS
MISC.	ONE STALL PER 360 SF OF MISCELLANEOUS GFA	3,292 SF MISCELLANEOUS AREA	9 STALLS
SERVICE	SERVICE DIAGNOSTICS PROVIDES 12 INTERIOR PARKING SPACES		-12 STALLS
TOTAL EXTERIOR PARKING STALLS REQUIRED			192 STALLS

* DENOTES VALUE USED TO CALCULATE MISCELLANEOUS AREA RATIO.
33,727 SF / 94 STALLS REQUIRED = 1 STALL / 360 SF





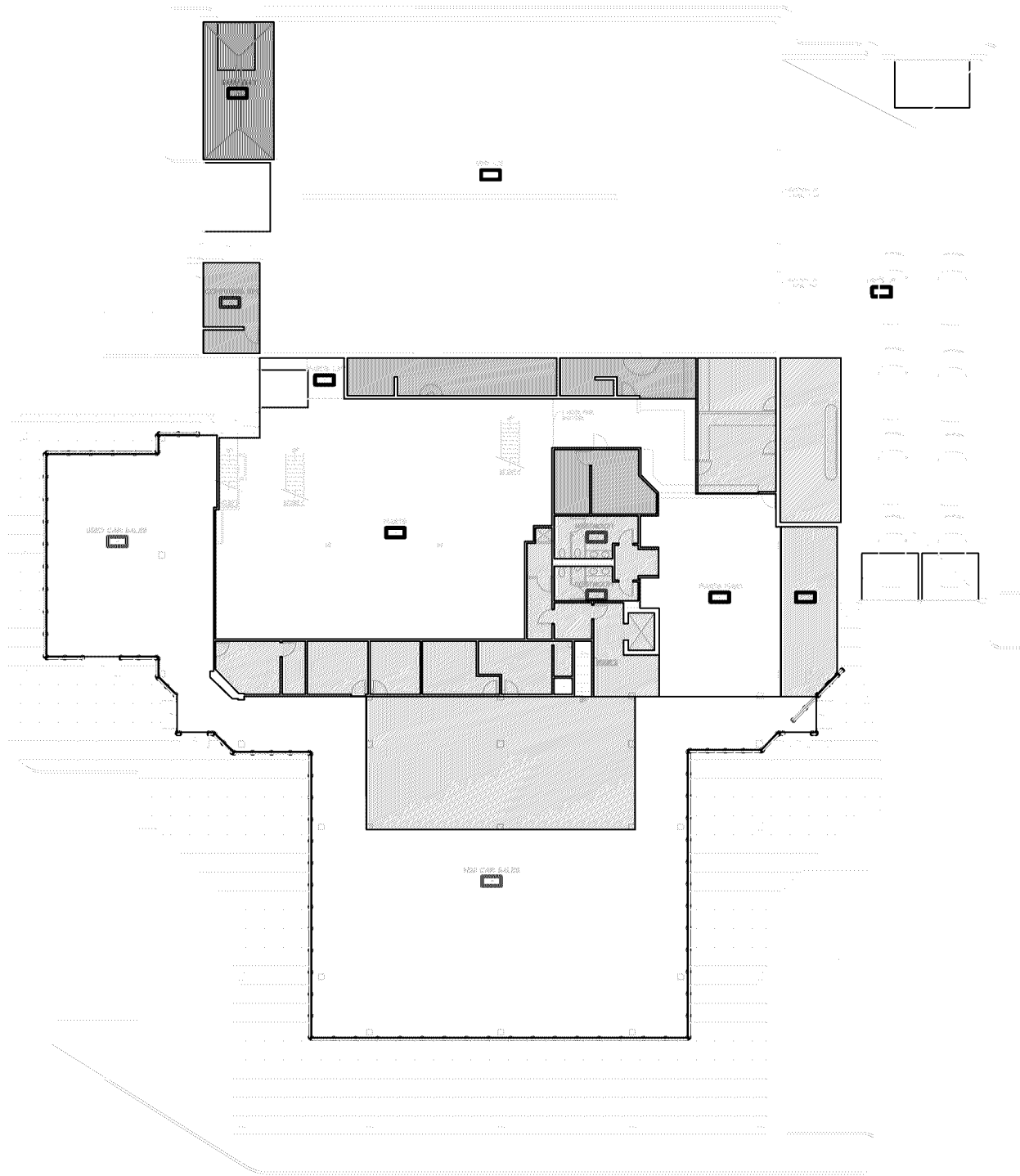

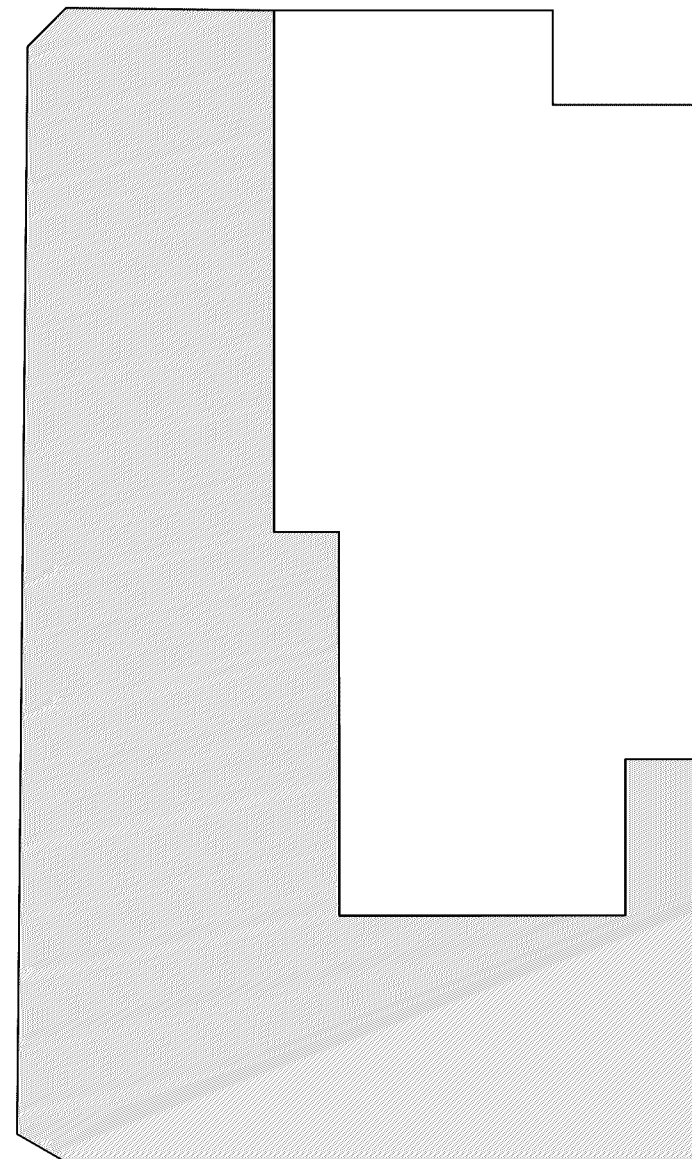

FIRST FLOOR



SECOND FLOOR



LEGEND

-  :DENOTES OFFICE AREA
-  :DENOTES WAREHOUSE AREA
-  :DENOTES RETAIL AREA
-  :DENOTES SERVICE AREA
-  :DENOTES CARWASH AREA
-  :DENOTES MISCELLANEOUS AREA

PARKING SUMMARY

REQUIRED SUBARU PARKING:

SERVICE AREA	THREE STALLS FOR EACH ENCLOSED "MAJOR SERVICE" BAY	10	30 STALLS
	TWO STALLS FOR EACH ENCLOSED "MINOR SERVICE" BAY	7	14 STALLS
CAR WASH	ONE STALL PER 375 SF OF GFA	*440 SF CAR WASH	*1 STALLS
OFFICE	ONE STALL PER 285 SF OF OFFICE GFA	*9,755 SF OFFICE AREA	*34 STALLS
LARGE ITEM RETAIL	ONE STALL PER 220 SF OF RETAIL GFA	*6,468 SF SHOWROOM AREA	*29 STALLS
WAREHOUSE	ONE STALL PER 1,000 SF OF WAREHOUSE GFA	*9,333 SF WAREHOUSE AREA	*9 STALLS
MISC.	ONE STALL PER 350 SF OF MISCELLANEOUS GFA	1,083 SF MISCELLANEOUS AREA	3 STALLS
SERVICE	SERVICE DIAGNOSTICS PROVIDES 8 INTERIOR PARKING SPACES		-8 STALLS
TOTAL EXTERIOR PARKING STALLS REQUIRED			112 STALLS

* DENOTES VALUE USED TO CALCULATE MISCELLANEOUS AREA RATIO.
29,893 SF / 73 STALLS REQUIRED = 1 STALL / 350 SF