

PL201900150
PL2019-150

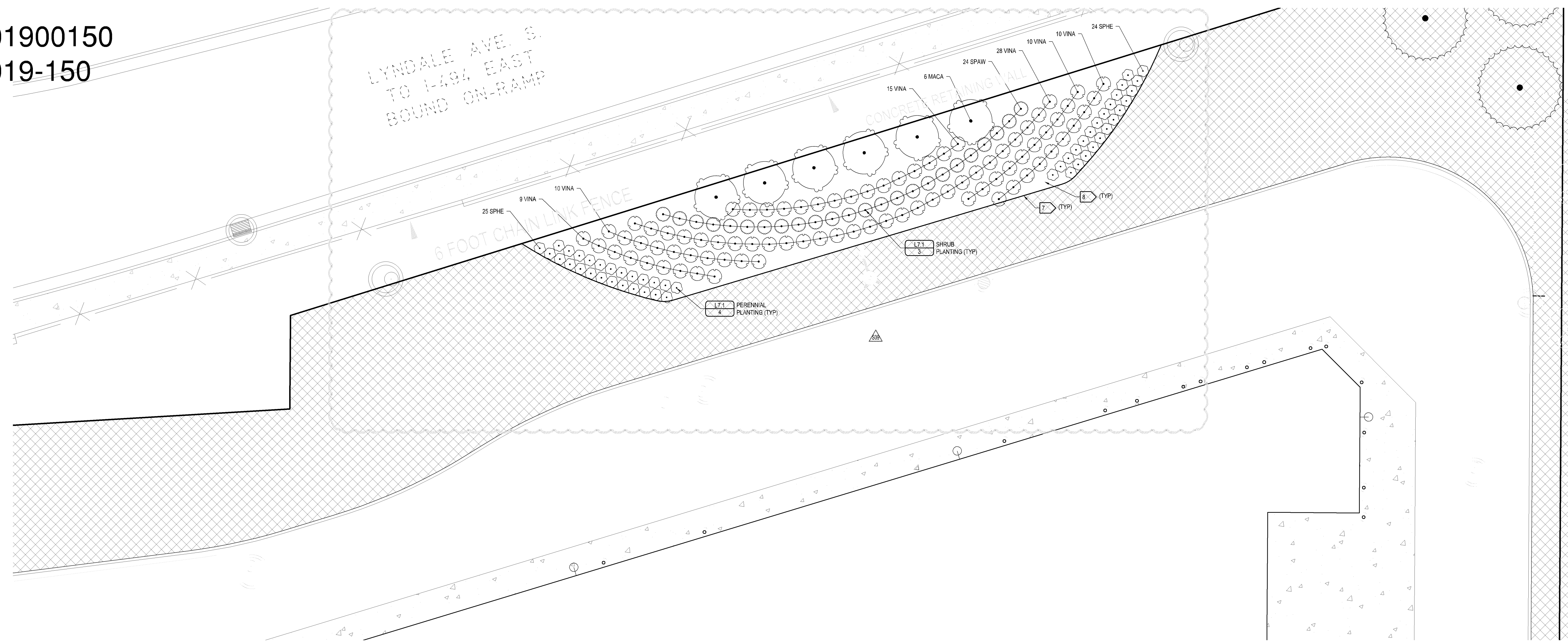

LANDSCAPE NOTES

- CONTACT UTILITY SERVICE PROVIDERS FOR FIELD LOCATION OF SERVICES 72 HOURS PRIOR TO BEGINNING.
- COORDINATE INSTALLATION WITH CONTRACTORS PERFORMING RELATED WORK.
- CONTRACTOR IS RESPONSIBLE FOR VISITING SITE TO FAMILIARIZE WITH SITE CONDITIONS AND CONSTRAINTS.
- SOO ALL AREAS AS INDICATED ON PLAN. SPREAD A MINIMUM OF THREE (3) INCHES OF TOPSOIL AND HOLD DOWN TOPSOIL TWO (2) INCHES FOR SOO THICKNESS. SEE SHEET C3.1 FOR FINAL DESIGN GRADES.
- ALL PLANT MATERIALS SHALL CONFORM WITH THE MOST CURRENT EDITION OF THE AMERICAN ASSOCIATION OF NURSERYMEN STANDARDS AND SHALL BE OF HARDY STOCK, FREE FROM INFESTATION, DISEASE, DAMAGE AND DISPARATION. IF THERE IS A DISCREPANCY BETWEEN THE NUMBER OF PLANTS ON THE SCHEDULE AND THE NUMBER SHOWN ON THE PLAN, THE PLAN SHALL GOVERN.
- PLANTING SOIL FOR PERENNIALS, SHRUBS AND TREES SHALL CONSIST OF INDOT SELECT TOPSOIL BORROW UNLESS OTHERWISE NOTED. SEE DETAILS FOR DEPTH OF PLANTING SOIL.
- EDGE PLANTING BEDS AND SEPARATE MULCH TYPES WITH 8 INCH BLACK VINYL EDGING (BLACK DIAMOND OR APPROVED EQUAL).
- INSTALL 4 INCH DEPTH (3" NOMINAL SIZE) GRAY TRAP ROCK IN ALL PLANTING BEDS UNLESS OTHERWISE NOTED. LANDSCAPE FABRIC SHALL BE INSTALLED UNDER ALL AREAS OF ROCK MULCH.
- AUTOMATIC DRIP IRRIGATION SYSTEM TO BE USED TO IRRIGATE ALL LANDSCAPE BEDS. DIRECTIONAL SPRAY IRRIGATION TO BE USED FOR TURF AND TREES IN TURF AREAS. IRRIGATION CONTRACTOR TO SUBMIT SHOP DRAWING TO LANDSCAPE ARCHITECT PRIOR TO INSTALLATION.
- PLANTING SOIL FOR PARKING LOT ISLANDS SHALL BE A 1:1:1 MIX OF SOIL, COMPOST AND SAND.
- TREES LOCATED IN TURF OR NATIVE BEDS AREAS SHALL RECEIVE A FOUR (4) FOOT DIAMETER SHREDDED HARDWOOD MULCHING, TO A DEPTH OF FOUR (4) INCHES. DO NOT INSTALL EDGING AROUND MULCHING.
- SEED, SOO, MULCH AND FERTILIZER SHALL MEET THE FOLLOWING SPECIFICATIONS, AS MODIFIED:
SEED: INDOT 3075
MULCH (INDOT TYPE 1 @ 2 TON/AC, DISC ANCHORED/INDOT 3862
FERTILIZER: INDOT 3881
INDOT 2575
GENERAL PLACEMENT
- QUANTITIES SHOWN ON PLANT SCHEDULE ARE FOR THIS SHEET ONLY. SEE SHEET L2.1 FOR TOTAL QUANTITIES FOR DESIGN.
- PLANT MATERIAL SHALL BE UNDER WARRANTY FOR A PERIOD OF TWO (2) YEARS. WARRANTY PERIOD SHALL START AFTER ALL PLANTING HAS BEEN COMPLETED. LANDSCAPE ARCHITECT SHALL PERFORM A SITE INSPECTION AFTER FIRST AND SECOND GROWING SEASONS TO DETERMINE VIABILITY AND ANY NECESSARY REPLACEMENT OF ANY PLANT MATERIAL. AFTER INSPECTION, THE CONTRACTOR SHALL REPLACE PLANT MATERIAL DEEMED UNACCEPTABLE BY LANDSCAPE ARCHITECT WITH PLANT (S) OF SAME VARIETY AND SIZE AS ORIGINAL AT THE CONTRACTOR'S EXPENSE.

DEVELOPER

MOTORS MANAGEMENT CORPORATION
3701 ALABAMA AVENUE SOUTH
ST. LOUIS PARK, MN 55416
TEL: (612)252-8800 - FAX: (612)252-8900

MUNICIPALITY



PROJECT

LUTHER BLOOMINGTON
ACURA SUBARU
BLOOMINGTON, MN

SHEET INDEX

NO.	TITLE
C1.1	EXISTING SITE
C1.2	EXISTING CONDITIONS
C1.3	CONSTRUCTION
C1.4	DESIGN PLAN
C1.5	DESIGN PLAN - FINISH GRADES, FINISH ELEVATIONS
C1.6	DESIGN PLAN - CONCRETE
C1.7	DESIGN PLAN - FINISH GRADES, FINISH ELEVATIONS
C1.8	DESIGN PLAN - FINISH GRADES, FINISH ELEVATIONS
C1.9	DESIGN PLAN - FINISH GRADES, FINISH ELEVATIONS
C1.10	DESIGN PLAN - FINISH GRADES, FINISH ELEVATIONS
C1.11	DESIGN PLAN - FINISH GRADES, FINISH ELEVATIONS
C1.12	DESIGN PLAN - FINISH GRADES, FINISH ELEVATIONS
C1.13	DESIGN PLAN - FINISH GRADES, FINISH ELEVATIONS

PLANT SCHEDULE

FLOWERING TREES	QTY	BOTANICAL / COMMON NAME	MATURE SIZE	PLANTING SIZE	ROOT COND.
MACA	6	MALUS X CAMELOT TM / CAMELOT CRAB APPLE	8 H X 10 W	1.75 GAL	POT
SHRUBS	QTY	BOTANICAL / COMMON NAME	MATURE SIZE	PLANTING SIZE	ROOT COND.
SPAW	24	SPRAEA X BUBALDA ANTHONY WATERER / ANTHONY WATERER SPRAEA	3 H X 3 W	3 GAL	POT
VNA	82	VIBURNUM OPLULUS NANLUM / DWARF EUROPEAN VIBURNUM	2 H X 3 W	3 GAL	POT
GRASSES	QTY	BOTANICAL / COMMON NAME	MATURE SIZE	PLANTING SIZE	ROOT COND.
SPHE	43	SPOROBOLUS HETEROLEPIS / PRINCE DROPS EED	2 H X 2 W	2 GAL	POT

ISSUE / REVISION HISTORY

DATE	ISSUE / REVISION	REVIEW
10.02.2019	BLOOMINGTON PERMIT SUBMITTAL	SES
17.04.2019	ADDENDUM #1	SES
18.06.2019	BULLETIN S01	SES
22.09.2019	REVISION PER SUBMITTAL	SES
05.08.2020	BULLETIN S02	SES
05.08.2020	BULLETIN S03	SES
10.09.2020	BULLETIN S04	SES
04.02.2020	CITY PERMITTAL	SES
10.04.2020	BULLETIN S05	SES

PROJECT MANAGER REVIEW

BY: SES DATE OF REVIEW: 05.28.20

CERTIFICATION

I hereby certify that this plan was prepared by me or under my direct supervision, and that I am a duly Licensed Landscape Architect or the Vice of the State of MINNESOTA.

Josh Pappas
Joshua K. Pappas 00001 Date: 07/15/2020

Signature shown is digital reproduction of original. The original copy of this plan on file at Landform Professional Services, LLC office and is available upon request.

IF THE SIGNATURE, SEAL OR FOUR LINES DIRECTLY ABOVE ARE NOT VISIBLE, THIS SHEET HAS BEEN REPRODUCED BY OTHER METHODS. REQUIRE TO PRINT TO OBTAIN AN ACCURATE COPY TO FILE. CONTACT THE ENGINEER TO REQUEST ADDITIONAL DOCUMENTS.

BULLETIN S09
JULY 15, 2020

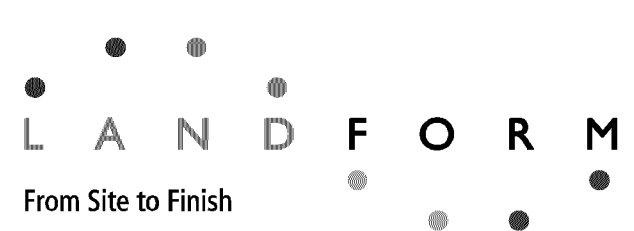

105 South Fifth Avenue Tel: 612-252-9070
Suite 513 Fax: 612-252-9077
Minneapolis, MN 55401 Web: landform.net
FILE NAME: L2020AA041.DWG
PROJECT NO.: BAA14041

ENLARGED LANDSCAPE PLAN
L2.2

Landform and Site to Finish are registered landscape architects of Landform Professional Services, LLC.

