

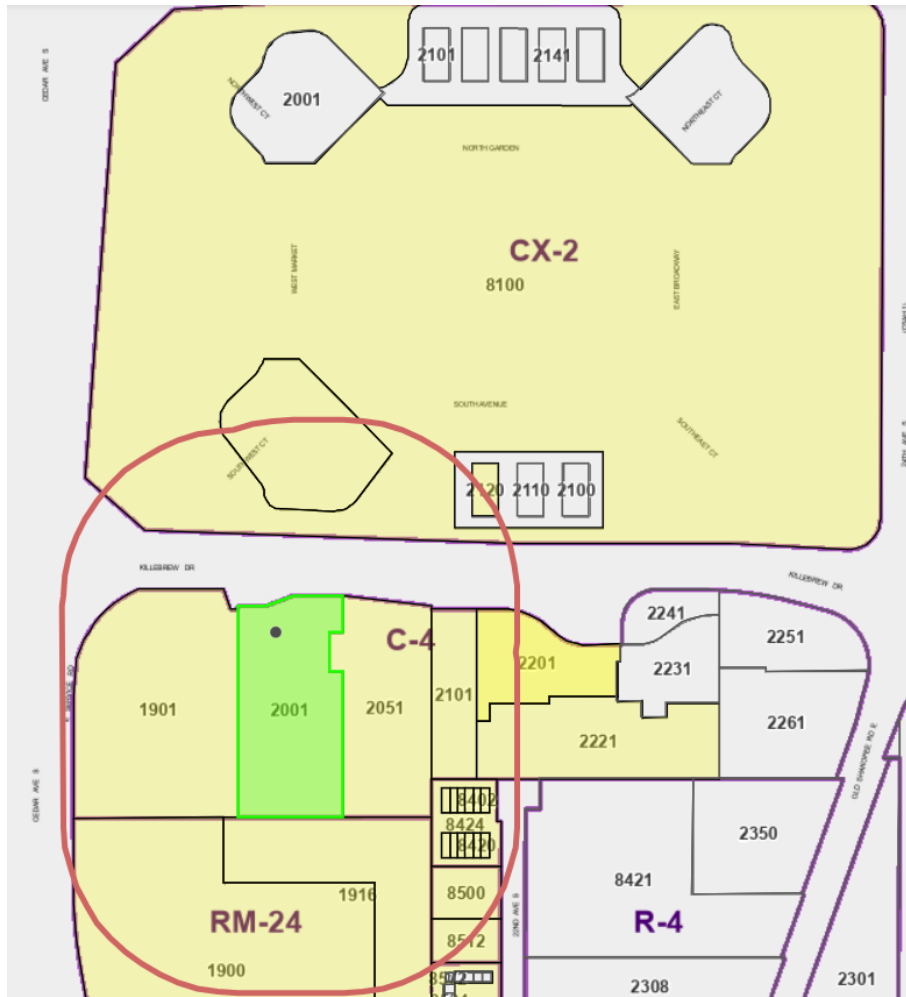



City of Bloomington Notification Map



Case PL2025-74

Subject Properties: 2001 Killebrew Dr

-  Notification Boundary (500 feet)
-  Subject Property/Properties
-  Notified Properties



ULBRICH, JAMISON
8402 22ND AVE S
BLOOMINGTON, MN 55425

KATIPUNAN, ALEXANDRA BALITON
94-124 PUPUPUHI ST #302
WAIPAHU, HI 96797

SOUTH PAD HOTEL LLC
2131 LINDAU LN #500
BLOOMINGTON, MN 55425

SANNEH ANTHONY R
8400 22ND AVE S
BLOOMINGTON, MN 55425

JARRETT YVONNE M
8406 22ND AVE S
BLOOMINGTON, MN 55425

MOAC MALL HOLDINGS LLC
145 PROGRESS PL
SPRINGDALE, OH 45246

24 EAST 13 LLC
3711 SHORE PKY
BROOKLYN, NY 11235

COUNTRYSIDE VILLAGE ASSN
8422 22ND AVE S
BLOOMINGTON, MN 55425

STORLIEN DANIEL R
8410 22ND AVE S
BLOOMINGTON, MN 55425

FAN CHONG LING FENG
8408 22ND AVE S
BLOOMINGTON, MN 55425

THOMAS, LORI
2266 CHESTNUT BLUFFS AVE
HENDERSON, NV 89052

HATHAWAY CAROL J
8418 22ND AVE S
BLOOMINGTON, MN 55425

GRIZZLY MANAGEMENT 8524 LLC
545 TAMARACK AVE SUITE F
LONG LAKE, MN 55356

MSP BLN OFFICE LLC
800 LASALLE AVE #1250
MPLS, MN 55402

HERTZ HOME LLC
P O BOX 14494
MPLS, MN 55414

BLOOMINGTON CIS LP
2221 KILLEBREW DR
BLOOMINGTON, MN 55425

M & V ROCHESTER LLC
2401 WEST 52ND STREET
MPLS, MN 55410

THREE RINGS LLC
800 LASALLE AVENUE #1250
MPLS, MN 55402

COLONIAL TOWNHOMES LLC
P O BOX 209
HANOVER, MN 55341

MOAC MALL HOLDINGS LLC
2131 LINDAU LANE #500
BLOOMINGTON, MN 55425

AEON VP BLOOMINGTON LLC
901 N 3RD ST #150
MPLS, MN 55401

COMPASS ROSE R E LLC
4920 30TH AVE S #209
FARGO, ND 58104

2276 HOMECREST REALTY LLC
1245 HEWLETT PLAZA #56
HEWLETT, NY 11557

AEON VP BLOOMINGTON 172 LIM
901 N 3RD ST #150
MPLS, MN 55401

ANDERSON, MICHAEL DAVID
8404 22ND AVE S
BLOOMINGTON, MN 55425

RHEAUME CRAIG A
4920 30TH AVE S
FARGO, ND 58104