

PL201600233

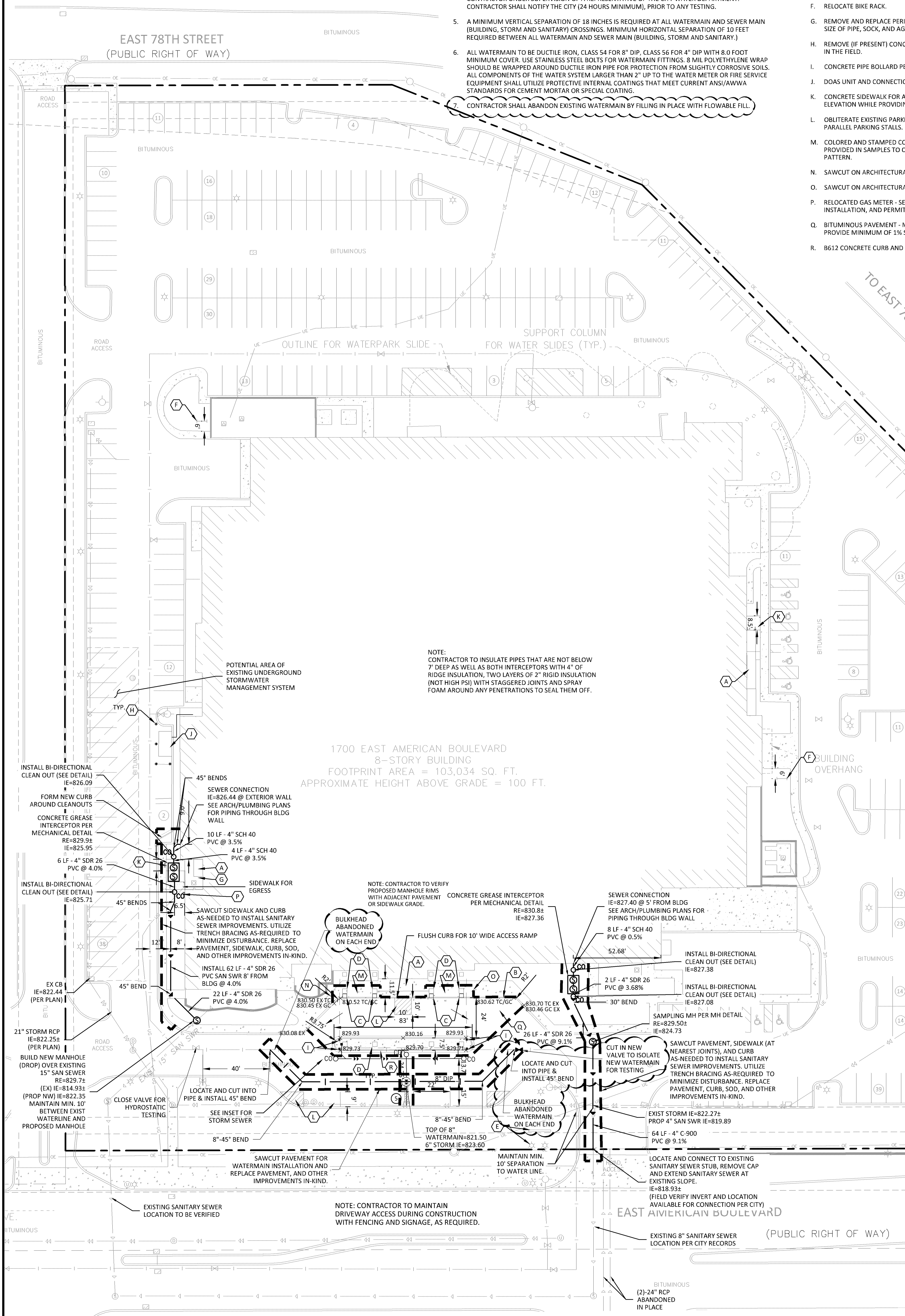

WATERMAIN NOTES

- CONTRACTOR IS RESPONSIBLE FOR COMPLYING TO THE SPECIFICATIONS OF THE LOCAL AUTHORITIES WITH REGARD TO MATERIALS AND INSTALLATION OF THE WATERMAINS.
- CONTRACTOR SHALL NOT OPEN, TURN OFF, INTERFERE WITH, OR ATTACH ANY PIPE OR HOSE TO OR TAP ANY WATERMAIN BELONGING TO THE CITY UNLESS DULY AUTHORIZED TO DO SO BY THE CITY. ANY ADVERSE CONSEQUENCES OF ANY SCHEDULED OR UNSCHEDULED DISRUPTIONS OF SERVICE TO THE PUBLIC ARE TO BE THE LIABILITY OF THE CONTRACTOR.
- WATERMAINS SHALL BE INSPECTED AND APPROVED BY THE CITY. THE CITY SHALL BE NOTIFIED PRIOR TO COMMENCING WITH THE UTILITY CONSTRUCTION.
- DISINFECTION, BACTERIOLOGICAL, CONDUCTIVITY AND PRESSURE/LEAKAGE TESTING OF WATER LINES SHALL BE PERFORMED PER CITY OF BLOOMINGTON STANDARD SPECIFICATIONS AND PAID FOR BY THE CONTRACTOR UNDER SUPERVISION OF A REPRESENTATIVE OF THE CITY WATER DEPARTMENT. CONTRACTOR SHALL NOTIFY THE CITY (24 HOURS MINIMUM), PRIOR TO ANY TESTING.
- A MINIMUM VERTICAL SEPARATION OF 18 INCHES IS REQUIRED AT ALL WATERMAIN AND SEWER MAIN (BUILDING, STORM AND SANITARY) CROSSINGS. MINIMUM HORIZONTAL SEPARATION OF 10 FEET REQUIRED BETWEEN ALL WATERMAIN AND SEWER MAIN (BUILDING, STORM AND SANITARY.)
- ALL WATERMAIN TO BE DUCTILE IRON, CLASS 54 FOR 8" DIP, CLASS 56 FOR 4" DIP WITH 8.0 FOOT MINIMUM COVER. USE STAINLESS STEEL BOLTS FOR WATERMAIN FITTINGS. 8 MIL POLYETHYLENE WRAP SHOULD BE WRAPPED AROUND DUCTILE IRON PIPE FOR PROTECTION FROM SLIGHTLY CORROSIVE SOILS. ALL COMPONENTS OF THE WATER SYSTEM LARGER THAN 2" UP TO THE WATER METER OR FIRE SERVICE EQUIPMENT SHALL UTILIZE PROTECTIVE INTERNAL COATINGS THAT MEET CURRENT ANSI/AWWA STANDARDS FOR CEMENT MORTAR OR SPECIAL COATING.
- CONTRACTOR SHALL ABANDON EXISTING WATERMAIN BY FILLING IN PLACE WITH FLOWABLE FILL.

KEY NOTES

- BUILDING, STOOPS, STAIRS SEE ARCHITECTURAL PLANS.
- DEPRESSED CURB PER DETAIL. MATCH NEW CURB ELEVATION TO EXISTING CURB AND SIDEWALK ELEVATION ALONG EDGES OF SAWCUT, WHILE PROVIDING FOR MINIMUM OF 1% SLOPE AWAY FROM BUILDING AT ALL TIMES. MATCH CURB CONCRETE COLOR AND JOINTS WITH THAT BEHIND CURB.
- REMOVE EXISTING CULMIN.
- PROPOSED CULMIN - SEE ARCHITECTURAL PLANS FOR DETAIL AND LOCATION GRID.
- REMOVE EXISTING MONUMENT SIGN - PROTECT EXISTING FOUNDATION/BASE. REPLACE WITH GREAT WOLF MONUMENTATION ON EXISTING BASE PER ARCHITECTURAL DETAIL. PROTECT SIGN FOOT-LIGHTS AND ADJUST AS NEEDED.
- RELOCATE BIKE RACK.
- REMOVE AND REPLACE PERIMETER DRAINAGE PER ARCHITECTURAL PLANS. MATCH EXISTING TYPE AND SIZE OF PIPE, SOCK, AND AGGREGATE.
- REMOVE (IF PRESENT) CONCRETE PIPE BOLLARD AND REINSTALL (OR PLACE NEW), CONFIRMING LOCATION IN THE FIELD.
- CONCRETE PIPE BOLLARD PER ARCHITECTURAL PLANS. MATCH EXISTING.
- DOAS UNIT AND CONNECTION TO BUILDING - SEE MECHANICAL PLAN.
- CONCRETE SIDEWALK FOR ARCHITECTURAL STAIR LANDING - MEET AND MATCH EXISTING SIDEWALK ELEVATION WHILE PROVIDING MINIMUM 1% SLOPE AWAY FROM BUILDING.
- OBTERATE EXISTING PARKING STRIPING, REPLACE WITH 4" TRAFFIC STRIPING (WHITE), ESTABLISHING 5 PARALLEL PARKING STALLS.
- COLORLED AND STAMPED CONCRETE PAVEMENT TO MATCH EXISTING: ASHLAR PATTERN, COLOR TO BE PROVIDED IN SAMPLES TO OWNER FOR APPROVAL. JOINTS SHALL MATCH EXISTING PAVEMENT JOINT PATTERN.
- SAWCUT ON ARCHITECTURAL GRID LINE F - SEE ARCHITECTURAL PLANS.
- SAWCUT ON ARCHITECTURAL GRID LINE K - SEE ARCHITECTURAL PLANS.
- RELOCATED GAS METER - SEE ARCHITECTURAL PLANS. CONTRACTOR TO COORDINATE LOCATION, INSTALLATION, AND PERMITTING WITH THE UTILITY COMPANY.
- BITUMINOUS PAVEMENT - MEET AND MATCH EXISTING PAVEMENT ELEVATION ALONG SAWCUT LINES. PROVIDE MINIMUM OF 1% SLOPE AWAY FROM BUILDING AT ALL TIMES.
- 8612 CONCRETE CURB AND GUTTER WITH CONCRETE SIDEWALK INFILL (SEE DETAILS).

GRADING NOTES

- ALL GRADIENT ON SIDEWALKS ALONG THE ADA ROUTE SHALL HAVE A MAXIMUM LONGITUDINAL SLOPE OF 5% (1:20), EXCEPT AT CURB RAMPS (1:12), AND A MAXIMUM CROSS SLOPE OF 2.08% (1:48). MAXIMUM SLOPE IN ANY DIRECTION ON AN ADA PARKING STALL OR ACCESS AREA SHALL BE 1:20 (1:48). CONTRACTOR SHALL REVIEW AND VERIFY THE GRADIENT IN THE FIELD ALONG THE ADA ROUTES PRIOR TO PLACING CONCRETE OR BITUMINOUS. CONTRACTOR SHALL NOTIFY THE ENGINEER IMMEDIATELY IF THERE IS A DISCREPANCY BETWEEN THE GRADIENT IN THE FIELD VERSUS THE DESIGN GRADIENT. COORDINATE ALL WORK WITH PAVING CONTRACTOR.
- CONTRACTOR SHALL TAKE ALL PRECAUTIONS NECESSARY TO AVOID PROPERTY DAMAGE TO ADJACENT PROPERTIES DURING THE CONSTRUCTION PHASES OF THIS PROJECT. CONTRACTOR WILL BE HELD SOLELY RESPONSIBLE FOR ANY DAMAGES TO THE ADJACENT PROPERTIES OCCURRING DURING THE CONSTRUCTION PHASES OF THIS PROJECT.
- SAFETY NOTICE TO CONTRACTORS: IN ACCORDANCE WITH GENERALLY ACCEPTED CONSTRUCTION PRACTICES, CONTRACTOR WILL BE SOLELY AND COMPLETELY RESPONSIBLE FOR CONDITIONS ON THE JOB SITE, INCLUDING SAFETY OF ALL PERSONS AND PROPERTY DURING PERFORMANCE OF THE WORK. THIS REQUIREMENT WILL APPLY CONTINUOUSLY AND NOT BE LIMITED TO NORMAL WORKING HOURS. THE DUTY OF THE ENGINEER OR THE DEVELOPER TO CONDUCT CONSTRUCTION REVIEW OF THE CONTRACTOR'S PERFORMANCE IS NOT INTENDED TO INCLUDE REVIEW OF THE ADEQUACY OF THE CONTRACTOR'S SAFETY MEASURES IN, ON OR NEAR THE CONSTRUCTION SITE.
- CONTRACTOR SHALL COMPLETE THE SITE GRADING CONSTRUCTION IN ACCORDANCE WITH THE REQUIREMENTS OF THE OWNER'S SOILS ENGINEER. ALL SOIL TESTING SHALL BE COMPLETED BY THE OWNER'S SOILS ENGINEER. CONTRACTOR SHALL BE RESPONSIBLE FOR COORDINATING ALL REQUIRED SOIL TESTS AND INSPECTIONS WITH THE SOILS ENGINEER.
- CONTRACTOR SHALL COMPLETE DOWATERING AS REQUIRED TO COMPLETE THE SITE GRADING AND UTILITY CONSTRUCTION.
- PRIOR TO PLACEMENT OF THE AGGREGATE BASE, A TEST ROLL SHALL BE PERFORMED ON THE STREET AND PARKING AREA SUBGRADE. CONTRACTOR SHALL PROVIDE A LOADED TANKER TRUCK WITH A GROSS WEIGHT OF 25 TONS. THE TEST ROLLING SHALL BE AT THE DIRECTION OF THE SOILS ENGINEER AND SHALL BE COMPLETED IN AREAS AS DIRECTED BY THE SOILS ENGINEER. CORRECTION OF THE SUBGRADE SOILS SHALL BE COMPLETED IN ACCORDANCE WITH THE REQUIREMENTS OF THE SOILS ENGINEER.
- REPLACE ALL SUBGRADE SOIL DISTURBED DURING THE CONSTRUCTION THAT HAVE BECOME UNSUITABLE AND WILL NOT PASS A TEST ROLL. REMOVE UNSUITABLE SOIL FROM THE SITE AND IMPORT SUITABLE SOIL AT NO ADDITIONAL COST TO THE OWNER.
- EXISTING TREES AND OTHER NATURAL VEGETATION WITHIN THE PROJECT AND/OR ADJACENT TO THE PROJECT ARE OF PRIME CONCERN TO THE CONTRACTOR'S OPERATIONS AND SHALL BE A RESTRICTED AREA. CONTRACTOR SHALL PROTECT TREES TO REMAIN AT ALL TIMES. EQUIPMENT SHALL NOT NECESSARILY BE OPERATED UNDER NEARBY TREES AND EXTREME CAUTION SHALL BE EXERCISED WHEN WORKING ADJACENT TO TREES. SHOULD ANY PORTION OF THE TREE BRANCHES REQUIRE REMOVAL TO PERMIT OPERATION OF THE CONTRACTOR'S EQUIPMENT, CONTRACTOR SHALL OBTAIN THE SERVICES OF A PROFESSIONAL TREE TRIMMING SERVICE TO TRIM THE TREES PRIOR TO THE BEGINNING OF OPERATION. SHOULD CONTRACTOR'S OPERATIONS RESULT IN THE BREAKING OF ANY LIMBS, THE BROKEN LIMBS SHOULD BE REMOVED IMMEDIATELY AND CUTS SHALL BE PROPERLY PROTECTED TO MINIMIZE ANY LASTING DAMAGE TO THE TREE. NO TREES SHALL BE REMOVED WITHOUT AUTHORIZATION BY THE ENGINEER. COSTS FOR TRIMMING SERVICES SHALL BE CONSIDERED INCIDENTAL TO THE GRADING CONSTRUCTION AND NO SPECIAL PAYMENT WILL BE MADE.
- RESTRICTED AREAS SHALL INCLUDE ALL DESIGNATED TREED AREAS OUTSIDE OF THE DESIGNATED CONSTRUCTION ZONE. ALL VEGETATION WITHIN THE RESTRICTED AREAS SHALL REMAIN.
- CONTRACTOR SHALL RESTRICT ALL GRADING AND CONSTRUCTION ACTIVITIES TO AREAS DESIGNATED ON THE PLANS. ACTIVITIES WITHIN THE CONSTRUCTION MAY BE RESTRICTED TO A NARROWER WIDTH IN THE FIELD TO SAVE ADDITIONAL TREES AS DIRECTED BY THE OWNER.
- ACTIVITIES PROHIBITED OUTSIDE OF THE CONSTRUCTION BOUNDARIES WOULD INCLUDE, BUT NOT BE LIMITED TO: SOIL AND OTHER MATERIAL STOCKPILING, EQUIPMENT OR MACHINERY STORAGE, DRIVING OF ANY VEHICLE, LEAKAGE OR SPILLAGE OF ANY "WASHOUT" OR OTHER TOXIC MATERIAL, THE COLLECTION OF OTHER DEBRIS, AND SOIL STOCKPILING WILL BE IN AN AREA DETERMINED ON-SITE BY THE ENGINEER.
- ALL RESTRICTED AREAS SHALL BE FENCED OFF WITH BRIGHT ORANGE POLYETHYLENE SAFETY NETTING AND STEEL STAKES AS SHOWN ON THE TREE PROTECTION DETAIL. AT NO TIME SHALL THIS FENCING BE REMOVED OR ACTIVITY OF ANY KIND TAKE PLACE WITHIN IT. FINAL PLACEMENT OF ALL PROTECTIVE FENCING SHALL BE COMPLETE BEFORE ANY WORK COMMENCES ON-SITE.
- BEFORE COMMENCING WITH ANY EXCAVATION CONTRACTOR SHALL COMPLETE ALL PREPARATORY WORK REGARDING TREE REMOVAL, ROOT PRUNING, TREE PRUNING AND STUMP REMOVAL TO THE SATISFACTION OF THE OWNER.
- PREPARATORY WORK SHALL INCLUDE THE FOLLOWING AND SHALL BE COMPLETED UNDER THE DIRECT SUPERVISION OF THE OWNER'S REPRESENTATIVE.
 - TREE REMOVAL: CONTRACTOR SHALL FELL THE TREES. AT NO TIME SHALL TREES BE BULDOZED OUT, BUT SHALL BE CUT DOWN AND STUMPS REMOVED SEPARATELY. PRIOR TO THE FELLING OF ALL TREES, PROPER REMOVAL OF A PORTION OR ALL OF THE CANOPY SHALL BE COMPLETED SO THAT TREES IN THE RESTRICTED AREAS SHALL NOT BE INJURED IN THE PROCESS.
 - ROOT PRUNING: BEFORE ANY STUMPS ARE TO BE REMOVED, ALL ROOTS SHALL BE SEVERED FROM ROOTS IN THE RESTRICTED AREAS BY SAW CUTTING WITH A VERMIER DESIGNED FOR ROOT PRUNING, BY HAND, OR WITH A CHAINSAW. TREE ROOTS PROJECTING INTO THE CONSTRUCTION ZONE SHALL BE EXPOSED PRIOR TO ROOT PRUNING WITH SMALL MACHINERY, I.E., BOCAT.
 - STUMP REMOVAL: AT SUCH TIME THAT ROOTS HAVE BEEN PROPERLY SEVERED, STUMPS MAY BE REMOVED. WHERE REMOVAL OF CERTAIN STUMPS COULD CAUSE DAMAGE TO EXISTING PROTECTED TREES, TREE STUMPS SHALL BE GROUND OUT. ALL STUMP REMOVAL SHALL BE UNDER THE DIRECT SUPERVISION OF THE OWNER'S REPRESENTATIVE.
 - TREE PRUNING: PROPER PRUNING OF TREES IN THE RESTRICTED ZONE SHALL BE DIRECTED BY AND SUPERVISION AT ALL TIMES BY THE OWNER'S REPRESENTATIVE.
 - AN OWNER'S REPRESENTATIVE WILL BE AVAILABLE AT ALL TIMES DURING THE PREPARATORY AND CONSTRUCTION PERIOD.
 - MULCH RATHER THAN SEED OR SOIL WILL BE USED AT THE BASE OF QUALITY TREES TO A PERIMETER DETERMINED BY THE OWNER'S REPRESENTATIVE. AREAS TO BE SEED FOR EROSION CONTROL. PURPOSES WITHIN THE CONSTRUCTION ZONE ARE TO BE DETERMINED BY THE OWNER'S REPRESENTATIVE. NATURAL GROUND COVER WILL BE MAINTAINED WHERE POSSIBLE.
 - THE USE OF RETAINING WALLS NEAR TREES, IN ADDITION TO THOSE REQUIRED ON THE PLANS SHALL BE DETERMINED IN THE FIELD, BASED ON TREE LOCATIONS AND TOPOGRAPHY.
- FINISHED GRADING SHALL BE COMPLETED. CONTRACTOR SHALL UNIFORMLY GRADE AREAS WITHIN LIMITS OF GRADING, INCLUDING ADJACENT TRANSITION AREAS. PROVIDE A SMOOTH FINISHED SURFACE WITHIN SPECIFIED TOLERANCES, WITH UNIFORM LEVELS OR SLOPES BETWEEN POINTS WHERE ELEVATIONS ARE SHOWN, OR BETWEEN SUCH POINTS AND EXISTING GRADIES. AREAS THAT HAVE BEEN FINISHED GRADED SHALL BE PROTECTED FROM SUBSEQUENT CONSTRUCTION OPERATIONS, TRAFFIC, AND EROSION. REPAIR ALL AREAS THAT HAVE BECOME BUTTERED, BROKEN OR HAS SETTLED BELOW THE CORRECT GRADE. ALL AREAS DISTURBED BY THE CONTRACTOR'S OPERATIONS SHALL BE RESTORED TO EQUAL, OR BETTER THAN ORIGINAL CONDITION OR TO THE REQUIREMENTS OF THE NEW WORK.
- TOLERANCES - TOPSOIL SHALL BE COMPLETED TO PLUS OR MINUS 1/2 INCH OF THE SPECIFIED THICKNESS.
- AFTER THE SITE GRADING IS COMPLETED, IF EXCESS OR SHORTAGE OF SOIL MATERIAL EXISTS, CONTRACTOR SHALL TRANSPORT ALL EXCESS SOIL MATERIAL OFF THE SITE TO AN AREA SELECTED BY THE CONTRACTOR, OR IMPORT SUITABLE MATERIAL TO THE SITE.
- CONTRACTOR SHALL DETERMINE THE LOCATION OF ANY HAIL ROADS THAT MAY BE REQUIRED TO COMPLETE THE SITE GRADING CONSTRUCTION AND SHALL INDICATE HAIL ROADS ON EROSION AND SEDIMENT CONTROL, "SITE MAP". CONTRACTOR SHALL COMPLY WITH THE REQUIREMENTS OF THE GOVERNING AUTHORITY OF EACH ROADWAY. CONTRACTOR SHALL POST WHATEVER SECURITY, AND COMPLY WITH ALL CONDITIONS WHICH ARE REQUIRED BY EACH GOVERNING AUTHORITY OF EACH ROADWAY.

LEGEND

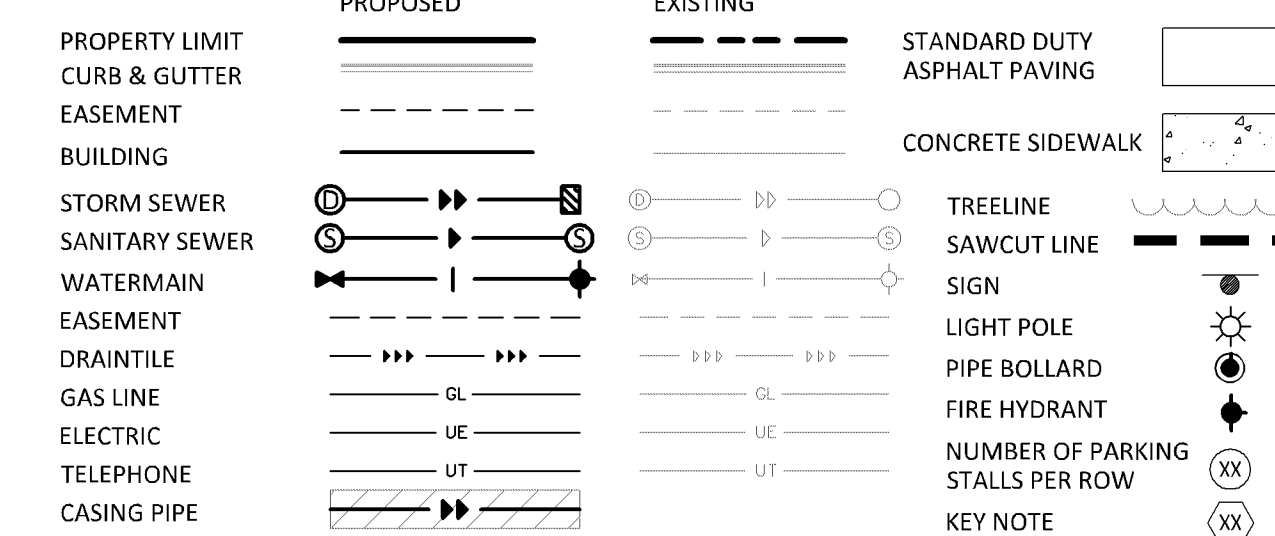

DEVELOPMENT SUMMARY

AREA	381,673 SF	8.762 AC
GROSS SITE AREA		
BUILDING SETBACKS		
FRONT YARD	60 FEET	
REAR YARD	60 FEET	
SIDE YARD	60 FEET	
PARKING SETBACKS		
FRONT YARD	20 FT	
REAR YARD	5 FT	
SIDE YARD	5 FT	
PARKING REQUIRED	541 STALLS	
PROPOSED SURFACE PARKING	505 STALLS	
GARAGE PARKING	41 STALLS	

DEVELOPMENT NOTES

- ALL DIMENSIONS ARE ROUNDED TO THE NEAREST TENTH FOOT.
- ALL DIMENSIONS SHOWN ARE TO THE FACE OF CURB TO FACE OF CURB UNLESS OTHERWISE NOTED.
- CONTRACTOR SHALL REVIEW PAVEMENT GRADIENT AND CONSTRUCT "GUTTER OUT" WHERE WATER DRAINS AWAY FROM CURB. ALL OTHER AREAS SHALL BE CONSTRUCTED AS "GUTTER IN" CURB. COORDINATE WITH GRADING CONTRACTOR.
- ALL AREAS ARE ROUNDED TO THE NEAREST SQUARE FOOT.
- CONTRACTOR SHALL REFER TO ARCHITECTURAL PLANS FOR EXACT LOCATIONS AND DIMENSIONS OF EXIST STAIRS, RAMPS, PRECISE BUILDING DIMENSIONS AND BUILDING UTILITY ENTRANCE LOCATIONS.
- SEE ARCHITECTURAL PLANS FOR GREAT WOLF MONUMENTATION DETAILS.
- SEE SITE LIGHTING PLANS FOR LIGHT POLE FOUNDATION DETAIL AND FOR EXACT LOCATIONS OF LIGHT POLES.
- ALL GRADIENTS ON SIDEWALKS ALONG THE ADA ROUTE SHALL HAVE A MAXIMUM LONGITUDINAL SLOPE OF 5% (1:20), EXCEPT AT CURB RAMPS (1:12), AND A MAXIMUM CROSS SLOPE OF 2.08% (1:48). THE CONTRACTOR SHALL REVIEW AND VERIFY THE GRADIENT IN THE FIELD ALONG THE ADA ROUTES PRIOR TO PLACING CONCRETE OR BITUMINOUS PAVEMENT. THE CONTRACTOR SHALL NOTIFY THE ENGINEER IMMEDIATELY IF THERE IS A DISCREPANCY BETWEEN THE GRADIENT IN THE FIELD VERSUS THE DESIGN GRADIENT AND COORDINATE WITH GRADING CONTRACTOR.
- PROVIDE MINIMUM 1% SLOPE AWAY FROM BUILDING ENTRANCE AT ALL TIMES.

UTILITY CONSTRUCTION NOTES

- THE UTILITY IMPROVEMENTS FOR THIS PROJECT SHALL BE CONSTRUCTED IN ACCORDANCE WITH THE "STANDARD UTILITIES SPECIFICATIONS" AS PUBLISHED BY THE CITY ENGINEERS ASSOCIATION OF MINNESOTA (CEAM), EXCEPT AS MODIFIED HEREIN. CONTRACTOR SHALL OBTAIN A COPY OF THESE SPECIFICATIONS.
 - ALL UTILITIES SHALL BE CONSTRUCTED IN ACCORDANCE WITH CITY REQUIREMENTS.
 - CONTRACTOR SHALL NOT OPEN, TURN OFF, INTERFERE WITH, OR ATTACH ANY PIPE OR HOSE TO OR TAP WATERMAIN BELONGING TO THE CITY UNLESS DULY AUTHORIZED TO DO SO BY THE CITY. ANY ADVERSE CONSEQUENCES OF ANY SCHEDULED OR UNSCHEDULED DISRUPTIONS OF SERVICE TO THE PUBLIC ARE THE LIABILITY OF CONTRACTOR.
 - A MINIMUM VERTICAL SEPARATION OF 18 INCHES AND HORIZONTAL SEPARATION OF 10 FEET BETWEEN OUTSIDE PIPE DIAMETERS IS REQUIRED AT ALL WATERMAIN AND SEWER MAIN (BUILDING, STORM AND SANITARY) CROSSINGS.
- ALL MATERIALS SHALL BE AS SPECIFIED IN CEAM SPECIFICATIONS EXCEPT AS MODIFIED HEREIN.
 - ALL MATERIALS SHALL COMPLY WITH THE REQUIREMENTS OF THE CITY.
 - SANITARY SEWER TO BE PVC SDR-26, UNLESS NOTED OTHERWISE.
 - ALL SANITARY SEWER SERVICES TO BUILDING SHALL BE PVC SCH 40 CONFORMING TO ASTM D2665.
- COORDINATE ALL BUILDING SERVICE CONNECTION LOCATIONS AND INVERT ELEVATIONS WITH MECHANICAL CONTRACTOR PRIOR TO CONSTRUCTION.
- ALL BUILDING SERVICE CONNECTIONS (STORM, SANITARY, WATER) WITH FIVE FEET OR LESS COVER ARE TO BE INSULATED FROM BUILDING TO POINT WHERE 5- FEET OF COVER IS ACHIEVED.
- CONTRACTOR SHALL TAKE ALL PRECAUTIONS NECESSARY TO AVOID PROPERTY DAMAGE TO ADJACENT PROPERTIES DURING THE CONSTRUCTION PHASES OF THIS PROJECT. CONTRACTOR WILL BE HELD SOLELY RESPONSIBLE FOR ANY DAMAGES TO THE ADJACENT PROPERTIES OCCURRING DURING THE CONSTRUCTION PHASES OF THIS PROJECT.
- SAFETY NOTICE TO CONTRACTORS: IN ACCORDANCE WITH GENERALLY ACCEPTED CONSTRUCTION PRACTICES, CONTRACTOR WILL BE SOLELY AND COMPLETELY RESPONSIBLE FOR CONDITIONS ON THE JOB SITE, INCLUDING SAFETY OF ALL PERSONS AND PROPERTY DURING PERFORMANCE OF THE WORK. THIS REQUIREMENT WILL APPLY CONTINUOUSLY AND NOT BE LIMITED TO NORMAL WORKING HOURS. THE DUTY OF THE ENGINEER OR THE DEVELOPER TO CONDUCT CONSTRUCTION REVIEW OF THE CONTRACTOR'S PERFORMANCE IS NOT INTENDED TO INCLUDE REVIEW OF THE ADEQUACY OF CONTRACTOR'S SAFETY MEASURES IN, ON OR NEAR THE CONSTRUCTION SITE.
- ALL AREAS OUTSIDE THE PROPERTY BOUNDARIES THAT ARE DISTURBED BY UTILITY CONSTRUCTION SHALL BE RESTORED IN KIND. SOILED AREAS SHALL BE RESTORED WITH 6 INCHES OF TOPSOIL PLACED BENEATH THE SOIL.
- CONTRACTOR SHALL BE RESPONSIBLE FOR PROVIDING AND MAINTAINING TRAFFIC CONTROL DEVICES SUCH AS BARRICADES, WARNING SIGNS, DIRECTIONAL SIGNS, FLAGMEN AND LIGHTS TO CONTROL THE MOVEMENT OF TRAFFIC WHERE NECESSARY. TRAFFIC CONTROL DEVICES SHALL CONFORM TO APPROPRIATE MINNESOTA DEPARTMENT OF TRANSPORTATION STANDARDS.
- ALL SOILS TESTING SHALL BE COMPLETED BY AN INDEPENDENT SOILS ENGINEER. EXCAVATION FOR THE PURPOSE OF REMOVING UNSTABLE OR UNSUITABLE SOILS SHALL BE COMPLETED AS REQUIRED BY THE SOILS ENGINEER. THE UTILITY BACKFILL CONSTRUCTION SHALL COMPLY WITH THE REQUIREMENTS OF THE SOILS ENGINEER. CONTRACTOR SHALL BE RESPONSIBLE FOR COORDINATING ALL REQUIRED SOIL TESTS AND SOIL INSPECTIONS WITH THE SOILS ENGINEER.
- A GEOTECHNICAL ENGINEERING REPORT HAS BEEN COMPLETED BY:
COMPANY: BRAUN INTERPRET CORPORATION
ADDRESS: 11001 HAMPSHIRE AVE S - MINNEAPOLIS, MN 55438
PHONE: 952-095-2000
DATED: JUNE 22, 2004
CONTRACTOR SHALL OBTAIN A COPY OF THIS SOILS REPORT.
- EXISTING TREES AND OTHER NATURAL VEGETATION WITHIN THE PROJECT AND/OR ADJACENT TO THE PROJECT ARE OF PRIME CONCERN TO THE CONTRACTOR'S OPERATIONS AND SHALL BE A RESTRICTED AREA. CONTRACTOR SHALL PROTECT TREES TO REMAIN AT ALL TIMES. EQUIPMENT SHALL NOT NECESSARILY BE OPERATED UNDER NEARBY TREES AND EXTREME CAUTION SHALL BE EXERCISED WHEN WORKING ADJACENT TO TREES. SHOULD ANY PORTION OF THE TREE BRANCHES REQUIRE REMOVAL TO PERMIT OPERATION OF THE CONTRACTOR'S EQUIPMENT, CONTRACTOR SHALL OBTAIN THE SERVICES OF A PROFESSIONAL TREE TRIMMING SERVICE TO TRIM THE TREES PRIOR TO THE BEGINNING OF OPERATION. SHOULD CONTRACTOR'S OPERATIONS RESULT IN THE BREAKING OF ANY LIMBS, THE BROKEN LIMBS SHOULD BE REMOVED IMMEDIATELY AND CUTS SHALL BE PROPERLY PROTECTED TO MINIMIZE ANY LASTING DAMAGE TO THE TREE. NO TREES SHALL BE REMOVED WITHOUT AUTHORIZATION BY THE ENGINEER. COSTS FOR TRIMMING SERVICES SHALL BE CONSIDERED INCIDENTAL TO THE GRADING CONSTRUCTION AND NO SPECIAL PAYMENT WILL BE MADE.
- CONTRACTOR SHALL SUBMIT COPIES OF SHOP DRAWINGS FOR MANHOLE AND CATCH BASIN STRUCTURES TO ENGINEER. CONTRACTOR SHALL ALLOW 5 WORKING DAYS FOR SHOP DRAWING REVIEW.

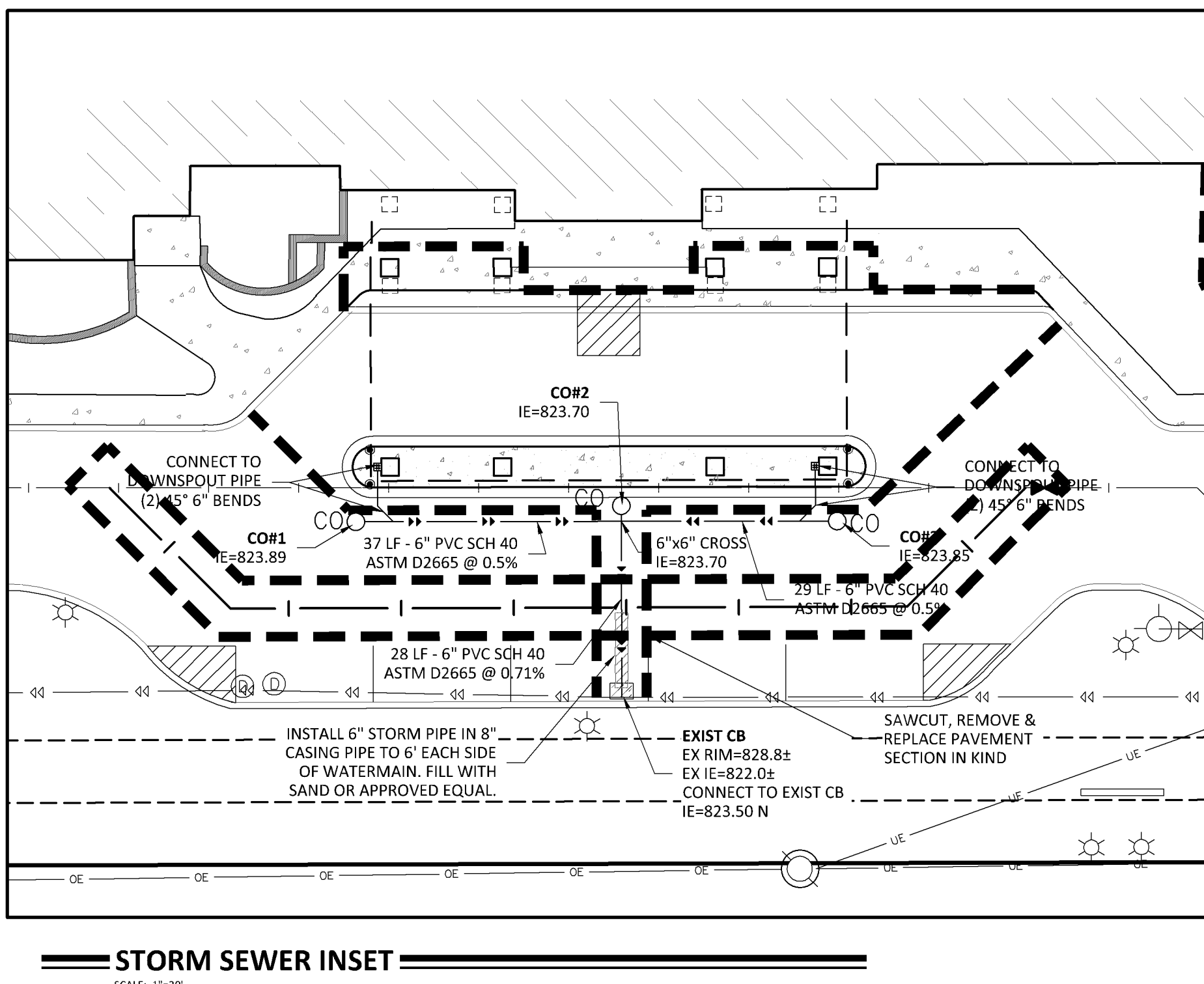

ENGINEERING DIVISION
Approved by: Jen Desrude, PE
11/07/2017 15:11 PM

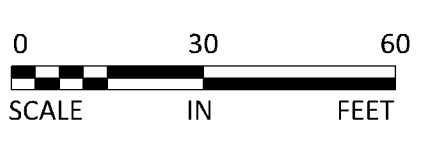
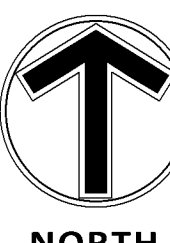

Sambatek
www.sambatek.com
12800 Whitewater Drive, Suite 300
Minnetonka, MN 55343
763.476.6010 telephone
763.476.8532 facsimile
Engineering | Surveying | Planning | Environmental

Client
**GREAT WOLF
RESORTS, INC.**

Project
**GREAT WOLF
RESORT
RENOVATION**

Location
**BLOOMINGTON,
MINNESOTA**
1700 AMERICAN BLVD E

Certification
I hereby certify that this plan, specification or report was prepared by me or under my direct supervision and that I am a duly licensed professional engineer under the laws of the state of Minnesota.

Michelle J. Caron
Registration No. 26254 Date: 03/31/2017
If applicable, contact us for a wet signed copy of this plan which is available upon request at Sambatek's, Minnetonka, MN office.

Summary
Designed: MIC Drawn: LJV
Approved: MIC Book / Page:
Phase: FINAL Initial Issued: 3/31/2017

No.	Date By	Submital / Revision
03/31/17	ISSUE FOR CONSTRUCTION	
04/26/17	CONSTRUCTION - REV 1	
08/16/17	CONSTRUCTION - REV 2	
08/21/17	CONSTRUCTION - REV 3	
09/19/17	CONSTRUCTION - REV 4	
10/03/17	CONSTRUCTION - REV 5	
10/04/17	CONSTRUCTION - REV 6	
10/06/17	CONSTRUCTION - REV 7	
10/11/17	CONSTRUCTION - REV 8	
10/12/17	CONSTRUCTION - REV 9	
10/12/17	CONSTRUCTION - REV 10	

Sheet Title
SITE PLAN

Sheet No. Revision
C3.01 10

Project No. 20707