

K:\TWC_LDEV\KRAUS_ANDERSON\SOUTHTOWN3 Design\CAD\Exhibits\2024-0709 Site Plan + MOB\2024-0709 Southtown - Site Plan.dwg July 09, 2024 - 4:05pm

This document, together with the concepts and designs presented herein, as an instrument of service, is intended only for the specific purpose and client for which it was prepared. Reuse of and improper reliance on this document without written authorization and adaptation by Kimley-Horn and Associates, Inc. shall be without liability to Kimley-Horn and Associates, Inc.

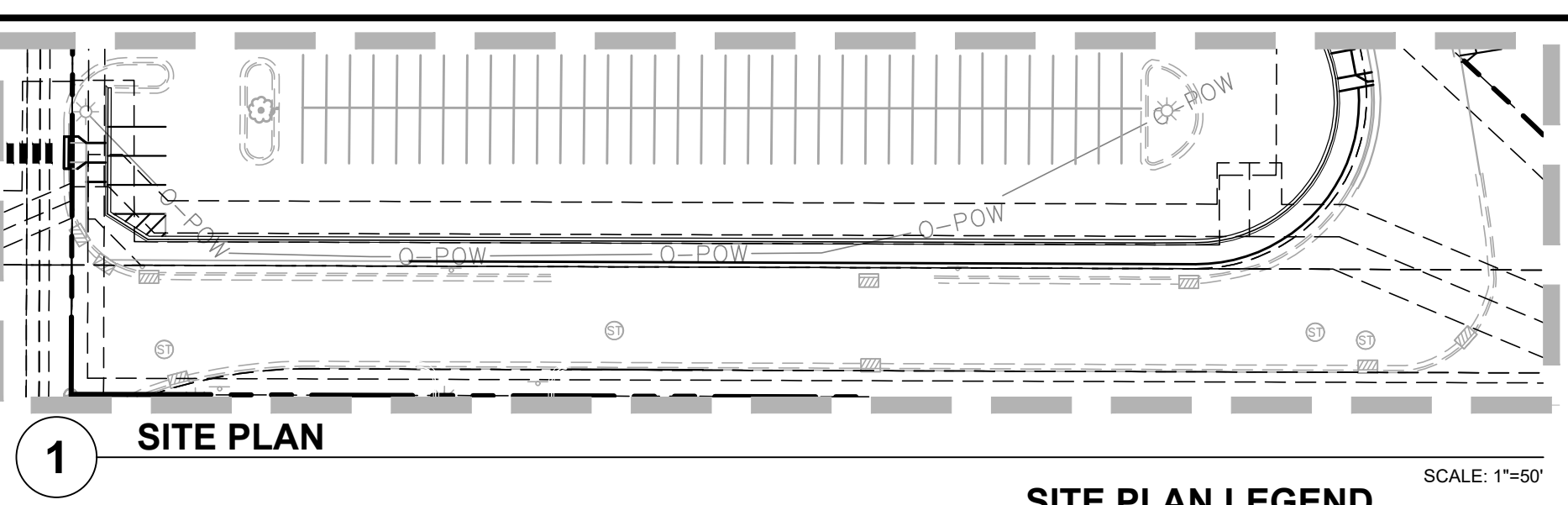
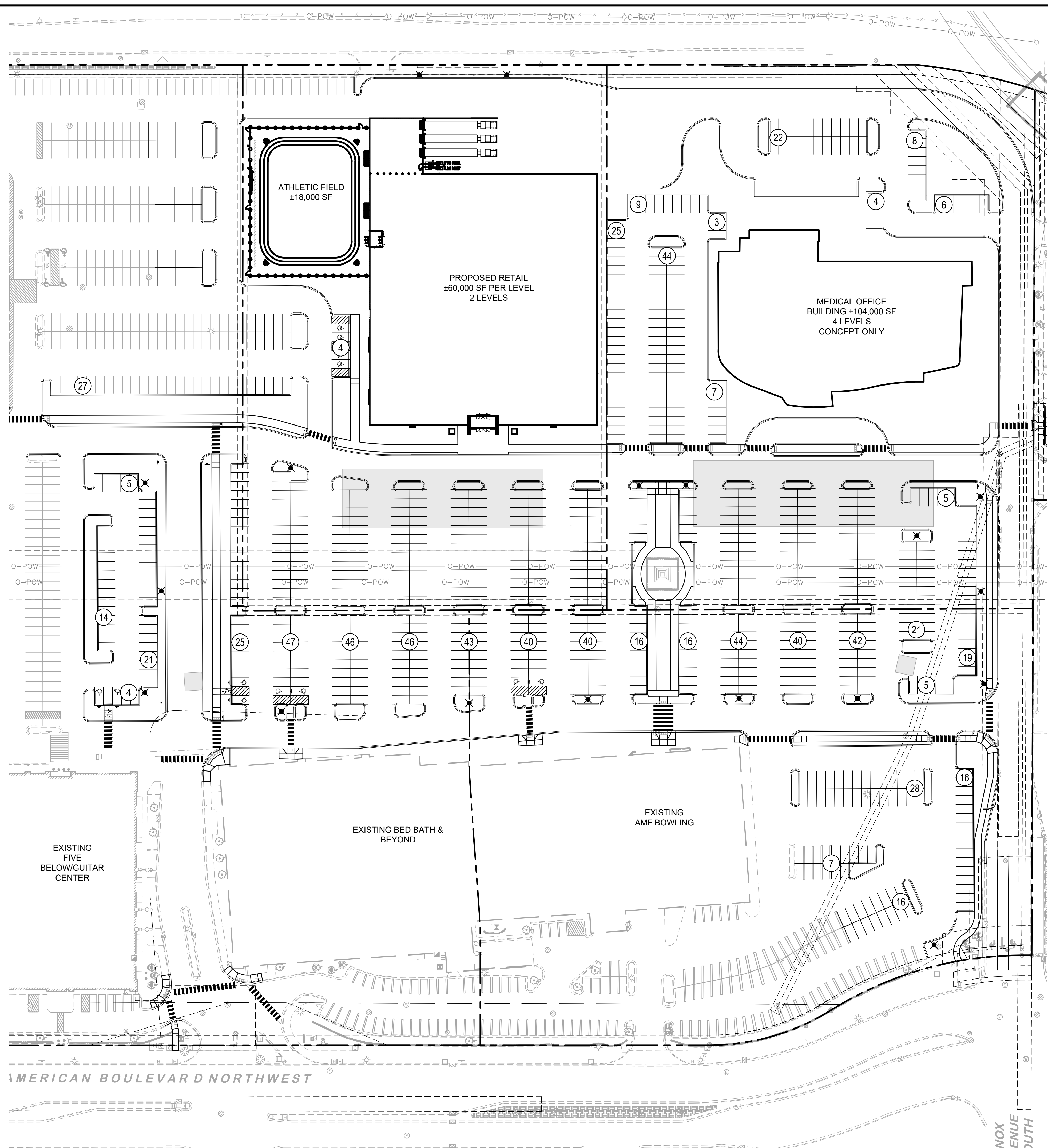

SITE PLAN LEGEND
 SCALE: 1"=50'
 - - - - - PROPERTY LINE
 - - - - - BUILDING SETBACK LINE
 ○ PARKING COUNT

PRELIMINARY - NOT FOR CONSTRUCTION

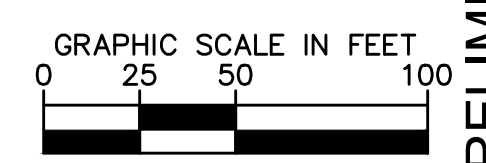
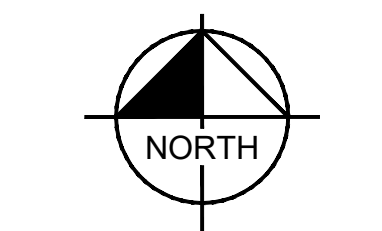

SOUTHTOWN REDEVELOPMENT

PREPARED FOR
KRAUS ANDERSON

BLOOMINGTON, MN

**PRELIMINARY
 DEVELOPMENT
 PLAN**

KHA PROJECT	18051008
DATE	07/09/2024
SCALE	AS SHOWN
DESIGNED BY	NAB
DRAWN BY	AMZ
CHECKED BY	ACL
DATE	XX/XX/XXXX
INC. NO.	60551

UNLESS OTHERWISE SPECIFIED, ALL DESIGN AND CONSTRUCTION SHALL BE IN ACCORDANCE WITH THE LATEST EDITIONS OF THE MINNESOTA ENGINEERING AND SURVEYING BOARD'S RULES AND REGULATIONS AND THE MINNESOTA PROFESSIONAL ENGINEERING AND SURVEYING ACT.

Kimley-Horn
 © 2023 KIMLEY-HORN AND ASSOCIATES, INC.
 787 EUSTIS STREET, SUITE 100, ST. PAUL, MN 55114
 PHONE: 651-685-4197
 WWW.KIMLEY-HORN.COM

NO.	REVISIONS	DATE	BY

SHEET NUMBER
EX-1