

PENN AVENUE SOUTH

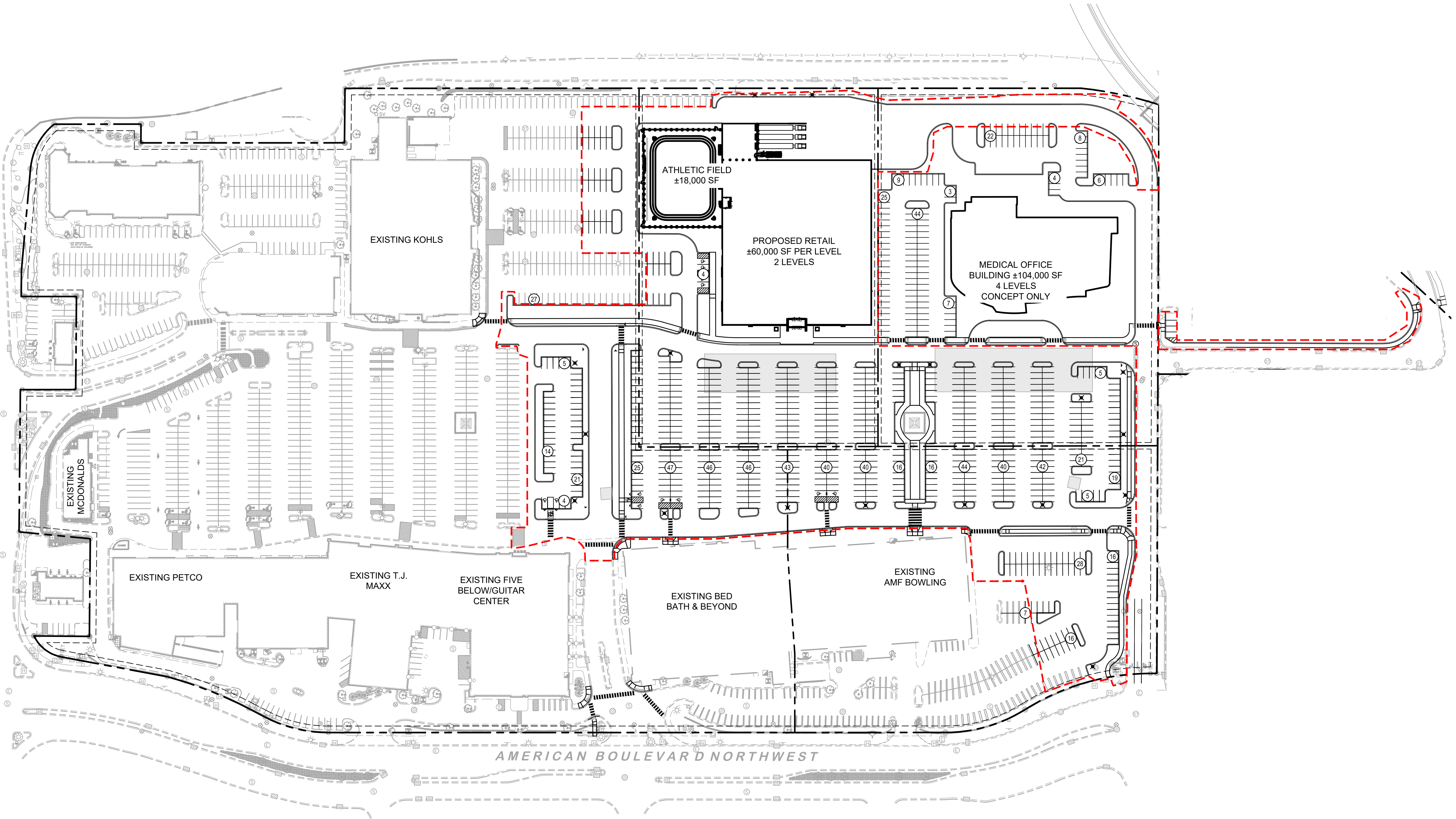

AMERICAN BOULEVARD NORTHWEST

**SITE PLAN LEGEND**

- PROPERTY LINE
- BUILDING SETBACK LINE
- ⑩ PARKING COUNT
- - - - - AREA OF IMPROVEMENTS - PROPOSED

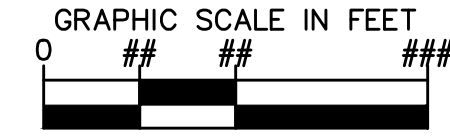
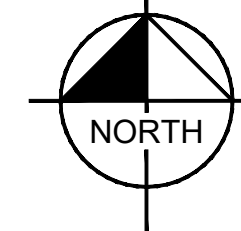

Know what's below.  
Call before you dig.

PRELIMINARY - NOT FOR CONSTRUCTION

SOUTHTOWN REDEVELOPMENT

PREPARED FOR  
**KRAUS ANDERSON**

BLOOMINGTON, MN

**PRELIMINARY  
DEVELOPMENT  
PLAN**

|             |                         |
|-------------|-------------------------|
| KHA PROJECT | 160521028               |
| DATE        | 07/09/2024              |
| SCALE       | AS SHOWN                |
| DESIGNED BY | NAB                     |
| DRAWN BY    | AMZ                     |
| CHECKED BY  | ACL                     |
| PROPERTY    | ARK C. LORENSGARD, P.E. |
| DATE        | XX/XX/XXXX              |
| INC. NO.    | 60551                   |

I HEREBY CERTIFY THAT THIS PLAN, SPECIFICATIONS AND PROPOSALS HAS BEEN PREPARED BY ME OR UNDER MY DIRECT SUPERVISION AND THAT I AM A DULY LICENSED PROFESSIONAL ENGINEER UNDER THE LAWS OF THE STATE OF MINNESOTA.

**Kimley-Horn**

© 2023 KIMLEY-HORN AND ASSOCIATES, INC.  
767 EULIST STREET, SUITE 100, ST. PAUL, MN 55114  
PHONE: 651-665-4197  
WWW.KIMLEY-HORN.COM

| NO. | REVISIONS | DATE | BY |
|-----|-----------|------|----|
|     |           |      |    |
|     |           |      |    |
|     |           |      |    |
|     |           |      |    |
|     |           |      |    |
|     |           |      |    |
|     |           |      |    |
|     |           |      |    |
|     |           |      |    |

SHEET NUMBER  
**EX-1**