

# MARAWANNA

## 8200 GRAND AVE SO.

### BLOOMINGTON, MN

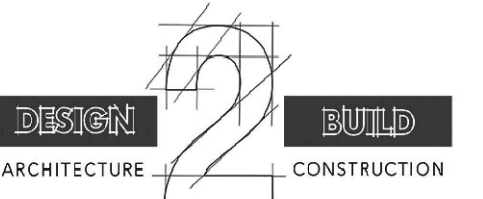

design2buildmn@live.com  
612-396-4556

4892 TWINS COURT  
EAGAN, MN. 55123

## CODE DATA

<b>APPLICABLE CODES</b> CITY OF BLOOMINGTON, MN  2018 INTERNATIONAL BUILDING CODE 2020 MINNESOTA STATE BUILDING CODE 2018 INTERNATIONAL FIRE CODE WITH ADMENDMENTS 2020 MINNESOTA PLUMBING CODE 2020 MN MECHANICAL AND FUEL GAS CODE 2023 NATIONAL ELECTRICAL CODE
---

CHAPTER 3- OCCUPANCY CLASSIFICATION (SEC. 302)			
GROUP	SECTION	DESCRIPTION OF OCCUPANCY	S.F.
B	304.1	OFFICE AREAS	950
S1	311.2	PRODUCTION AND STORAGE:	3200
TOTAL PROPOSED			4150
MIXED OCC. SEPARATION (TABLE 508.4)	OCCUPANCY TYPES	REQUIRED SEPARATION (HOURS)	
	B, S1	0 HR	

CHAPTER 5- GENERAL BUILDING LIMITATIONS			
SECTION	ALLOWABLE AREA INCREASE (SF)		
TABLE 506.2	506.3		
USE GROUP	CONSTR. TYPE	BASIC AREA	FRONTAGE INCREASE
M	2B	50,000	
TOTAL ALLOWABLE AREA			TOTAL 50,000

TOTAL HEIGHT (SEC. 504)					
USE GROUP	CONSTRUCTION TYPE	NUMBER OF STORIES	MAX. BUILDING HEIGHT	PROP. NUMBER OF STORIES	PROP. BUILDING HEIGHT
M	2B	3	75'	1	18'

CHAPTER 6- CONSTRUCTION TYPES/REQUIREMENTS			
SECTION	TYPE	REQUIREMENTS (TABLE 601)	REQUIREMENT w/ EXCEPTION
TABLE 601	2B	BEARING WALLS- EXTERIOR	0 HR
		BEARING WALLS- INTERIOR	0 HR
		NON- BEARING WALL- EXTERIOR	0 HR
		NON- BEARING WALL- INTERIOR	0 HR
		STRUCTURAL FRAME	0 HR
		PARTITIONS	0 HR
		FLOORS & FLOOR/CEILINGS	0 HR
		ROOFS & ROOF/CEILING	0 HR
EXTERIOR DOORS & WINDOWS	0 HR		

CHAPTER 9- FIRE PROTECTION SYSTEMS		
SECTION	TYPE	DESCRIPTION OF REQUIREMENTS
903.2.7	2B	BUILDING IS FULLY SPRINKLERED

CHAPTER 10- MEANS OF EGRESS/OCCUPANT LOAD			
USE	OCCUPANT LOAD FACTOR	AREA	OCCUPANT LOAD
M	60	950 ÷ 60 = 15.8	16
S1	300	3200 ÷ 300 = 10.6	11

EXIT WIDTH REQUIREMENTS (SECTION 1005)				
USE	WITH SPRINKLER SYSTEM		TOTAL REQ'D WIDTH	TOTAL WIDTH PROVIDED
	STAIR WIDTH/ OCCUP.	OTHER EGRESS COMP./OCCUP.		
M		16 X 0.3 = 4.8	5"	72"
S1		11 X 0.3 = 3.3	4"	72"
TRAVEL DISTANCE (SEC. 1017.2) SPRINKLERED = 250' MAX ALLOWABLE)				

CHAPTER 29- PLUMBING SYSTEMS												
SECTION	OCCUPANT GROUP	AREA (S.F.)	FACTOR	TABLE 2902.1				WATER CLO.		LAVS.		DRINKING FOUNTAIN
				OCCUPANT LOAD	TOT.	MALE	FEM.	MALE	FEM.	MALE	FEM.	
	M	950	60	16	8	8	0.32	0.32	0.32	0.32		
	S1	3200	300	11	5.5	5.5	0.06	0.06	0.06	0.06		
TOTAL REQUIRED							0.38	0.38	0.38	0.38		
TOTAL PROVIDED							1	1	1	1		

**PROJECT SUMMARY**  
 THIS PROJECT IS AN EXISTING ONE-STORY BUILDING USED FOR OFFICE AND PRODUCTION. IT WILL REMAIN AS OFFICE AND PRODUCTION SPACE.  
 COMMON TOILETS WILL BE PROVIDED FOR PUBLIC USE WITH SECURE ACCESS.

## SHEET INDEX

ARCHITECTURAL	
A1	CODE DATA / SHEET INDEX
A2	DEMO PLAN
A3	PROPOSED PLAN
A4	FIXTURE PLAN

## LOCATION PLAN



PROJECT AREA IS SHADED

## KEY PLAN

Copyright:

These plans are not to be used in full or partial without written consent of Design2Build

MARK: DATE: ISSUE FOR:

I hereby certify that this plan, specification, or report was prepared by me or someone under my direct supervision and that I am a licensed Professional Architect under the laws of the State of Minnesota.

SIGNED: LIC. : #24982

IN CHARGE: SJR

DRAWN BY: BNF

CHECKED BY: SJR

JOB #:

DATE: 10/29/2025

PROJECT TITLE

MARAWANNA

8200 GRAND AVE.  
BLOOMINGTON, MN

SHEET TITLE

CODE DATA

SHEET #

A1