

NOTES:

- 1. SHADED WALLS ARE EXISTING TO REMAIN.
- 2. DASHED LINES ARE EXISTING TO BE REMOVED.
- CONTRACTOR TO VERIFY THESE ARE NON-LOAD BEARING WALLS.

WALL LINE REFERENCE

- REPRESENTS WALL TO BE REMOVED
- REPRESENTS EXISTING WALL
- == REPRESENTS NEW WALL
- - - - REPRESENTS DOOR TO BE REMOVED

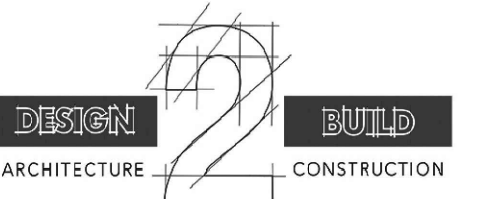

design2buildmn@live.com
612-396-4556

4892 TWINS COURT
EAGAN, MN. 55123

Copyright:

These plans are not to be used in full or partial without written consent of Design2Build

MARK: DATE: ISSUE FOR:

I hereby certify that this plan, specification, or report was prepared by me or someone under my direct supervision and that I am a licensed Professional Architect under the laws of the State of Minnesota.

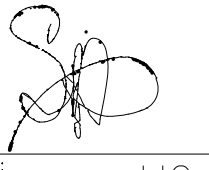
SIGNED:  LIC. : #24982

IN CHARGE: SJR
DRAWN BY: BNF
CHECKED BY: SJR
JOB #:
DATE: 10/29/2025

PROJECT TITLE
MARAWANA

8200 GRAND AVE.
BLOOMINGTON, MN

SHEET TITLE

FIXTURE PLAN - -
PROPOSED

SHEET #
A4

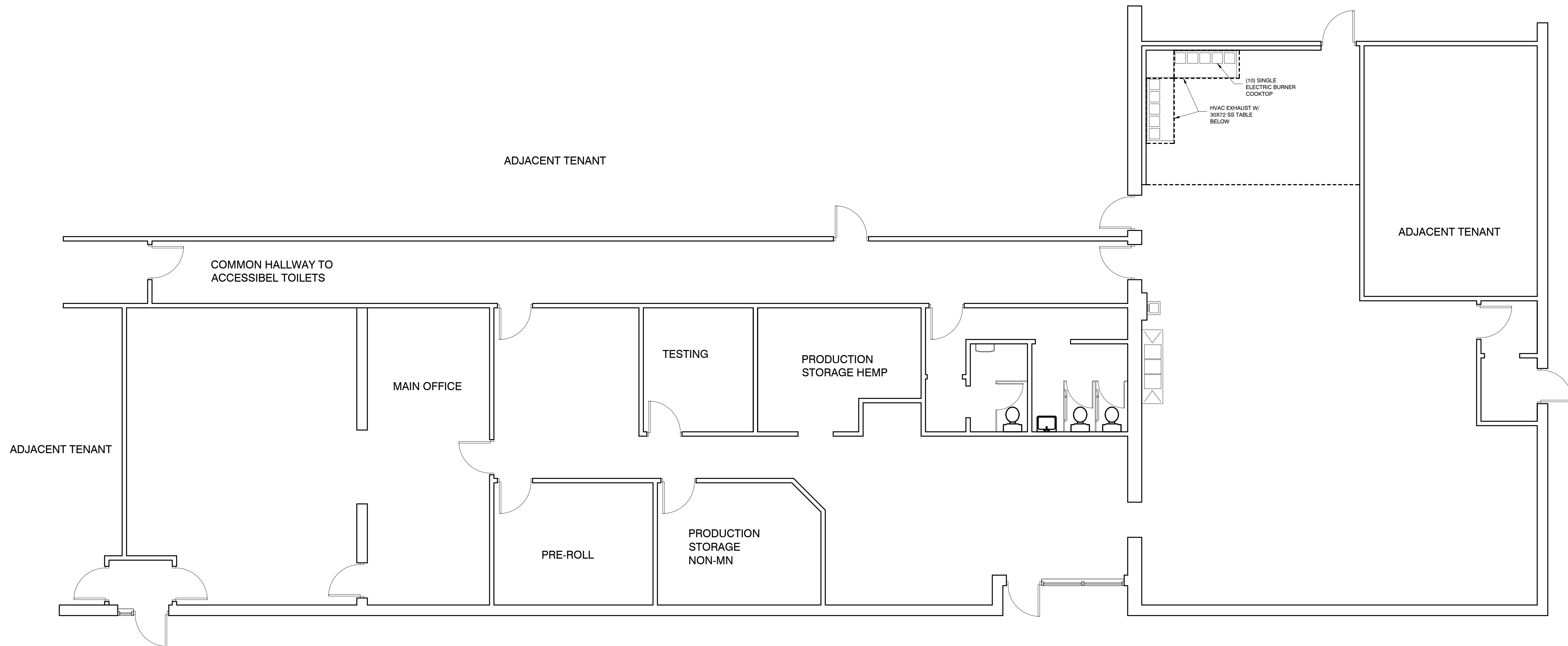

1 FIXTURE PLAN

SCALE: 3/16" = 1'-0"

