

FIRST LEVEL - FLOOR PLAN

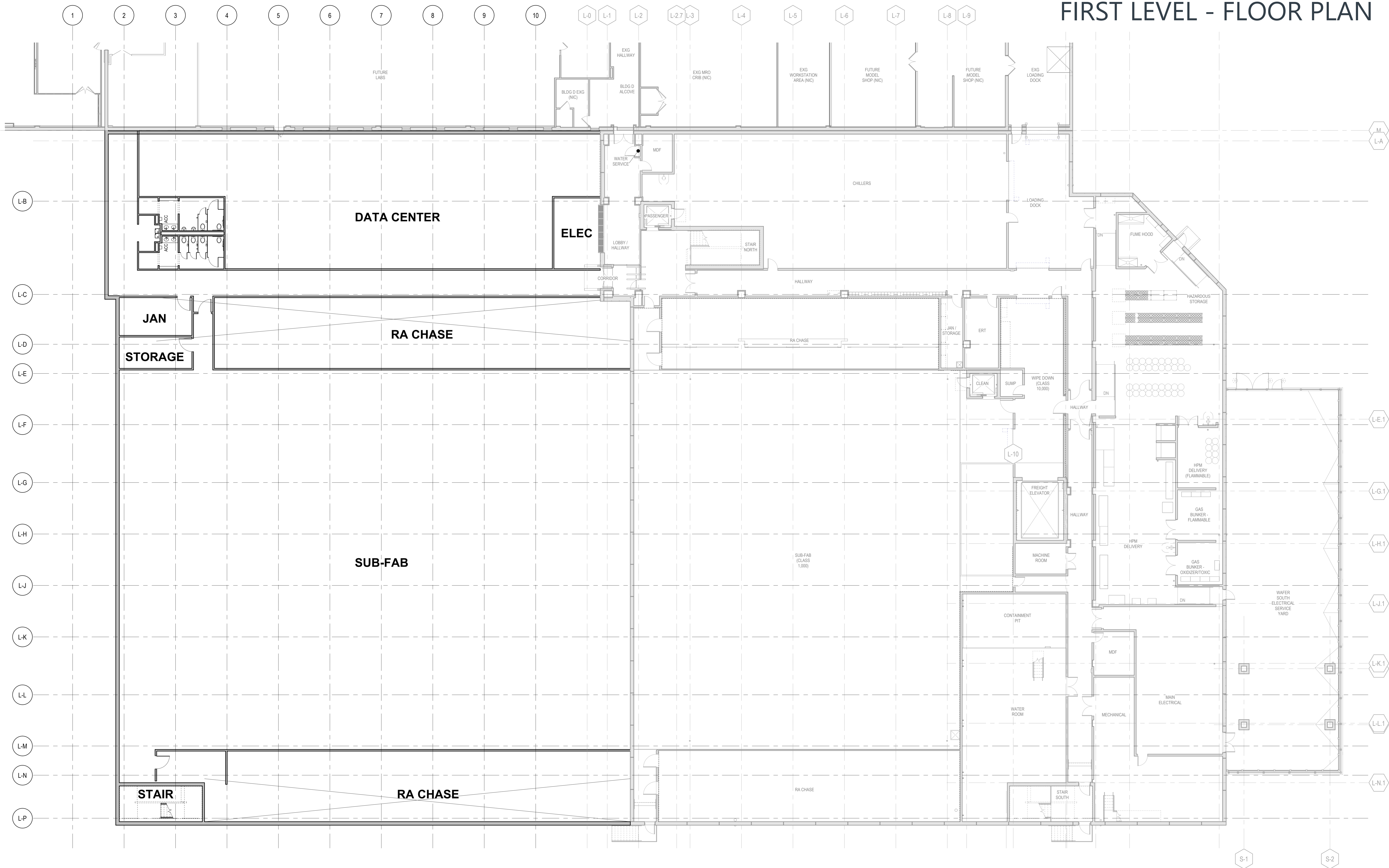

FLOOR PLAN - FIRST LEVEL
3/32" = 1'-0"

Must meet 2020 MN State Building Code	Provide a detailed code analysis with the plans.
Must meet 2020 MN Accessibility Code.	When plans are 80% complete please contact Building & Inspections to set up a Building Code review.
Building plans must be signed by a MN licensed architect.	A report shall be submitted identifying the maximum expected quantities of Hazardous Materials. The report shall be prepared by a qualified person, firm, or corporation.
SAC review by MET Council will be required. On January 2nd, 2025, the City of Bloomington implemented a City SAC charge. The cost will be \$2,020 per City SAC unit. The amount of SAC charged will mirror the MET Council Determination. This applies to any permits submitted on or after 01/02/25.	

SECOND LEVEL - FLOOR PLAN

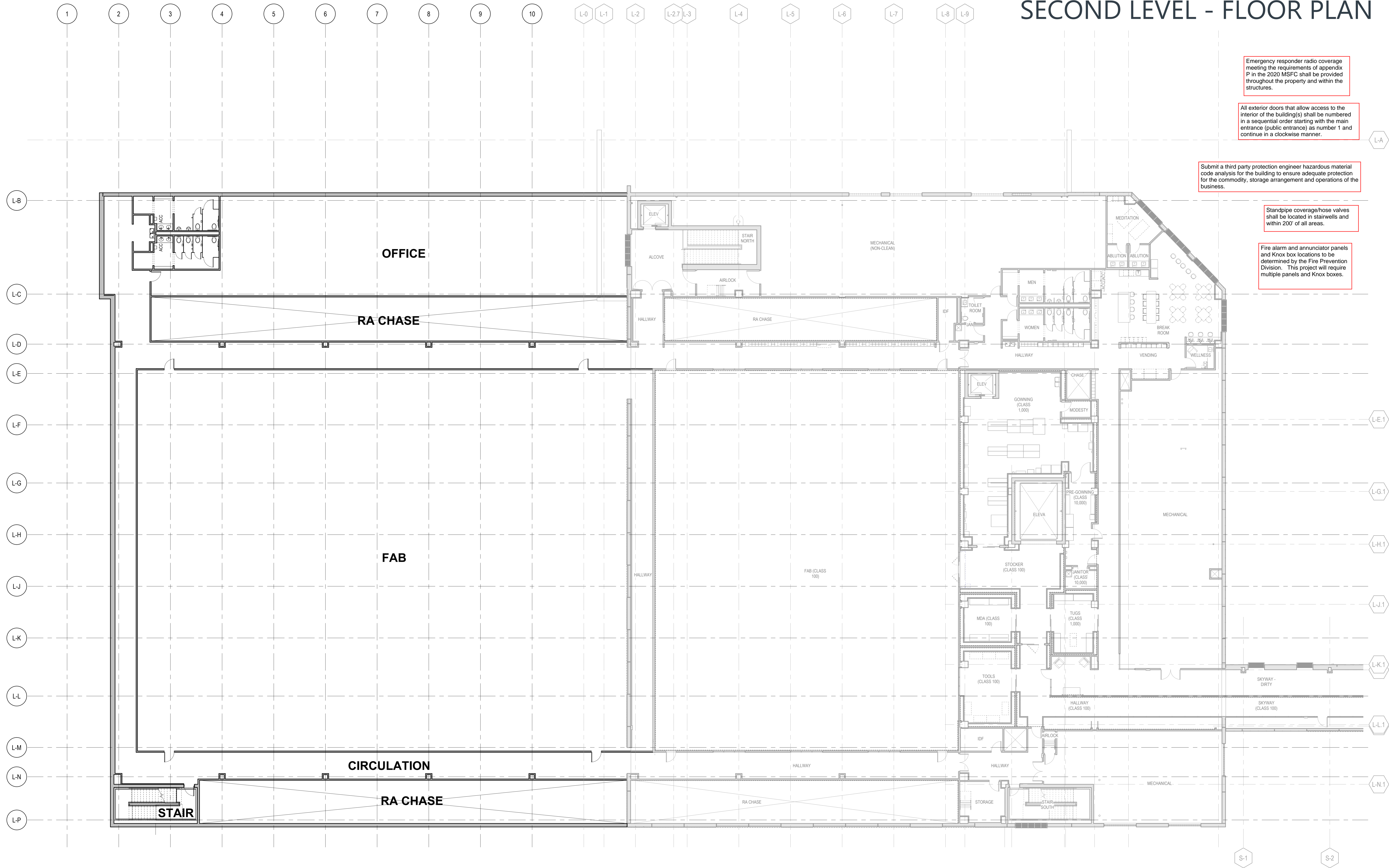

Emergency responder radio coverage meeting the requirements of appendix P in the 2020 MSFC shall be provided throughout the property and within the structures.

All exterior doors that allow access to the interior of the building(s) shall be numbered in a sequential order starting with the main entrance (public entrance) as number 1 and continue in a clockwise manner.

Submit a third party protection engineer hazardous material code analysis for the building to ensure adequate protection for the commodity, storage arrangement and operations of the business.

Standpipe coverage/hose valves shall be located in stairwells and within 200' of all areas.

Fire alarm and annunciator panels and Knox box locations to be determined by the Fire Prevention Division. This project will require multiple panels and Knox boxes.