

Heat detectors may be required in storage space(s) above the dance studio. Provide at least 1 fire extinguisher in the dance studio.

Minimum 1 exit door from the space. Overhead garage door does not qualify.

Remove or provide appropriate storage cabinets for products considered hazardous materials.

ANNOTATED SITE PLAN – CUP APPLICATION

8924 Mount Curve Road, Bloomington, MN 55438

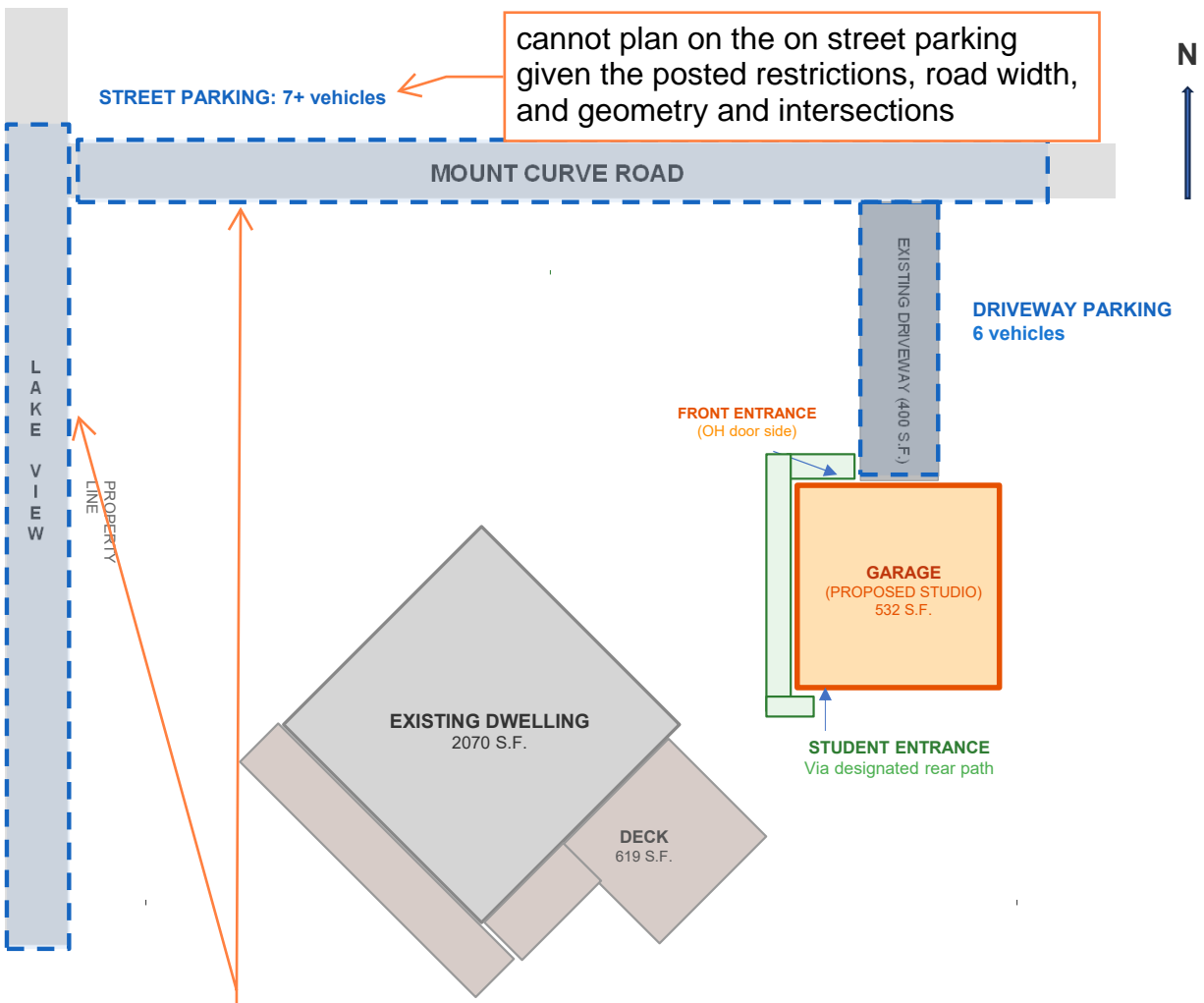

cannot plan on the on street parking given the posted restrictions, road width, and geometry and intersections

TOTAL PARKING: 13 spaces

LOT COVERAGE DATA

Lot Area:	11,831 S.F.
Existing Dwelling:	983 S.F.
Existing Garage:	532 S.F.
Structural Coverage:	1,515 S.F. (12.8%)
Driveway (Impervious):	400 S.F.
Deck:	619 S.F.
Total Impervious:	1,915 S.F. (16.2%)

No change to lot coverage proposed.
Garage interior renovation only.

LEGEND

	Proposed Studio (Existing Garage)
	Existing Dwelling
	Driveway
	Deck
	Parking Areas (13 total spaces)
	Student Entrance / Path

NOTE: This site plan is for CUP application reference. Not to scale. See Windmill Design Studio as-built plans (Sheet T1.0) for precise survey data.

These roads are all posted as No Parking due to the narrow street width (estimated to be 20' - 25' wide)





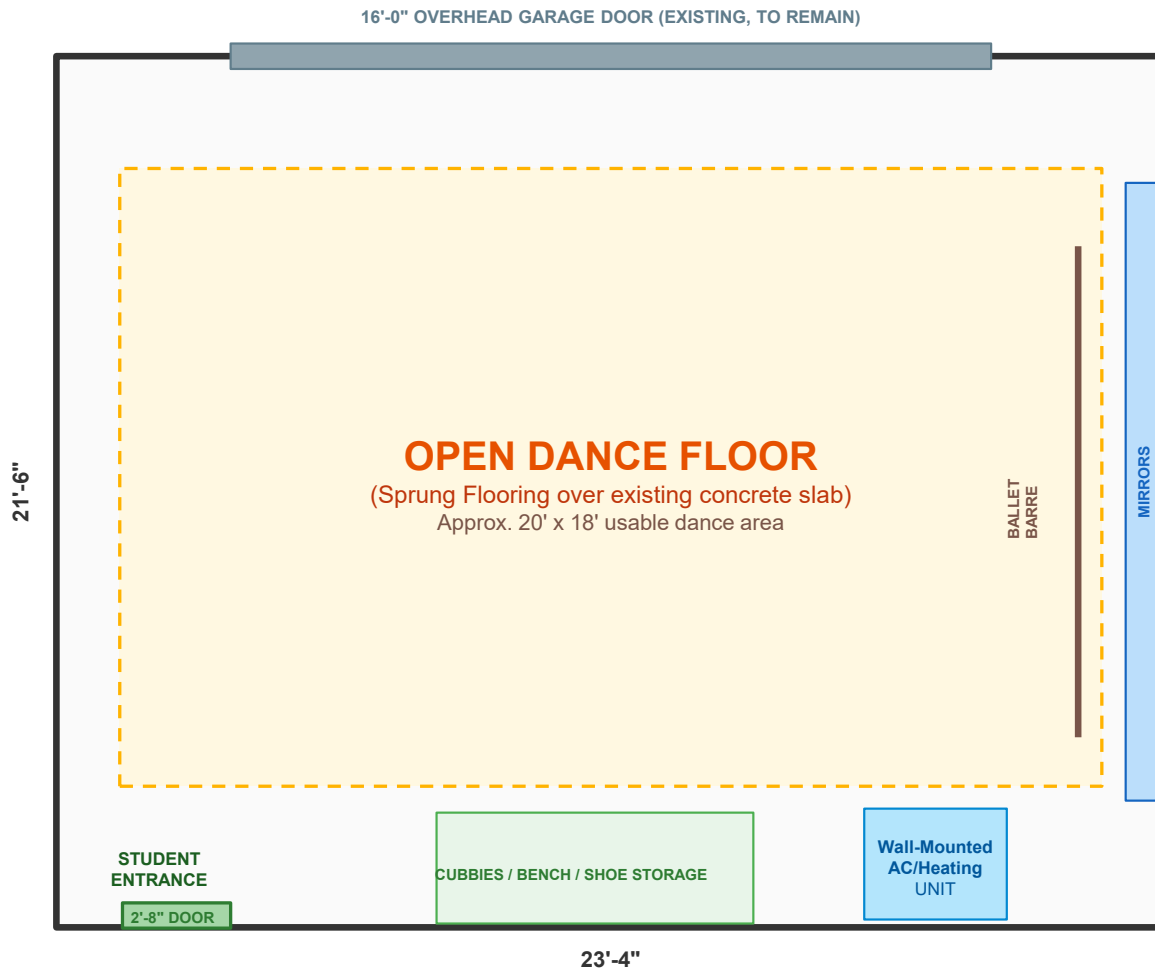

PROPOSED GARAGE STUDIO FLOOR PLAN

Existing Detached Garage: 23'-4" x 21'-6" (532 S.F.)

Ceiling Height: 8'-3" to bottom of truss



LEGEND

-  Sprung Dance Floor
-  Wall-Mounted Mirrors
-  Ballet Barre
-  HVAC System
-  Student Cubbies / Bench
-  Entrance Door
-  Overhead Garage Door (existing)

PLANNED RENOVATIONS

Contingent upon CUP approval:

- Insulation & drywall (all walls)
- Wall-mounted heating & cooling system
- Sprung dance flooring over slab
- Wall-mounted mirrors & ballet barre
- Lighting for instruction

Exterior appearance unchanged.

Separate building permits will be obtained.

- NOTES: 1. All renovations contingent upon CUP approval. Separate building permits to be obtained.
 2. Exterior appearance of garage will not change. Overhead door to remain.
 3. No bathroom in garage. Students may access bathroom in main residence.
 4. See Windmill Design Studio as-built plans (Sheet AB1.3) for existing conditions and precise dimensions.

Permits are required if any remodeling work is being done - including alterations/upgrades to electrical, plumbing, or mechanical systems.

Call Building & Inspections if questions - 952-563-8930.