



SEAGATE

SEAGATE  
TECHNOLOGY  
NORMANDEALE  
WAFER SOUTH  
PHASE B

B | W | B | R

380 St. Peter Street, Ste. 600  
Saint Paul, MN 55102  
651.222.3701  
bwbr.com

Consultants



DUNHAM

50 South Sixth Street / Suite 1100  
Minneapolis, Minnesota 55402-1540

PHONE 612.465.7550  
FAX 612.465.7551  
WEB dunhameng.com

mechanical + electrical  
consulting engineering  
Dunham Project Manager: Kichols

This document may be an electronic file or may be printed from an electronic file provided to the user. It is the sole responsibility of the user to ensure that the content and quality is consistent with the content and quality of the original documents on file at BWBR.

I hereby certify that this plan, specification or report was prepared by me or under my direct supervision and that I am a duly Licensed Professional Engineer under the laws of the State of Minnesota.

Name \_\_\_\_\_

Date 04/20/2026 Reg. No. \_\_\_\_\_

Issued For \_\_\_\_\_

Item \_\_\_\_\_ Date \_\_\_\_\_

\_\_\_\_\_

\_\_\_\_\_

\_\_\_\_\_

\_\_\_\_\_

\_\_\_\_\_

\_\_\_\_\_

\_\_\_\_\_

\_\_\_\_\_

\_\_\_\_\_

\_\_\_\_\_

\_\_\_\_\_

\_\_\_\_\_

\_\_\_\_\_

\_\_\_\_\_

\_\_\_\_\_

\_\_\_\_\_

\_\_\_\_\_

\_\_\_\_\_

\_\_\_\_\_

\_\_\_\_\_

\_\_\_\_\_

\_\_\_\_\_

\_\_\_\_\_

\_\_\_\_\_

\_\_\_\_\_

\_\_\_\_\_

\_\_\_\_\_

\_\_\_\_\_

\_\_\_\_\_

\_\_\_\_\_

\_\_\_\_\_

\_\_\_\_\_

\_\_\_\_\_

\_\_\_\_\_

\_\_\_\_\_

\_\_\_\_\_

\_\_\_\_\_

\_\_\_\_\_

\_\_\_\_\_

\_\_\_\_\_

\_\_\_\_\_

\_\_\_\_\_

\_\_\_\_\_

\_\_\_\_\_

\_\_\_\_\_

\_\_\_\_\_

\_\_\_\_\_

\_\_\_\_\_

\_\_\_\_\_

\_\_\_\_\_

\_\_\_\_\_

\_\_\_\_\_

\_\_\_\_\_

\_\_\_\_\_

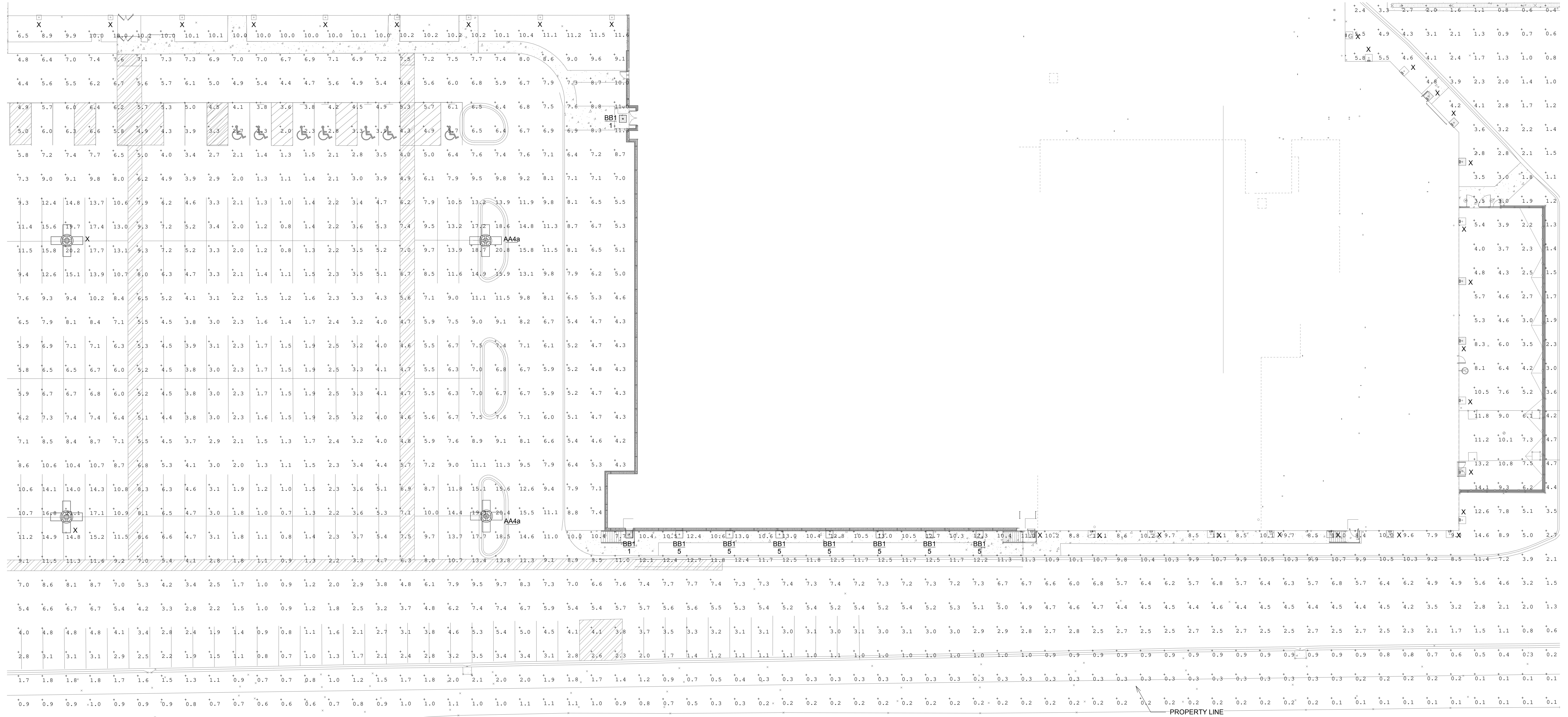

1 ELECTRICAL SITE PLAN - PHOTOMETRICS (INITIAL)  
3/64" = 1'-0"

**GENERAL NOTES:**  
A. FIXTURES UTILIZED IN THIS CALCULATION HAVE A 0.9 LIGHT LOSS FACTOR.

NOT FOR  
CONSTRUCTION

This Sheet may be a Reduced Copy  
The bar above is 1" long on a Full Size Sheet.  
Drawing Scales apply to Full Size Sheets.

Keyplan



Comm. No. 32021141.00 Drawn JW

Sheet Title  
**ELECTRICAL SITE PLAN -  
INITIAL LIGHTING  
CALCS**

Sheet No.

**900.L1**