

These documents in this form, electronic media, are being provided as your request. The information contained is preliminary in nature and may only be utilized for the stated project. All documents information contained herein including, but not limited to, symbols, blocks, details, etc. may not be reproduced, sold, distributed or utilized in any form on other projects without the express written permission of JTS Architects. Due to the unsecured nature of these documents (electronic media) and the inability of the originator to establish controls over the use thereof, JTS Architects assumes no responsibility for any consequences arising out of the use of the data. It is the sole responsibility of the user to check the validity of all information contained herein. The user shall at all times refer to the signed and sealed construction drawings for the project during all phases of the project. The user shall assume all risks and liabilities resulting from the use of this data. By accepting and/or extracting the information from the attached file, the recipient acknowledges and agrees to the above terms regarding the use of the information contained within the attached file.

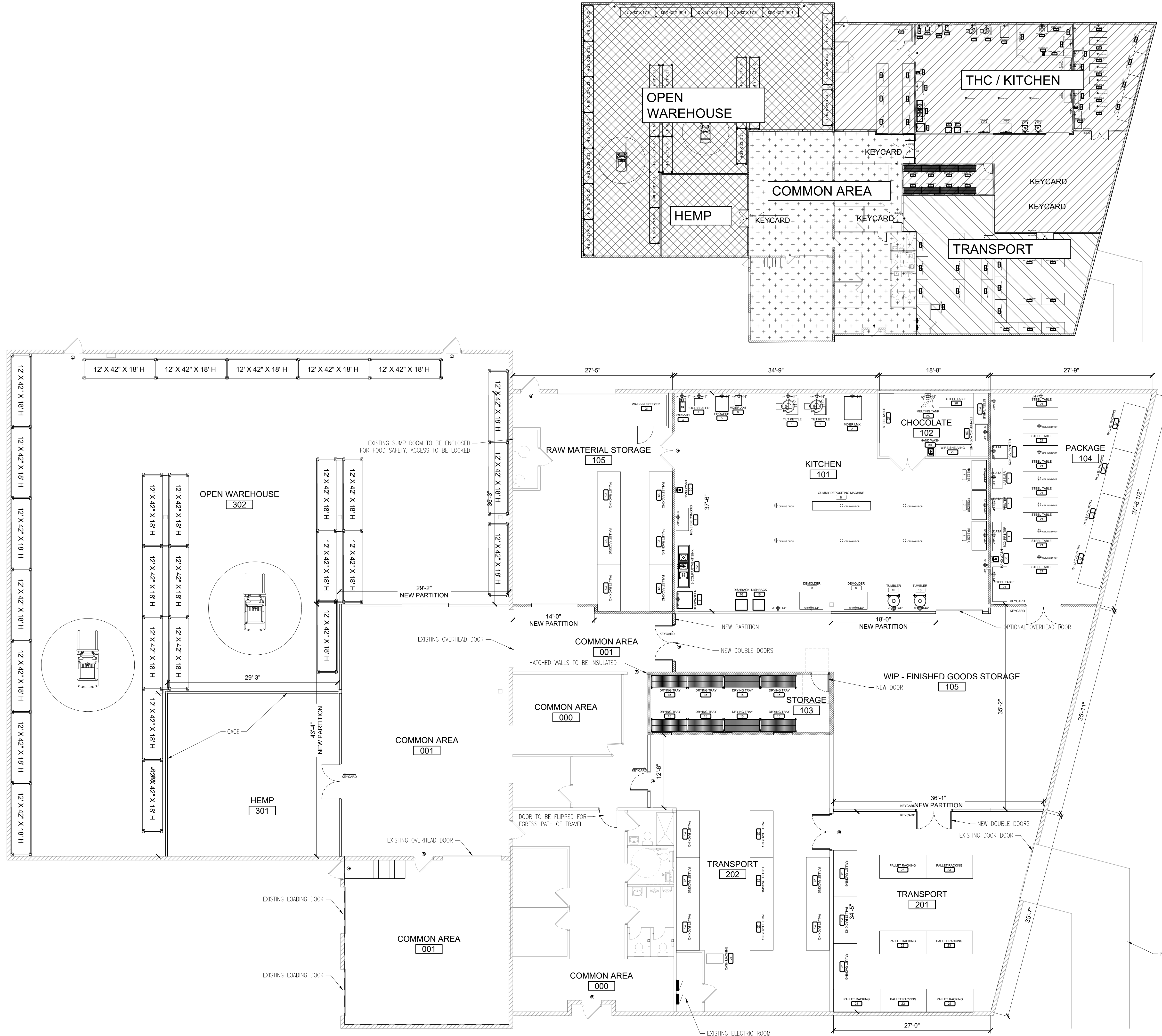

EQUIPMENT SCHEDULE				
MARK	DESCRIPTION	MANUFACTURER	MODEL	COMMENTS
KITCHEN				
1	TELE KETTLE	SMITHS	1000	STAINLESS STEEL
2	MAKER	SMITHS	1000	STAINLESS STEEL
3	ROUNDE COOKER	SMITHS	1000	250V PROVIDE INSULATED
4	FOOD BEATER	SMITHS	1000	250V PROVIDE INSULATED
5	MAKER	SMITHS	1000	250V PROVIDE INSULATED
6	MAKER	SMITHS	1000	250V PROVIDE INSULATED
7	MAKER	SMITHS	1000	250V PROVIDE INSULATED
8	MAKER	SMITHS	1000	250V PROVIDE INSULATED
9	MAKER	SMITHS	1000	250V PROVIDE INSULATED
10	MAKER	SMITHS	1000	250V PROVIDE INSULATED
11	MAKER	SMITHS	1000	250V PROVIDE INSULATED
12	MAKER	SMITHS	1000	250V PROVIDE INSULATED
13	MAKER	SMITHS	1000	250V PROVIDE INSULATED
14	MAKER	SMITHS	1000	250V PROVIDE INSULATED
15	MAKER	SMITHS	1000	250V PROVIDE INSULATED
16	MAKER	SMITHS	1000	250V PROVIDE INSULATED
17	MAKER	SMITHS	1000	250V PROVIDE INSULATED
18	MAKER	SMITHS	1000	250V PROVIDE INSULATED
19	MAKER	SMITHS	1000	250V PROVIDE INSULATED
20	MAKER	SMITHS	1000	250V PROVIDE INSULATED
21	MAKER	SMITHS	1000	250V PROVIDE INSULATED
22	MAKER	SMITHS	1000	250V PROVIDE INSULATED
23	MAKER	SMITHS	1000	250V PROVIDE INSULATED
24	MAKER	SMITHS	1000	250V PROVIDE INSULATED
25	MAKER	SMITHS	1000	250V PROVIDE INSULATED
26	MAKER	SMITHS	1000	250V PROVIDE INSULATED
27	MAKER	SMITHS	1000	250V PROVIDE INSULATED
28	MAKER	SMITHS	1000	250V PROVIDE INSULATED
29	MAKER	SMITHS	1000	250V PROVIDE INSULATED
30	MAKER	SMITHS	1000	250V PROVIDE INSULATED
31	MAKER	SMITHS	1000	250V PROVIDE INSULATED
32	MAKER	SMITHS	1000	250V PROVIDE INSULATED
33	MAKER	SMITHS	1000	250V PROVIDE INSULATED
34	MAKER	SMITHS	1000	250V PROVIDE INSULATED
35	MAKER	SMITHS	1000	250V PROVIDE INSULATED
36	MAKER	SMITHS	1000	250V PROVIDE INSULATED
37	MAKER	SMITHS	1000	250V PROVIDE INSULATED
38	MAKER	SMITHS	1000	250V PROVIDE INSULATED
39	MAKER	SMITHS	1000	250V PROVIDE INSULATED
40	MAKER	SMITHS	1000	250V PROVIDE INSULATED
41	MAKER	SMITHS	1000	250V PROVIDE INSULATED
42	MAKER	SMITHS	1000	250V PROVIDE INSULATED
43	MAKER	SMITHS	1000	250V PROVIDE INSULATED
44	MAKER	SMITHS	1000	250V PROVIDE INSULATED
45	MAKER	SMITHS	1000	250V PROVIDE INSULATED
46	MAKER	SMITHS	1000	250V PROVIDE INSULATED
47	MAKER	SMITHS	1000	250V PROVIDE INSULATED
48	MAKER	SMITHS	1000	250V PROVIDE INSULATED
49	MAKER	SMITHS	1000	250V PROVIDE INSULATED
50	MAKER	SMITHS	1000	250V PROVIDE INSULATED
51	MAKER	SMITHS	1000	250V PROVIDE INSULATED
52	MAKER	SMITHS	1000	250V PROVIDE INSULATED
53	MAKER	SMITHS	1000	250V PROVIDE INSULATED
54	MAKER	SMITHS	1000	250V PROVIDE INSULATED
55	MAKER	SMITHS	1000	250V PROVIDE INSULATED
56	MAKER	SMITHS	1000	250V PROVIDE INSULATED
57	MAKER	SMITHS	1000	250V PROVIDE INSULATED
58	MAKER	SMITHS	1000	250V PROVIDE INSULATED
59	MAKER	SMITHS	1000	250V PROVIDE INSULATED
60	MAKER	SMITHS	1000	250V PROVIDE INSULATED
61	MAKER	SMITHS	1000	250V PROVIDE INSULATED
62	MAKER	SMITHS	1000	250V PROVIDE INSULATED
63	MAKER	SMITHS	1000	250V PROVIDE INSULATED
64	MAKER	SMITHS	1000	250V PROVIDE INSULATED
65	MAKER	SMITHS	1000	250V PROVIDE INSULATED
66	MAKER	SMITHS	1000	250V PROVIDE INSULATED
67	MAKER	SMITHS	1000	250V PROVIDE INSULATED
68	MAKER	SMITHS	1000	250V PROVIDE INSULATED
69	MAKER	SMITHS	1000	250V PROVIDE INSULATED
70	MAKER	SMITHS	1000	250V PROVIDE INSULATED
71	MAKER	SMITHS	1000	250V PROVIDE INSULATED
72	MAKER	SMITHS	1000	250V PROVIDE INSULATED
73	MAKER	SMITHS	1000	250V PROVIDE INSULATED
74	MAKER	SMITHS	1000	250V PROVIDE INSULATED
75	MAKER	SMITHS	1000	250V PROVIDE INSULATED
76	MAKER	SMITHS	1000	250V PROVIDE INSULATED
77	MAKER	SMITHS	1000	250V PROVIDE INSULATED
78	MAKER	SMITHS	1000	250V PROVIDE INSULATED
79	MAKER	SMITHS	1000	250V PROVIDE INSULATED
80	MAKER	SMITHS	1000	250V PROVIDE INSULATED
81	MAKER	SMITHS	1000	250V PROVIDE INSULATED
82	MAKER	SMITHS	1000	250V PROVIDE INSULATED
83	MAKER	SMITHS	1000	250V PROVIDE INSULATED
84	MAKER	SMITHS	1000	250V PROVIDE INSULATED
85	MAKER	SMITHS	1000	250V PROVIDE INSULATED
86	MAKER	SMITHS	1000	250V PROVIDE INSULATED
87	MAKER	SMITHS	1000	250V PROVIDE INSULATED
88	MAKER	SMITHS	1000	250V PROVIDE INSULATED
89	MAKER	SMITHS	1000	250V PROVIDE INSULATED
90	MAKER	SMITHS	1000	250V PROVIDE INSULATED
91	MAKER	SMITHS	1000	250V PROVIDE INSULATED
92	MAKER	SMITHS	1000	250V PROVIDE INSULATED
93	MAKER	SMITHS	1000	250V PROVIDE INSULATED
94	MAKER	SMITHS	1000	250V PROVIDE INSULATED
95	MAKER	SMITHS	1000	250V PROVIDE INSULATED
96	MAKER	SMITHS	1000	250V PROVIDE INSULATED
97	MAKER	SMITHS	1000	250V PROVIDE INSULATED
98	MAKER	SMITHS	1000	250V PROVIDE INSULATED
99	MAKER	SMITHS	1000	250V PROVIDE INSULATED
100	MAKER	SMITHS	1000	250V PROVIDE INSULATED

- NOTES:
- CROSS-HATCHED WALLS TO BE INSULATED
 - KITCHEN, CHOCOLATE, AND STORAGE 103 TO HAVE FRP MIN 8FT AFF
 - ALL OUTLETS IN KITCHEN AND PACKAGE ROOMS TO BE QUAD OUTLETS
 - KITCHEN, RAW MATERIAL STORAGE, AND KITCHEN STORAGE TO BE SUPPLIED BY NEW RTU
 - PACKAGE ROOM 104 TO USE EXISTING HVAC
 - TRANSPORT ROOM 202 AND ALL OF COMMON AREA 000 TO USE EXISTING RTU
 - COMMON AREA 001, HEMP, AND OPEN WAREHOUSE TO BE UNCONDITIONED
 - STORAGE ROOM 103 TO MAINTAIN TEMPERATURE BETWEEN 65-72 DEGREES, HUMIDITY LEVELS UNDER 40%; HUMIDIFIER MAXIMUM OUTPUT AT 200 PINTS PER DAY
 - GREASE INTERCEPTOR WILL NEED TO BE INSTALLED PER LOCAL PLUMBING CODE
 - RAW MATERIAL STORAGE, KITCHEN, CHOCOLATE, STORAGE 103, PRE-TRANSPORT, AND TRANSPORT 101 TO BE CONDITIONED

NOT FOR CONSTRUCTION